

Alternate instructions for installing larger diameter cables in RACO® STAB-IT® II boxes (if needed)

1. Loosen up screw

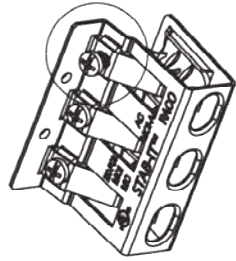

2. Push in cable

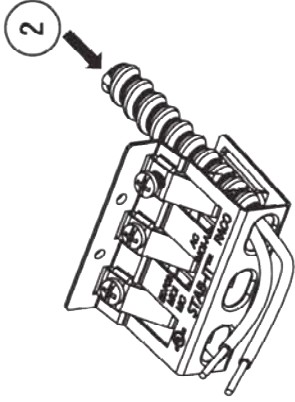

3. Tighten up screw

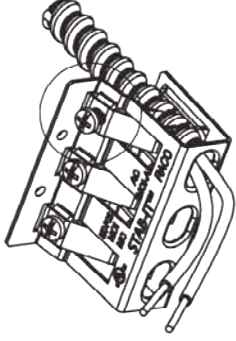

4. Push in cable until it
snaps into place

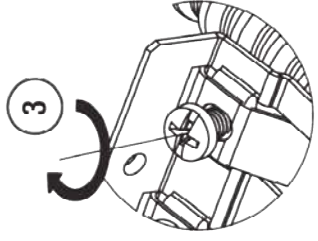
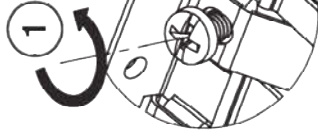
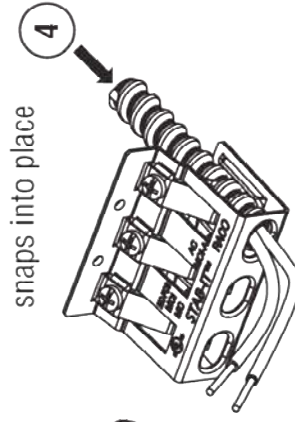

Instructions for removing cables from RACO® STAB-IT® II boxes

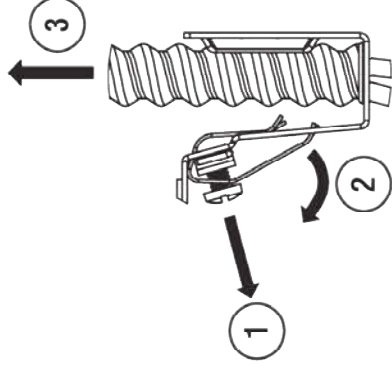
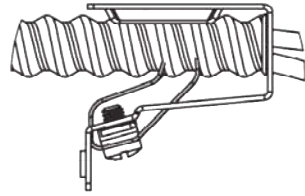
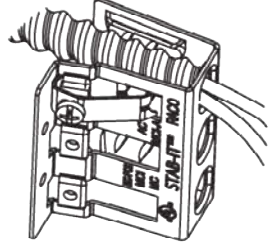
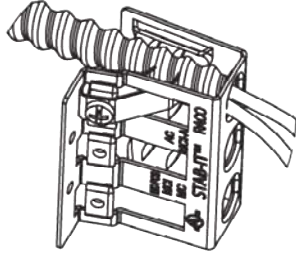

1. Loosen screw

2. Pull the spring clip away from cable as shown

3. Pull cable out



Hubbell Commercial Construction
Hubbell Incorporated (Delaware)

RACO INC.
3902 W. Sample St. P.O. Box 4002 South Bend, IN 46634
Phone: (574) 234-7151 FAX (574) 283-4244

MADE IN CHINA
RA-Instr 348 rev2
400704