

25 kV COLD SHRINK TERMINATION KIT

Conforms to all Requirements of IEEE Std. 48 and C119.4
Latest Revision

Ratings

Maximum Continuous Voltage.....16 kV Phase-to-Ground

Insulation Withstand Voltages

Basic Impulse Level.....150 kV Crest (1.2 x 50 μ Sec. wave)
60 Hz (60 Sec.) Dry.....65 kV rms
60 Hz (6 Hr.) Dry.....55 kV rms
60 Hz (10 Sec.) Wet.....60 kV rms
Partial Discharge Extinction Voltage (5 pC).....21 kV rms

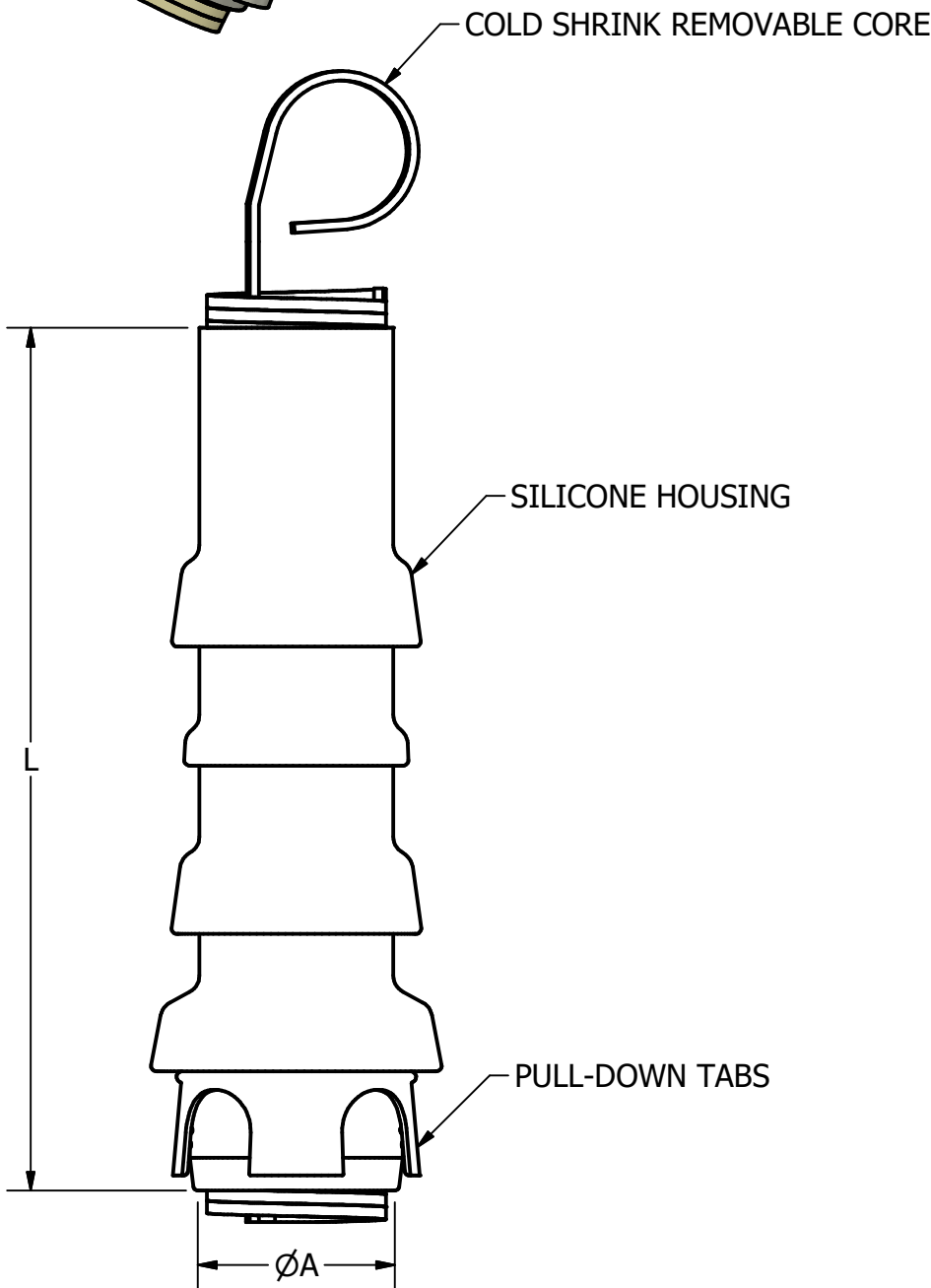
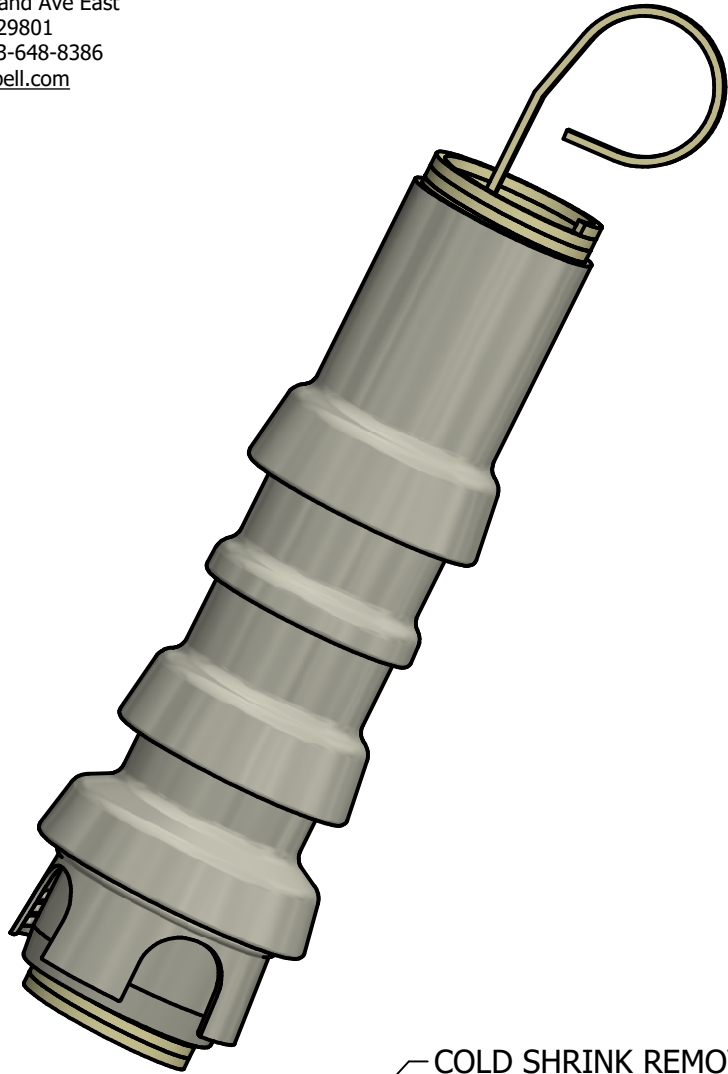

TABLE 1

| HOUSING CODE | INSULATION DIA. (in.) | L (in.) | ØA (in.) |
|--------------|-----------------------|---------|----------|
| 2 | .67-1.10 | 8.5 | 1.5 |
| 3 | 0.85 - 1.50 | 9.4 | 1.9 |
| 5 | 1.08 - 1.97 | 10.2 | 2.4 |
| 6 | 1.41 - 2.56 | 11.2 | 3 |

TABLE 2

| CONNECTOR CODE | CONDUCTOR SIZE | STRANDING |
|----------------|----------------|-----------------------|
| A22 | #2 | Stranded & Compressed |
| | #1 | Compact & Solid |
| | #1 | Stranded & Compressed |
| | 1/0 | Compact & Solid |
| A24 | 1/0 | Stranded & Compressed |
| | 2/0 | Compact & Solid |
| A25 | 2/0 | Stranded & Compressed |
| | 3/0 | Compact & Solid |
| A26 | 3/0 | Stranded & Compressed |
| | 4/0 | Compact & Solid |
| A27/B27 | 4/0 | Stranded & Compressed |
| | 250 | Compact |
| B30 | 250 | Stranded & Compressed |
| | 350 | Stranded & Compressed |
| B33 | 500 | Compact |
| | 600 | Stranded & Compressed |
| B38 | 750 | Compact |
| | 700 | Stranded & Compressed |
| | 750 | Stranded & Compressed |
| B41 | 1000 | Stranded & Compressed |

ORDERING INFORMATION:

25TW**X1X2X3**

X1 = HOUSING CODE (SEE TABLE 1)

X2 = CONNECTOR (SEE TABLE 2)

X3 = G FOR GROUND KIT
BLANK FOR NONE

FOR TERMINATIONS WITHOUT CONNECTOR USE:

25TW20 = HOUSING CODE 2

25TW30 = HOUSING CODE 3

25TW50 = HOUSING CODE 5

25TW60 = HOUSING CODE 6

The Hubbell Cold Shrink Termination manufactured with silicone rubber, is designed for 15 kV applications and offers easy installation and reliable performance when terminating outdoor medium voltage solid dielectric cables. Hubbell Cold Shrink Terminations are designed for use on 3 & 4-wire systems, or single phase taps from these systems. Removal of the inner support core allows the termination to shrink evenly on the cable, producing a tight void free interface between the cable and termination housing.

| | | | | | |
|--|-----------|---|------------|-----------------------|--------------|
| <p>CONTENTS ARE CONFIDENTIAL AND THE EXCLUSIVE PROPERTY OF HUBBELL POWER SYSTEMS. NO PUBLICATION, DISTRIBUTION OR COPIES MAY BE MADE WITHOUT THE WRITTEN CONSENT OF HUBBELL POWER SYSTEMS. HUBBELL POWER SYSTEMS UNPUBLISHED ALL RIGHTS RESERVED UNDER THE COPYRIGHT LAWS.</p> | | HUBBELL POWER SYSTEMS, Inc. | | | |
| | | <p>TITLE 25 kV COLD SHRINK TERMINATION</p> | | | |
| REV DATE | 4/11/2019 | SIZE | DWG NO. | CAT / PART / ASSY NO. | REV |
| | | SB | --- | 25TW | 0 |
| | | DO NOT SCALE THIS DRAWING | DRN BY BVB | DATE 4/11/2019 | SHEET 1 OF 1 |