

CATALOG NUMBER	ALUMINIUM		A.C.S.R.		FIG. NO.	DIMENSIONS		DIE INDEX
	MIN.	MAX.	MIN.	MAX.		H	L	
YC4A6	#6 SOL	#4 STR	#6 SOL	#6 STR	#6	-----	-----	B6
YC4A4	#6 SOL	#4 STR	#4 SOL	#4 STR	#6	#6	-----	B6
YC2A6	#2 SOL	#2 STR	#6 SOL	#6 STR	#4 6-1 #2 7-1	-----	-----	C
YC2A4	#2 SOL	#2 STR	#4 SOL	#4 STR	#4 7-1 #2 7-1	-----	-----	C
YC2A2	#2 SOL	#2 STR	#2 SOL	#2 STR	#4 6-1 #2 7-1	-----	-----	C
YC2SA4	1/0 STR	1/0 STR	#6 STR	#4 STR	1/0	#6 (6-1)	#4 (7-1)	C
YC2SA2	1/0 STR	1/0 STR	#2 SOL	#2 STR	1/0	#2 (6-1)	#2 (7-1)	C
YC2SA25	1/0 STR	2/0 STR	1/0 STR	2/0 STR	1/0	1/0	1/0	Q
YC26A3	1/0 STR	2/0 STR	#6 STR	#2 SOL	2/0	#6 (6-1)	#4 (7-1)	D
YC26A2	1/0 STR	2/0 STR	#2 STR	#2 STR	1/0	#2 (6-1)	#2 (7-1)	D

CATALOG NUMBER	ALUMINIUM		A.C.S.R.		FIG. NO.	DIMENSIONS		DIE INDEX
	MIN.	MAX.	MIN.	MAX.		H	L	
YC26A25	1/0 STR	2/0 STR	1/0 STR	1/0 STR	2	1.38 [19]	2.56 [32]	D
YC26A26	1/0 STR	2/0 STR	2/0 STR	2/0 STR	1	1.38 [19]	2.56 [32]	D
YC28A2	3/0 STR	4/0 STR	#6 SOL	#2 STR	2	1.61 [25]	2.75 [38]	H
YC28A25	3/0 STR	4/0 STR	4/0 STR	4/0 STR	2	1.61 [25]	2.75 [38]	H
YC28A26	3/0 STR	4/0 STR	4/0 STR	4/0 STR	2	1.61 [25]	2.75 [38]	H
YC28A28	3/0 STR	4/0 STR	4/0 STR	4/0 STR	1	1.61 [25]	2.75 [38]	H
YC33R2R	300 AAC	397.5 AAC	6 STR AAC	#1 AAC	2	1.96 [25]	.81 [21]	R
YC33R26	336.4 AAC	336.4 AAC	#2 STR AAC	2/0 AAC	2	1.96 [25]	1.56 [40]	R
YC33R28	336.4 AAC	397.5 AAC	2/0 STR AAC	4/0 AAC	2	2.08 [35]	2.50 [64]	R

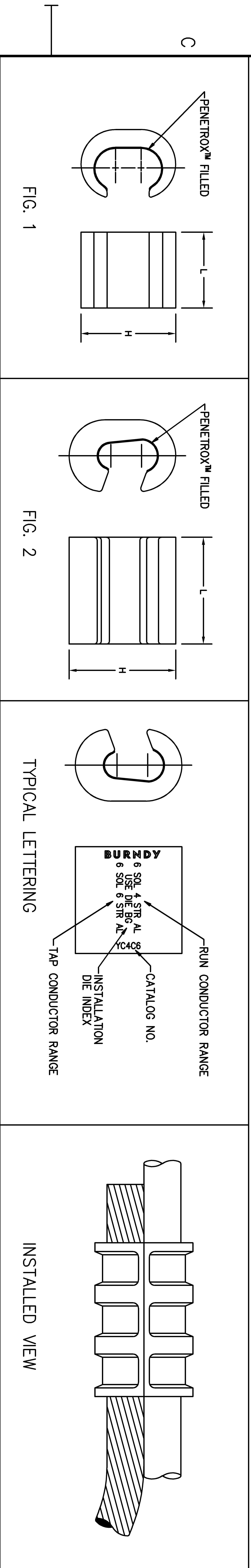

COLOR CODE	DIE INDEX	INSTALLATION TOOLING (# OF CRIMPS)			
		MECHANICAL	HYDRAULIC	PERM GR(4)	W-BG(2)
---	BG	X-BG(4)	U-BG(4)	U-BG(4)	U-BG(4)
---	C	K-NBG(2)	W-C(4)	U-C(4)	U-C(4)
---	Q	---	W-Q(6)	---	---
---	D	---	---	U-D(3)	U-D(3)
---	H	---	---	U-H(3)	U-H(3)
---	R	---	---	U-R(1)	U-R(1)

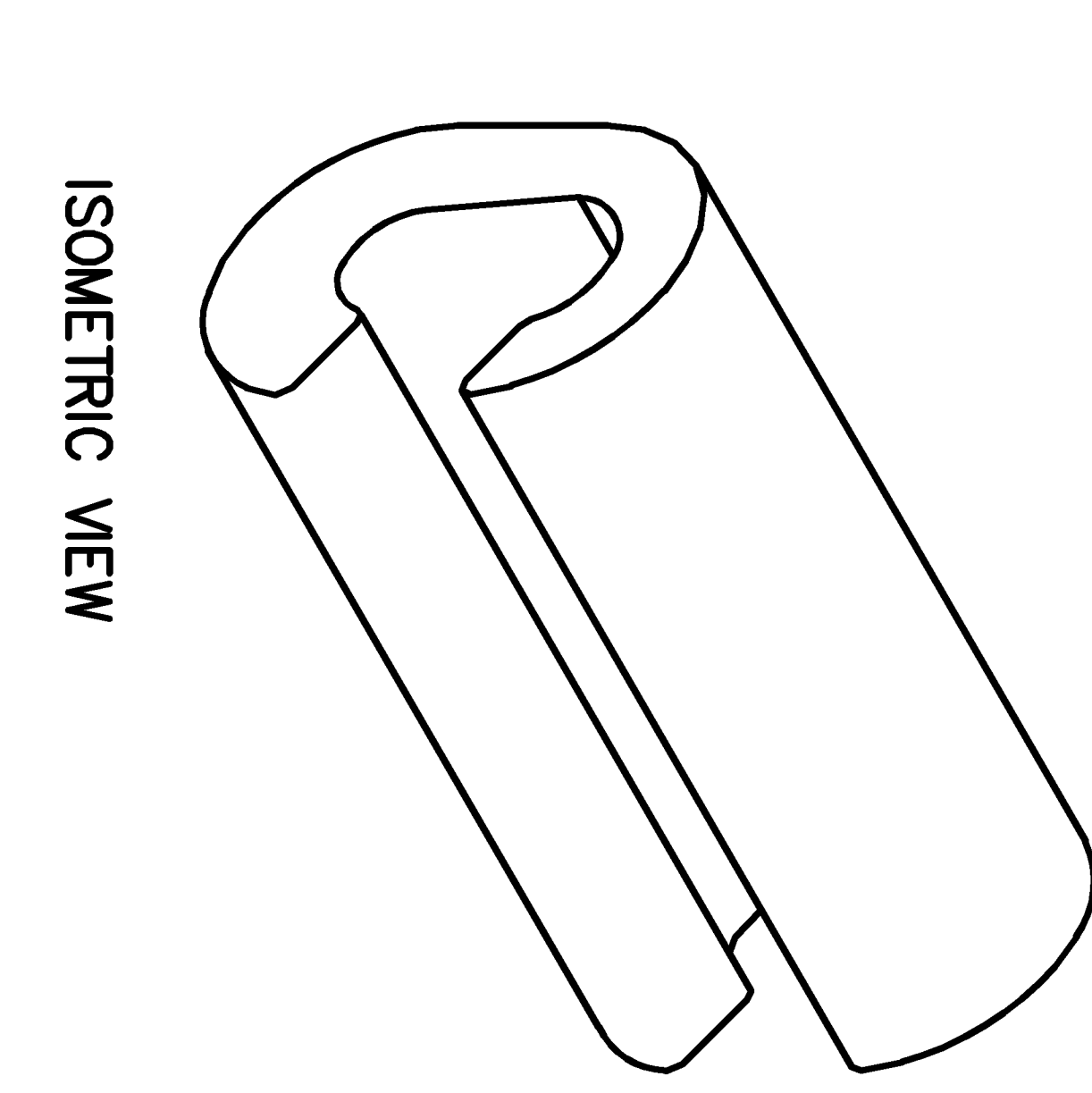

- NOTES:**
- MATERIAL: ALUMINIUM
 - CATALOG # PT6515 ADAPTOR IS REQUIRED TO USE "U" DIES IN Y45 SERIES TOOLS.
 - CATALOG # PUADP-1 ADAPTOR IS REQUIRED TO USE "U" DIES IN Y46 SERIES TOOLS.
 - TWO CRIMPS MADE SIMULTANEOUSLY WITH ONE CLOSING OF TOOL.
 - SCRATCH BRUSH CONTACT SURFACES OF CONDUCTORS.
 - TO INSURE GETTING PENETROX™ ON ALL CONDUCTOR SURFACES, MOVE THE CRIMPIT™ UP AND DOWN AFTER PLACING IT ON THE RUN CONDUCTOR, BUT BEFORE THE TAP IS INSERTED.
 - REFERENCE, FOR UTILITY USE.
 - YC28A26 ALSO ACCOMMODATES: 3/0 ACSR RUN TO 3/0 ACSR OR 3/0 AAC TAP.
 - YC2SA2 REQUIRES 6 CRIMPS.
 - YC33R26 REQUIRES 2 CRIMPS.

REFERENCE: SD33889N4, N6, N12, N16, N17 & N18
SD28962, SE45717

TO ORDER BURNDY PRODUCTS CALL 1-800-346-4175
MANCHESTER, NH 03109, USA
FOR PRODUCT INFO = <http://www.fciconnect.com>

CRIMPIT™ (ALUM.)

ITEM NO: N/A
CAT NO: YC-A, YC-R (TABLE)

SCALE: N/A	DRAWN BY: P HARRICK	1/15/59
CHECKER: W.G.	1/18/59	
DESIGN: R. MACDONALD	8/13/56	
ING. APPRVL: ---		
ICC APPRVL: D. VARIO	9/9/56	
MKT. APPRVL: R. PELLIER	8/14/56	
PROD. PLAN: ---		
PROJECT #: ---	SIZE: D	
DRAWING NO: SD027166-01	SHEET 1 OF 1	

