

*** BILL OF MATERIAL ***

PT NO.	CATALOG NO.	QTY	DESCRIPTION
1	PATCASELI	1	CASE, TOOL PATRIOT LITHIUM-ION
2	BAT18VLI	2	BATTERY, LITHIUM ION 18V
3	PATCHGRLI	1	CHARGER, BATTERY LITHIUM ION
4	BATCHGRLIOMI	1	BATTERY CHARGER SAFETY OPERATING MAINTENANCE & INSTRUCTIONS
5	PT208620	1	LANYARD
6	PATCUT129LIOMI	1	SOMI, PATCUT129LI
7	PT2044380I	1	FIVE YEAR WARRANTY CARD
8	LIMSDS	1	MSDS, LITIUM-ION BATTERY

CATALOG NUMBER	DESCRIPTION	CHARGER CATALOG NO.
PATCUT129-LI	PATRIOT® 129 CUTTER WITH 120V CHARGER	PATCHGRLI
PATCUT129-LIDC	PATRIOT® 129 CUTTER WITH 12V CHARGER	PATCHGRLIDC
PATCUT129-LI250V	PATRIOT® 129 CUTTER WITH 250V CHARGER	PATCHGRLI250V

SPECIFICATIONS:

TOOL WEIGHT WITH BATTERY: 10.2 LBS (4.6 kg)
 LENGTH: 14.5 IN (36.8 cm)
 WIDTH: 3.5 IN (8.9 cm)
 HEIGHT: 13.5 IN (34.3 cm)
 OPERATING VOLTAGE: 18V-D
 RECHARGE TIME: 30 MINUTES

FOR USE ON

COPPER & ALUMINUM 1.29"
 ACSR 1113 kcmil
 GROUND ROD 5/8"
 REBAR 1/2"
 SOFT STEEL BOLTS 5/8"
 STANDARD GUY WIRE 1/2"
 EHS GUY WIRE 3/8"

FEATURES AND BENEFITS

- REFINED HYDRAULIC SYSTEM FOR ULTRA PERFORMANCE, SPEED AND RELIABILITY.
- FIELD PROVEN ELECTRONICS FOR ULTIMATE RELIABILITY IN THE HARSHTEST ENVIRONMENTS.
- OVERMOLDED HANDLE FOR COMFORT AND IMPROVED GRIP; ALLOWS FOR ONE HANDED OPERATION FOR ADVANCE RETRACT AND HOLD.
- SPECIALIZED LATCH HEAD DESIGN FOR INTERFERENCE FREE CLOSURE FOR MID-SPAN CUTS.
- MAKITA 18 VOLT LITHIUM-ION BATTERIES PROVIDE 2.5 TIMES MORE CHARGE/DISCHARGE CYCLES THAN TRADITIONAL Ni-Cd BATTERIES AND PROVIDE 430% MORE LIFETIME WORK.
- MAKITA 30 MINUTE CHARGER CONTROLS CURRENT, VOLTAGE AND TEMPERATURE TO MAXIMIZE BATTERY LIFE.
- FORCED AIR COOLING FAN COOLS THE BATTERY BY FORCING COOL AIR THROUGH THE BATTERY'S BUILT IN AIR VENTS.
- 180° HEAD ROTATION ALLOWS USER TO GET INTO TIGHT AREAS EASIER.
- ERGONOMICALLY BALANCED TOOL DESIGN EASES OPERATION AND LESSENS FATIGUE.
- DURABLE HIGH IMPACT FORMED CARRYING CASE PROVIDES SUPERIOR PROTECTION AND STORES ALL ACCESSORIES.
- MECHANICAL RAM RELEASE: PROVIDES CONSISTENT, RELIABLE RAM RETRACTION (NO BATTERY POWER CONSUMPTION)
- 5 YEAR LIMITED WARRANTY ON THE TOOL (EXCLUDING BLADES).
- LIFETIME WARRANTY ON INFINITY DRIVE®.
- 3 YEAR LIMITED WARRANTY ON THE BATTERIES AND CHARGER.

NOTES:

1. READ AND FOLLOW ALL INSTRUCTIONS PROVIDED BY THE OPERATORS MANUAL, AND WARNING LABELS BEFORE USING THIS TOOL.

REV.	DATE	DESCRIPTION	ECO	BY	C'H'K.
E	2019-10-07 00:00:00 EDT	UPDATED AS PER MARKUP	52293	JL	BE

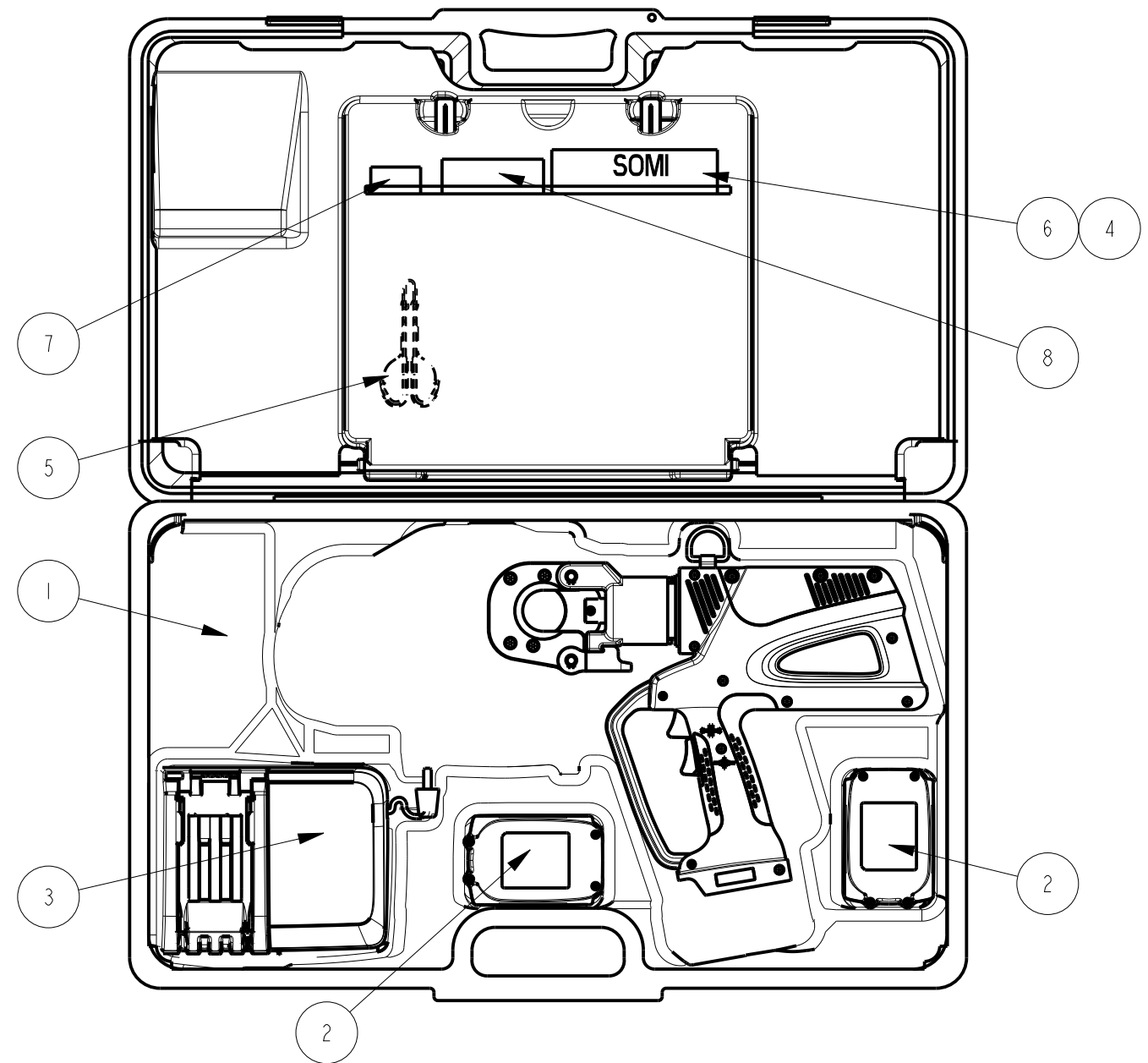

2. TOOL ACCEPTS 18V MAKITHA LITHIUM ION BATTERIES, BL SERIES OF SIZE 2.0 AHR AND GREATER IF THE PLASTIC BATTERY CLIP IN THE TOOL HAS A "STAR" MOLDED INTO IT. THE "STAR" IDENTIFIES ACCEPTANCE OF THE BL SERIES BATTERIES.
3. FOR TOOLS WHICH DO NOT HAVE A "STAR" MOLDED INTO THE PLASTIC BATTERY CLIP, USE IS LIMITED TO THE BL1830 (3.0 AHR) BATTERY. FORCING ANY OTHER BATTERY INTO THIS TOOL WILL VOID THE WARRANTY.

TO ORDER BURNDY® PRODUCTS CALL

UNITED STATES:
 1-800-346-4175 (LONDONDERRY, NH)

CANADA:
 1-800-361-6975 (QUEBEC)
 1-800-387-6487 (ALL OTHER PROVINCES)

FOR PRODUCT INFO: <http://www.burndy.com>

®UPDATED DATA

ITEM NO: --	CAT. NO: SEE TABLE	
DRAWN BY: T. FAUCHER 06/09/2010	CHECKER: M. CHIASSON 10/26/2010	BURNDY
DSN APPVL: M. CHIASSON 10/26/2010	MFG APPVL: S. GONYAW 10/26/2010	
QA APPVL: J. BRODEUR 10/27/2010	MKT APPVL: R. POIRIER 10/28/2010	SCALE: 1:4
PROD FAM: TOOLS, BATTERY	PROJECT #: 14074	DRAWING NO
DOCUMENT TYPE: Sales	SIZE: B	30002355
REL LEVEL: Released		SHEET 1 OF 1

REV: PE0200