

CLAMP TYPE LINE & GROUND TERMINALS  
SUITABLE FOR USE WITH CU OR AL  
CONDUCTOR .25(6) TO .81(21) DIA

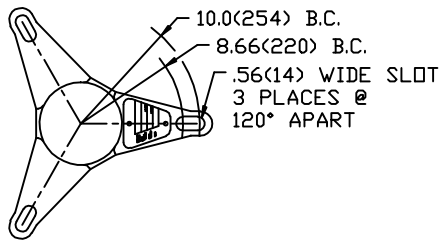

NOTES:

- 1 PACKED FOR DOMESTIC SHIPMENT
- 2 DIMENSIONS SUBJECT TO ±3% TOLERANCE.
- 3 DIMENSIONS ARE IN INCHES(MM).
- 4 ALTITUDE 0 TO 12,000 FT(3600 METERS) ABOVE SEA LEVEL.
- 5 PRESSURE RELIEF 40 KA RMS.
- 6 LEAKAGE DISTANCE - 15.4 IN(391 MM).
- 7 WEIGHT - 6.2 LB(3 KG).
- 8 MAXIMUM CONTINUOUS LINE-TO-GROUND OPERATING VOLTAGE RATING - 7.65 KV MCOV.
- 9 DUTY CYCLE VOLTAGE RATING - 9 KV RMS.
- 10 DARK GRAY WEATHERSHEDS.

.5 μ SEC 10kA IR KV	500 A SWITCHING SURGE IR KV	MAXIMUM 8/20 DISCHARGE VOLTAGE - KV AT					
		1.5 kA	3.0 kA	5 kA	10 kA	20 kA	40 kA
25.8	19.1	20.5	21.6	22.6	24.4	27	30.4

INTERMEDIATE  
CLASS  
ARRESTER

**OHIO BRASS**  
TOLERANCE CHART



**HUBBELL** POWER SYSTEMS

CONFIDENTIAL: THIS DRAWING AND ITS CONTENTS ARE CONFIDENTIAL AND THE EXCLUSIVE PROPERTY OF HUBBELL POWER SYSTEMS. NO PUBLICATION, DISTRIBUTION OR COPIES MAY BE MADE WITHOUT THE WRITTEN CONSENT OF HUBBELL POWER SYSTEMS. HUBBELL POWER SYSTEMS UNPUBLISHED ALL RIGHTS RESERVED UNDER THE COPYRIGHT LAWS.

TITLE  
PVI-LP ARRESTER  
7.65 KV MCOV

Program Revision  
2018.12.10.08.55.58

REV DATE  
08/04/04

SIZE S	DWG NO. ISPOLY-IN	CAT / PART / ASSY NO. 300808-3002	REV 0
DO NOT SCALE THIS DRAWING	DRN BY NON	DATE 11/26/02	SHEET 1 OF 1