

NOTES:

- 1 CREEPAGE DISTANCE: 14.08" / 358mm
- 2 ARC DISTANCE: 6.85" / 174mm
- 3 NOMINAL VOLTAGE: 15kV
- 4 NOMINAL CURRENT: 2000A
- 5 WITHSTAND VOLTAGE AT 60 sec.: 50kV
- 6 B.I.L. : 110kV
- 7 APPLICATION STANDARD: IEEE C57.19.01
- 8 MAX. TORQUE APPLIED ON FLANGE BOLTS: 40 lbf · ft / 54.2 N · m
- 9 WEIGHT: 26 lb / 11.8 kg

REVISIONS					
ZONE	REV.	DESCRIPTION	DRAWN BY	DATE	APPR.
A1 A6 C6	A	GENERAL UPDATE TO ACTUAL STANDARD ADD THE "SDC" DESIGNATION TO THE BUSHING NAME ADD THE MINIMUM GASKET SEAT DIMENSION INCREASE THE TOLERANCES ON THE FLANGE OUTSIDE DIAMETER	M. FORGET	2020-07-01	Y.V.

F

F

E

E

D

D

C

C

B

B

A

A

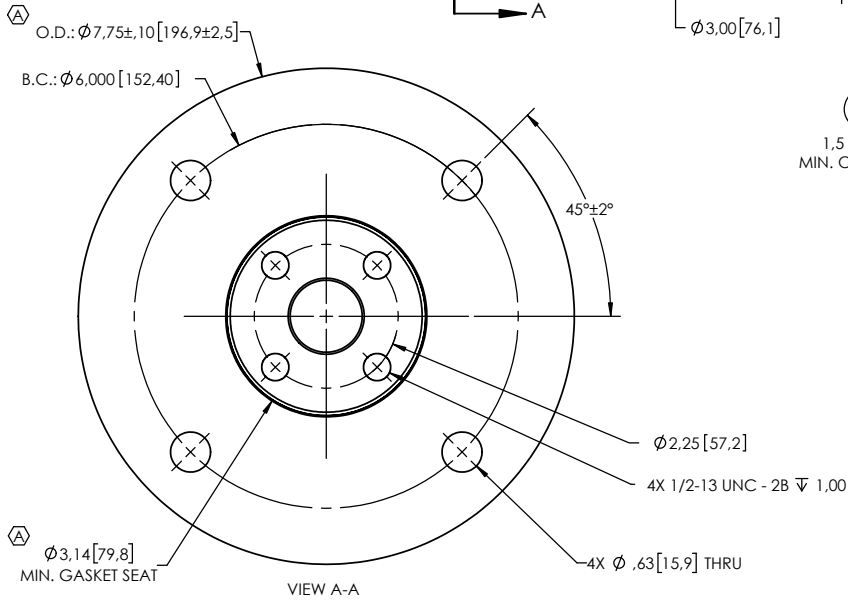
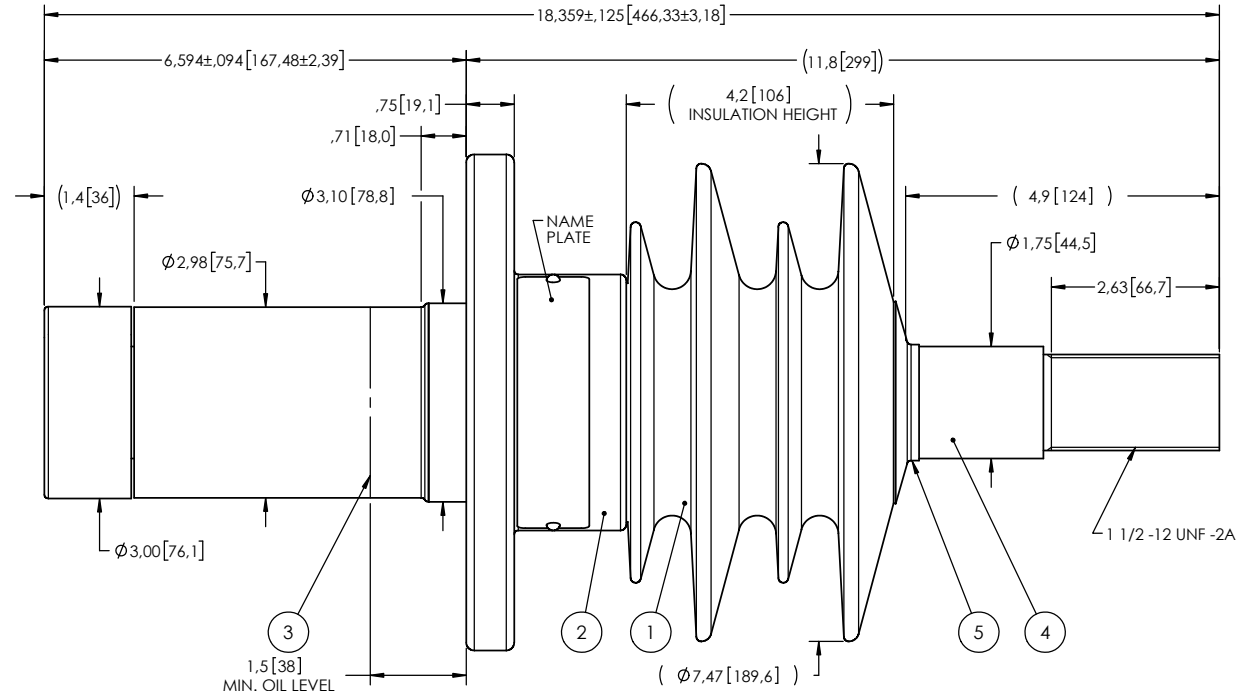

This drawing is the proprietary property of Electro Composites (2008) ULC, not part of the public domain, and is issued with the express understanding and agreement that it is not to be reproduced or copied in whole or in part or issued for furnishing information to others, or used directly or indirectly, in any way detrimental to the interest of Electro Composites (2008) ULC and is to be returned upon request by Electro Composites (2008) ULC. All Rights Reserved.

ITEM NO.	QTY	DRAWING NO.	PART NO.	DESCRIPTION	NOTE / MAT'L
5	1	S-1600-0587-0		CAP	COPPER
4	1	S-6831-6467		ROD ASSEMBLY	COPPER
3	1	S-6831-6466		SHIELD	COPPER
2	1	S-6831-6465		FLANGE	ALUMINUM
1	1	S-6831-6464	-001	CASTING, CYCLOALIPHATIC RESIN	EC-APG-02

PARTS LIST

GENERAL TOLERANCES (UNLESS OTHERWISE SPECIFIED)

- X. ±0.125
- .X ±0.094
- .XX ±0.063
- .XXX ±0.010
- ANGLES ±0.1°
- RADIUS ±0.031

REMOVE BURRS AND BREAK SHARP EDGES

DIMENSIONS ARE IN INCHES (UNLESS OTHERWISE SPECIFIED)

REPLACE:

DRAWN BY: J.N.PILOTTE DATE: 2011/03/17

CHECK BY:

PROJECT ENG.:

PROJECT MANAGER:

**Electro Composites**  
solid HV bushings solution

TITLE: SDC® BUSHING 15kV, 2000A Ⓢ  
MODEL: 110-020-T-355-01

FORMAT	CAGE CODE	DRAWING NO.	REVISION
A		S-6831-6464	A

SCALE	GENERATED BY	SHEET
1:3	SolidWorks 2009	1 of 1