

NOTES:

- 1 CREEPAGE DISTANCE: 13.3" / 338mm
- 2 ARC DISTANCE: 7.2" / 183mm
- 3 NOMINAL VOLTAGE: 15kV
- 4 NOMINAL CURRENT: 4000A
- 5 VOLTAGE WITHSTAND, 60 sec.: 50kV
- 6 B.I.L. : 110kV
- 7 ROUTINE TEST ACCORDING TO: IEEE C57.19.01
- 8 MAX. TORQUE APPLIED ON FLANGE BOLTS: 70 lbf x ft / 94.9 N.m
- 9 WEIGHT: 69 lb / 31.3 kg

REVISIONS					
ZONE	REV.	DESCRIPTION	DRAWN BY	DATE	APPR.
-	A	GENERAL UPDATE TO ACTUAL STANDARD ADD THE "SDC" DESIGNATION TO THE BUSHING NAME. ADD THE MINIMUM GASKET SEAT DIMENSION. INCREASE THE TOLERANCES ON THE FLANGE OUTSIDE DIAMETER.	M. FORGET	2021-08-12	Y.V.

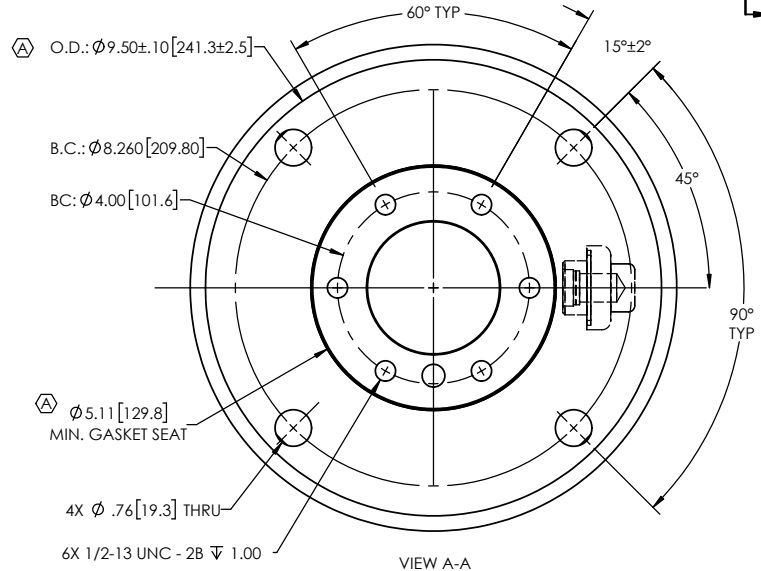
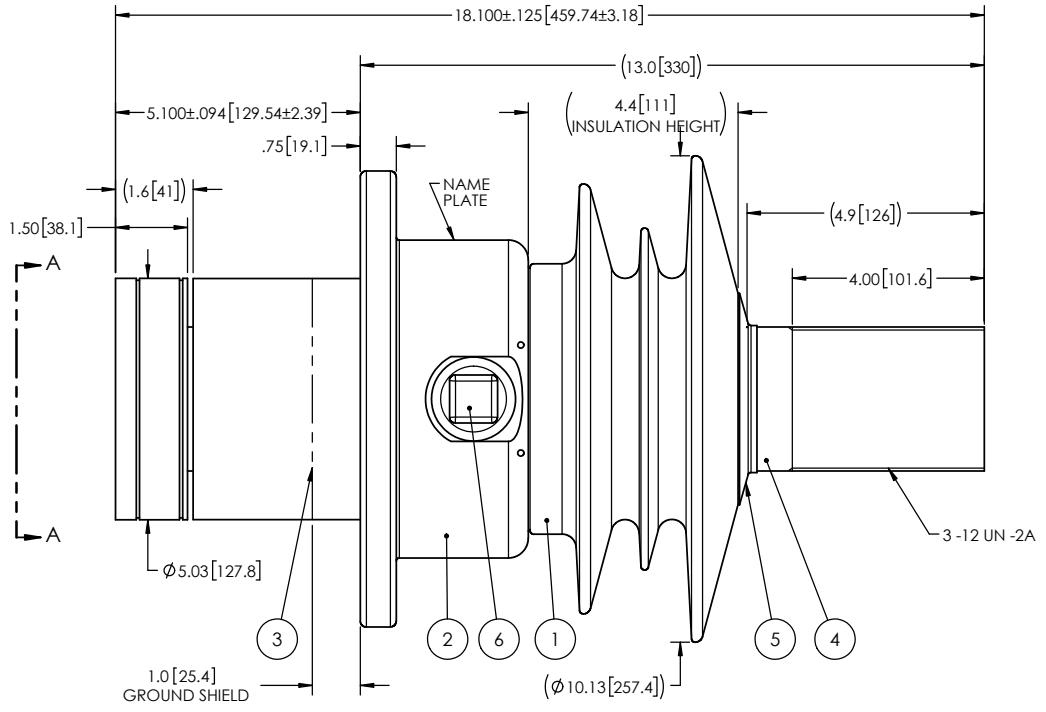

ITEM NO.	QTY	DRAWING NO.	PART NO.	DESCRIPTION	NOTE / MAT'L
6	1	S-1001-2022		CAPACITANCE TAP ASSEMBLY	ALUMINUM
5	1	S-3529-2532-0		CAP	COPPER
4	1	S-5303-4847		ROD ASSEMBLY	COPPER
3	1	S-5303-4855		SHIELD ASSEMBLY	COPPER
2	1	S-5303-4846		FLANGE	ALUMINUM
1	1	S-5303-4845	-001	CASTING, CYCLOALIPHATIC RESIN	EC-APG-02

PARTS LIST					
GENERAL TOLERANCES (UNLESS OTHERWISE SPECIFIED)			<p>ElectroComposites™ solid HV bushings solution</p> <p>TITLE: SDC® BUSHING 15kV, 4000A MODEL: 110-040-T-408-00</p>		
X.	±0.125	DRAWN BY: J. CLICHE CHECK BY: PROJECT ENG.: PROJECT MANAGER:	DATE: 2008/07/10	FORMAT: A	CAGE CODE: S-5303-4845
.X	±0.094		DRAWING NO.:	REVISION: A	
.XX	±0.063		SCALE: 1:4	GENERATED BY: SolidWorks 2020	
.XXX	±0.031		SHEET: 1 of 1		
ANGLES	±0.25°				
RADIUS	±0.031	REMOVE BURRS AND BREAK SHARP EDGES DIMENSIONS ARE IN INCHES (UNLESS OTHERWISE SPECIFIED)			

This drawing is the proprietary property of Electro Composites (2008) ULC, not part of the public domain, and is issued with the express understanding and agreement that it is not to be reproduced or copied in whole or in part or issued for furnishing information to others, or used directly or indirectly, in any way detrimental to the interest of Electro Composites (2008) ULC and is to be returned upon request by Electro Composites (2008) ULC. All Rights Reserved.