

- NOTES:
- 1 CREEPAGE DISTANCE: 43.5" / 1106mm
 - 2 ARC DISTANCE: 18.4" / 467mm
 - 3 NOMINAL VOLTAGE: 34.5kV
 - 4 NOMINAL CURRENT: 4000A
 - 5 VOLTAGE WITHSTAND, 60 sec.: 80kV
 - 6 BIL : 200kV
 - 7 ROUTINE TEST ACCORDING TO: IEEE C57.19.01
 - 8 MAX. TORQUE APPLIED ON FLANGE BOLTS: 70 lbf·ft / 94.9 N·m
 - 9 WEIGHT: 190 lb / 86.2 kg

10 SILVER PLATED, AS PER ASTM B700, TYPE 1, GRADE D, CLASS N, NO NICKEL LAYER, FROM 13 TO 20 MICROMETERS THICKNESS

| REVISIONS | | | | | |
|-----------|------|--|-----------|------------|-------|
| ZONE | REV. | DESCRIPTION | DRAWN BY | DATE | APPR. |
| A2 B6 | A | ADD THE "SDC" DESIGNATION TO THE BUSHING NAME ADD THE "MINIMUM GASKET SEAT" DIMENSION | J. CLICHE | 2014-05-16 | Y.V. |
| B6 C6 | B | UPDATE THE MINIMUM GASKET SEAT DIMENSION DESIGNATION. INCREASE THE TOLERANCES ON THE FLANGE OUTSIDE DIAMETER. | M. FORGET | 2023-03-06 | Y.V. |

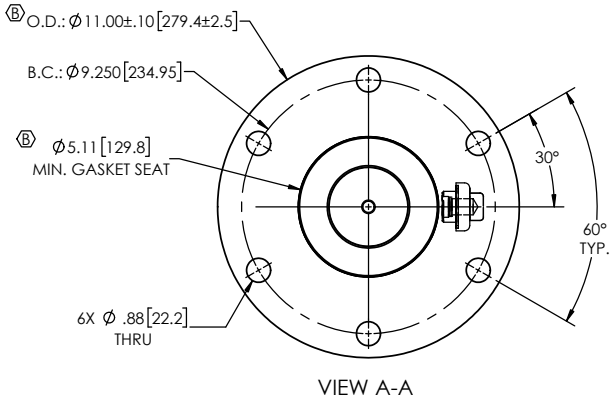
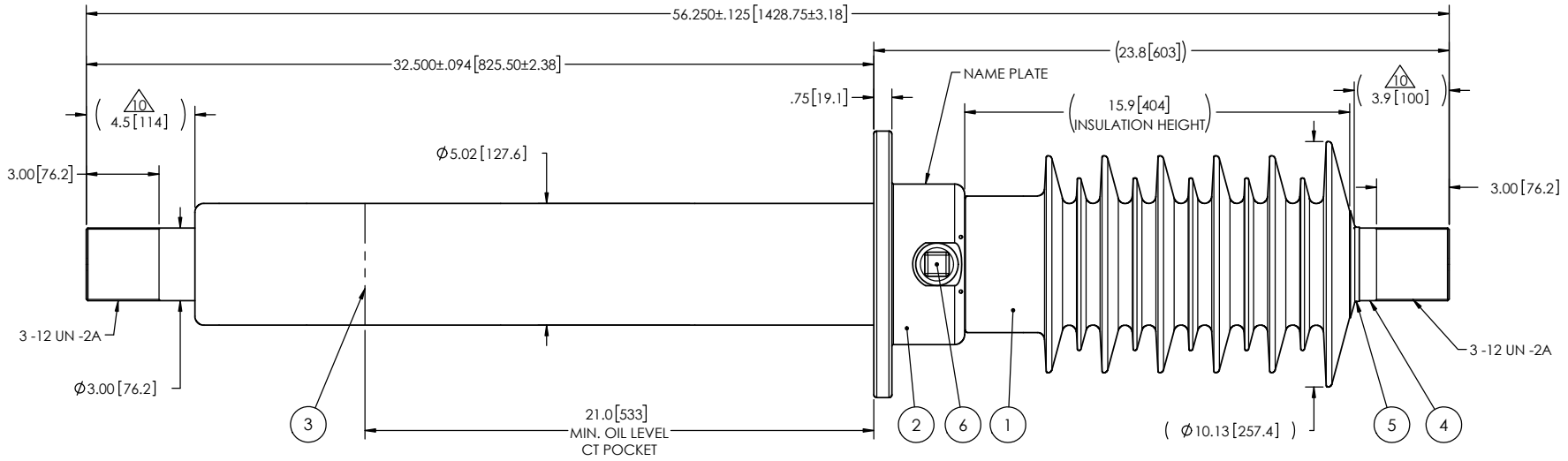

| ITEM NO. | QTY | DRAWING NO. | PART NO. | DESCRIPTION | NOTE / MAT'L |
|----------|-----|---------------|----------|-------------------------------|--------------|
| 6 | 1 | S-1001-2022 | | CAPACITANCE TAP ASSEMBLY | ALUMINUM |
| 5 | 1 | S-3529-2532-0 | | CAP | COPPER |
| 4 | 1 | S-7901-7333 | | ROD ASSEMBLY | COPPER |
| 3 | 1 | S-5860-5558 | | SHIELD ASSEMBLY | COPPER |
| 2 | 1 | S-7901-7334 | | FLANGE | ALUMINUM |
| 1 | 1 | S-7901-7332 | -001 | CASTING, CYCLOALIPHATIC RESIN | EC-APG-02 |

| PARTS LIST | | | | | |
|---|--------|--|--|-------------------------------|---------------|
| GENERAL TOLERANCES (UNLESS OTHERWISE SPECIFIED) | | | Electro Composites solid HV bushings solution | | |
| X. | ±0.125 | TITLE: SDC® BUSHING 34.5kV, 4000A MODEL: 200-040-T-487-01 | | | |
| .X | ±0.094 | | DRAWN BY: A.SAVARD | DATE: 2012/06/21 | FORMAT: A |
| .XX | ±0.063 | REMOVE BURRS AND BREAK SHARP EDGES | PROJECTING: [] | SCALE: 1:7 | REVISION: B |
| .XXX | ±0.031 | DIMENSIONS ARE IN INCHES (UNLESS OTHERWISE SPECIFIED) | PROJECT MANAGER: [] | GENERATED BY: SolidWorks 2022 | SHEET: 1 of 1 |
| ANGLES | ±0.25° | | | | |
| RADIUS | ±0.031 | | | | |

This drawing is the proprietary property of Electro Composites (2008) ULC, not part of the public domain, and is issued with the express understanding and agreement that it is not to be reproduced or copied in whole or in part or issued for furnishing information to others, or used directly or indirectly, in any way detrimental to the interest of Electro Composites (2008) ULC and is to be returned upon request by Electro Composites (2008) ULC. All Rights Reserved.