

- NOTES:
- 1 CREEPAGE DISTANCE: 41.15" / 1045.25mm
  - 2 ARC DISTANCE: 16.6" / 422.53mm
  - 3 NOMINAL VOLTAGE: 34.5kV
  - 4 NOMINAL CURRENT: 4500A
  - 5 WITHSTAND VOLTAGE AT 60 sec.: 80kV
  - 6 B.I.L. : 200kV
  - 7 ROUTINE TEST ACCORDACE TO IEEE C57.19.01
  - 8 MAX. TORQUE APPLIED ON FLANGE BOLTS: 40 lbf x ft
  - 9 WEIGHT: 286.3 lbs / 129.8 Kg
- △10 SILVER PLATED TOP END, AS PER ASTM B700, TYPE 1, GRADE D, CLASS N, NO NICKEL LAYER, FROM 13 TO 20 MICROMETERS THICKNESS

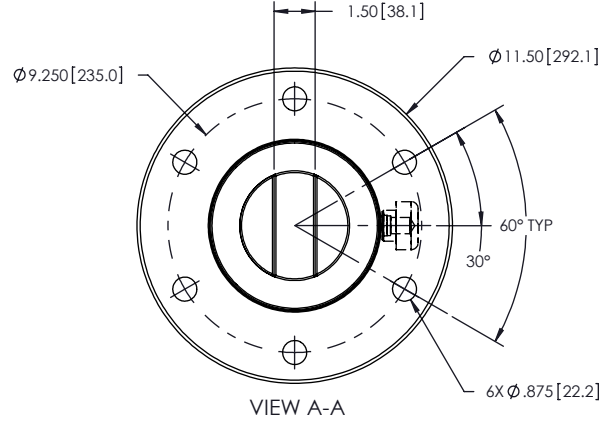
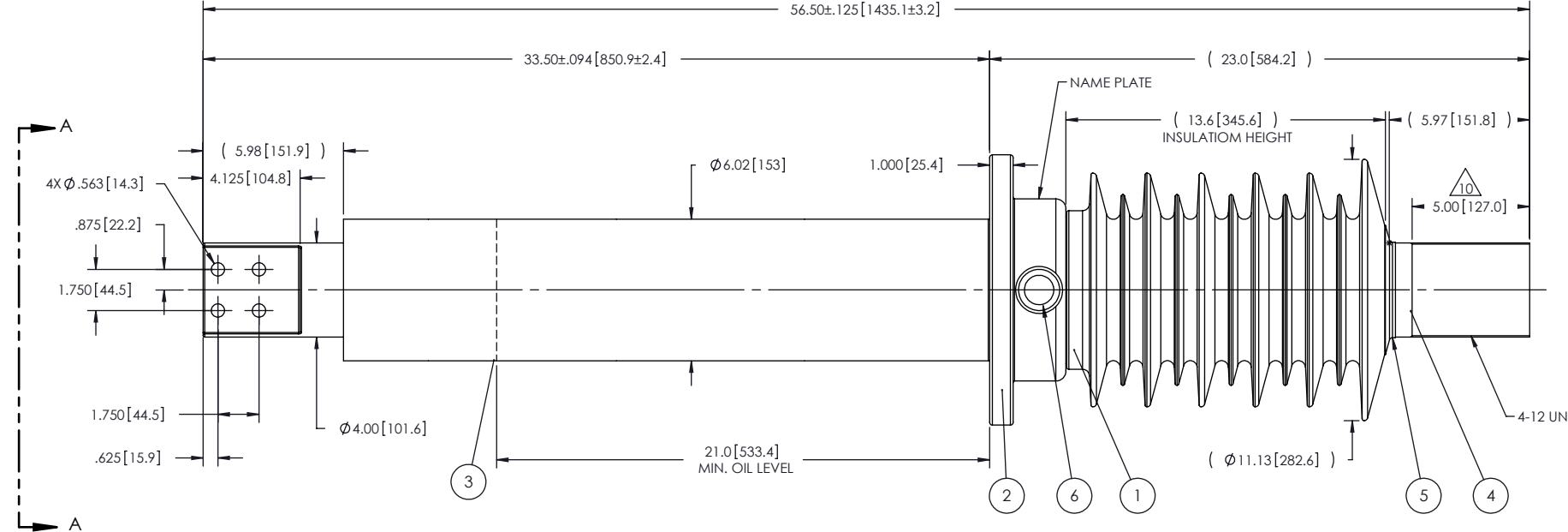

This drawing is the proprietary property of Electro Composites (2008) ULC, not part of the public domain, and is issued with the express understanding and agreement that it is not to be reproduced or copied in whole or in part or issued for furnishing information to others, or used directly or indirectly, in any way detrimental to the interest of Electro Composites (2008) ULC and is to be returned upon request by Electro Composites (2008) ULC. All Rights Reserved.

REVISIONS					
ZONE	REV.	DESCRIPTION	DRAWN BY	DATE	APPR.

ITEM NO.	QTY	DRAWING NO.	PART NO.	DESCRIPTION	NOTE / MATL
6	1	S-1001-2022	STD	CAPACITANCE TAP ASSEMBLY	ALUMINUM
5	1	S-3974-3543		CAP	COPPER
4	1	S-5904-5529		ROD ASSEMBLY	COPPER
3	1	S-5904-5528		SHIELD ASSEMBLY	COPPER
2	1	S-5904-5527		FLANGE	ALUMINUM
1	1			CASTING, CYCLOALIPHATIC RESIN	EC-APG-02
PARTS LIST					

<p>GENERAL TOLERANCES (UNLESS OTHERWISE SPECIFIED)</p> <p>X. ±0.125          .X ±0.094          .XX ±0.063          .XXX ±0.010          ANGLES ±0.25°          RADIUS ±0.031</p>		<p>REMOVE BURRS AND BREAK SHARP EDGES</p> <p>DIMENSIONS ARE IN INCHES (UNLESS OTHERWISE SPECIFIED)</p>		<p><b>Electro Composites™</b>  <b>solid HV bushings solution</b></p>	
<p>TITLE: BUSHING 34.5kV, 4500A MODEL: 200-045-T-488-00</p>		<p>SCALE: 1:7</p>		<p>GENERATED BY: SolidWorks 2009 SHEET: 1 of 1</p>	
<p>DRAWN BY: J.N.PILOTTE DATE: 2009/09/10</p>		<p>PROJECT NO.: [ ]</p>		<p>PROJECT MANAGER: [ ]</p>	
<p>CHECK BY: [ ]</p>		<p>PROJECT NO.: [ ]</p>		<p>PROJECT MANAGER: [ ]</p>	
<p>PROJECT NO.: [ ]</p>		<p>PROJECT MANAGER: [ ]</p>		<p>PROJECT MANAGER: [ ]</p>	