

REV	DATE	DESCRIPTION	ECO	BY	CHK.
A	07/30/2013	NEW DRAWING RELEASE	31396	PM	MB

CATALOG NUMBER	TRANSFORMER FULL-LOAD (NORMAL) AMPERES	FIG. NO.	FUSE THICKNESS T
Z11	600	1	.11 [3]
Z15	800	1	.15 [4]
Z22.5	1200	1	.23 [6]
Z25	1333	1	.25 [6]
Z30	1600	1	.30 [8]
Z37.5	2000	1	.38 [10]
Z44	2500	1	.44 [11]
Z50	3000	2	.50 [13]
Z7.5	400	1	.08 [2]

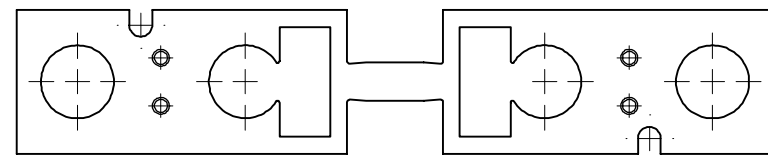

FIG. 1
FUSE

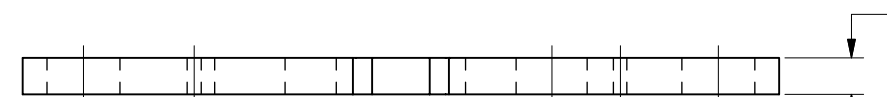
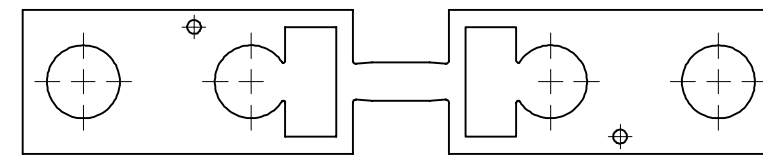
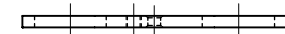
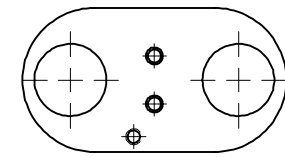
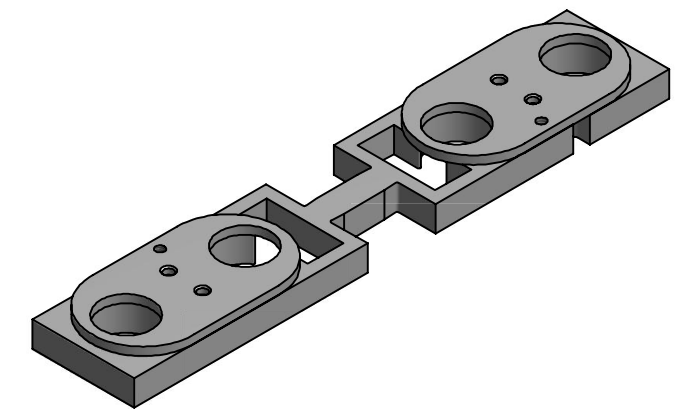
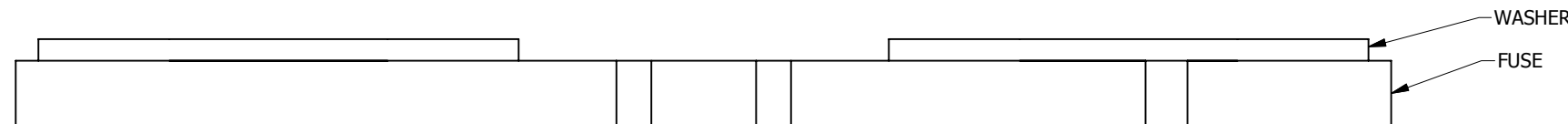
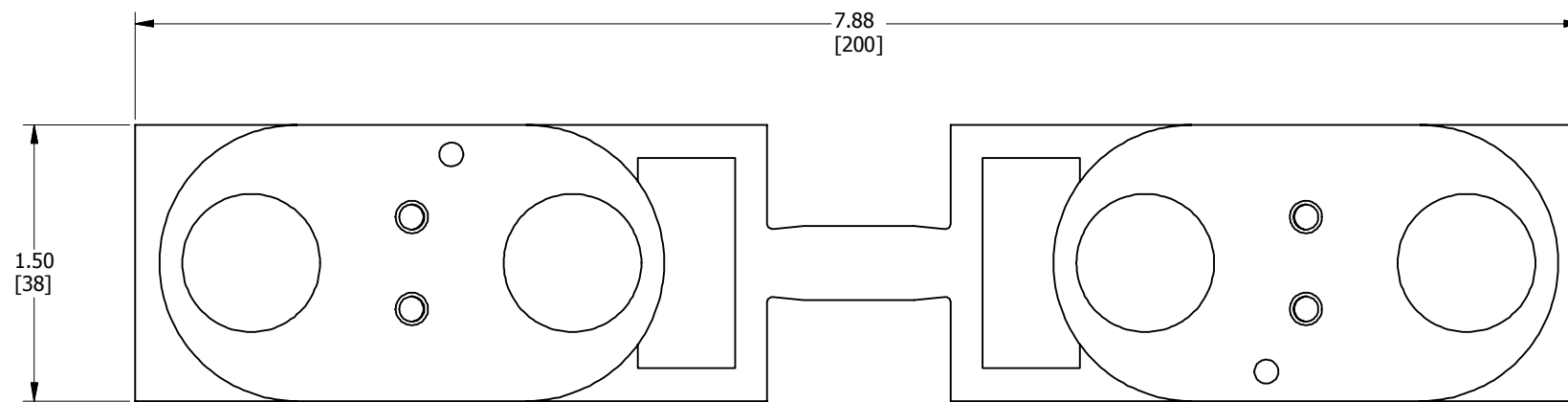

FIG. 2
FUSE



WASHER



NOTES:

- DIMENSIONS IN BRACKETS [] ARE IN MILLIMETERS ROUNDED OFF TO THE NEAREST MILLIMETER, UNLESS OTHERWISE SPECIFIED AND ARE FOR REFERENCE ONLY.
- FUSE & WASHER MATERIAL : HARD DRAWN COPPER 98% CONDUCTIVITY.
- FINISH : ELECTRO-TIN.
- FOR ASSEMBLY USE 1/8 DIA. X 3/4 LONG FLAT COUNTERSUNK HEAD COPPER RIVETS.

TO ORDER BURNDY® PRODUCTS CALL

UNITED STATES
1-800-346-4175 (LONDONDERRY, NH)

CANADA:
1-800-361-6975 (QUEBEC)
1-800-387-6487 (ALL OTHER PROVINCES)

FOR PRODUCT INFO: <http://www.burndy.com>

COPPER FUSE FOR NETWORK PROTECTOR

ITEM NO: N/A	
CAT. NO: SEE TABLE	
DRAWN BY: PALANI M 11/21/2012	
CHECKER: W ZAHLMAN 7/31/2013	
DSN APRVL: W ZAHLMAN 7/31/2013	
MFG APRVL: --	
QA APRVL: T WATTS 7/30/2013	
MKT APRVL: S MOIST 7/30/2013	
PROD FAM: --	DRAWING NO
PROJECT #: --	50015028
DOCUMENT TYPE: SALES	REV
REL LEVEL: Released	A

SIZE D SHEET 1 OF 1