

CATALOG NO.	STRANDED COPPER CONDUCTOR ACCOMMODATED	BOLT SIZE	BURNDY® INSTALLATION TOOLING (# CRIMPS)								
			COLOR CODE	DIE INDEX	MECHANICAL	HYDRAULIC			DIELESS (# CRIMPS)	WIRE STRIP LENGTH	
					MD6 MD7-34R	BCT500, Y500CT, PAT600	Y35,Y39, Y750, PAT750	Y46 PAT46			Y45
YAZ342TC38FXB	373.7 kcmil 925/24 350 kcmil FLEX 240 mm <sup>2</sup> CLASS 5	1/2 [M12]	BLUE	19 OR 470	7	7	7	7	7	HYDRAULIC: Y644 (1) PAT644 (1) Y81KFT(2) PAT81KFT(2)	2-5/16"
YAZ342NTCFXB					W32VT (4) W32RT (4)	W32VT(4) W32RT(4)	U32RT(4)	U32RT(4)	U32RT(4)		

REV	DATE	DESCRIPTION	ECO	BY	C'H'K.
A	11/28/2012	CREATE SALES DRAWING	29531	MVP	DD

CATALOG NO.	DIMENSIONS								
	B ±.06	C +.04 -.02	E +.04 -.02	K DIA. ±.02	L ±.09	N ±.03	O.D. ±.01	T REF.	Y MIN.
YAZ342TC38FXB	2.48 [63]	1.55 [39]	1.00 [25]	.41 [10]	5.09 [129]	.41 [10]	1.24 [31]	.23 [6]	1.43 [36]
YAZ342NTCFXB			1.75 [45]	.56 [14]	6.27 [159]	.62 [16]			2.40 [61]

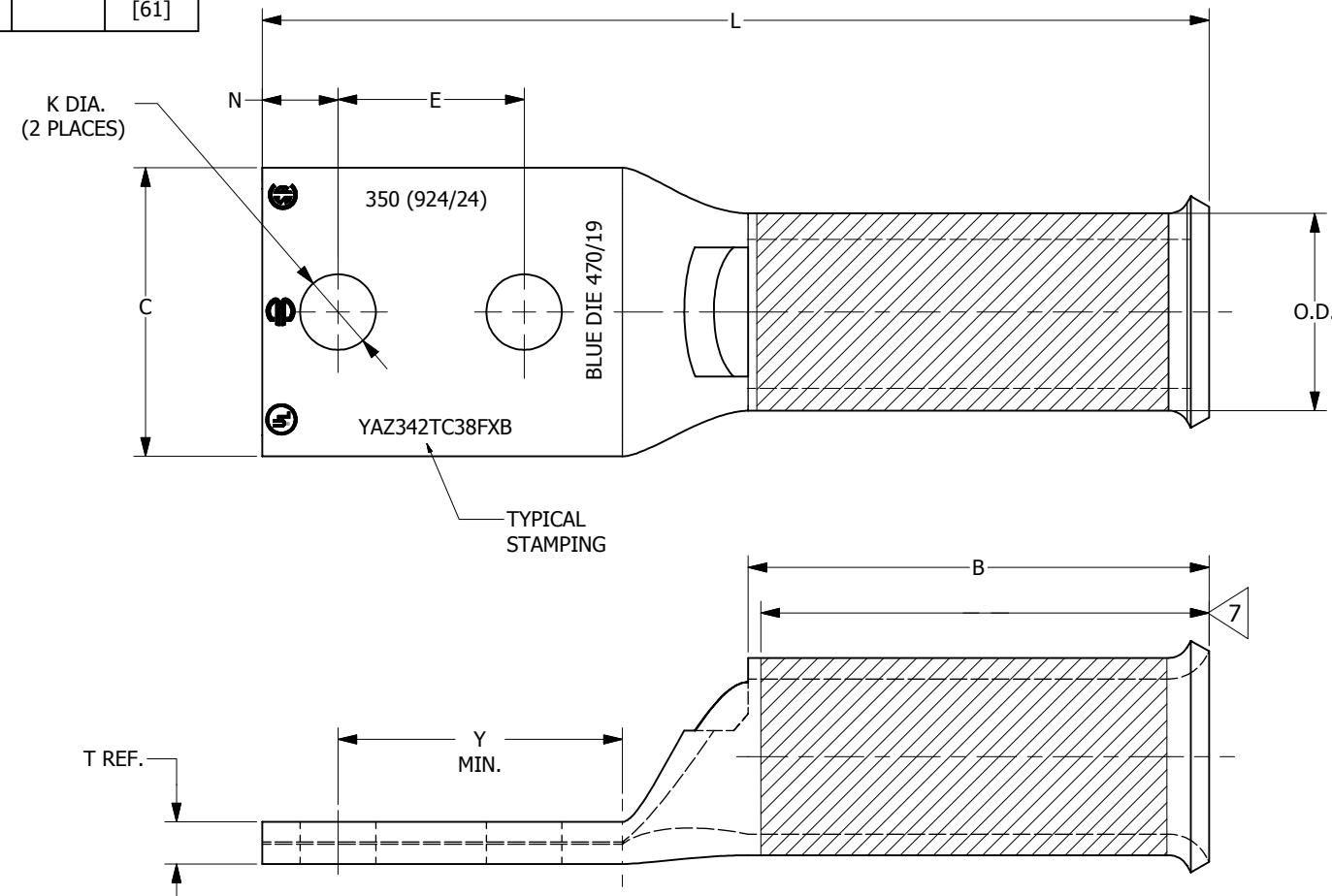

**NOTES:**

1. MATERIAL: COPPER TUBING.
2. FINISH: ELECTRO TIN PLATED.
3. CATALOG # PT6515 ADAPTOR IS REQUIRED TO USE "U" DIES IN Y45 SERIES TOOLS.
4. CATALOG # PUADP-1 ADAPTOR IS REQUIRED TO USE "U" DIES IN Y46 SERIES TOOLS.
5. Y35P3 INDENTOR ADAPTOR REQUIRED FOR Y34PR INDENTOR.
6. DIMENSIONS IN BRACKETS [ ] ARE IN MILLIMETERS ROUNDED OFF TO THE NEAREST MILLIMETER, UNLESS OTHERWISE NOTED, AND ARE FOR REFERENCE ONLY.
7. CRIMP ( # OF CRIMPS PER TABLE ) WITH IN THE LENGTH BETWEEN THE INK STAMPED CRIMPING AREA.
8. UL LISTED AND CSA CERTIFIED WIRE CONNECTORS.

TO ORDER BURNDY® PRODUCTS CALL		HYLUG™	
UNITED STATES 1-800-346-4175 (LONDONDERRY, NH)		ITEM NO: N/A	
CANADA: 1-800-361-6975 (QUEBEC) 1-800-387-6487 (ALL OTHER PROVINCES)		CAT. NO: SEE TABLE	
FOR PRODUCT INFO: <a href="http://www.burndy.com">http://www.burndy.com</a>		DRAWN BY: MVP 11/28/2012	
		CHECKER: --	
		DSN APRVL: --	
		MFG APRVL: --	
		QA APRVL: WATTS 07/26/2013	
		MKT APRVL: MICHAEL 07/31/2013	
		PROD FAM: CM&R COMPRESSION	
		PROJECT #: --	
		SIZE	
		DOCUMENT TYPE: SALES	
		REL LEVEL: Released	
		DRAWING NO	
		50015619	
		SHEET 1 OF 1	
		REV	
		A	