

DRAWING NO.
50064429

7

6

5

4

3

2

1

REV	DATE	DESCRIPTION	ECO	BY	C'H'K.
D	2020-06-25 01:00:00 EDT	MARKING UPDATED	53776	DD	MA

CATALOG NUMBER	COMMERCIAL COPPER CABLE RANGE / GROUND ROD TO COPPER CABLE		METRIC COPPER CABLE RANGE		H	L	Z	INSTALLATION DATA				
	RUN	TAP	RUN	TAP				DIE INDEX NO.	Y750/Y35 Y39 HYPRESS™	Y45 HYPRESS™ ³	Y46 HYPRESS™ ⁴	NO. OF CRIMPS
YGHHC2C2	#6 SOL. (Ø .162) - #2 STR. (Ø .292) 1/4" ROD	#6 SOL. (Ø .162) - #2 STR. (Ø .292)	10 mm (Ø 4.1 mm) 35 mm (Ø 7.6 mm)	10 mm (Ø 4.1 mm) 35 mm (Ø 7.6 mm)	1.16 [30]	.75 [19]	1.88 [48]	C	U-C	U-C	U-C	2
YGHHC26C26	1 STR. (Ø .328) - 2/0 STR. (Ø .419) 3/8" ROD	1 STR. (Ø .328) - 2/0 STR. (Ø .419)	35 mm (Ø 7.6 mm) 70mm (Ø 10.9 mm)	35 mm (Ø 7.6 mm) 70mm (Ø 10.9 mm)	1.54 [39]	.75 [19]	1.88 [48]	0	U-0	U-0	U-0	2
YGHHC29C26	3/0 STR. (Ø .470) - 250 kcmil (Ø .575) 1/2" OR 5/8" ROD	#6 SOL. (Ø .162) - 2/0 STR. (Ø .419)	95 mm (Ø 12.5 mm) 120 mm (Ø 14.4 mm)	10 mm (Ø 4.1 mm) 70 mm (Ø 10.9 mm)	1.97 [50]	.88 [22]	2.13 [54]	997	U997	U997	U997	
YGHHC29C29	3/0 STR. (Ø .470) - 250 kcmil (Ø .575) 1/2" OR 5/8" ROD	3/0 STR. (Ø .470) - 250 kcmil (Ø .575)	95 mm (Ø 12.5 mm) 120 mm (Ø 14.4 mm)	95 mm (Ø 12.5 mm) 120 mm (Ø 14.4 mm)	2.06 [52]			1011	U1011	S1011	P1011	4
YGHHC34C26	300 kcmil (Ø .630) - 500 kcmil (Ø .813) 3/4" ROD	#6 SOL (Ø .162) - 2/0 STR. (Ø .419)	150 mm (Ø 16 mm) 240 mm (Ø 20.3 mm)	10 mm (Ø 4.1 mm) 70 mm (Ø 10.9 mm)	2.39 [61]			1011	U1011	S1011	P1011	4
YGHHC34C29 ⁷	300 kcmil (Ø .630) - 500 kcmil (Ø .813)	3/0 STR. (Ø .470) - 250 kcmil (Ø .575)	150 mm (Ø 16 mm) 240 mm (Ø 20.3 mm)	95 mm (Ø 12.5 mm) 120 mm (Ø 14.4 mm)	2.67 [68]	1011	U1011	S1011	P1011	4		
YGHHC34C34	300 kcmil (Ø .630) - 500 kcmil (Ø .813)	300 kcmil (Ø .630) - 500 kcmil (Ø .813)		150 mm (Ø 16 mm) 240 mm (Ø 20.3 mm)	2.91 [74]					1.10 [28]	2.58 [66]	6

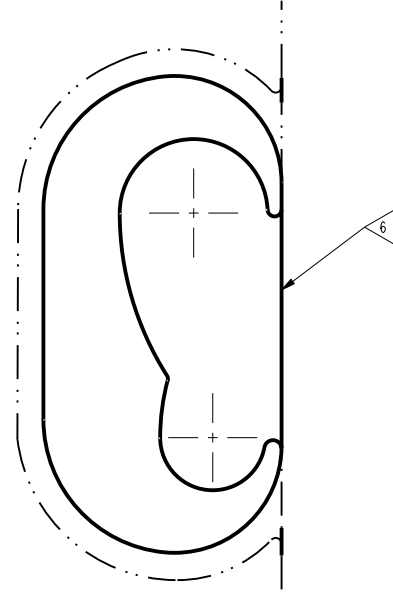
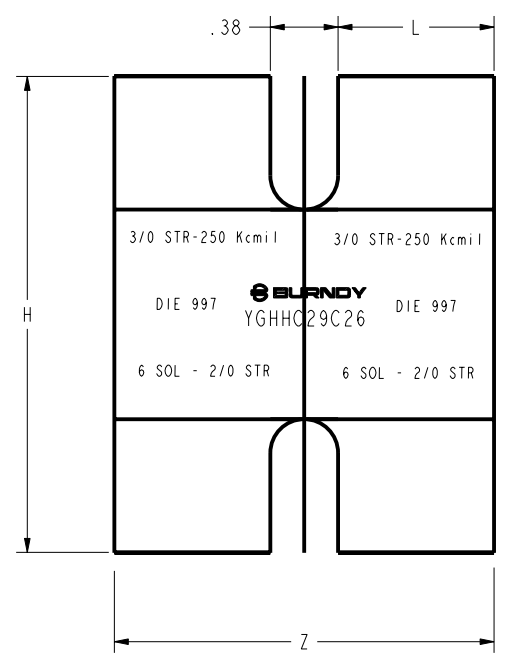

NOTES:

- MATERIAL: COPPER
- GROOVES ARE PREFILLED WITH PENETROX™ "E".
- WHERE A "U" OR "PU" IS RECOMMENDED WITH THE Y45 HYPRESS™, A PT6515 ADAPTER MUST BE USED.
- WHERE A "U" OR "PU" IS RECOMMENDED WITH THE Y46 HYPRESS™, A P-UADP ADAPTER MUST BE USED.
- DIMENSIONS IN BRACKETS [] ARE IN MILLIMETERS.
- CONNECTORS ARE INDIVIDUALLY SEALED IN CLEAR POLYETHELENE SHEET.
- THESE CONNECTORS CAN ONLY BE INSTALLED USING THE Y750. Y45 OR Y46 HYPRESS™ WITH THE RECOMMENDED DIES. THESE CONNECTORS CAN NOT BE INSTALLED WITH THE Y35 AND Y39 HYPRESS™.
- AS A FINAL CHECK AFTER COMPRESSION, BE SURE THE DIE EMBOSSES THE SAME DIE INDEX REFERENCE ON THE FACE OF THE COMPRESSED AREA AS APPEARS ON THE BODY OF THE CONNECTOR.

TO ORDER BURNDY® PRODUCTS CALL		CONNECTOR, COMPRESSION GROUND	
UNITED STATES 1-800-346-4175 (LONDONDERRY, NH)		ITEM NO: N/A	CAT. NO: YGHHC--C (TABLE)
CANADA: 1-800-361-6975 (QUEBEC) 1-800-387-6487 (ALL OTHER PROVINCES)		DRAWN BY: RAAMANATHAN10/26/2015	CHECKER: T. LOGAN 11/16/2015
FOR PRODUCT INFO: http://www.burndy.com		DSN APPVL: T. LOGAN 11/16/2015	MFG APPVL: H. JOE 11/18/2015
		QA APPVL: W. TIMOTHY 11/16/2015	MKT APPVL: T. PETER 11/17/2015
		PROJ #:	SCALE: NTS
		SIZE: D	DRAWING NO: 50064429
		REL LEVEL: Released	REV: D
			SHEET 1 OF 1

REV: PE0200

8

7

6

5

4

3

2

1