

\*\*\* BILL OF MATERIAL \*\*\*

PT NO.	CATALOG NO.	QTY	DESCRIPTION
1	PATCASELI	1	CASE, TOOL PATRIOT LITHIUM-ION
2	BAT18V5AHLI	2	BATTERY, MAKITA 18V LI-ION 5.0 AH MAKITA P/N BL1850B
3	PATCHGRLI	1	CHARGER, BATTERY LITHIUM ION
4	BATCHGRLIOMI	1	BATTERY CHARGER SAFETY OPERATING MAINTENANCE & INSTRUCTIONS
5	PT208620	1	LANYARD
6	PAT600LIOMI	1	SOMI, PAT600LI
7	PT2044380I	1	FIVE YEAR WARRANTY CARD
8	LIMSDS	1	MSDS, LITIUM-ION BATTERY

CATALOG NUMBER	DESCRIPTION	CHARGER CATALOG NO.
PAT600L5	PATRIOT® 600 WITH 120V CHARGER	PATCHGRLI
PAT600L5DC	PATRIOT® 600 WITH 12V CHARGER	PATCHGRLIDC
PAT600CL5	PATRIOT® 600 COVERED HEAD WITH 120V CHARGER	PATCHGRLI

SPECIFICATIONS:

OUTPUT FORCE: 6 TONS (5.4 METRIC TONS)  
 TOOL WEIGHT WITH BATTERY: 10.1 LBS (4.5 kg)  
 LENGTH: 14.5 IN (36.8 cm)  
 WIDTH: 3.5 IN (8.9 cm)  
 HEIGHT: 13.7 IN (34.9 cm)  
 OPERATING VOLTAGE: 18V-DC  
 RECHARGE TIME: 45 MINUTES

FOR USE ON:

COPPER: #8 - 600 kcmil      TERMINALS: YA, YA-L  
 SPLICES: YS, YS-L, YS-T, YS-R  
 COPPER FLEX: #8 - 350 kcmil      TERMINALS: YA-FX, YAV, YA-L-FX  
 SPLICES: YS, YSV-FXB  
 ALUMINUM: #8 - 350 kcmil      TERMINALS: YA-A, YA-A-TN  
 SPLICES: YS-A

FEATURES AND BENEFITS

- REFINED HYDRAULIC SYSTEM FOR ULTRA PERFORMANCE, SPEED AND RELIABILITY.
- FIELD PROVEN ELECTRONICS FOR ULTIMATE RELIABILITY IN THE HARSHTEST ENVIRONMENTS.
- OVERMOLDED HANDLE FOR COMFORT AND IMPROVED GRIP; ALLOWS FOR ONE HANDED OPERATION FOR ADVANCE RETRACT AND HOLD.
- MAKITA 18 VOLT LITHIUM-ION BATTERIES PROVIDE 2.5 TIMES MORE CHARGE/DISCHARGE CYCLES THAN TRADITIONAL Ni-Cd BATTERIES AND PROVIDE 430% MORE LIFETIME WORK.
- MAKITA CHARGER CONTROLS CURRENT, VOLTAGE AND TEMPERATURE TO MAXIMIZE BATTERY LIFE.
- FORCED AIR COOLING FAN COOLS THE BATTERY BY FORCING COOL AIR THROUGH THE BATTERY'S BUILT IN AIR VENTS.
- SPECIALIZED LATCH HEAD DESIGN ALLOWS INTERFERENCE FREE CLOSURE ON TAP CONNECTORS.
- PERMANENT "D3" CRIMP GROOVE ACCEPTS "W", "X" AND "W-VT" DIES.
- PAT600C-LI WITH COVERED HEAD IS AVAILABLE.
- STATE OF THE ART CRIMPING HEAD DESIGN, 180° HEAD ROTATION LETS USER GET INTO TIGHT AREAS EASIER.
- ERGONOMICALLY BALANCED TOOL DESIGN EASES OPERATION AND HELPS LESSEN FATIGUE.
- DURABLE HIGH IMPACT FORMED CARRYING CASE PROVIDES SUPERIOR PROTECTION AND STORES ALL ACCESSORIES.
- 5 YEAR LIMITED WARRANTY ON THE TOOL.
- LIFETIME WARRANTY ON INFINITY DRIVE®.
- 3 YEAR LIMITED WARRANTY ON THE BATTERIES AND CHARGER.

REV.	DATE	DESCRIPTION	ECO	BY	C'H'K.
B	2018-08-27 00:00:00 EDT	UPDATED AS PER MARKUP	49728	RS	RM

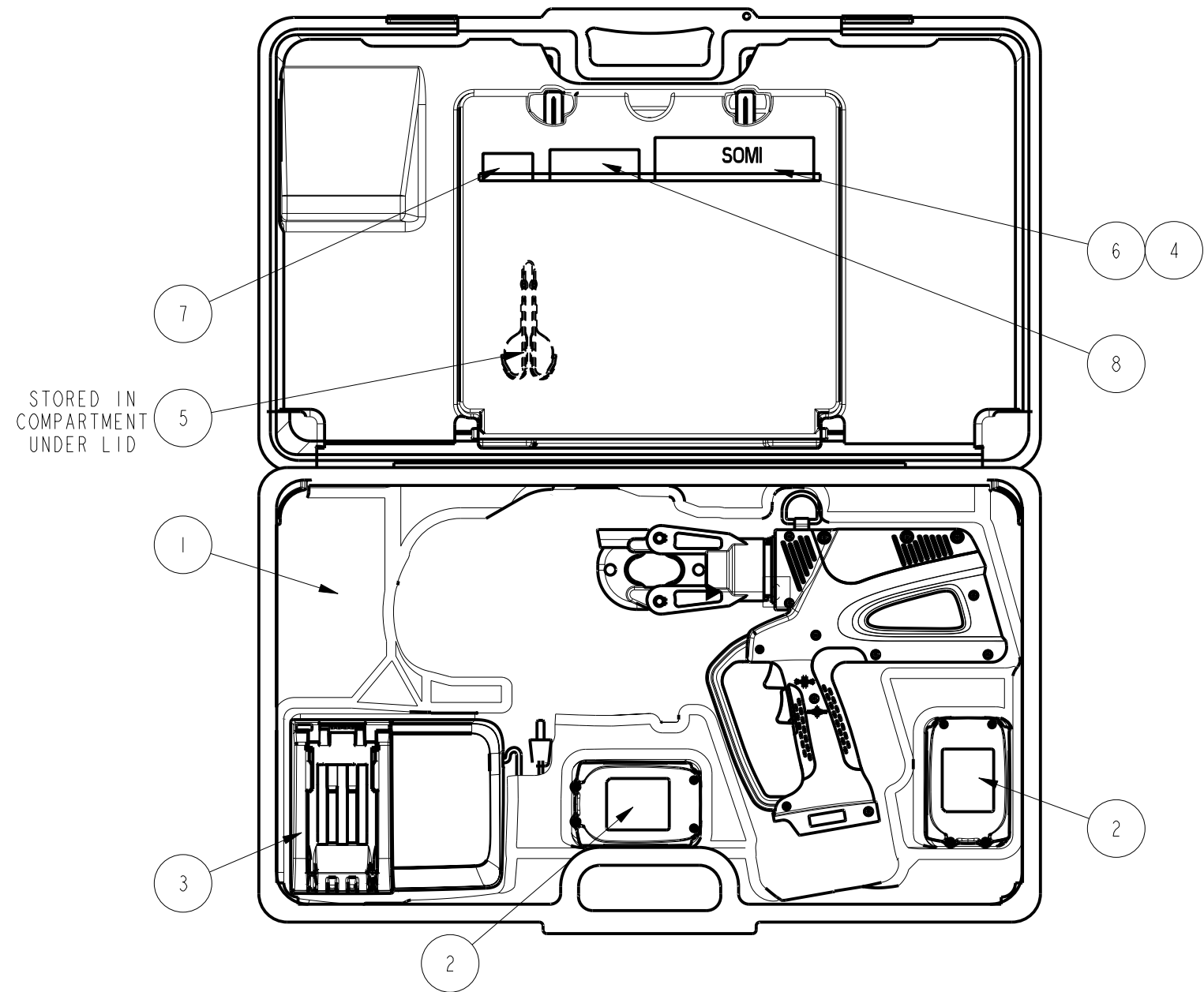

NOTES:

1. TOOL ACCEPTS 18V MAKITA LITHIUM ION BATTERIES, BL SERIES OF SIZE 2.0 AHR AND GREATER IF THE PLASTIC BATTERY CLIP IN THE TOOL HAS A "STAR" MOLDED INTO IT. THE "STAR" IDENTIFIES ACCEPTANCE OF THE BL SERIES BATTERIES.
2. FOR TOOLS WHICH DO NOT A "STAR" MOLDED INTO THE PLASTIC BATTERY CLIP, USE IS LIMITED TO THE BL 1830 (3.0AHR) BATTERY. FORCING ANY OTHER BATTERY INTO THIS TOOL WILL VOID THE WARRANTY.



REV: PE0200

TO ORDER BURNDY® PRODUCTS CALL		PATRIOT® 6 TON BATTERY CRIMPING TOOL	
UNITED STATES:		ITEM NO: 50068030	
1-800-346-4175 (LONDONDERRY, NH)		CAT. NO: DRAWASMS	
CANADA:		DRAWN BY: T. FAUCHER 08/17/2016	
1-800-361-6975 (QUEBEC)		CHECKER: M. CHIASSON 08/16/2016	
1-800-387-6487 (ALL OTHER PROVINCES)		DSN APPVL: M. CHIASSON 08/19/2016	
FOR PRODUCT INFO: <a href="http://www.burndy.com">http://www.burndy.com</a>		MFG APPVL: C. TORREY 08/19/2016	
		QA APPVL: C. LINDQUIST 08/19/2016	
		MKT APPVL: P. SILVA 08/19/2016	
		SCALE: 1:4	
		PROJECT #: --	
		DRAWING NO	
		50068032	
		REV	
		B	
		SHEET 1 OF 1	

