

BURNDY® PRODUCTS - HYLUG™ & HARDWARE

ITEM NUMBER	CATALOG NUMBER	FIG NO	ACCOMMODATES ACCC® CONDUCTOR		CONTAINS HARDWARE KIT CAT #	CTC NUMBER	DIMENSIONS						INSTALLATION TOOLING (NOT INCLUDED) TOOLS, DIE SETS				APPROXIMATE WEIGHT LBS.	
			CODE WORD	SIZE			C	D	L	N	O.D.	I.D.	T	DIE INDEX	Y45	Y46		Y60
10093852	BYNA32RTHACCC	1	COPENHAGEN	230 mm ²	TMH24	600-153-1-0D	3.25	4.50	15.5	1.12	1.19	.80	.50	717	S717	P717	L717W	--
10093851	BYNA32RTACCC				--		[82]	[114]	[393]	[29]	[30]	[20]	[13]					

REV	DATE	DESCRIPTION	ECO	BY	C'H'K.
A	02/23/2016 00:00:00 AM	NEW DRAWING CREATED	42864	CV	MB

CATALOG NO. TMH24 HARDWARE KIT CONSIST OF	
QTY.	DESCRIPTION
4	BOLT, HEX HEAD 1/2"-13 X 2" LONG
4	HEX NUT, 1/2"-13
4	FLAT WASHER 1/2"
4	RESILIENT WASHER 1/2"

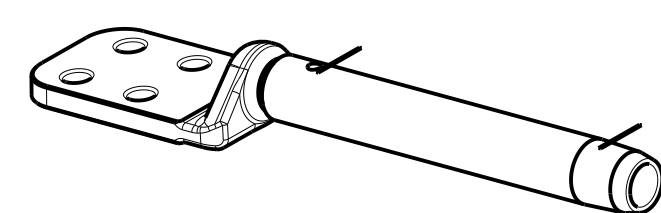
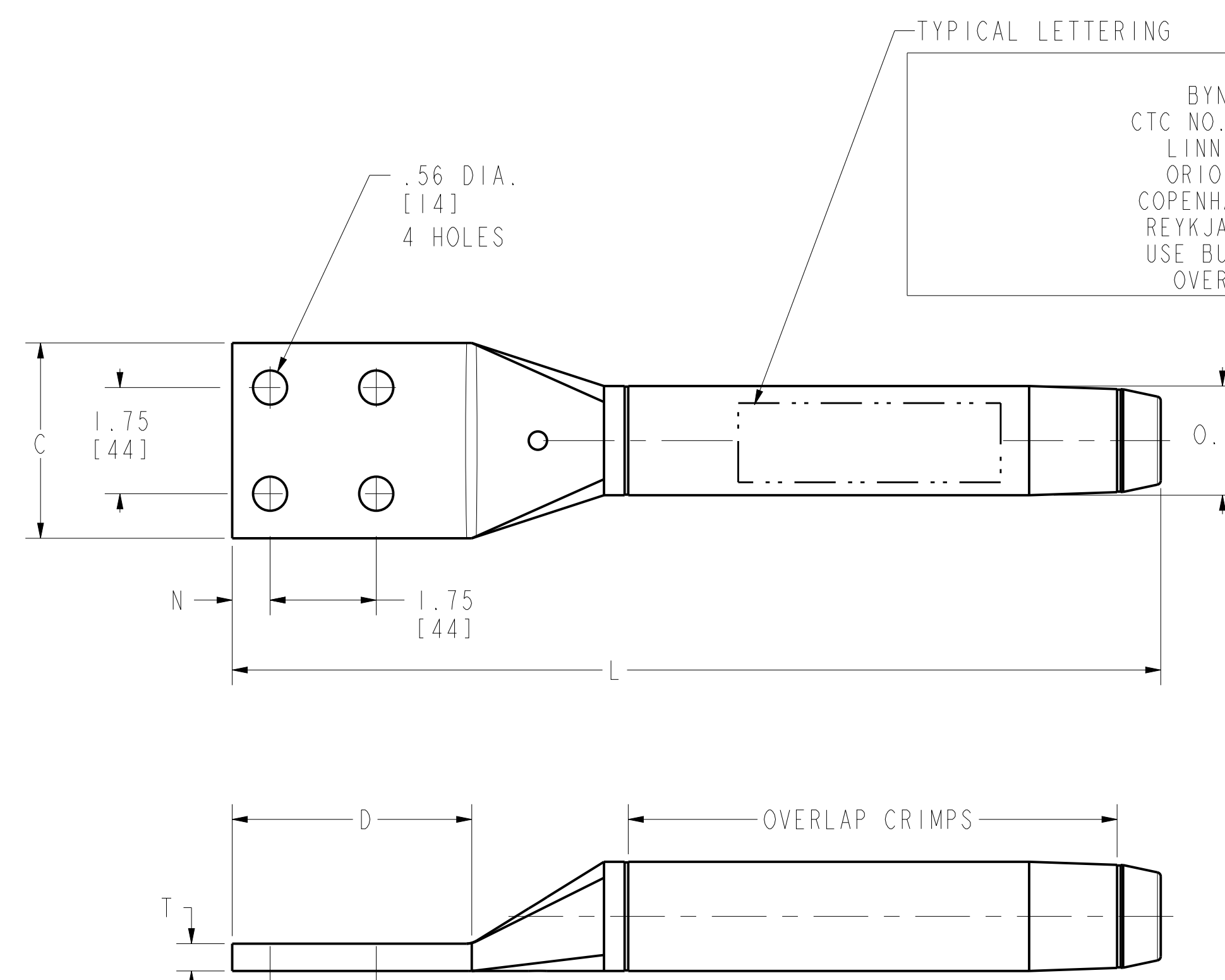

FIGURE 1
3D VIEW
SCALE 1:4



TYPICAL LETTERING
 BURNDY
 BYNA32RTACCC
 CTC NO. 600-153-1-0D
 LINNET 431 ACCC
 ORIOLE 438 ACCC
 COPENHAGEN 230 ACCC
 REYKJAVIK 235 ACCC
 USE BURNDY DIE 717
 OVERLAP CRIMPS

NOTES:

- MATERIAL:
 - CONNECTOR, ALUMINUM ALLOY, NO-OX-ID COATED
 - ALUMINUM FILLER PLUG
 - TMH24 HARDWARE
 - BOLTS, NUTS AND FLAT WASHERS, ALUMINUM ALLOY
 - RESILIENT WASHERS, GALVANIZED STEEL
- DIMENSIONS IN BRACKETS [] ARE IN MILLIMETERS ROUNDED OFF TO THE NEAREST MILLIMETER, UNLESS OTHERWISE SPECIFIED AND ARE FOR REFERENCE ONLY.
- DESIGNED FOR CORONA FREE OPERATION TO 230 KV NO ACCESSORIES REQUIRED.
- CONNECTOR SHALL BE SHIPPED UN-ASSEMBLED.

- RECOMMENDED TIGHTENING TORQUE: 1/2-13 ALUMINUM HARDWARE: 300 LBS-IN [34NM]
- CATALOG NUMBER FOR HYLUG™ WITHOUT HARDWARE ARE CATALOG NUMBERS WITHOUT "H".
- REFERENCE: 10092621, CONNECTOR INSTALLATION

COMPRESSION TERMINAL CONNECTOR FOR
(ACCC®) ALUMINUM CONDUCTOR COMPOSITE CORE

TO ORDER BURNDY® PRODUCTS CALL		0 DEG HYLUG™ & HARDWARE	
UNITED STATES 1-800-346-4175 (LONDONDERRY, NH)		ITEM NO: SEE TABLE	CAT. NO: SEE TABLE
CANADA: 1-800-361-6975 (QUEBEC) 1-800-387-6487 (ALL OTHER PROVINCES)		DRAWN BY: VIMAL C 02/23/16	CHECKER: MANIKANDAN B 02/23/16
FOR PRODUCT INFO: http://www.burndy.com		DSN APPVL: P CHAN 02/08/16	MFG APPVL: --
		GA APPVL: KOWALCZYK C 02/10/16	MKT APPVL: B CRUTCHER 02/09/16
		PROD FAM: Transmission/YNA	DRAWING NO: 50068175
		PROJECT #: --	SCALE: 1:2
		DOCUMENT TYPE: Sales	SHEET 1 OF 1
		REL LEVEL: In Work	

