

COPPER CONDUCTOR SIZE (SOL. & STR.)	INSTALLATION TOOLS, DIE SET CAT. NO. AND (# OF CRIMPS)		STUD SIZE	DIMENSIONS				
	MECHANICAL	HYDRAULIC		B MIN.	C ± .08	L ± .12	O.D.	T REF.
				Y35/Y39/Y45 \triangleleft 3 4 Y46/Y750/PAT750				
1/0 STR (.372 DIA.)	W25VT (4) X25RT (4)	U25RT (2)	1/2	1.38 [34]	.83 [21]	3.05 [78]	.51 [13]	.11 [3]

REV	DATE	DESCRIPTION	ECO	BY	C'H'K.
A	06/01/2018	FOCUS REQUEST FPN1805029	49140	PP	VS

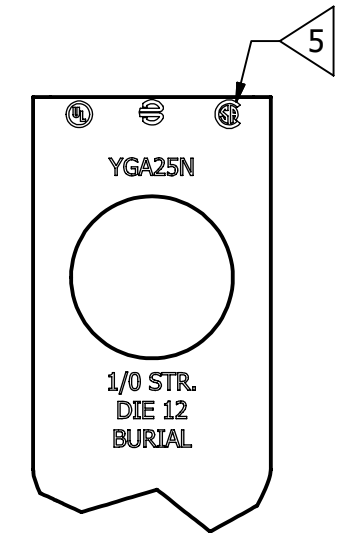

TYPICAL LETTERING

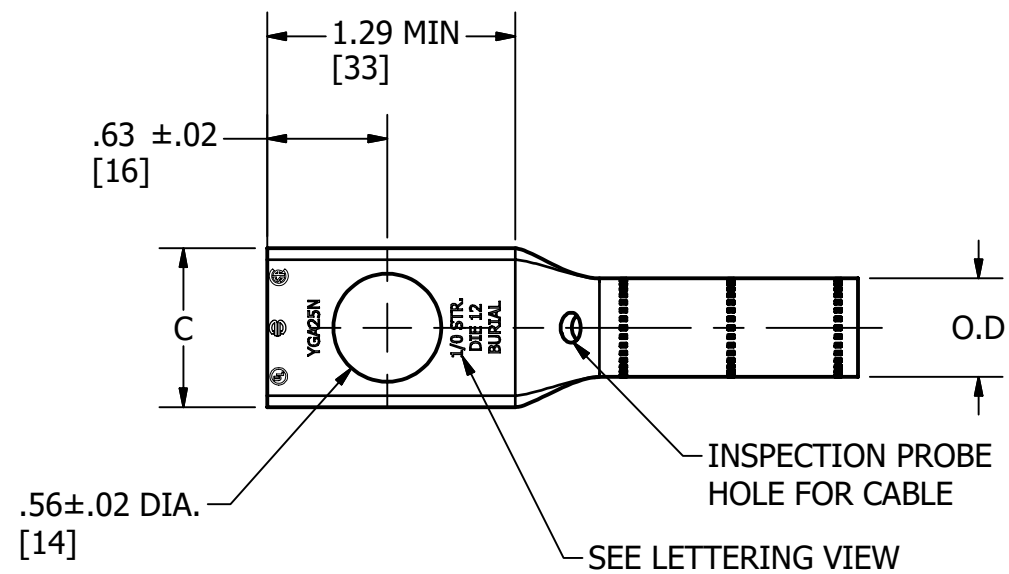
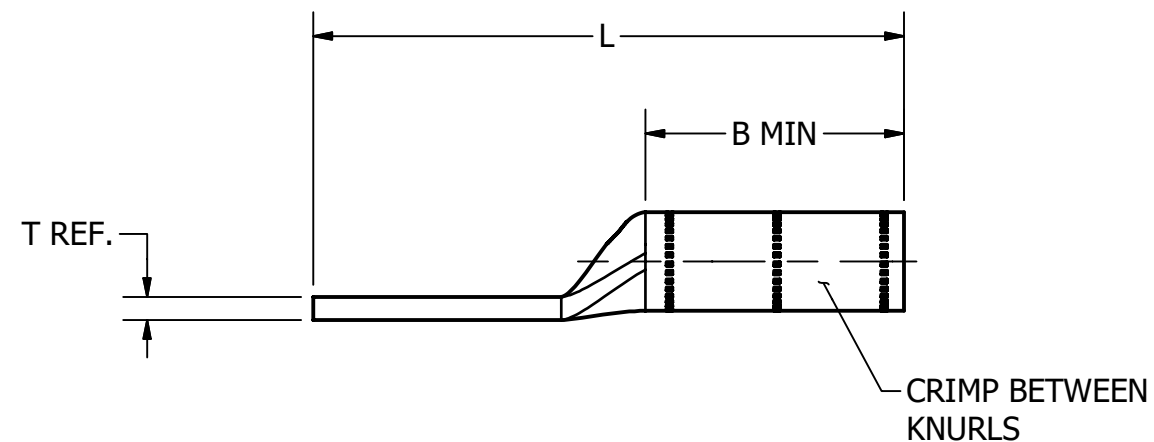

NOTES:

1. MATERIAL: COPPER
2. BARREL IS PREFILLED WITH PENETROX™ "E" AND INDIVIDUALLY SEALED.
3. WHERE A "U" OR "PU" IS RECOMMENDED WITH THE Y45 HYPRESS, A PT6515 ADAPTER MUST BE USED.
4. WHERE A "U" OR "PU" IS RECOMMENDED WITH THE Y46 HYPRESS, A PUADP-1 ADAPTER MUST BE USED.
5. UL & CSA CERTIFIED PRODUCTS ARE SUITABLE FOR DIRECT BURIAL IN EARTH OR CONCRETE.
6. DIMENSIONS IN BRACKETS [] ARE IN MILLIMETERS ROUNDED OFF TO THE NEAREST MILLIMETER, UNLESS OTHERWISE NOTED.
7. FOR TIN PLATING ADD SUFFIX -TN TO CAT NO.

TO ORDER BURNDY® PRODUCTS CALL		HYLUG™	
UNITED STATES 1-800-346-4175 (LONDONDERRY, NH)		ITEM NO: 25018960	
CANADA: 1-800-361-6975 (QUEBEC) 1-800-387-6487 (ALL OTHER PROVINCES)		CAT. NO: YGA25N	
FOR PRODUCT INFO: http://www.burndy.com		DRAWN BY: P.PRASANTH 03/15/2018	
		CHECKER: S.VENKATESAN 03/15/2018	
		DSN APRVL: J.MICHAUD 06/07/2018	
		MFG APRVL: --	
		QA APRVL: T.WATTS 06/07/2018	
		MKT APRVL: --	
		PROD FAM: --	
		DRAWING NO	
		50090245	
		REV	
		A	
		SHEET 1 OF 1	