

AWG WIRE SIZE (METRIC SIZE)	STUD SIZE	CATALOG NUMBER	BULK CATALOG NUMBER	TAPE MOUNTED CATALOG NUMBER 2000/REEL	C		K		L MAX.	N		T ± .01 [± .25]	Y MAX.	Z MIN.	MAX. WIRE INSUL. DIA. ACCOM.	WIRE STRIP LENGTH ± .03 [± .8]	COLOR CODE	INSTALLATION TOOLING (ONE CRIMP)
					MAX.	MIN.	MAX.	MIN.		MAX.	MIN.							
22-16 Str. and Sol. (0.34 mm ² - 1.00 mm ²)	2	TP162F	BA16EF2	BA16EF2M	.18 [4.5]	.17 [4.2]	.10 [2.5]	.09 [2.3]	.75 [19.0]	.10 [2.4]	.08 [2.2]	.03 [.8]	.66 [16.8]	.23 [5.8]	.14 [3.6]	RED	Y6NCB [J1022NC4], MRE1022NV, MR15 (Wire range is No. 22-18 stranded or solid when crimped with the MR15.)	
	6	TP166F	BA16EF6	BA16EF6M	.28 [7.2]	.28 [7.0]	.15 [3.8]	.14 [3.6]	.80 [20.3]	.14 [3.6]	.13 [3.4]							
	8	TP168F	BA16EF8	BA16EF8M	.32 [8.1]	.31 [7.8]	.18 [4.5]	.16 [4.1]	.86 [21.8]	.17 [4.4]	.16 [4.2]							
	10	TP1610F	BA16EF10	BA16EF10M	.41 [10.5]	.40 [10.2]	.23 [5.8]	.19 [4.8]	.95 [24.1]	.20 [5.1]	.19 [4.9]							
16-14 Str. and Sol. (1.50 mm ²)	2	TP142F	BA14EF2	-	.18 [4.5]	.17 [4.2]	.10 [2.5]	.09 [2.3]	.75 [19.0]	.10 [2.4]	.08 [2.2]	.03 [.8]	.66 [16.8]	.23 [5.8]	.18 [4.6]	BLUE	Y6NCB [J1022NC4], MRE1022NV, MR15	
	6	TP146F	BA14EF6	-	.28 [7.2]	.28 [7.0]	.15 [3.8]	.14 [3.6]	.80 [20.3]	.14 [3.6]	.13 [3.4]							
	8	TP148F	BA14EF8	BA14EF8M	.32 [8.1]	.31 [7.8]	.18 [4.5]	.16 [4.1]	.86 [21.8]	.17 [4.4]	.16 [4.2]							
	10	TP1410F	BA14EF10	BA14EF10M	.41 [10.5]	.40 [10.2]	.23 [5.8]	.19 [4.8]	.95 [24.1]	.20 [5.1]	.19 [4.9]							
12-10 Str. (4.00 mm ²)	6	TP106F	BA10EF6	BA10EF6M	.28 [7.2]	.28 [7.0]	.15 [3.8]	.14 [3.6]	.95 [24.1]	.14 [3.6]	.13 [3.4]	.04 [1.0]	.81 [20.6]	.26 [6.6]	.26 [6.6]	11/32" [8.7]	YELLOW	
	8	TP108F	BA10EF8	BA10EF8M	.32 [8.1]	.31 [7.8]	.18 [4.5]	.16 [4.1]	.98 [24.9]	.18 [4.4]	.16 [4.2]							
	10	TP1010F	BA10EF10	BA10EF10M	.41 [10.5]	.40 [10.2]	.23 [5.8]	.19 [4.8]	1.07 [27.2]	.20 [5.1]	.19 [4.9]							

REV	DATE	DESCRIPTION	ECO	BY	C'H'K.
C	07/27/2020	METRIC WIRE SIZE ADDED IN TABLE	53947	SS	YR

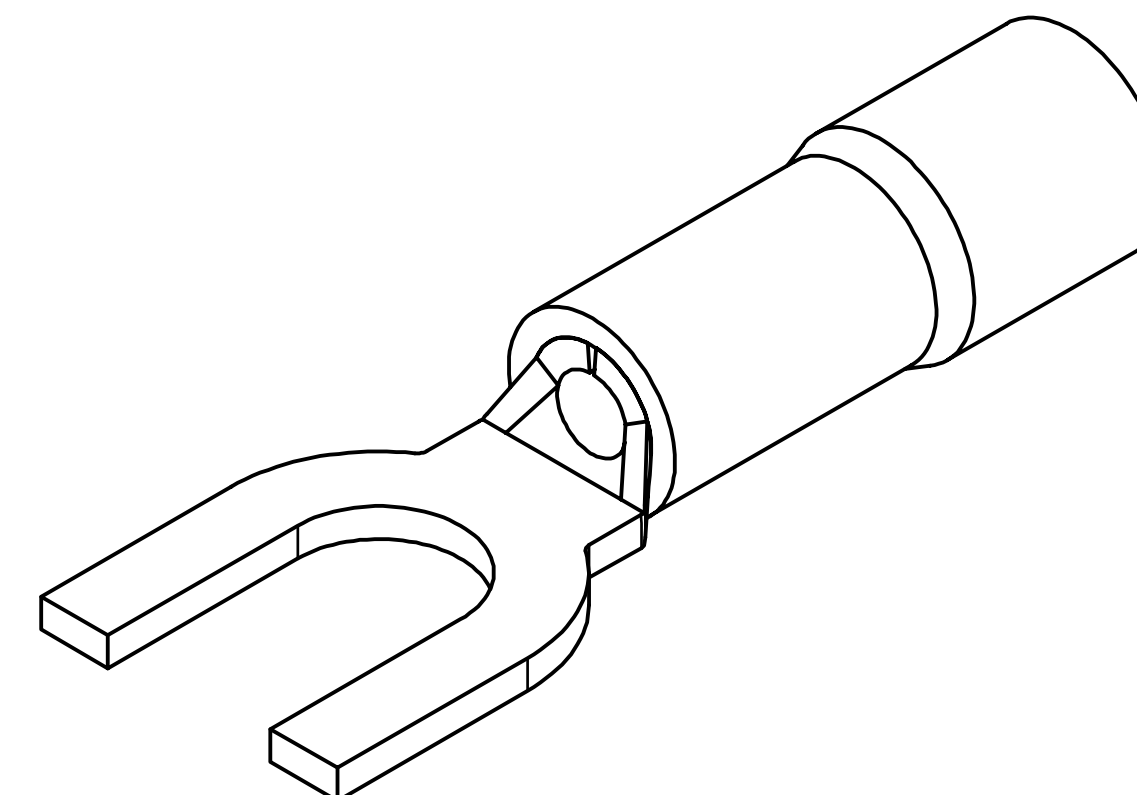
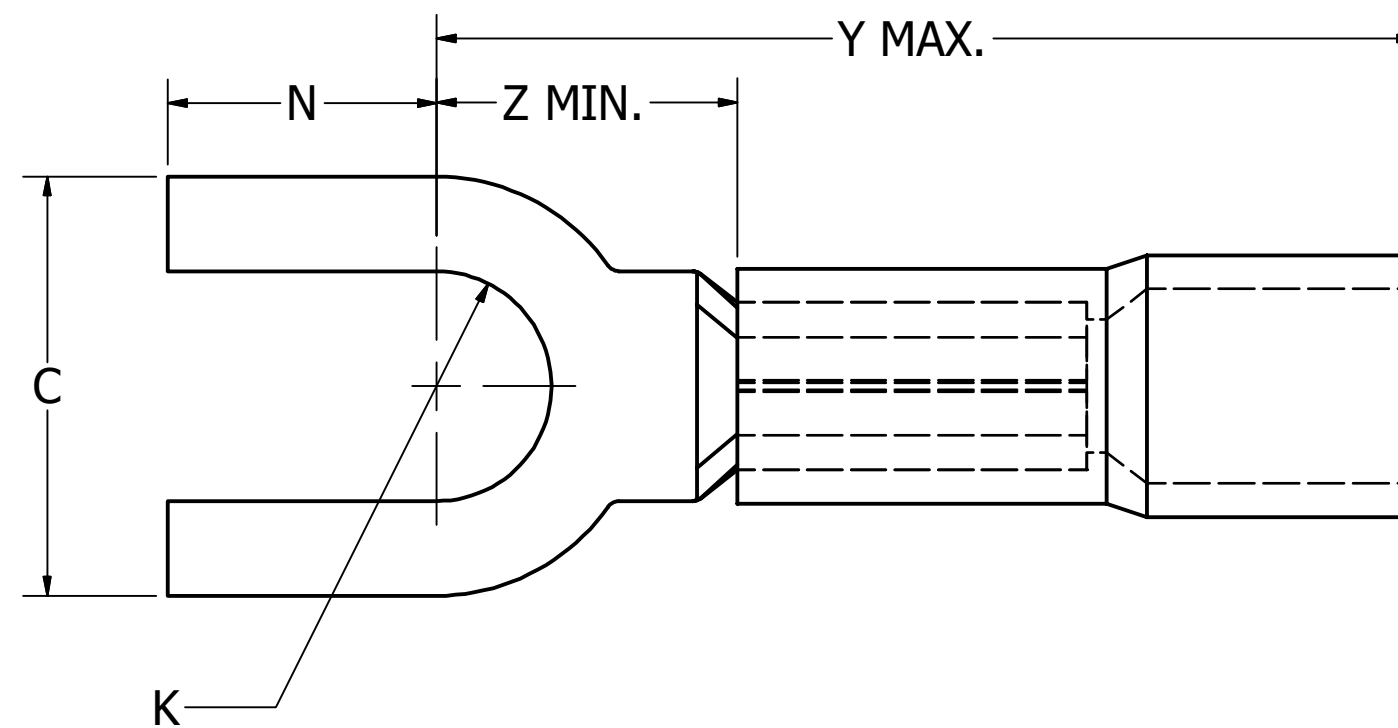
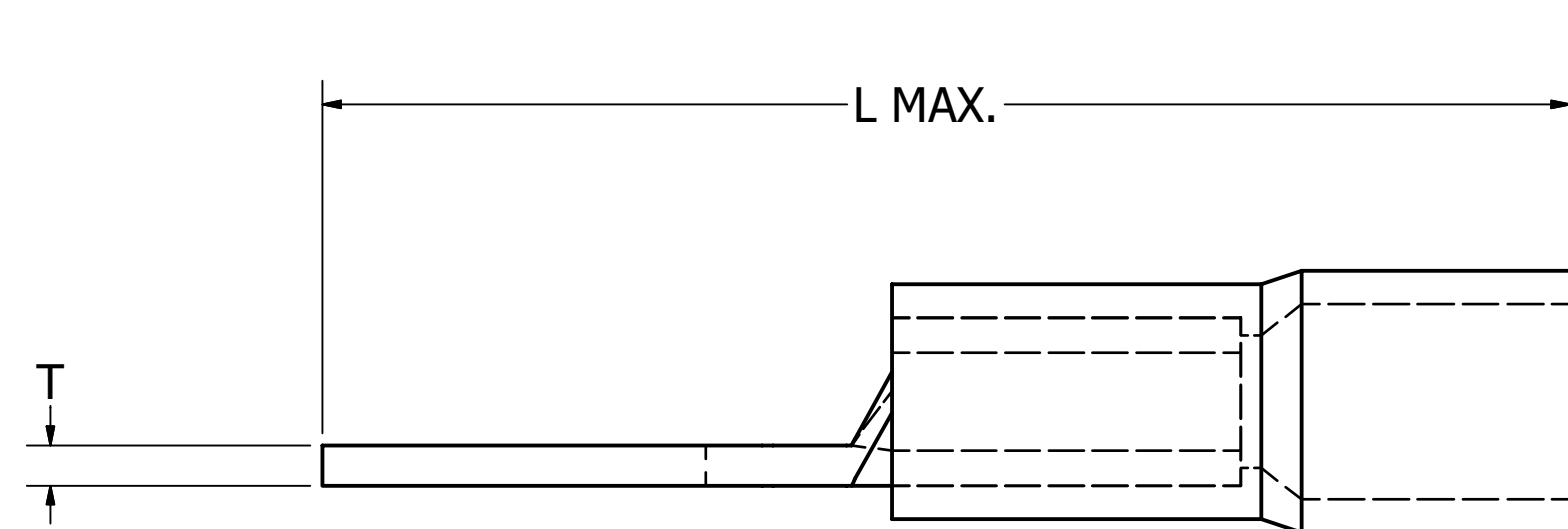

- NOTES:
1. TERMINAL: TIN PLATED COPPER.
 2. INSULATION: POLYVINYLCHLORIDE.
 3. DIMENSIONS IN BRACKETS [] ARE IN MILLIMETERS AND ARE FOR REFERENCE ONLY.
 4. DIE SETS ARE LISTED IN BRACKETS [] AFTER THEIR RESPECTIVE TOOLS.
 5. FOR CONNECTORS MOUNTED ON MYLAR USE INSTALLATION TOOL OEM175TFM:
USE DIE SET TFM2218NV FOR WIRE SIZE 22-18.
USE DIE SET TFM1614NV FOR WIRE SIZE 16-14.
USE DIE SET TFM1210NV FOR WIRE SIZE 12-10.
 6. REFERENCE DRAWING 50105269 FOR MORE INFORMATION ABOUT TAPE MOUNTED TERMINALS.
 7. UL LISTED & CSA CERTIFIED WIRE CONNECTORS PER UL486A/B (FILE E9498) & CSA C22.2 NO.65 REQUIREMENTS (FILE 42862).
 8. DISCONTINUED TOOLS: Y6NCP, Y10MRS, Y10MRPA, PATMD1022LI, MR889, MR8891, Y1022HYTOOL, INSY10D
CONTACT TECH SERVICE FOR INFORMATION ABOUT APPROVED APPLICATIONS (1-800-451-4956).
 9. WIRE CONNECTOR:
600V MAXIMUM
BUILDING WIRE: 1000V MAXIMUM, SIGNS OR LUMINARIES
TEMPERATURE RATING OF INSULATING MATERIAL 105°C
FLAME RATING: UL94 V-0.

10. BULK CATALOG NUMBERS ARE ONLY UL LISTED AND CSA CERTIFIED WHEN CRIMPED WITH THE MR15.

TO ORDER BURNDY® PRODUCTS CALL		VINYLUG	
UNITED STATES 1-800-346-4175 (LONDONDERRY, NH)		ITEM NO: SEE TABLE	
CANADA: 1-800-361-6975 (QUEBEC) 1-800-387-6487 (ALL OTHER PROVINCES)		CAT. NO: TYPE TP-F & BA-EF	
FOR PRODUCT INFO: http://www.burndy.com		DRAWN BY: RBABU 10/3/2018 CHECKER: V.SAKTHIVEL 10/3/2018 DSN APRVL: K.CASTONGUAY 10/16/2018 MFG APRVL: -- QA APRVL: B.POST 10/5/2018 MKT APRVL: M.BAILLY 10/9/2018 PROD FAM: --	
		PROJECT #: -- SIZE DOCUMENT TYPE: SALES REL LEVEL: Released	
		C	