

REV	DATE	DESCRIPTION	ECO	BY	CHK.
A	08/21/2018	NEW DRAWING CREATION	49775	WP	VS

WIRE SIZE (AWG)	STUD SIZE	CATALOG NUMBER	BULK CATALOG NUMBER	C		K		L MAX.	N		T ± .01 [± 0.25]	Y MAX.	Z MIN.	MAX. WIRE INSUL. DIA. ACCOM.	WIRE STRIP LENGTH ± .03 [ ± .8]	COLOR CODE	INSTALLATION TOOLING (ONE CRIMP)
				MAX.	MIN.	MAX.	MIN.		MAX.	MIN.							
22-16 Str. and Sol.	2	TP162Z	BA16EZ2	.18 [4.5]	.17 [4.2]	.10 [2.5]	.09 [2.3]	.78 [19.8]	.12 [3.2]	.12 [2.9]	.03 [.8]	.66 [16.8]	.23 [5.8]	.14 [3.7]	1/4" [6.4]	RED	Y6NCB [J1022NC4], MRE1022NV, MR15  (Wire range is No. 22-18 stranded or solid when crimped with the MR15.)
	6	TP166Z	BA16EZ6	.28 [7.2]	.28 [7.0]	.15 [3.8]	.14 [3.6]	.83 [21.1]	.17 [4.3]	.16 [4.1]							
	8	TP168Z	BA16EZ8	.32 [8.1]	.31 [7.8]	.18 [4.5]	.16 [4.1]	.88 [22.4]	.20 [5.0]	.18 [4.7]							
	10	TP1610Z	BA16EZ10	.41 [10.5]	.40 [10.2]	.23 [5.8]	.19 [4.8]	.96 [24.4]	.22 [5.5]	.20 [5.2]							
—	—	BA16EZ10T1	.36 [9.3]	.36 [9.0]													
16-14 Str. and Sol.	2	TP142Z	BA14EZ2	.18 [4.5]	.17 [4.2]	.10 [2.5]	.09 [2.3]	.78 [19.8]	.12 [3.2]	.12 [2.9]	.03 [.8]	.66 [16.8]	.23 [5.8]	.18 [4.6]	BLUE	Y6NCB [J1022NC4], MRE1022NV, MR15	
	6	TP146Z	BA14EZ6	.28 [7.2]	.28 [7.0]	.15 [3.8]	.14 [3.6]	.83 [21.1]	.17 [4.3]	.16 [4.1]							
	8	TP148Z	BA14EZ8	.32 [8.1]	.31 [7.8]	.18 [4.5]	.16 [4.1]	.88 [22.4]	.20 [5.0]	.18 [4.7]							
	10	TP1410Z	BA14EZ10	.41 [10.5]	.40 [10.2]	.23 [5.8]	.19 [4.8]	.96 [24.4]	.22 [5.5]	.20 [5.2]							
—	—	BA14EZ10T1	.36 [9.3]	.36 [9.0]													
12-10 Str.	6	TP106Z	BA10EZ6	.28 [7.2]	.28 [7.0]	.15 [3.8]	.14 [3.6]	.99 [25.2]	.18 [4.6]	.17 [4.3]	.04 [1.0]	.81 [20.6]	.26 [6.6]	11/32" [8.7]	YELLOW		
	8	TP108Z	BA10EZ8	.32 [8.1]	.31 [7.8]	.18 [4.5]	.16 [4.1]	1.01 [25.6]	.20 [5.1]	.19 [4.8]							
	10	TP1010Z	BA10EZ10	.41 [10.5]	.40 [10.2]	.23 [5.8]	.19 [4.8]	1.09 [27.7]	.22 [5.6]	.21 [5.4]							
	—	—	BA10EZ10T1	.36 [9.3]	.36 [9.0]												

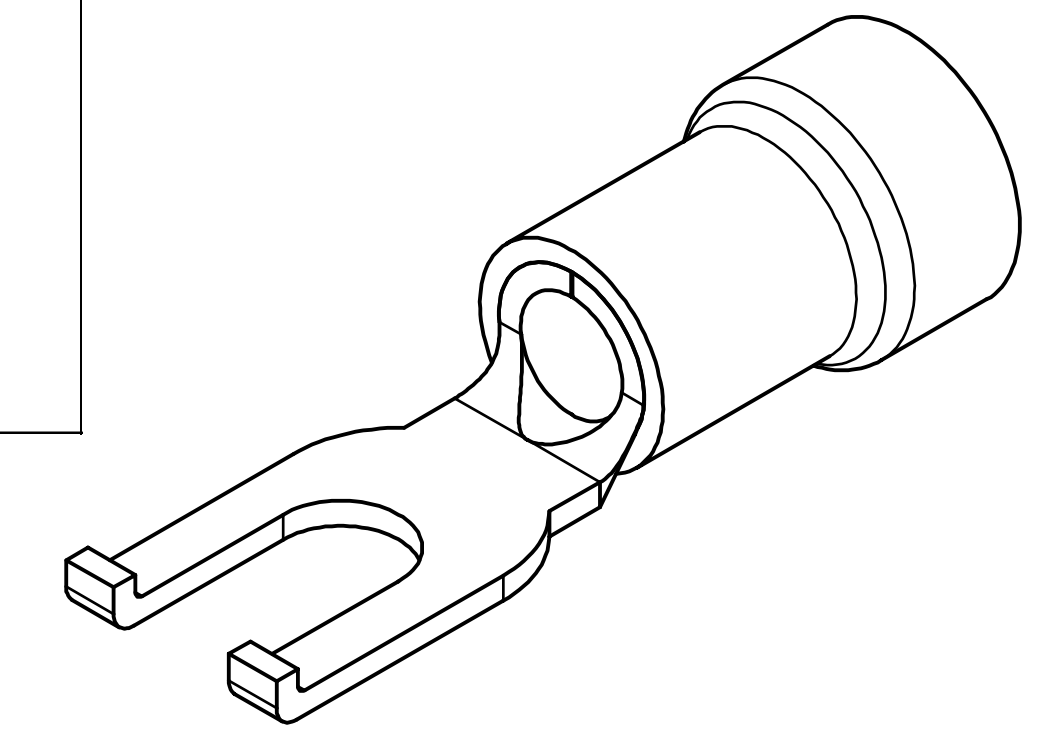

- NOTES:
1. TERMINAL: TIN PLATED COPPER
  2. INSULATION: POLYVINYL CHLORIDE
  3. DIMENSIONS IN BRACKETS [ ] ARE IN MILLIMETERS AND ARE FOR REFERENCE ONLY.
  4. DIE SETS ARE LISTED IN BRACKETS [ ] AFTER THEIR RESPECTIVE TOOLS.
  5. UL LISTED & CSA CERTIFIED WIRE CONNECTORS PER UL486A/B (FILE E9498) & CSA 22.2 NO.65 REQUIREMENTS (FILE 42862)
  6. DISCONTINUED TOOLS: Y6NCP, Y10MRSA, Y10MRPA, PATMD1022LI, MR889, MR8891, Y1022HYTOOL, INSY10D  
CONTACT TECH SERVICE FOR INFORMATION ABOUT APPROVED APPLICATIONS (1-800-451-4956)
  7. WIRE CONNECTOR:  
600V MAXIMUM  
BUILDING WIRE: 1000V MAXIMUM, SIGNS OR LUMINARIES  
TEMPERATURE RATING OF INSULATING MATERIAL 105°C  
FLAME RATING: UL94 V-0

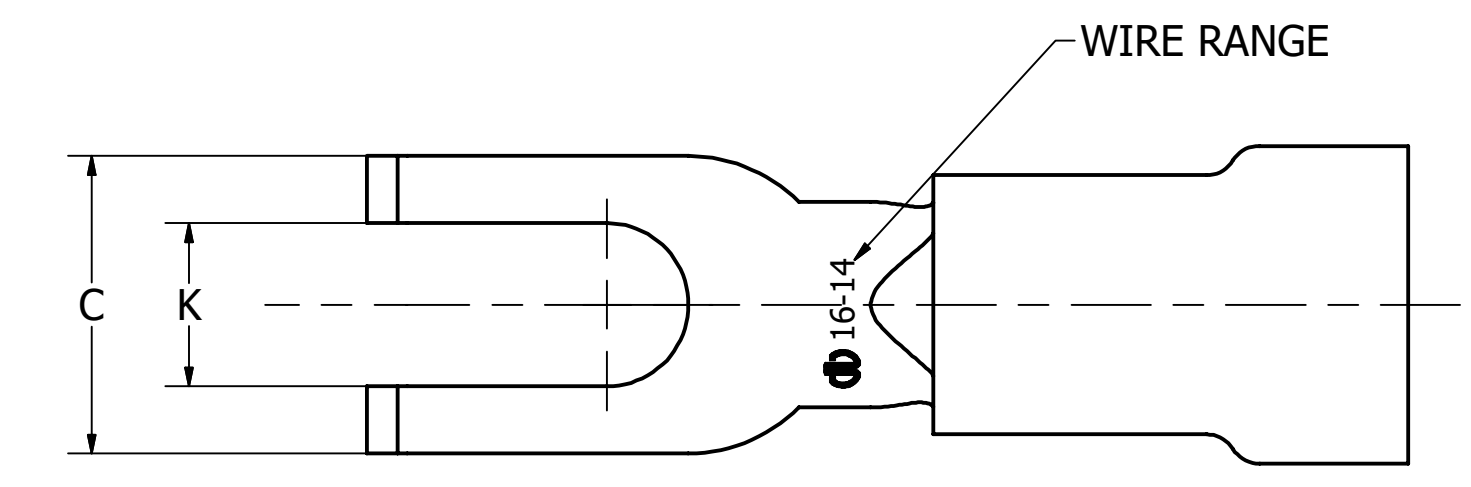
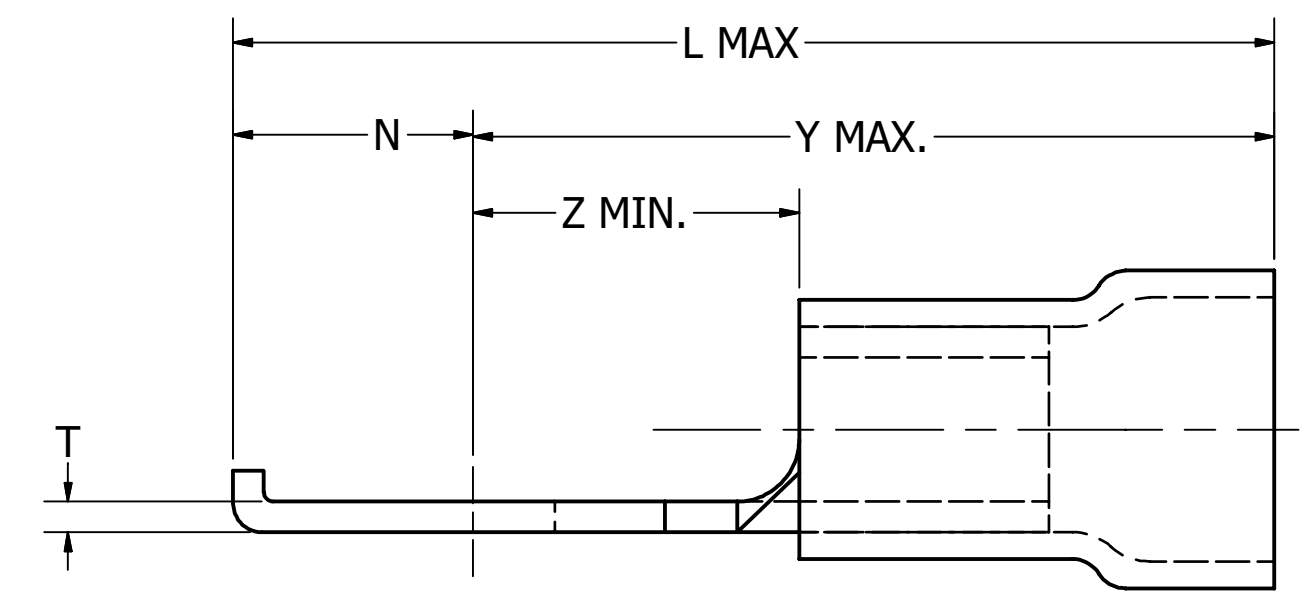

TO ORDER BURNDY® PRODUCTS CALL		VINYLUG	
UNITED STATES 1-800-346-4175 (LONDONDERRY, NH)		ITEM NO: SEE TABLE	
CANADA: 1-800-361-6975 (QUEBEC) 1-800-387-6487 (ALL OTHER PROVINCES)		CAT. NO: TYPE TP-Z & BA -EZ	
FOR PRODUCT INFO: <a href="http://www.burndy.com">http://www.burndy.com</a>		DRAWN BY: P.WINSON 08/21/2018	
		CHECKER: V.SAKTHIVEL 08/21/2018	
		DSN APRVL: K.CASTONGUAY 09/07/2018	
		MFG APRVL: --	
		QA APRVL: B.POST 09/07/2018	
		MKT APRVL: M.BAILLY 09/07/2018	
		PROD FAM: --	
		PROJECT #: --	
		SIZE	
		D	
		DRAWING NO	
		50094185	
		SHEET 1 OF 1	
		REV	
		A	