

WIRE SIZE (AWG)	STUD SIZE	CATALOG NUMBER	BULK CATALOG NUMBER	C		K		L MAX.	N		T ± .01 [± .25]	Y MAX.	Z MIN.	WIRE STRIP LENGTH ± .03 [± .8]	INSTALLATION TOOLING (ONE CRIMP)							
				MAX.	MIN.	MAX.	MIN.		MAX.	MIN.												
22-18 Str. and Sol.	6	YAV18H6FBOX	YAV18H6F	.27 [6.7]	.24 [6.0]	.15 [3.8]	.14 [3.6]	.89 [22.5]	.12 [2.9]	.10 [2.4]	.04 [1.0]	.79 [20.1]	.19 [4.8]	1/4" [6.4]	Y6NCB [J1022NC5], Y6NCP1 [J1022NC5], Y1022, Y8MRB1, Y81KFT, Y81KFTMBH, PAT81KFT18V, MRE1022B, Y122CMR # # # # - Y122CMR only to be used for YAV10HF							
		YAV18H19FBOX	YAV18H19F	.31 [7.8]	.30 [7.5]											.97 [24.6]	.24 [6.2]	.22 [5.7]	.03 [0.9]	.75 [18.9]	.21 [5.3]	
10	YAV18H21FBOX	YAV18H21F	.38 [9.7]	.35 [8.9]	.23 [5.8]	.19 [4.8]	.89 [22.6]	.23 [5.8]	.21 [5.3]	.03 [0.7]	.76 [19.3]	.22 [5.6]										
20-14 Str. and Sol.	6	YAV14Z5BOX	YAV14Z5	.33 [8.3]	.30 [7.5]	.15 [3.8]							.14 [3.6]			.89 [22.6]	.23 [5.8]	.20 [5.1]	.04 [1.1]	.69 [17.6]	.13 [3.2]	
		YAV14H32FBOX	YAV14H32F	.31 [7.8]	.29 [7.3]		.95 [24.2]	.20 [5.0]	.18 [4.5]	.05 [1.2]	.78 [19.7]	.23 [5.8]										
	8	YAV14H56FBOX	YAV14H56F	.31 [7.9]	.28 [7.2]	.18 [4.5]							.16 [4.1]			.95 [24.2]	.20 [5.0]	.18 [4.5]	.04 [1.1]	.78 [19.7]	.23 [5.8]	
		YAV14H34FBOX	YAV14H34F	.38 [9.7]	.35 [8.9]		.23 [5.8]	.19 [4.8]	1.03 [26.2]	.28 [7.2]	.25 [6.5]	.04 [0.9]										.21 [5.2]
		YAV14HFBOX	YAV14HF	.33 [8.3]	.30 [7.5]																	
	10	YAV14Z6BOX	YAV14Z6	.38 [9.7]	.35 [8.9]	.23 [5.8]	.19 [4.8]	1.03 [26.2]	.28 [7.2]	.25 [6.5]	.04 [0.9]	.21 [5.2]										
12-10 Str. and Sol.		YAV10HFBOX	YAV10HF	.39 [9.9]	.36 [9.1]								1.07 [27.1]			.17 [4.4]	.15 [3.9]	.06 [1.4]	.91 [23.2]	.24 [6.1]	7/16" [11.1]	

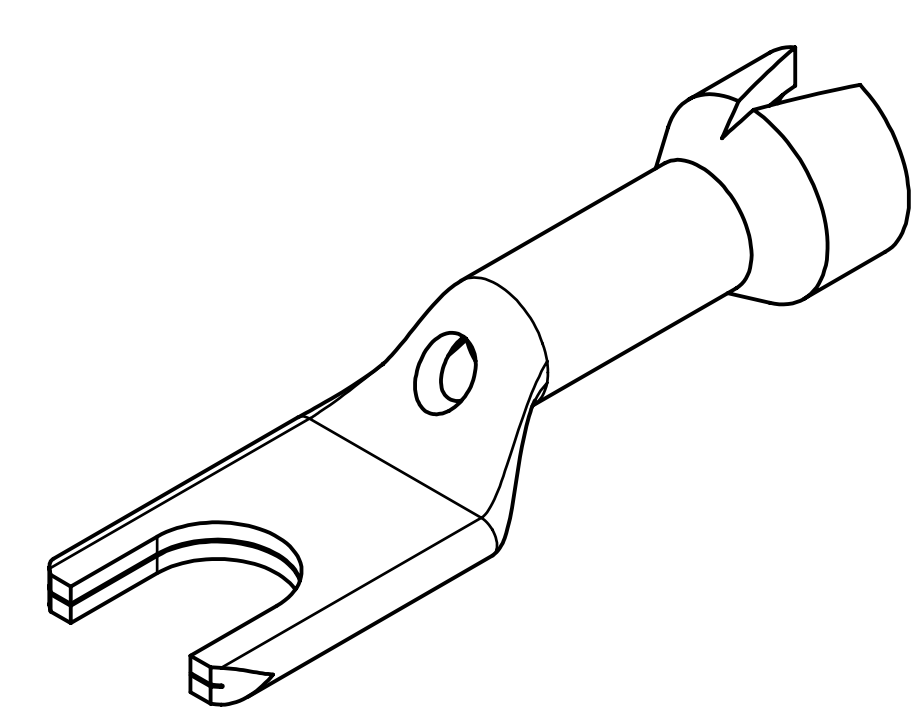

TYPE YAV-H-F

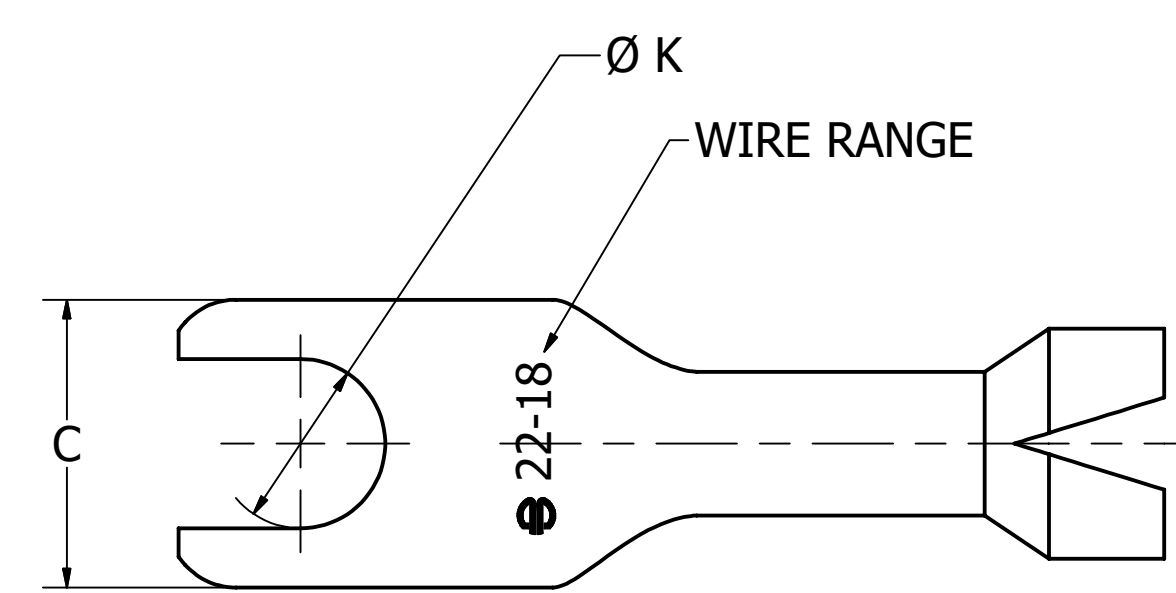
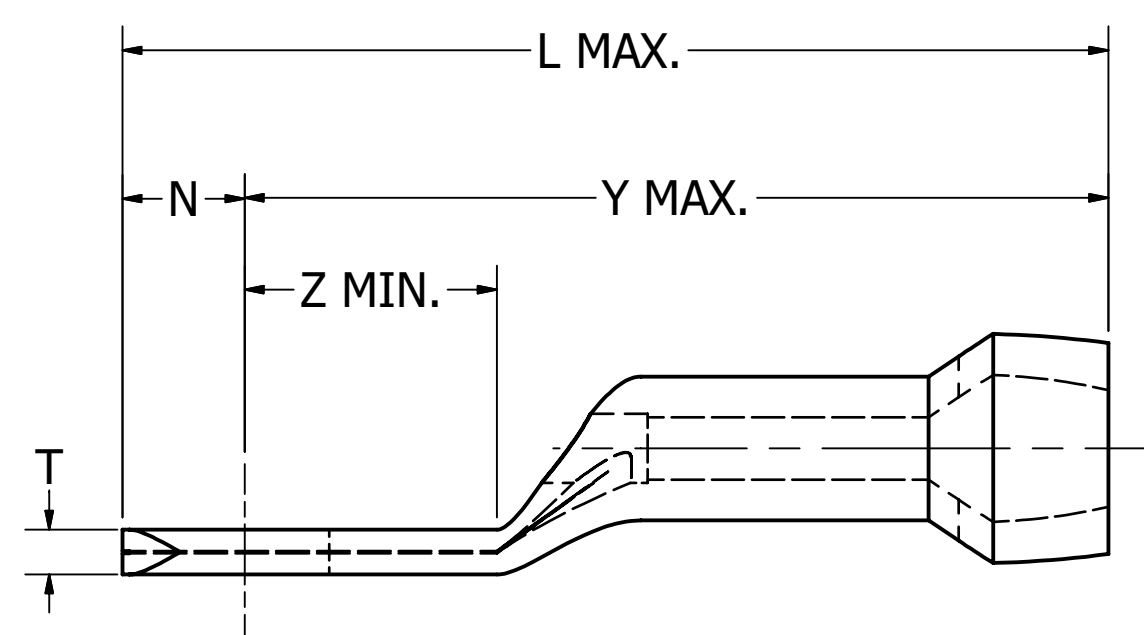
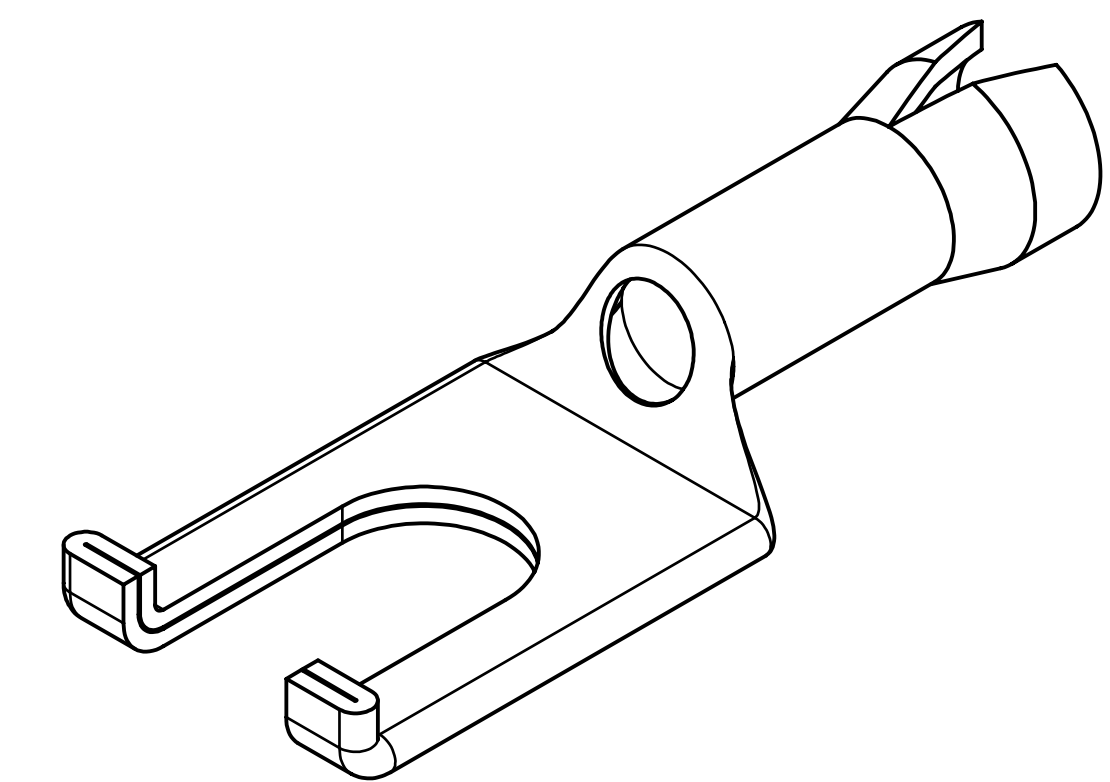

TYPE YAV-Z

- NOTES:
1. TERMINAL: TIN PLATED COPPER
 2. DIMENSIONS IN BRACKETS [] ARE IN MILLIMETERS AND ARE FOR REFERENCE ONLY.
 3. DIE SETS ARE LISTED IN BRACKETS [] AFTER THEIR RESPECTIVE TOOLS.
 4. UL LISTED & CSA CERTIFIED WIRE CONNECTORS PER UL486A/B (FILE E9498) & CSA C22.2 NO.65 REQUIREMENTS (FILE 42862)
 5. DISCONTINUED TOOLS: Y6NCP, Y10MRSA, Y10MRPA, EMR20, PATMD1022LI
CONTACT TECH SERVICE FOR INFORMATION ABOUT APPROVED APPLICATIONS (1-800-451-4956)

TO ORDER BURNDY® PRODUCTS CALL		HYLUG	
UNITED STATES 1-800-346-4175 (LONDONDERRY, NH)		ITEM NO: SEE TABLE	
CANADA: 1-800-361-6975 (QUEBEC) 1-800-387-6487 (ALL OTHER PROVINCES)		CAT. NO: TYPE YAV-H-F & YAV-Z	
FOR PRODUCT INFO: http://www.burndy.com		DRAWN BY: P.WINSON 11/16/2018	
		CHECKER: V.SAKTHIVEL 11/16/2018	
		DSN APRVL: K.CASTONGUAY 11/21/2018	
		MFG APRVL: --	
		QA APRVL: B.POST 11/21/2018	
		MKT APRVL: M.BAILLY 11/21/2018	
		PROD FAM: --	
		PROJECT #: --	
		SIZE	
		D	
		DRAWING NO	
		50094188	
		REV	
		A	
		SHEET 1 OF 1	