

REV	DATE	DESCRIPTION	ECO	BY	C'H'K.
B	09/01/2020	UPDATED AS PER MARKUP	54185	YR	SS

WIRE SIZE	AREA CIR. MILS.	SOLID WIRE DIA. (IN.)	CONCENTRIC STR. MAX. DIA. (IN.)	FLEX. BUNCH OR ROPE LAY DIA. (IN. APPROX.)
26	254.1	0.01594	0.019	-
25	320.4	0.01790	-	-
24	404.0	0.02010	0.024	-
23	509.5	0.02257	-	-
22	642.4	0.02535	0.030	-
21	810.1	0.02845	-	-
20	1022	0.03196	0.038	-
19	1288	0.03589	-	-
18	1624	0.04030	0.0460	-
17	2048	0.04526	-	-
16	2583	0.05082	0.0585	-
15	3257	0.05707	-	-
14	4107	0.06408	0.0735	-
13	5178	0.07196	-	-
12	6530	0.08081	0.0931	0.101
11	8234	0.09074	-	-
10	10380	0.1019	0.117	0.126
9	13090	0.1144	0.132	0.146

CIRCULAR MILS RANGE	CATALOG NUMBER	BULK CATALOG NUMBER	L MAX.	WIRE STRIP LENGTH ± .03 [± .8]	INSTALLATION TOOLING
300 - 1,909	YSM18*	YSM18BOX1000	.30 [7.6]	5/16" [7.9]	Y8MRB1, MR89Q
477 - 4,107	YSM14*	YSM14BOX1000			
4,107 - 10,380	YSM10*	YSM10BOX500	.41 [10.4]	7/16" [11.1]	Y8MRB1, MR89Q, MR4CQ
10,380 - 13,090	YSM9CG1*		.49 [12.4]	1/2" [12.7]	

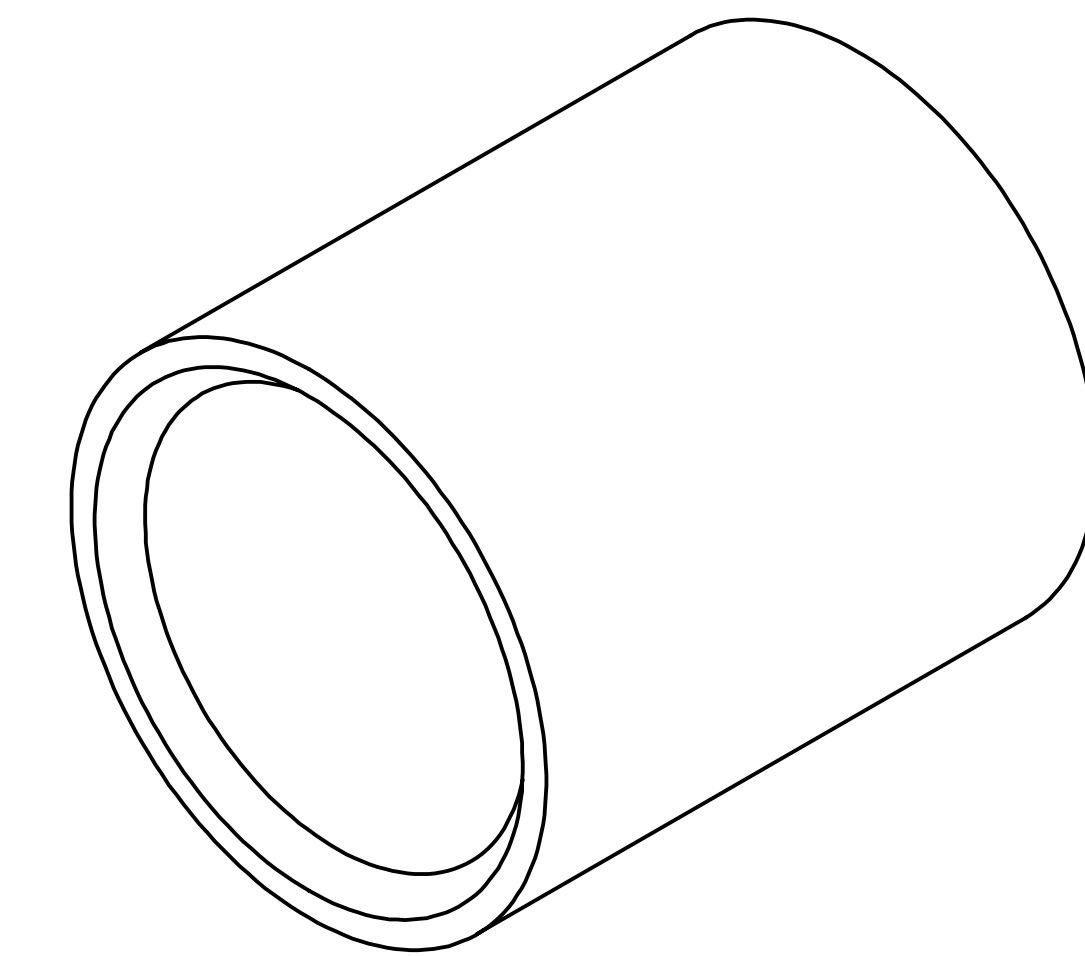
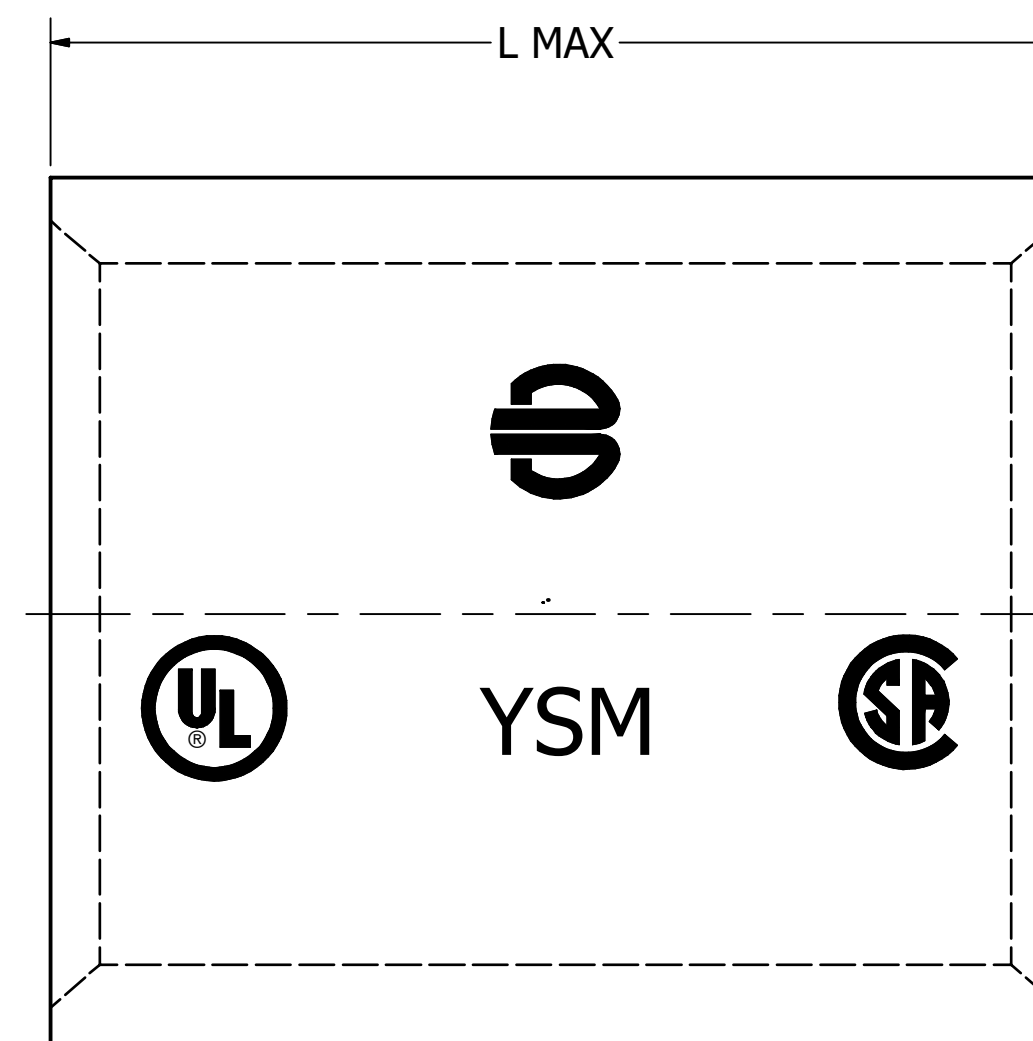

NOTES:

1. TERMINAL: TIN PLATED COPPER
2. DIMENSIONS IN BRACKETS [] ARE IN MILLIMETERS AND ARE FOR REFERENCE ONLY.
3. UL LISTED & CSA CERTIFIED SPLICING WIRE CONNECTORS PER UL486C (FILE E9498) & CSA C22.2 NO.188 REQUIREMENTS (FILE 3934)
4. DISCONTINUED TOOLS: Y10MRQ, Y14MRQ, Y2MR
CONTACT TECH SERVICE FOR INFORMATION ABOUT APPROVED APPLICATIONS (1-800-451-4956)
5. FOR NICKEL PLATING AT MINIMUM 200 MICRO INCHES THICK, ADD SUFFIX "NK" TO THE CAT. NO.
6. ITEMS WITH CATALOG NUMBERS FOLLOWED BY ASTERISKS (*) ARE CSA CERTIFIED BUT NOT UL LISTED.
7. ITEMS WITH CATALOG NUMBERS FOLLOWED BY DAGGERS (†) ARE NOT UL LISTED OR CSA CERTIFIED.
8. ITEMS ARE ONLY UL LISTED WHEN CRIMPED WITH THE MY28.

9 REMOVE STOP PLATE FROM Y39BH.

TO ORDER BURNDY® PRODUCTS CALL		HYLINK															
UNITED STATES 1-800-346-4175 (LONDONDERRY, NH)		ITEM NO: N/A															
CANADA: 1-800-361-6975 (QUEBEC) 1-800-387-6487 (ALL OTHER PROVINCES)		CAT. NO: TYPE YSM															
FOR PRODUCT INFO: http://www.burndy.com		<table border="1"> <tr> <td>DRAWN BY: P.PRASANTH</td> <td>12/18/2018</td> </tr> <tr> <td>CHECKER: V.SAKTHIVEL</td> <td>12/18/2018</td> </tr> <tr> <td>DSN APRVL: K.CASTONGUAY</td> <td>02/12/2019</td> </tr> <tr> <td>MFG APRVL: --</td> <td></td> </tr> <tr> <td>QA APRVL: B.ELLIOTT</td> <td>01/03/2019</td> </tr> <tr> <td>MKT APRVL: M.BAILLY</td> <td>01/03/2019</td> </tr> <tr> <td>PROD FAM: --</td> <td></td> </tr> </table>		DRAWN BY: P.PRASANTH	12/18/2018	CHECKER: V.SAKTHIVEL	12/18/2018	DSN APRVL: K.CASTONGUAY	02/12/2019	MFG APRVL: --		QA APRVL: B.ELLIOTT	01/03/2019	MKT APRVL: M.BAILLY	01/03/2019	PROD FAM: --	
DRAWN BY: P.PRASANTH	12/18/2018																
CHECKER: V.SAKTHIVEL	12/18/2018																
DSN APRVL: K.CASTONGUAY	02/12/2019																
MFG APRVL: --																	
QA APRVL: B.ELLIOTT	01/03/2019																
MKT APRVL: M.BAILLY	01/03/2019																
PROD FAM: --																	
		<table border="1"> <tr> <td>PROJECT #:</td> <td>--</td> <td>SIZE</td> <td>D</td> </tr> <tr> <td>DOCUMENT TYPE:</td> <td>SALES</td> <td></td> <td></td> </tr> <tr> <td>REL LEVEL:</td> <td>Released</td> <td></td> <td></td> </tr> </table>		PROJECT #:	--	SIZE	D	DOCUMENT TYPE:	SALES			REL LEVEL:	Released				
PROJECT #:	--	SIZE	D														
DOCUMENT TYPE:	SALES																
REL LEVEL:	Released																
		<table border="1"> <tr> <td>DRAWING NO</td> <td>50094200</td> <td>REV</td> <td>B</td> </tr> <tr> <td colspan="2">SHEET 1 OF 2</td> <td colspan="2"></td> </tr> </table>		DRAWING NO	50094200	REV	B	SHEET 1 OF 2									
DRAWING NO	50094200	REV	B														
SHEET 1 OF 2																	

REV	DATE	DESCRIPTION	ECO	BY	C'H'K.
B	09/01/2020	UPDATED AS PER MARKUP	54185	YR	SS

WIRE SIZE	AREA CIR. MILS.	SOLID WIRE DIA. (IN.)	CONCENTRIC STR. MAX. DIA. (IN.)	FLEX. BUNCH OR ROPE LAY DIA. (IN. APPROX.)
13	5178	0.07196	-	-
12	6530	0.08081	0.0931	0.101
11	8234	0.09074	-	-
10	10380	0.1019	0.117	0.126
9	13090	0.1144	0.132	0.146
8	16510	0.1285	0.148	0.157 - 0.162
7	20820	0.1433	0.166	0.179 - 0.196
6	26250	0.1620	0.186	0.207 - 0.215
5	33100	0.1819	0.209	0.235 - 0.240
4	41740	0.2043	0.235	0.263 - 0.269
3	52640	0.2294	0.264	0.219 - 0.305
2	66370	0.2576	0.297	0.319 - 0.337
1	83690	0.2893	0.333	0.367 - 0.376
1/0	105500	0.3249	0.374	0.423 - 0.441
2/0	133100	0.3648	0.420	0.500 - 0.508
3/0	167800	0.4096	0.472	0.549 - 0.576
4/0	211600	0.4600	0.530	0.613 - 0.645

CIRCULAR MILS RANGE	CATALOG NUMBER	BULK CATALOG NUMBER	L MAX.	WIRE STRIP LENGTH ± .03 [± .8]	RATCHET	MECHANICAL HYTOOL™	INSTALLATION TOOLING			
							Y29B		HYPRESS™ Y35BH, Y39BH	
							NEST	INDENTOR	NEST	INDENTOR
6,088 - 16,864	YSM8C*	YSM8CBOX500	.46 [11.7]	1/2" [12.7]	MR4CQ, MR89Q	MY2911, MY28 (One crimp)	DV8L-1	Y29PQ	UV8L	Y29PQ
	YSM8CG3†		.80 [20.3]	13/16" [20.6]			DV6L		UV6L	
10,380 - 26,813	YSM6C	YSM6CBOX1000	.49 [12.4]	1/2" [12.7]	MR4CQ		DV4L		UV4L	
	YSM6CG6†		.80 [20.3]	13/16" [20.6]			DV2L		UV2L	
26,813 - 42,613	YSM4C	YSM4CBOX1000	.55 [14.0]	9/16" [14.3]	-		DV1L		UV1L	
	YSM2C		.67 [17.0]	11/16" [17.5]	-		DV25L		UV25L	
42,613 - 66,832	YSM1C*		.74 [18.8]	3/4" [19.0]	-		DV26L	UV26L		
	YSM25*		.86 [21.8]	7/8" [22.2]	-		DV27L	UV27L		
66,832 - 81,807	YSM26*		.93 [23.6]	15/16" [23.8]	-		DV28L	UV28L		
	YSM27*									
81,807 - 104,110	YSM28*									
104,110 - 133,650										
133,650 - 167,332										
167,332 - 211,954										

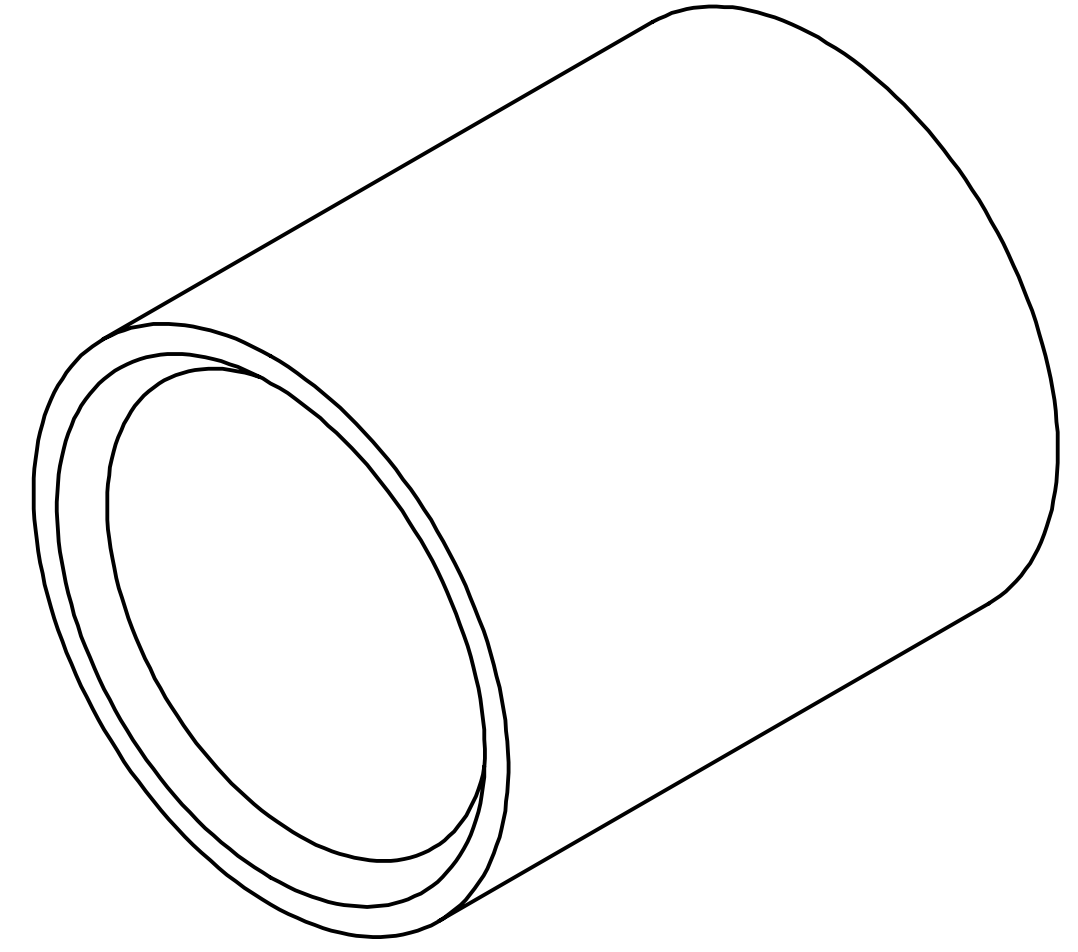
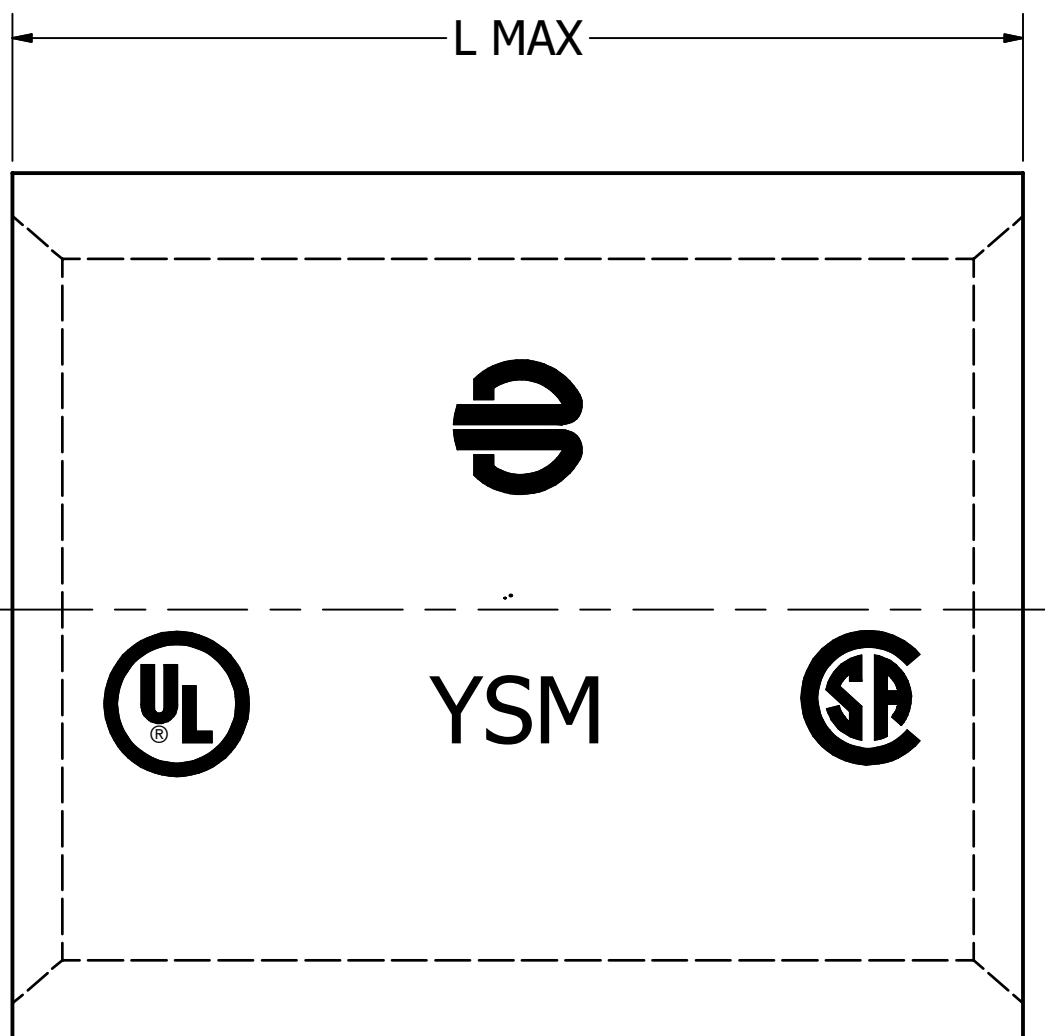

NOTES:

1. TERMINAL: TIN PLATED COPPER
2. DIMENSIONS IN BRACKETS [] ARE IN MILLIMETERS AND ARE FOR REFERENCE ONLY.
3. UL LISTED & CSA CERTIFIED SPLICING WIRE CONNECTORS PER UL486C (FILE E9498) & CSA C22.2 NO.188 REQUIREMENTS (FILE 3934)
4. DISCONTINUED TOOLS: Y10MRQ, Y14MRQ, Y2MR
CONTACT TECH SERVICE FOR INFORMATION ABOUT APPROVED APPLICATIONS (1-800-451-4956)
5. FOR NICKEL PLATING AT MINIMUM 200 MICRO INCHES THICK, ADD SUFFIX "NK" TO THE CAT. NO.
6. ITEMS WITH CATALOG NUMBERS FOLLOWED BY ASTERISKS (*) ARE CSA CERTIFIED BUT NOT UL LISTED.
7. ITEMS WITH CATALOG NUMBERS FOLLOWED BY DAGGERS (†) ARE NOT UL LISTED OR CSA CERTIFIED.
8. ITEMS ARE ONLY UL LISTED WHEN CRIMPED WITH THE MY28.

9 REMOVE STOP PLATE FROM Y39BH.

TO ORDER BURNDY® PRODUCTS CALL UNITED STATES 1-800-346-4175 (LONDONDERRY, NH) CANADA: 1-800-361-6975 (QUEBEC) 1-800-387-6487 (ALL OTHER PROVINCES) FOR PRODUCT INFO: http://www.burndy.com	HYLINK	
	ITEM NO: N/A	
	CAT. NO: TYPE YSM	
	DRAWN BY: P.PRASANTH	12/18/2018
	CHECKER: V.SAKTHIVEL	12/18/2018
	DSN APRVL: K.CASTONGUAY	02/12/2019
	MFG APRVL: --	
	QA APRVL: B.ELLIOTT	01/03/2019
	MKT APRVL: M.BAILLY	01/03/2019
	PROD FAM: --	
PROJECT #: --	SIZE	DRAWING NO
DOCUMENT TYPE: SALES	D	50094200
REL LEVEL: Released		SHEET 2 OF 2
		B