

- NOTES:
- |   |                                      |                          |                   |
|---|--------------------------------------|--------------------------|-------------------|
| 1 | CREEPAGE DISTANCE:                   | OUT: 13.9" / 352mm       | IN: 10.7" / 272mm |
| 2 | ARC DISTANCE:                        | OUT: 6.8" / 173mm        | IN: 10.7" / 272mm |
| 3 | NOMINAL VOLTAGE:                     | 15kV                     |                   |
| 4 | NOMINAL CURRENT:                     | 1200A                    |                   |
| 5 | VOLTAGE WITHSTAND, 60 sec.:          | 50kV                     |                   |
| 6 | BIL :                                | 110kV                    |                   |
| 7 | ROUTINE TEST ACCORDACE TO            | IEEE C57.19.01           |                   |
| 8 | MAX. TORQUE APPLIED ON FLANGE BOLTS: | 40 lbf · ft / 54.2 N · m |                   |
| 9 | WEIGHT:                              | 29 lb / 13.2 kg          |                   |

REVISIONS					
ZONE	REV.	DESCRIPTION	DRAWN BY	DATE	APPR.
A6 B6	A	ADD THE MINIMUM GASKET SEAT DIMENSION. INCREASE THE TOLERANCES ON THE FLANGE OUTSIDE DIAMETER.	M. FORGET	2019-08-07	Y.V.

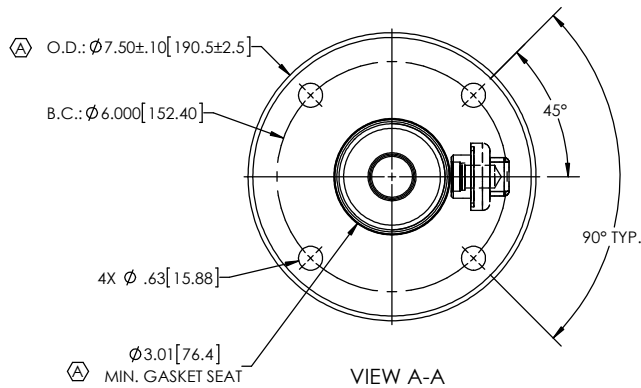
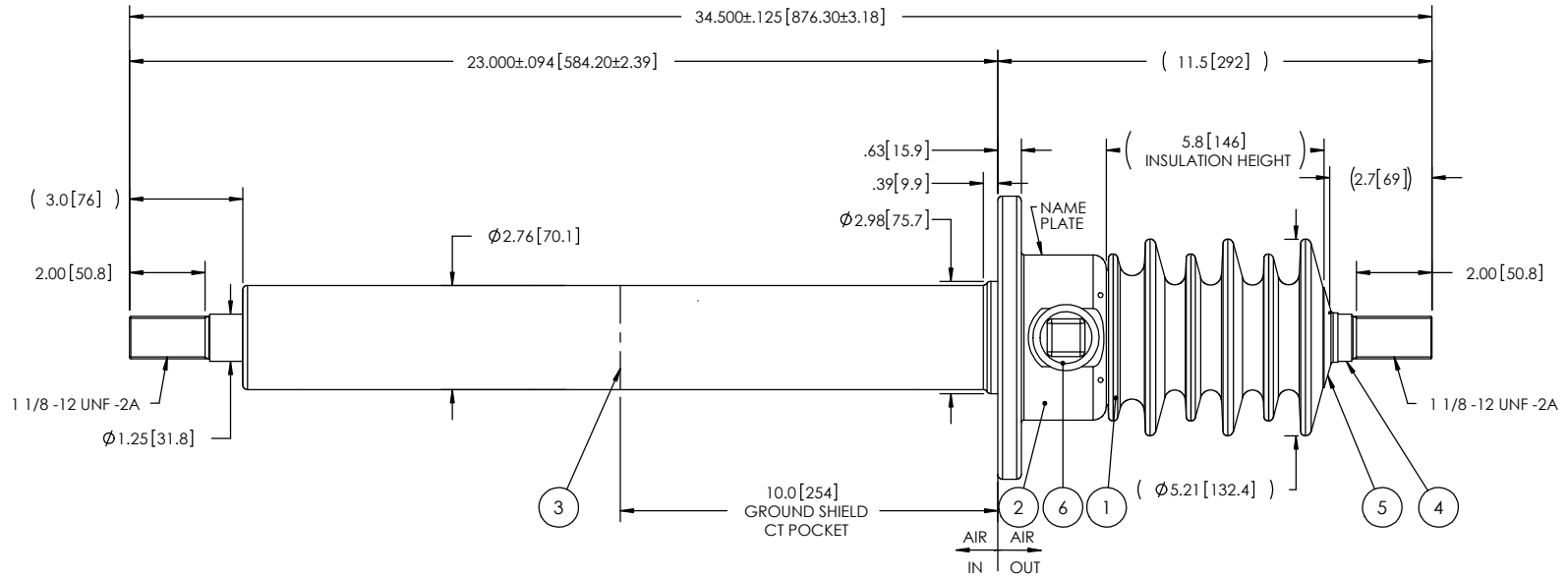

This drawing is the proprietary property of Electro Composites (2008) ULC, not part of the public domain, and is issued with the express understanding and agreement that it is not to be reproduced or copied in whole or in part or issued for furnishing information to others, or used directly or indirectly, in any way detrimental to the interest of Electro Composites (2008) ULC and is to be returned upon request by Electro Composites (2008) ULC. All Rights Reserved.

ITEM NO.	QTY	DRAWING NO.	PART NO.	DESCRIPTION	NOTE / MAT'L
6	1	S-1001-2022		CAPACITANCE TAP ASSEMBLY	ALUMINUM
5	1	S-1016-0008		CAP	COPPER
4	1	S-5370-8390		ROD ASSEMBLY	COPPER
3	1	S-5370-8394		SHIELD ASSEMBLY	COPPER
2	1	S-5370-8389		FLANGE	ALUMINUM
1	1	S-5370-8388	-001	CASTING, CYCLOALIPHATIC RESIN	EC-APG-02

PARTS LIST

GENERAL TOLERANCES (UNLESS OTHERWISE SPECIFIED)

X.	±0.125
.X	±0.094
.XX	±0.063
.XXX	±0.031
ANGLES	±0.25°
RADIUS	±0.031

REMOVE BURRS AND  
BREAK SHARP EDGES

DIMENSIONS ARE IN  
INCHES  
(UNLESS OTHERWISE SPECIFIED)

REPLACE:

DRAWN BY: J.N.PILOTTE DATE: 2014/06/10

CHECK BY:

PROJECTING:

PROJECT MANAGER:

**Electro Composites**  
solid HV bushings solution

TITLE:  
SDC® BUSHING 15kV, 1200A  
110-012-W-542-04

FORMAT

CAGE CODE

DRAWING NO.

REVISION

SCALE

1:5



GENERATED BY:

SolidWorks 2013

SHEET

1 of 1