

M-8305 2

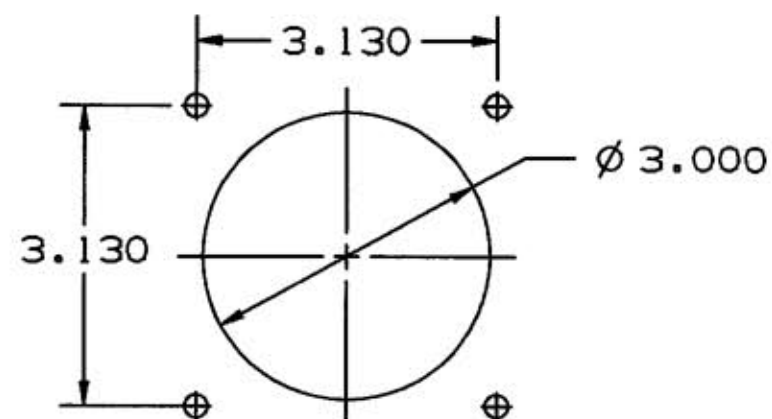

CUTOUT OPENING

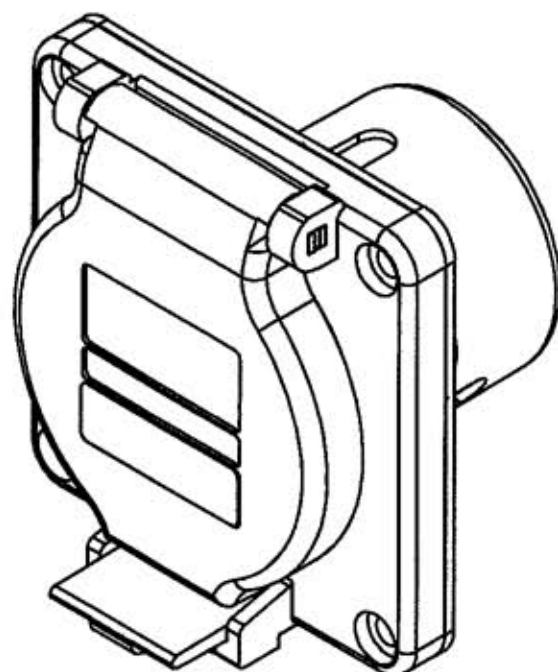
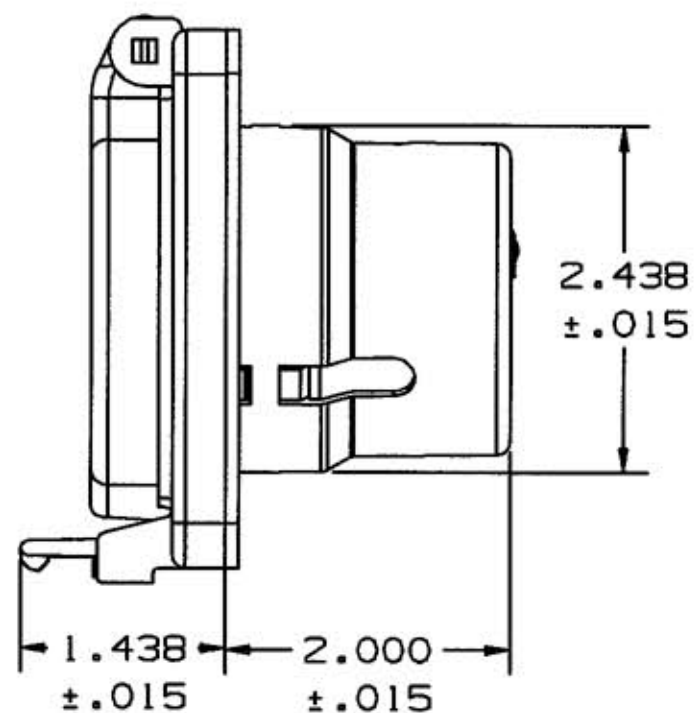
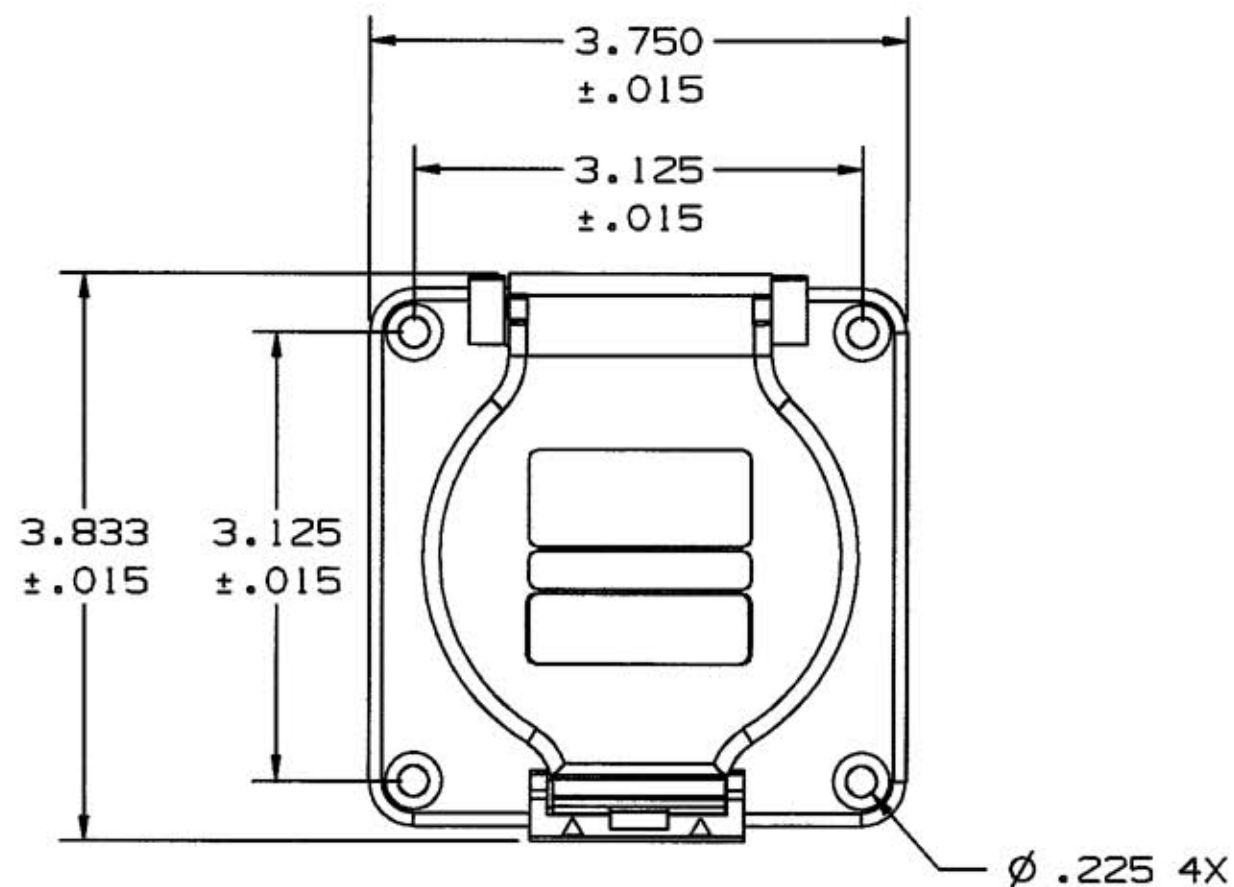

CODE 74545

LIST OF PARTS

DESCRIPTION	MATERIAL	FINISH
INLET BASE	PBT	
CUP, BLADE HOLDER	NYLON	
RING, RETAINING	SST	
SHUNT	COPPER	Ni PLATE
TERMINALS	COPPER	Ni PLATE
TERMINALS	COPPER	Zn PLATE
SCREW ASSY'S, TERM	SST/BRASS	Ni PLATE
BLADE HOLDER	PHENOLIC	
BASE, CAP	PHENOLIC	
BLADES	BRASS	Ni PLATE
SCREWS	STEEL	Zn PLATE
LIFT LID	PBTB	
HINGE PIN	SST	
HINGE SPRING	SST	
GASKET, LID	NEOPRENE	
GASKET, FLANGE	NEOPRENE	
LABEL, RATING	POLYESTER	
LABEL, CAUTION	POLYESTER	

2	CONVERTED ALL DIMS TO 3 PL DECIMAL, ADDED TOL. AND CUTOUT VIEW PER DCN #7772. AMZ	DB	8/25/00
1	RELEASED PER DCN7341. DJH	MJL	12/13/99
SYM	REVISIONS	APP	DATE

THE DESIGN AND DIMENSIONS OF THE PRODUCT SHOWN ON THIS DRAWING ARE SUBJECT TO CHANGE WITHOUT NOTICE

TITLE  
HBL6375S  
50A T/L INLET  
125/250V

TOLERANCES UNLESS OTHERWISE SPECIFIED	WIRING DEVICE-KELLEMS HUBBELL INCORPORATED BRIDGEPORT, CT	
FRACTIONS ±1/64	DR. BY DJH	APP. BY MJL
DECIMALS ±.005	TR. BY	SCALE NONE
ANGLES ±2°	CHK'D BY MJL	DATE 12/13/99

DIMENSION SHEET FOR CAT. NO.  
HBL6375S

REPAIRABLE ☐ NON-REPAIRABLE ☒

B

M-8305

2

M-7962 3

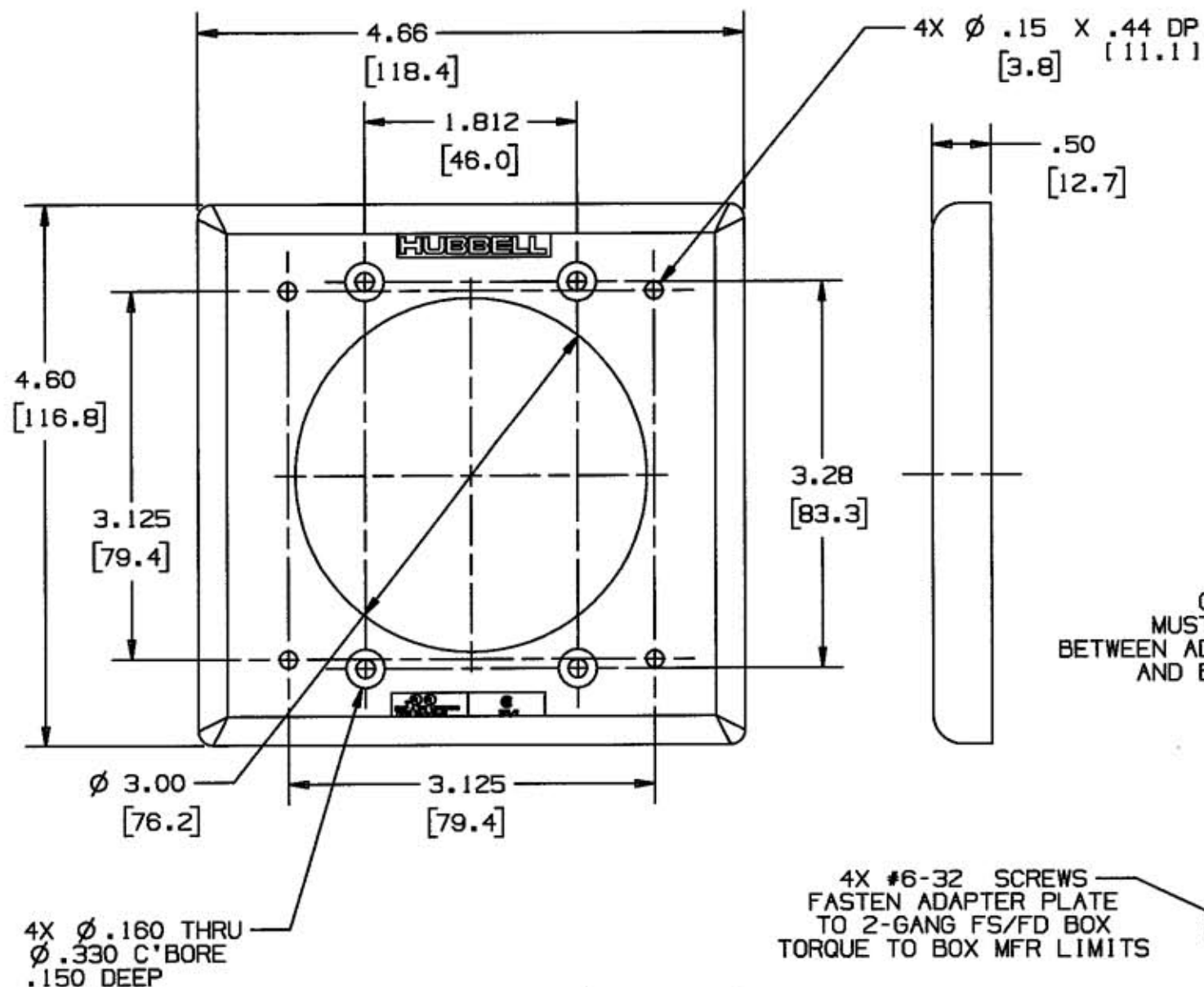

COVER GASKET  
MUST BE LOCATED  
BETWEEN ADAPTER PLATE  
AND BOX AS SHOWN

4X #6-32 SCREWS  
FASTEN ADAPTER PLATE  
TO 2-GANG FS/FD BOX  
TORQUE TO BOX MFR LIMITS

ADAPTER PLATE

HOLE PATTERN ACCEPTS  
20A AND 30A HUBBELL  
PIN & SLEEVE AND WATER-  
TIGHT TWIST-LOCK SHROUDED  
FLANGED INLETS & RECEPTACLES

4 #8 TRILOBE SCREWS  
PROVIDED FOR FASTENING  
DEVICE TO ADAPTER PLATE

CONDUIT, HUBS, CLOSURE PLUGS,  
AND CONDUCTORS ARE USER-  
SUPPLIED ITEMS AND ARE NOT  
INCLUDED WITH THIS CAT. NO.

TYPICAL 2-GANG FS/FD  
BOX; USER SUPPLIED  
MODEL MAY VARY FROM  
ILLUSTRATION; SEE  
INSTRUCTIONS FOR  
BOXES CAPABLE OF  
PROVIDING A TYPE 4,  
4X, 12 ENCLOSURE

NOTES: (UNLESS OTHERWISE SPECIFIED)

1) DIMENSIONS ARE: INCHES  
[MILLIMETERS]

2) .XX TOLERANCES TO BE ± .03

# LIST OF PARTS

DESCRIPTION	MATERIAL	FINISH
ADAPTER PLATE	PBT	GRAY
GASKET	NEOPRENE	BLACK
SCREW #6-32	STN STL	
SCREW, DEVICE MTG	STN STL	

3	ADDED NOTE 2 & NUMBER TO NOTE 1 PER DCN #12944. JMN	DJP	7/11/06
2	ADDED VIEWS OF COVER & DIMS; CONVERTED DIMS. TO INCHES/MM;REVISED NOTES PER DCN 8685 RCM	TCM	11/19/01
1	RELEASED PER DCN 8066	MDM	4/28/98
SYM	REVISIONS	APP	DATE

THE DESIGN AND DIMENSIONS OF THE  
PRODUCT SHOWN ON THIS DRAWING ARE  
SUBJECT TO CHANGE WITHOUT NOTICE

TITLE  
ADAPTER PLATE  
WATERTIGHT

TOLERANCES UNLESS OTHERWISE SPECIFIED	WIRING DEVICE-KELLEMS HUBBELL INCORPORATED BRIDGEPORT, CT
FRACTIONS ± 1/64	DR. BY MDM APP. BY MDM
DECIMALS ± .005	TR. BY SCALE NONE
ANGLES ± 2°	CHK'D BY MDM DATE 4/28/98

# TWO-GANG EXTENSION Cat# 5407-0

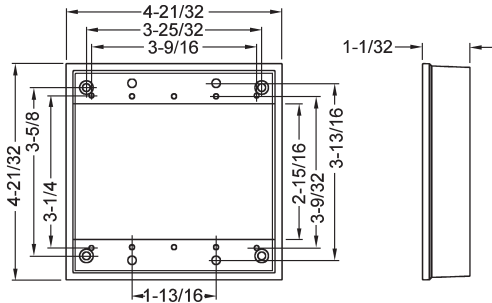

# TWO-GANG BOXES WITH 5 OUTLETS

## CAT. NOs. 5388-0, 5389-0

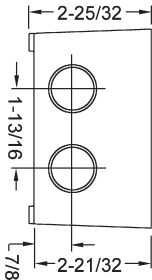
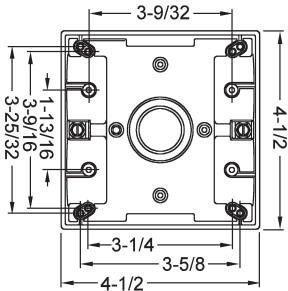

## TWO-GANG BOXES (General Dimensions)

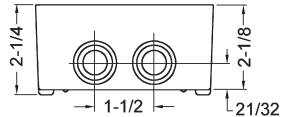
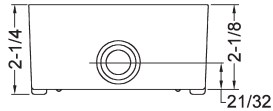
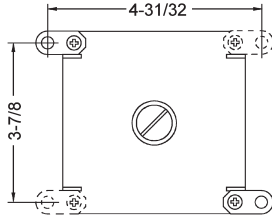
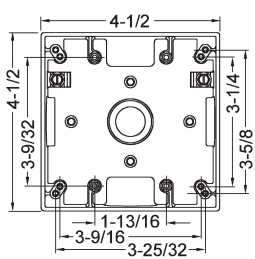

END VIEW FOR STYLES WITH TWO  
OUTLETS ON ONE END

# BOX MOUNTING LUG CATALOG NO. 5302-0

1/4" DIA. (2-HOLES)

