

NOTES:

- 1 CREEPAGE DISTANCE: 30.2" / 767mm
- 2 ARC DISTANCE: 13.6" / 346mm
- 3 NOMINAL VOLTAGE: 25kV
- 4 NOMINAL CURRENT: 14,000A
- 5 WITHSTAND VOLTAGE AT 60 sec.: 60kV
- 6 B.I.L. : 150kV
- 7 ROUTINE TEST ACCORDING TO: IEEE C57.19.01
- 8 MAX. TORQUE APPLIED ON FLANGE BOLTS: 70 lbf x ft
- 9 WEIGHT: 587 lb / 268.5 Kg
- 10 SILVER PLATED, AS PER ASTM B700, TYPE 1, GRADE D, CLASS N, NO NICKEL LAYER, FROM 13 TO 20 MICROMETERS THICKNESS
- 11 DO NOT STORE OR INSTALL BUSHING DIRECTLY EXPOSED TO SUNLIGHT (UV).

REVISIONS					
ZONE	REV.	DESCRIPTION	DRAWN BY	DATE	APPR.

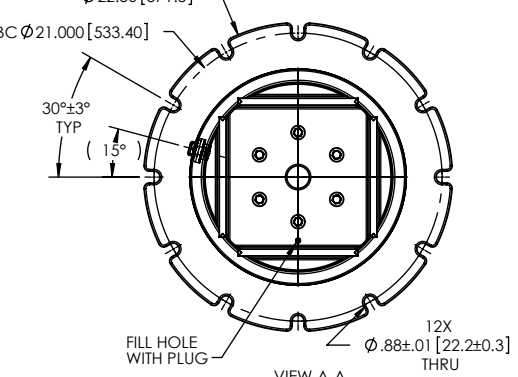
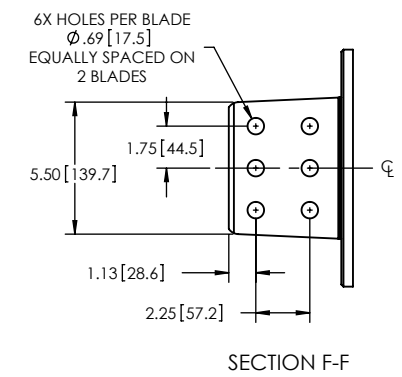
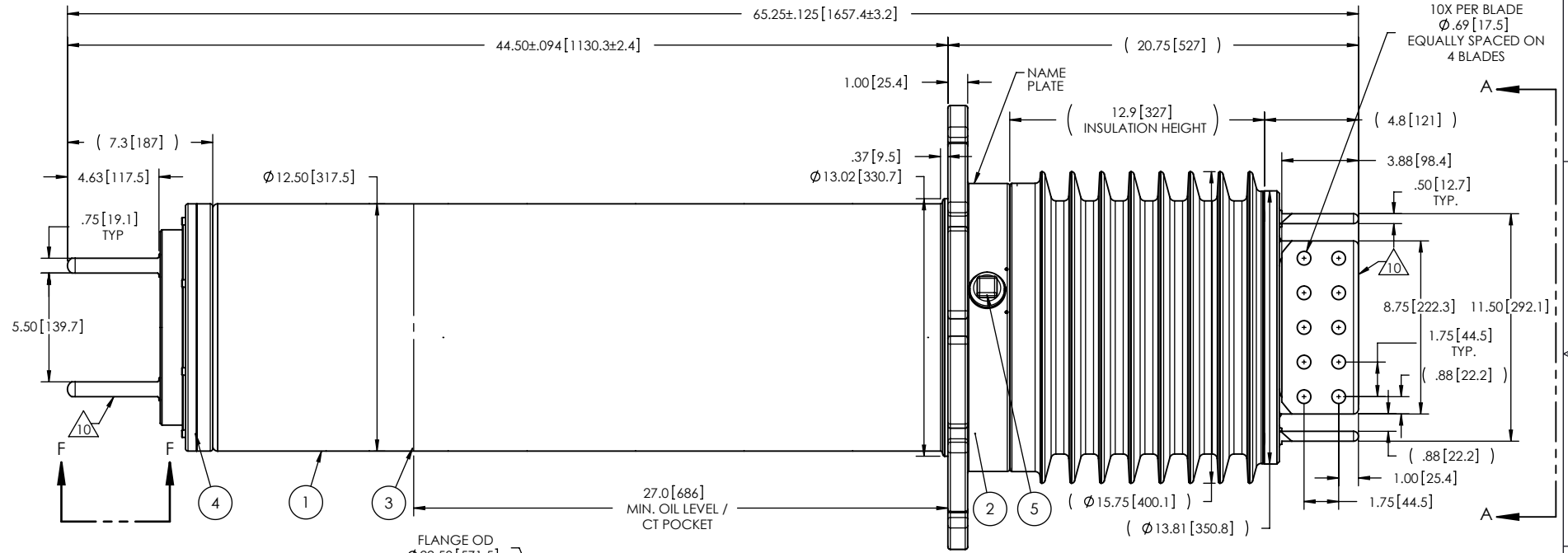

ITEM NO.	QTY	DRAWING NO.	PART NO.	DESCRIPTION	NOTE / MAT'L
5	1	S-1001-2022		CAPACITANCE TAP ASSEMBLY	ALUMINUM
4	1	S-6657-6418		TUBE ASSEMBLY	COPPER
3	1	S-6657-6416		SHIELD ASSEMBLY	COPPER
2	1	S-6657-6259		FLANGE	ALUMINUM
1	1	S-6657-6415	-001	CASTING, CYCLOALIPHATIC RESIN	APG-15

GENERAL TOLERANCES (UNLESS OTHERWISE SPECIFIED) X. ±0.125 .X ±0.094 .XX ±0.063 .XXX ±0.031 ANGLES ±0.25° RADIUS ±0.031		Electro Composites solid HV bushings solution	
REMOVE BURRS AND BREAK SHARP EDGES DIMENSIONS ARE IN INCHES (UNLESS OTHERWISE SPECIFIED)		TITLE: GSU BUSHING 25KV, 14,000A MODEL: 150-140-G-614-00	
DRAWN BY: A.SAVARD	DATE: 2011/03/01	FORMAT: A	CAGE CODE: S-6657-6415
CHECK BY:	PROJECT ENG.:	SCALE: 1:8	DRAWING NO.: S-6657-6415
PROJECT MANAGER:	GENERATED BY: SolidWorks 2009	SHEET: 1 OF 1	REVISION: NR

This drawing is the proprietary property of Electro Composites (2008) ULC, not part of the public domain, and is issued with the express understanding and agreement that it is not to be reproduced or copied in whole or in part or issued for furnishing information to others, or used directly or indirectly, in any way detrimental to the interest of Electro Composites (2008) ULC and is to be returned upon request by Electro Composites (2008) ULC. All Rights Reserved.