

- NOTES:
- 1 CREEPAGE DISTANCE: 54.8" / 1392mm
 - 2 ARC DISTANCE: 20.7" / 526mm
 - 3 NOMINAL VOLTAGE: 34.5kV
 - 4 NOMINAL CURRENT: 2350A
 - 5 VOLTAGE WITHSTAND, 60 sec.: 80 kV
 - 6 BIL : 200kV
 - 7 ROUTINE TEST ACCORDING TO: IEEE C57.19.01
 - 8 MAX. TORQUE APPLIED ON FLANGE BOLTS: 40 lbf·ft / 54.2 N·m
 - 9 WEIGHT: 74 lb / 33.6 kg

10 SILVER PLATED, AS PER ASTM B700, TYPE 1, GRADE D, CLASS N, NO NICKEL LAYER, FROM 13 TO 20 MICROMETERS THICKNESS

- 11 BUSHING NOT SUITABLE FOR ENCLOSED APPLICATIONS.
- 12 INSULATION THERMAL LIMIT: 130°C. BUSHING RATED PER IEEE C57.19.00 USUAL SERVICE CONDITIONS.

REVISIONS					
ZONE	REV.	DESCRIPTION	DRAWN BY	DATE	APPR.
C6 F5 E5	A	INCREASE THE TOLERANCES ON THE FLANGE OUTSIDE DIAMETER. "APPLICATION STANDARD" BECOME "ROUTINE TEST ACCORDING TO" ADD THE NOTE #12: MAXIMUM OPERATING TEMPERATURE.	J. CLICHE	2017-05-23	Y. V.
E4	B	UPDATE NOTE #12 ABOUT INSULATION THERMAL LIMIT	M. FORGET	2021-12-06	Y.V.
B4	C	CHANGE S-4894-4272 BY STANDARD FLANGE S-5408-5057	M. FORGET	2022-08-23	Y.V.

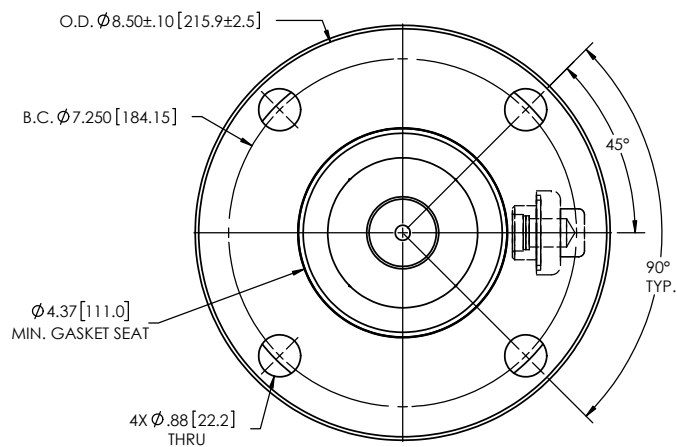
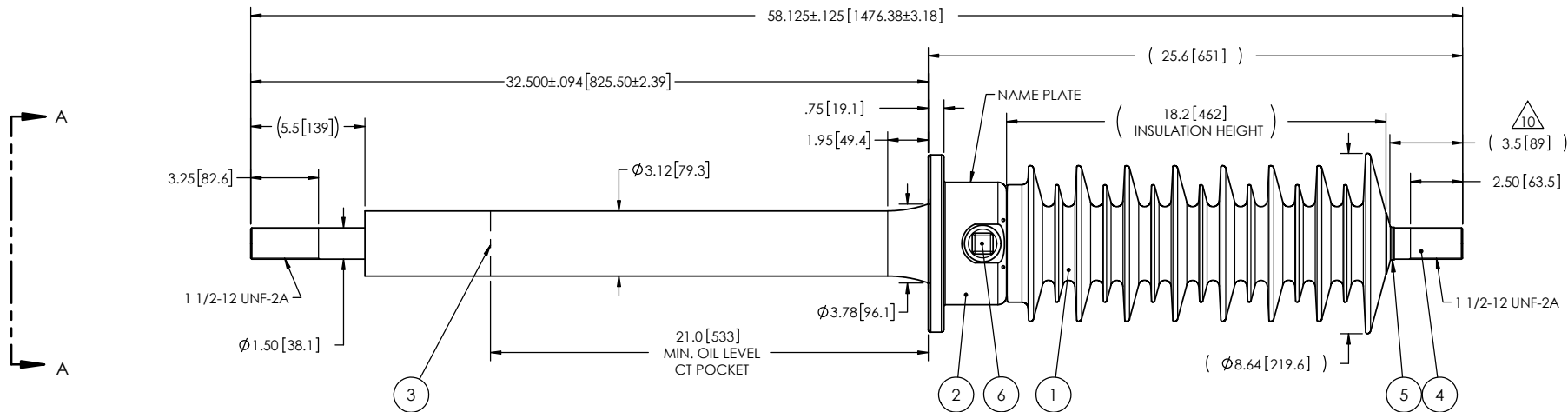

VIEW A-A
SCALE 1 : 4

This drawing is the proprietary property of Electro Composites (2008) ULC, not part of the public domain, and is issued with the express understanding and agreement that it is not to be reproduced or copied in whole or in part or issued for furnishing information to others, or used directly or indirectly, in any way detrimental to the interest of Electro Composites (2008) ULC and is to be returned upon request by Electro Composites (2008) ULC. All Rights Reserved.

ITEM NO.	QTY	DRAWING NO.	PART NO.	DESCRIPTION	NOTE / MAT'L
6	1	S-1001-2022		CAPACITANCE TAP ASSEMBLY	ALUMINUM
5	1	S-1001-0007		CAP	COPPER
4	1	S-3691-8693		ROD ASSEMBLY	COPPER
3	1	S-7485-6999		SHIELD ASSEMBLY	COPPER
2	1	S-5408-5057		FLANGE	ALUMINUM
1	1	S-3691-8692	-001	CASTING, CYCLOALIPHATIC RESIN	EC-APG-15NA

PARTS LIST

GENERAL TOLERANCES
(UNLESS OTHERWISE SPECIFIED)

X.	±0.125
.X	±0.094
.XX	±0.063
.XXX	±0.031
ANGLES	±0.25°
RADIUS	±0.031

REMOVE BURRS AND
BREAK SHARP EDGES

DIMENSIONS ARE IN
INCHES

(UNLESS OTHERWISE SPECIFIED)

DRAWN BY: J. CLICHE	DATE: 2015/01/13
CHECK BY:	
PROJECT ENG.:	
PROJECT MANAGER:	

Electro Composites
solid HV bushings solution

TITLE:
SDC® BUSHING 34.5kV 2350A
MODEL 200-023-T-686-02

FORMAT A	CAGE CODE	DRAWING NO. S-3691-8692	REVISION C
SCALE 1:8	GENERATED BY: SolidWorks 2021	SHEET 1 of 1	