

NOTES:

- 1 CREEPAGE DISTANCE: 8.6" / 220mm
- 2 ARC DISTANCE: 4.7" / 120mm
- 3 NOMINAL VOLTAGE: 2.4kV
- 4 NOMINAL CURRENT: 1200A
- 5 WITHSTAND VOLTAGE AT 60 sec.: 10kV
- 6 B.I.L. : 40kV
- 7 ROUTINE TEST ACCORDING TO: IEEE C57.19.01
- 8 MAX. TORQUE APPLIED ON FLANGE BOLTS: 40 lbf x ft
- 9 WEIGHT: 26 lbs / 11.8 Kg
- 10 BUSHING SUITABLE TO BE USED WITH LOWER INSULATION LENGTH IMMERSSED IN AIR

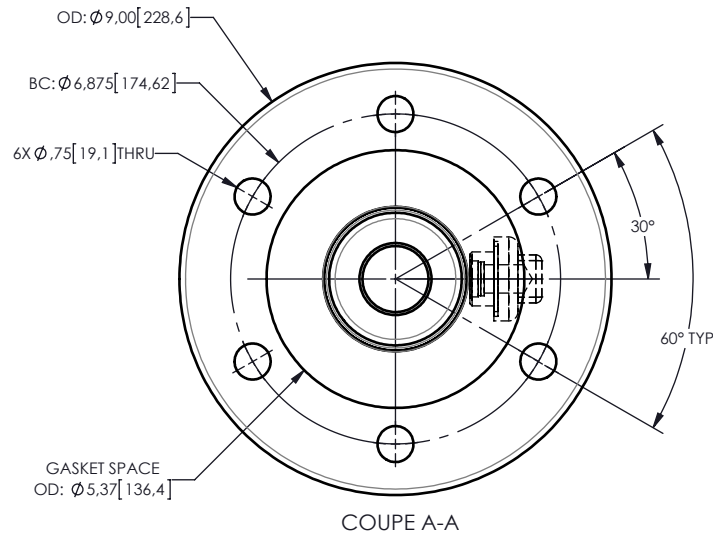
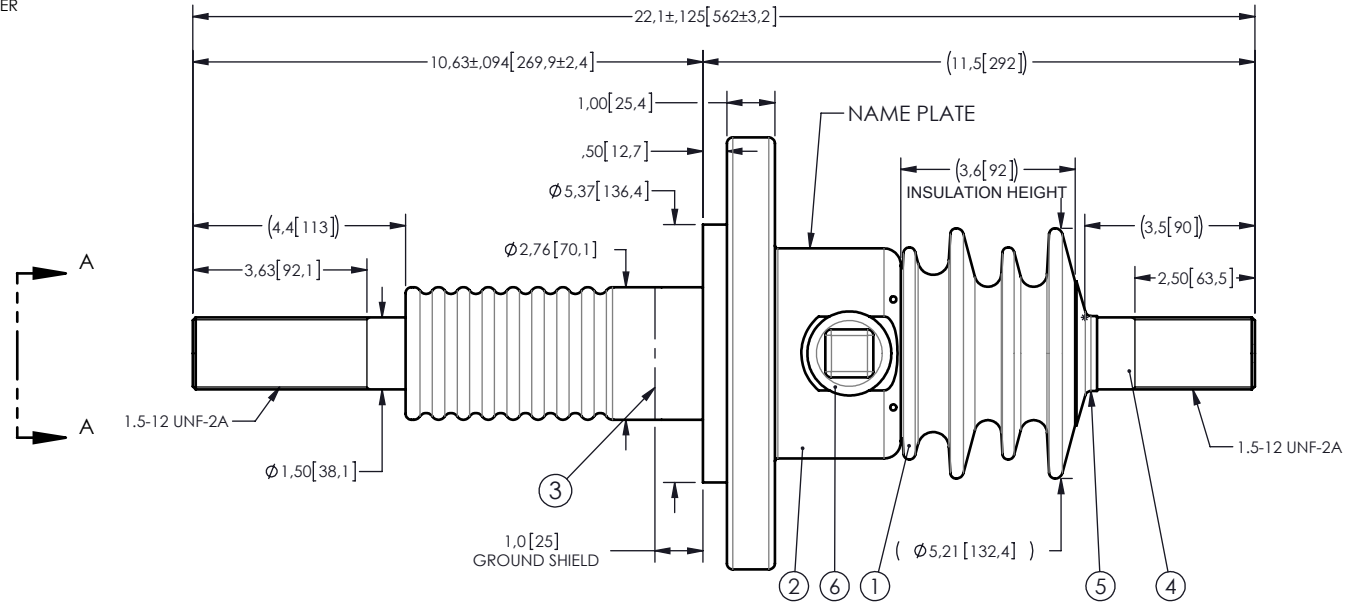

ITEM NO.	QTY	DRAWING NO.	PART NO.	DESCRIPTION	NOTE / MAT'L
6	1	S-1001-2022		CAPACITANCE TAP ASSEMBLY	ALUMINUM
5	1	S-1001-0007		CAP	COPPER
4	1	S-7739-7422		ROD ASSEMBLY	COPPER
3	1	S-7739-7421		SHIELD ASSEMBLY	COPPER
2	1	S-7739-7420		FLANGE	ALUMINUM
1	1	S-7739-7419	-001	CASTING, CYCLOALIPHATIC RESIN	EC-APG-02

PARTS LIST

GENERAL TOLERANCES (UNLESS OTHERWISE SPECIFIED)

X.	±0.125
.X	±0.094
.XX	±0.063
.XXX	±0.010
ANGLES	±0.1°
RADIUS	±0.031

REMOVE BURRS AND BREAK SHARP EDGES

DIMENSIONS ARE IN INCHES (UNLESS OTHERWISE SPECIFIED)

REPLACE:

DRAWN BY: J.N.PILOTTE DATE: 2012/08/07

CHECK BY:

PROJECT ENG.:

PROJECT MANAGER:

ElectroComposites
solid HV bushings solution

TITLE:
SDC™ BUSHING 2.4kV, 1200A
MODEL: 040-012-T-748-00

FORMAT	CAGE CODE	DRAWING NO.	REVISION
A		S-7739-7419	NR

SCALE	GENERATED BY:	SHEET
1:4	SolidWorks 2012	1 of 1

This drawing is the proprietary property of Electro Composites (2008) ULC, not part of the public domain, and is issued with the express understanding and agreement that it is not to be reproduced or copied in whole or in part or issued for furnishing information to others, or used directly or indirectly, in any way detrimental to the interest of Electro Composites (2008) ULC and is to be returned upon request by Electro Composites (2008) ULC. All Rights Reserved.