



PCORE
ELECTRIC

KV CLASS 69 kV **BIL** 350 kV **Uy** 44 kV

CURRENT RATING

2000 AMP BOTTOM CONNECTION

DWG. **CATALOG NUMBER** **GLAZE COLOR**

SD	B88023-335	BROWN
SD	B88023-335-70	LT. GRAY

TITLE
POC BUSHING
HIGH CREEPAGE, 3.31 [84.1] HIGH INTEGRAL
FLANGE ADAPTOR WITH ϕ .75 [19.0] HOLES ON
13.75 [349.2] B.C. AND .88 [22.2] RECESS
2-12 THREAD TOP TERMINAL
SPECIAL BOTTOM TERMINAL

DATE	11-12-12	REV. DATE	2-25-21
MAXIMUM ALTITUDE	10000 ft [3000 m]		
NET WEIGHT	200 lb [91 kg]		
ANGLE OF INCLINATION FROM THE VERTICAL	0° TO 60°		

MIN. CREEP	66.00 [1676.4]	MIN. STRIKE	24.00 [609.6]
CREEP/L-G	1.66 [42.1]	STD.	IEEE C57.19.00/01
PCB CONTENT OF OIL IS LESS THAN 1 ppm			

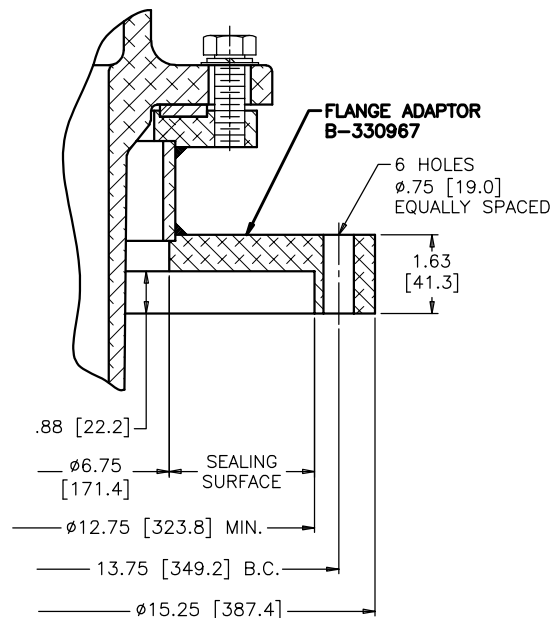
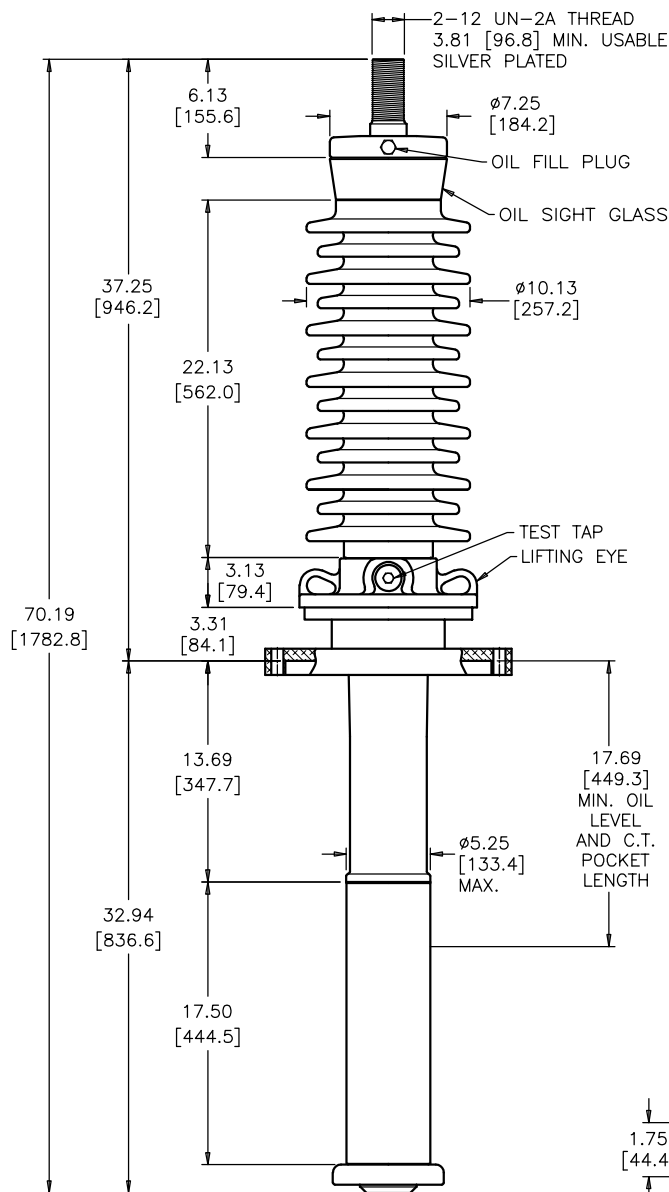

MOUNTING FLANGE

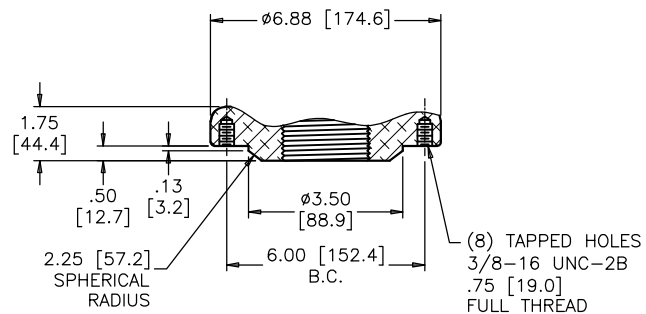

BOTTOM TERMINAL DETAIL

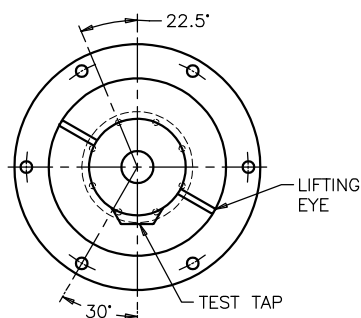

ANGLE BETWEEN BOTTOM TERMINAL AND
HOLES IN FLANGE COINCIDE WITHIN $\pm 2^\circ$

**ALIGNMENT OF FLANGE
AND BOTTOM TERMINAL
TOP VIEW**

DIMENSIONS IN INCHES [MILLIMETERS]

REVISION CREEP/L-G WAS CREEP/Uy, CORRECTED ROUNDING

SCALE 1/8

NOTE TO PURCHASER:
ALL SALES OF PCORE PRODUCTS ARE SUBJECT
TO OUR STANDARD TERMS AND CONDITIONS
AND THE LIMITED WARRANTIES THEREUNDER