

- NOTES:
- 1 CREEPAGE DISTANCE: 152.6" / 3876mm
 - 2 ARC DISTANCE: 49.8" / 1267mm
 - 3 NOMINAL VOLTAGE: 115kV
 - 4 NOMINAL CURRENT: 1600A
 - 5 VOLTAGE WITHSTAND, 60 sec.: 260kV
 - 6 BIL : 550kV
 - 7 ROUTINE TEST ACCORDING TO: IEEE C57.19.01
 - 8 MAX. TORQUE APPLIED ON FLANGE BOLTS: 70 lbf·ft / 94.9 N·m
 - 9 WEIGHT: 224 lb / 101.6 kg
 - 10 SILVER PLATED, AS PER ASTM B700, TYPE 1, GRADE D, CLASS N, NO NICKEL LAYER, FROM 13 TO 20 MICROMETERS THICKNESS

REVISIONS					
ZONE	REV.	DESCRIPTION	DRAWN BY	DATE	APPR.
C5	A	THE OUTSIDE DIAMETER OF THE FLANGE CHANGE FROM 13.19" TO 13.0"	J. CLICHE	2014-10-03	J.V.

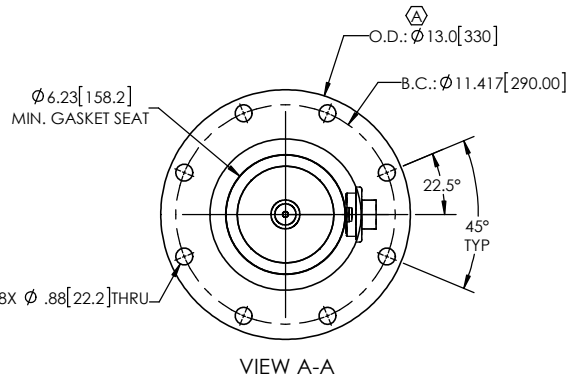
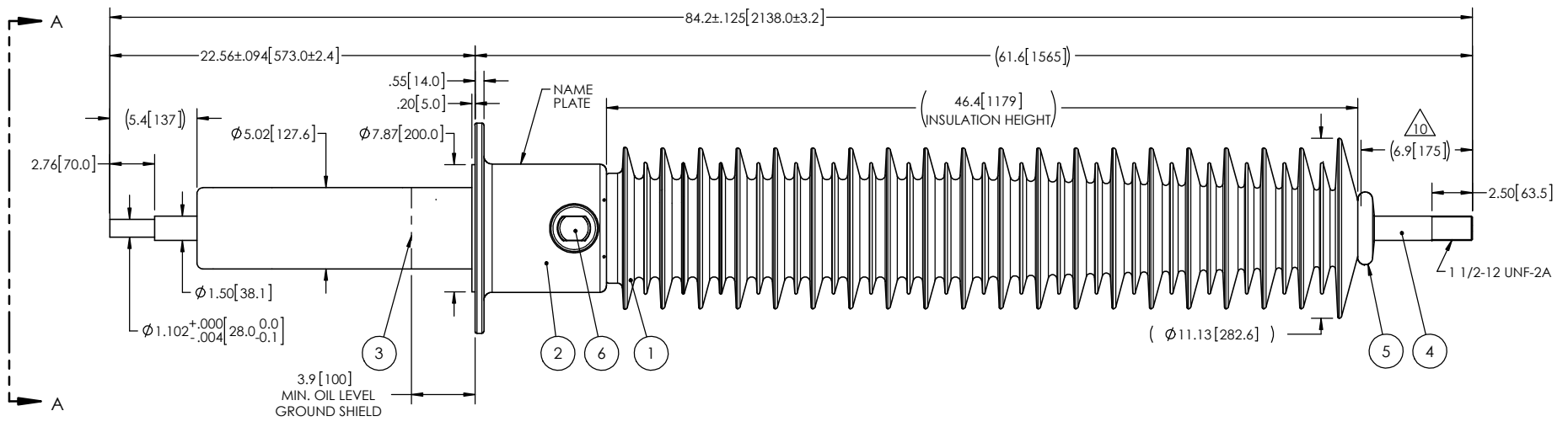

ITEM NO.	QTY	DRAWING NO.	PART NO.	DESCRIPTION	NOTE / MAT'L
6	1	S-4714-4107		CAPACITANCE TAP ASSEMBLY	ALUMINUM
5	1	S-2878-4854		CORONA RING TOP	ALUMINUM
4	1	S-8810-8501		ROD ASSEMBLY	COPPER
3	1	S-8810-8500		SHIELD ASSEMBLY	BRASS
2	1	S-8810-8499		FLANGE	ALUMINUM
1	1	S-8810-8496	-001	CASTING, CYCLOALIPHATIC RESIN	EC-APG-02

Electro Composites™
solid HV bushings solution

TITLE: **SDC® BUSHING 115kV, 1600A**
MODÈLE : 550-016-T-883-00

DRAWN BY: A.SAVARD	DATE: 2014/08/14	FORMAT: A	CAGE CODE	DRAWING NO.: S-8810-8496	REVISION: A
CHECK BY:		PROJECTING:		SCALE: 1:10	GENERATED BY: SolidWorks 2013
PROJECT MANAGER:				SHEET: 1 of 1	

GENERAL TOLERANCES (UNLESS OTHERWISE SPECIFIED)

X.	±0.125
.X	±0.094
.XX	±0.063
.XXX	±0.031
ANGLES	±0.25°
RADIUS	±0.031

REMOVE BURRS AND BREAK SHARP EDGES

DIMENSIONS ARE IN INCHES (UNLESS OTHERWISE SPECIFIED)

This drawing is the proprietary property of Electro Composites (2008) ULC, not part of the public domain, and is issued with the express understanding and agreement that it is not to be reproduced or copied in whole or in part or issued for furnishing information to others, or used directly or indirectly, in any way detrimental to the interest of Electro Composites (2008) ULC and is to be returned upon request by Electro Composites (2008) ULC. All Rights Reserved.