

- NOTES:
- 1 CREEPAGE DISTANCE: 24.9" / 632mm
  - 2 ARC DISTANCE: 10.1" / 257mm
  - 3 NOMINAL VOLTAGE: 25kV
  - 4 NOMINAL CURRENT: 10,000A
  - 5 WITHSTAND VOLTAGE AT 60 sec.: 60kV
  - 6 B.I.L. : 150kV
  - 7 ROUTINE TEST ACCORDING TO: IEEE C57.19.01
  - 8 MAX. TORQUE APPLIED ON FLANGE BOLTS: 70 lbf · ft / 94.9 N · m
  - 9 WEIGHT: 346 lb / 156.9 Kg
  - 10 MAXIMUM OPERATING TEMPERATURE: UP TO 130°C (266°F)
- △1 THE TEST TAP CAN BE ORIENTED IN 4 POSITIONS IN RELATION WITH THE BOTTOM SPADE: +22.5°±1° (AS SHOWN AT ZONE B5), +67.5°±1°, +112.5°±1° AND +157.5°±1°
- △12 SILVER PLATED, AS PER ASTM B700, TYPE 1, GRADE D, CLASS N, NO NICKEL LAYER, FROM 13 TO 20 μm THICKNESS

ZONE		REV.	DESCRIPTION	DRAWN BY	DATE	APPR.

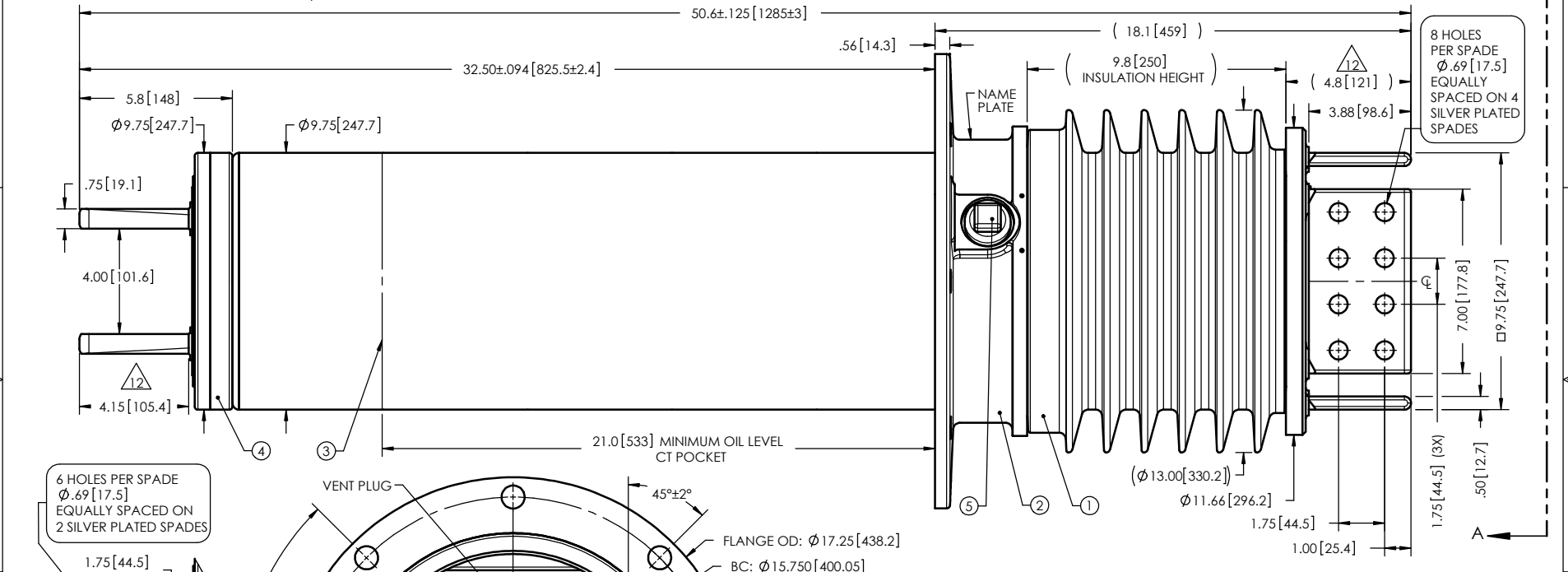

6 HOLES PER SPADE  
Ø.69 [17.5]  
EQUALLY SPACED ON  
2 SILVER PLATED SPADES

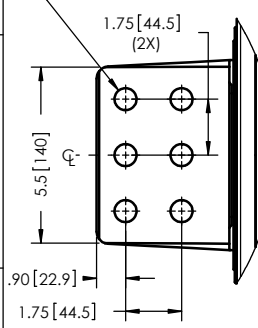

This drawing is the proprietary property of Electro Composites (2008) ULC, not part of the public domain, and is issued with the express understanding and agreement that it is not to be reproduced or copied in whole or in part or issued for furnishing information to others, or used directly or indirectly, in any way detrimental to the interest of Electro Composites (2008) ULC and is to be returned upon request by Electro Composites (2008) ULC. All Rights Reserved.

ITEM NO.	QTY	DRAWING NO.	PART NO.	DESCRIPTION	NOTE / MATL
5	1	S-1001-2022		CAPACITANCE TAP ASSEMBLY	ALUMINUM
4	1	S-2183-8627		ROD ASSEMBLY	COPPER
3	1	S-5955-5585		SHIELD ASSEMBLY	COPPER
2	1	S-5955-5584		FLANGE	ALUMINUM
1	1	S-2183-8626	-001	CASTING, CYCLOALIPHATIC RESIN	EC-APG-15NA

PARTS LIST

GENERAL TOLERANCES (UNLESS OTHERWISE SPECIFIED)		<b>Electro Composites</b> <b>solid HV bushings solution</b>	
X.	±0.125	TITLE: SDC® GSU BUSHING 25kV, 10,000A MODEL: 150-100-G-897-00	
.X	±0.094	DRAWN BY: J. CLICHE	DATE: 2014/11/24
.XX	±0.063	CHECK BY:	
.XXX	±0.031	PROJECT ENG.:	
ANGLES	±0.25°	PROJECT MANAGER:	
RADIUS	±0.031	SCALE: 1:6	GENERATED BY: SolidWorks 2013
REMOVE BURRS AND BREAK SHARP EDGES		FORMAT: A	CAGE CODE: S-2183-8626
DIMENSIONS ARE IN INCHES (UNLESS OTHERWISE SPECIFIED)		DRAWING NO.:	REVISION: NR
		SHEET: 1 of 1	