

NOTES:

- | | | | |
|---|--------------------------------------|-------------------------|-------------------------|
| 1 | CREEPAGE DISTANCE : | EXTERIOR: 27.2" / 690mm | INTERIOR: 15.7" / 399mm |
| 2 | ARC DISTANCE: | EXTERIOR: 14.3" / 364mm | INTERIOR: 10.6" / 270mm |
| 3 | NOMINAL VOLTAGE: | 25kV | |
| 4 | NOMINAL CURRENT: | 4000A | |
| 5 | VOLTAGE WITHSTAND, 60 sec.: | 60kV | |
| 6 | BL : | 150kV | |
| 7 | ROUTINE TEST ACCORDING TO: | IEEE C57.19.01 | |
| 8 | MAX. TORQUE APPLIED ON FLANGE BOLTS: | 40 lbf·ft / 54.2 N·m | |
| 9 | WEIGHT: | 150 lb / 67.9 kg | |

△10 SILVER PLATED, AS PER ASTM B700, TYPE 1, GRADE D, CLASS N, NO NICKEL LAYER, FROM 13 TO 20 MICROMETERS THICKNESS

REVISIONS				
ZONE	REV.	DESCRIPTION	DRAWN BY	DATE

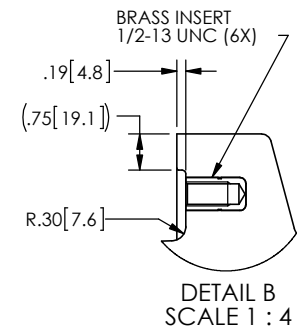
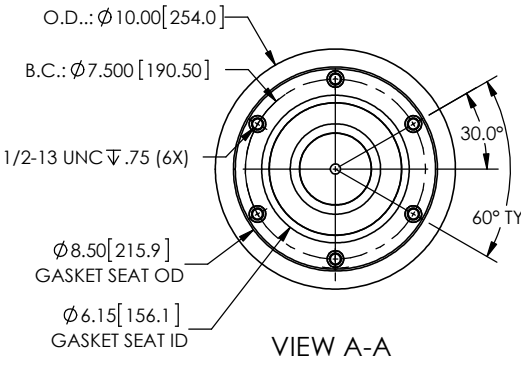
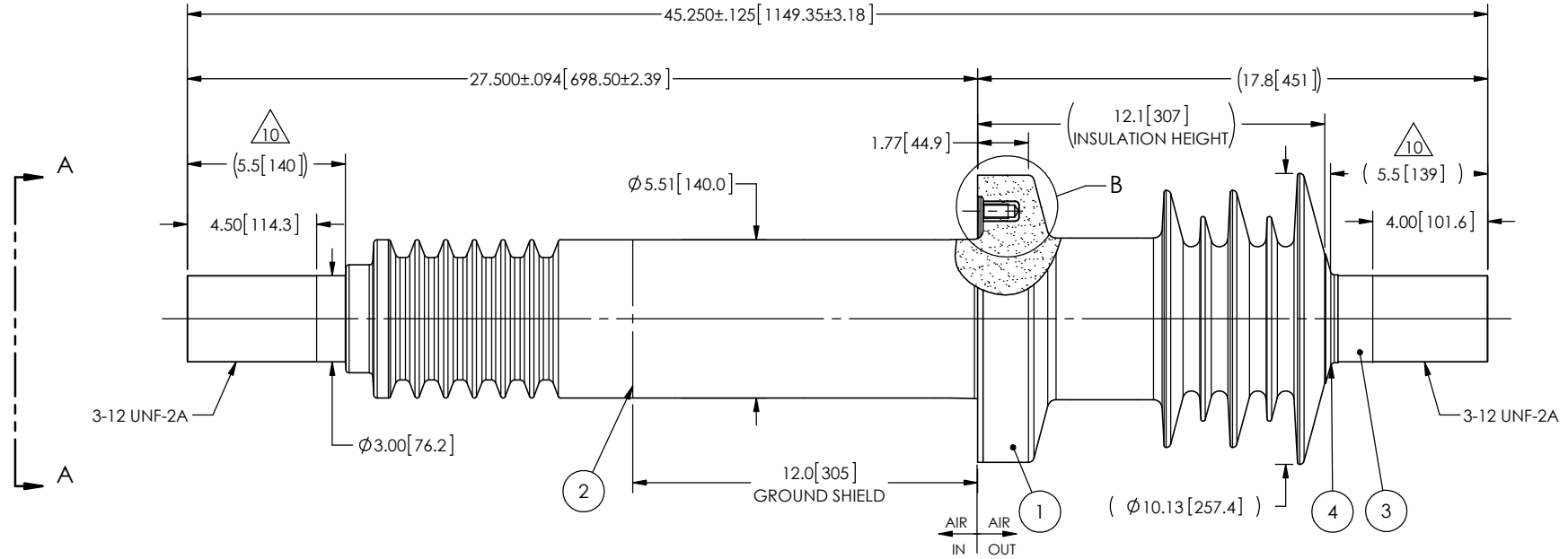

ITEM NO.	Qté	DRAWING NO.	PART NO.	DESCRIPTION	NOTE / MAT'L
4	1	S-3529-2532		CAP	COPPER
3	1	S-8218-8851		ROD ASSEMBLY	COPPER
2	1	S-8218-8850		SHIELD ASSEMBLY	COPPER
1	1	S-8218-8849	-001	CASTING, CYCLOALIPHATIC RESIN	EC-APG-02

PARTS LIST

GENERAL TOLERANCES (UNLESS OTHERWISE SPECIFIED)

X.	±0.125
.X	±0.094
.XX	±0.063
.XXX	±0.031
ANGLES	±0.25°
RADIUS	±0.031

REMOVE BURRS AND BREAK SHARP EDGES
DIMENSIONS ARE IN INCHES (UNLESS OTHERWISE SPECIFIED)

Electro Composites
solid HV bushings solution

TITLE: SDC® BUSHING 25kV, 4000A
MODEL: 150-040-W-919-00

DRAWN BY: J.N.PILOTTE	DATE: 2015/06/02	FORMAT: A	CAGE CODE: S-8218-8849	DRAWING NO.:	REVISION: NR
CHECK BY:	PROJECT ENG.:	PROJECT MANAGER:	SCALE: 1:6	GENERATED BY: SolidWorks 2013	SHEET: 1 of 1

This drawing is the proprietary property of Electro Composites (2008) ULC, not part of the public domain, and is issued with the express understanding and agreement that it is not to be reproduced or copied in whole or in part or issued for furnishing information to others, or used directly or indirectly, in any way detrimental to the interest of Electro Composites (2008) ULC and is to be returned upon request by Electro Composites (2008) ULC. All Rights Reserved.