

Post	P250053S0420	1
Suspension	S0250053S0000	1
Anchor Shackle	AS-50	2
Part Number	Qty	

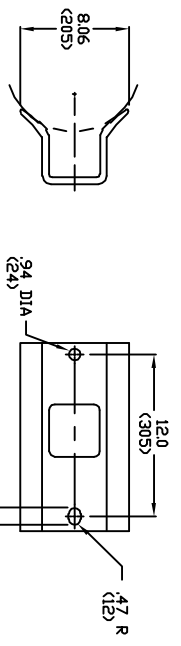

Mounting Base Detail

ELECTRICAL CHARACTERISTICS IN ACCORDANCE WITH ANSI C29.11-1988

DRY 60 HZ FLASHOVER	505
WET 60 HZ FLASHOVER	450
IMPULSE POSITIVE FLASHOVER	790
IMPULSE NEGATIVE FLASHOVER	825

ELECTRICAL CHARACTERISTICS IN ACCORDANCE WITH IEC-60383

WET 60 HZ 1-MIN WITHSTAND	335
IMPULSE POSITIVE WITHSTAND	710
IMPULSE NEGATIVE WITHSTAND	740

MAX WORKING LOADS, LBS(KN)

VERTICAL	10000 (44.4)
TRANSVERSE TENSION	7500 (33.3)
COMPRESSION	7500 (33.3)
LONGITUDINAL	1355 (6)
LEAKAGE DISTANCE	137
STRIKE DISTANCE	51.7

REV DATE 09/09/09

CONFERENTIAL THE DRAWING AND ITS CONTENTS ARE CONFIDENTIAL AND THE INFORMATION CONTAINED HEREIN IS UNCLASSIFIED EXCEPT WHERE SHOWN OTHERWISE. ALL RIGHTS RESERVED UNDER THE COPYRIGHT LAWS.

HUBBELL POWER SYSTEMS

TITLE: QUADRI SIL BRACED LINE POST ASSY

SIZE: B

DWG NO: BLP053G00000

CAT / PART / ASSY NO: BLP053G00000

DEN BY: JVR

DATE: 03/31/08

SHEET 1 OF 1