

4

3

2

1

FIG. NO.	CATALOG NUMBER	CU CONDUCTOR DIAMETER RANGE (MIN. - MAX.)	CU CONDUCTOR RANGE (MAX. - MIN.)	DIM A	DIM B	DIM C	DIM D	DIM E	HARDWARE BOLT STUD (HEX.)	APPROX. WT. EACH LB. [KG]	STANDARD PACK
1	GC207*	.286 - .204 [7.28 - 5.19]	#6 Sol. - 1/0 Str.	1.250 [31.81]	.750 [19.09]	1.875 [47.72]	.500 [12.70]	.313 [7.95]	.562 [14.29]	.21 [.10]	25
2	GC208	.128 - .229 [3.26 - 5.83]	#4 Str. - 2/0 Str.	1.313 [33.40]	.813 [20.69]	1.875 [47.72]	.500 [12.70]	.313 [7.95]	.562 [14.29]	.29 [.13]	25
3	GC209	.438 - .289 [11.15 - 7.36]	#3 Sol. - 4/0 Str.	1.500 [38.18]	1.125 [28.63]	1.750 [44.54]	.500 [12.70]	.313 [7.95]	.562 [14.29]	.40 [.18]	20

ITEM	DESCRIPTION	MATERIAL
1	MALE CASTING	BRONZE
2	FEMALE CASTING	BRONZE
3	BOLT	STAINLESS STEEL
4	3/8" WASHER	STAINLESS STEEL
5	NUT	STAINLESS STEEL
6	1/2" WASHER	STAINLESS STEEL

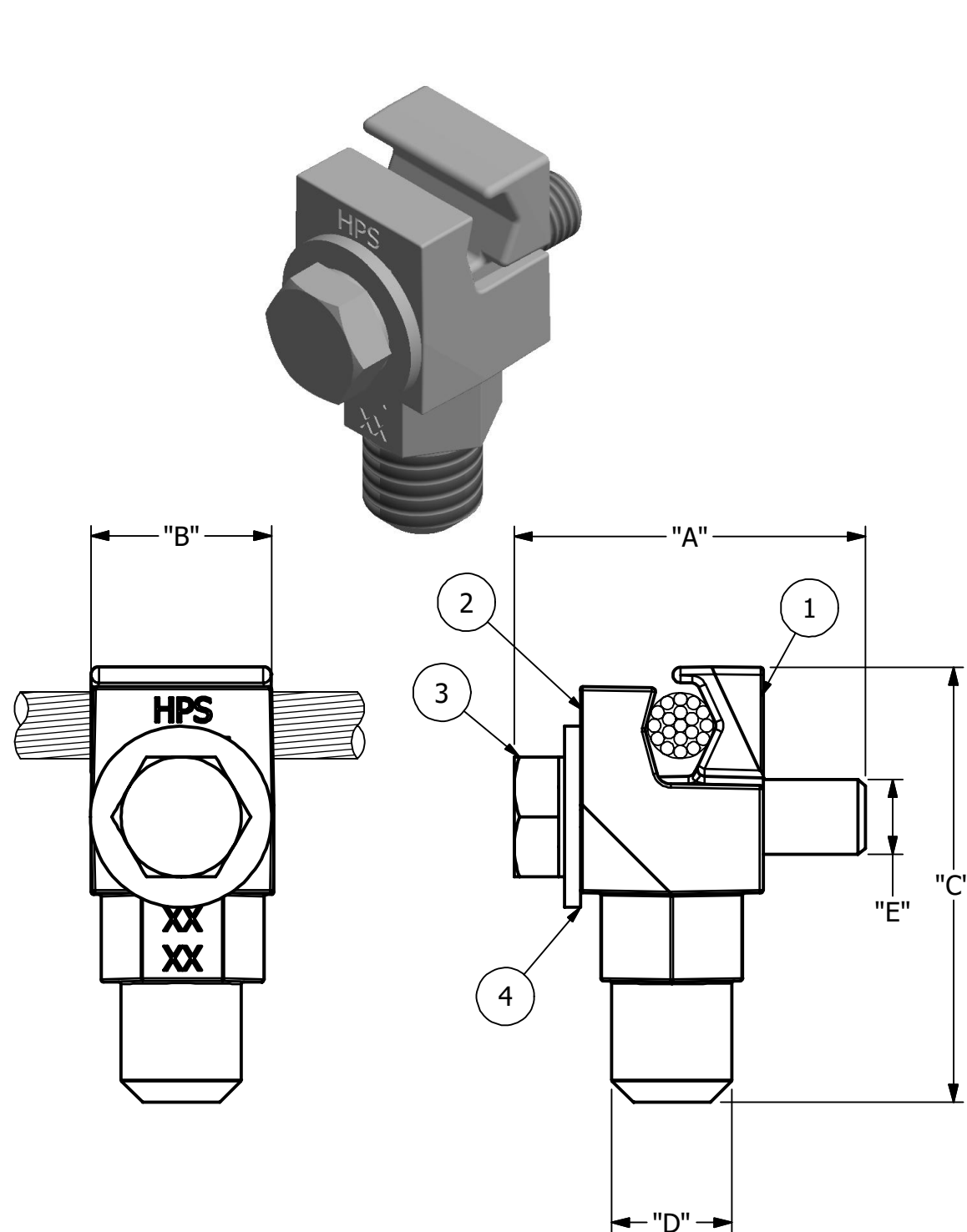

FIG 1

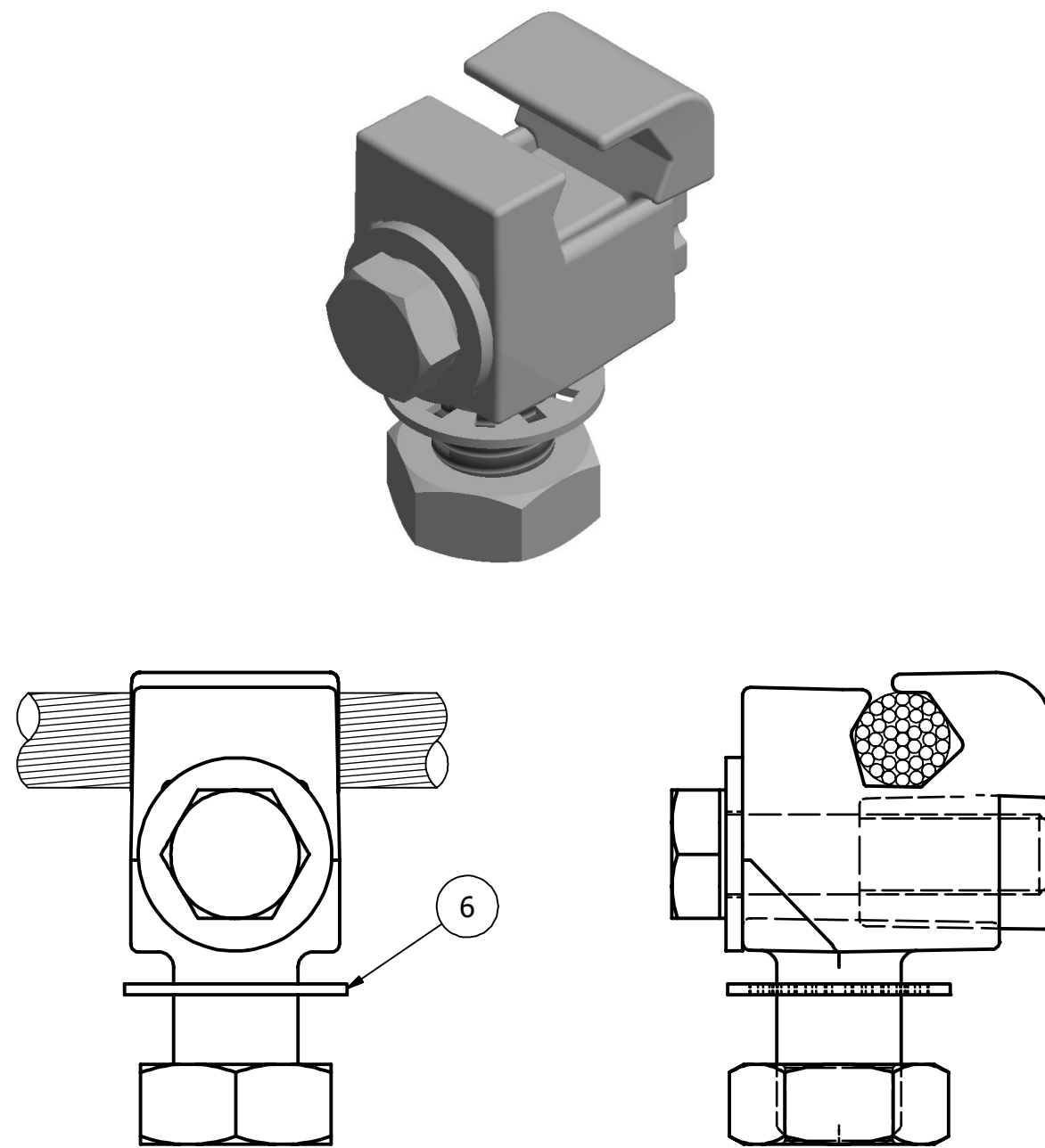

FIG 2

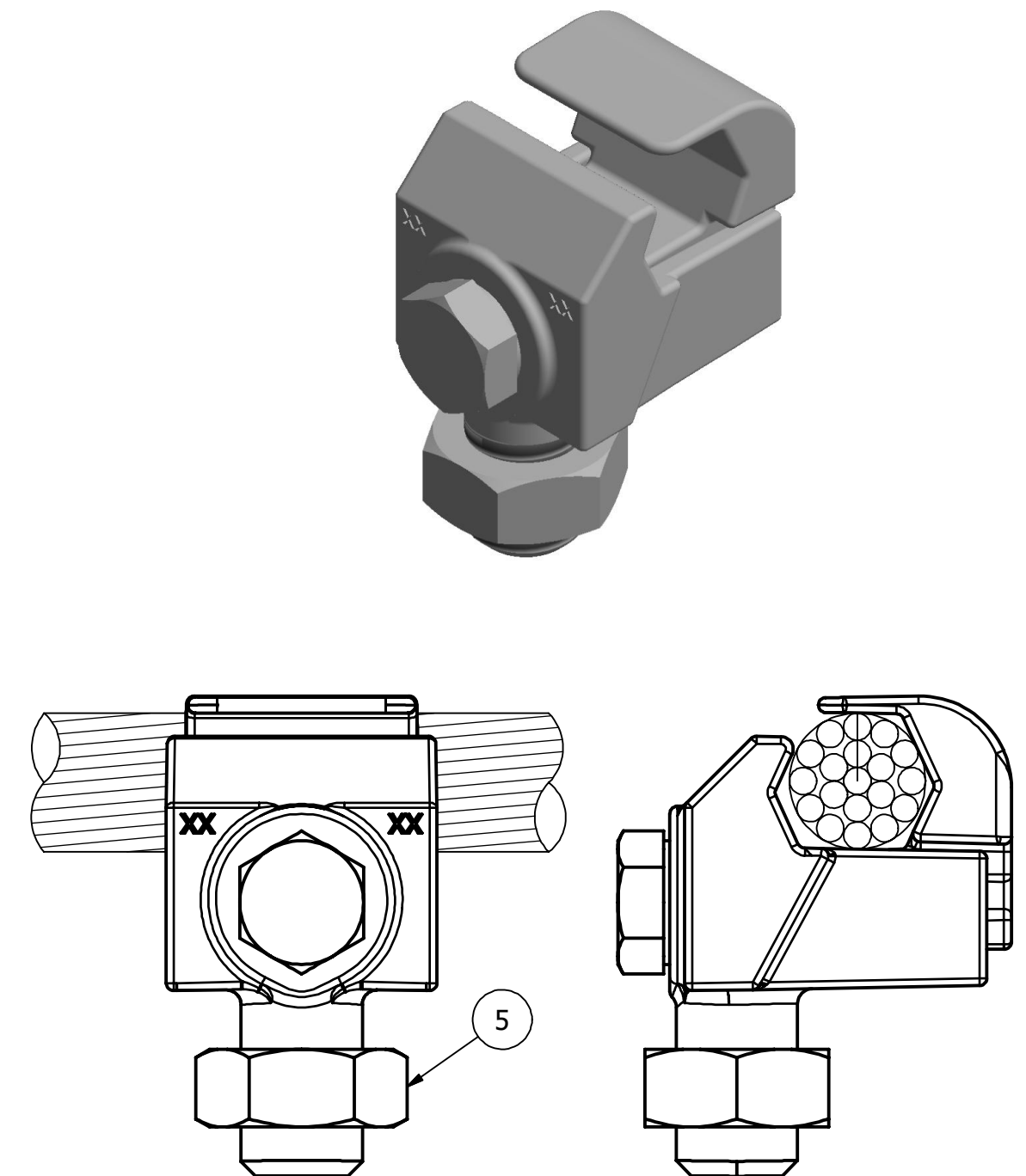

FIG 3

NOTES:

- ALL DIMENSIONS FOR REFERENCE ONLY IN. [MM], FORCE LBS [KN], TORQUE IN. LBS [N.M] & WEIGHT LBS. [KG].
- RATINGS:
 - RECOMMENDED TORQUE BOLT - 180 IN.LBS [20.34]
STUD - 480 IN.LBS [54.23]
- CERTIFICATIONS, SPECIFICATIONS & STANDARDS:
 - *RUS LISTED
- A SUFFIX IS ADDED TO THE CATALOG NUMBER TO DESIGNATE THE REQUIRED FITTINGS AS SHOWN IN THE TABULATION (EXAMPLE:GC207P) :
"P" - TIN PLATED

220908023768	9/8/22	BM	RT	SD
EC #	DATE	CHANGED BY	CHECKED BY	APPROVED BY
DESCRIPTION:				WEIGHT, LBS
UPDATED GC209 ASSEMBLY				SEE TABLE
UPDATED NEW TEMPLATE				
--				
--				
--				
ADDITIONAL COMMENTS: --				

THIRD ANGLE PROJECTION

CONFIDENTIAL: THIS DRAWING AND ITS CONTENTS ARE CONFIDENTIAL AND THE EXCLUSIVE PROPERTY OF HUBBELL POWER SYSTEMS. NO PUBLICATION, DISTRIBUTION OR COPIES MAY BE MADE WITHOUT THE WRITTEN CONSENT OF HUBBELL POWER SYSTEMS. HUBBELL POWER SYSTEMS UNPUBLISHED ALL RIGHTS RESERVED UNDER THE COPYRIGHT LAWS

HUBBELL POWER SYSTEMS, Inc.

TITLE: **CONNECTOR, CU GROUNDING TYPE GC20X**

CATALOG NUMBER: **SEE TABLE**

SIZE	DWG NO.	PART / ASSY NO.	REV
C	CC-20597	SEE TABLE	2

SCALE: 3 : 2 DRN BY: NLA DATE: 10/31/18 SHEET 1 OF 1

4

3

2

1