

CATALOG NUMBER	CONDUCTOR RANGE (MIN-MAX)	PRIMARY STRAND CONDUCTOR	BURNDY INDEX	KEARNEY	ALCOA DIE	T & B CODE	EEI DIE	DIELESS TOOL: ANDERSON	DIM A	DIM B	DIM C	STANDARD PACK	APPROX WT. EACH LBS
PTA10	.336 - .373 [8.53 - 9.47]	1/0 (7,19 STR)	BG OR 243	5/8 OR 5/8-1	B24EA	52	8A	VC6 (ALL)	3.25	.656	.406	50	.10
PTA40	.475 - .528 [12.06 - 13.41]	4/0 (7,19 STR)	249	.840	B49EA	76	11A	VC6 (ALL)	4.00	.859	.568	25	.20
PTA337	.603 - .666 [15.31 - 16.91]	336.4 (19 OR 37 STR)	321, 705, 655	1-1/8-1 OR 1-1/8-2	B80EA	96	-	VC6 (ALL)	4.50	1.062	.703	25	.33
PTA350	.616 - .681 [15.64 - 17.29]	350 (19, 36, 61 STR)	.490 OR 547	1-1/8-1 OR 1-1/8-2	B80EA	96	-	VC6FT	6.50	1.105	.718	25	.40
PTA477	.722 - .814 [18.33 - 20.68]	477 OR 500 (19 OR 37 STR)	317, 327 OR 426	1-1/8-2	B80EA	106	14A	VC6FT	6.25	1.250	.843	25	.50
PTA556	.780 - .858 [19.81 - 21.79]	556.5 (19 OR 37 STR)	261 OR 318	1-5/16	B76AH	115	15A	VC8	8.75	1.390	.906	25	.90
PTA636	.835 - .918 [21.20 - 23.31]	636 (37 STR)	469	1-1/2	B024AH	125	-	VC8	7.50	1.531	.969	25	1.50
PTA795	.932 - 1.031 [23.67 - 26.18]	750-800 (37 OR 61 STR)	342	1-5/8	B027AH	140	-	VC8	10.5	1.625	1.063	15	1.49

ITEM	DESCRIPTION	MATERIAL
1	SLEEVE	ALUMINUM
2	PLUG	POLYMER

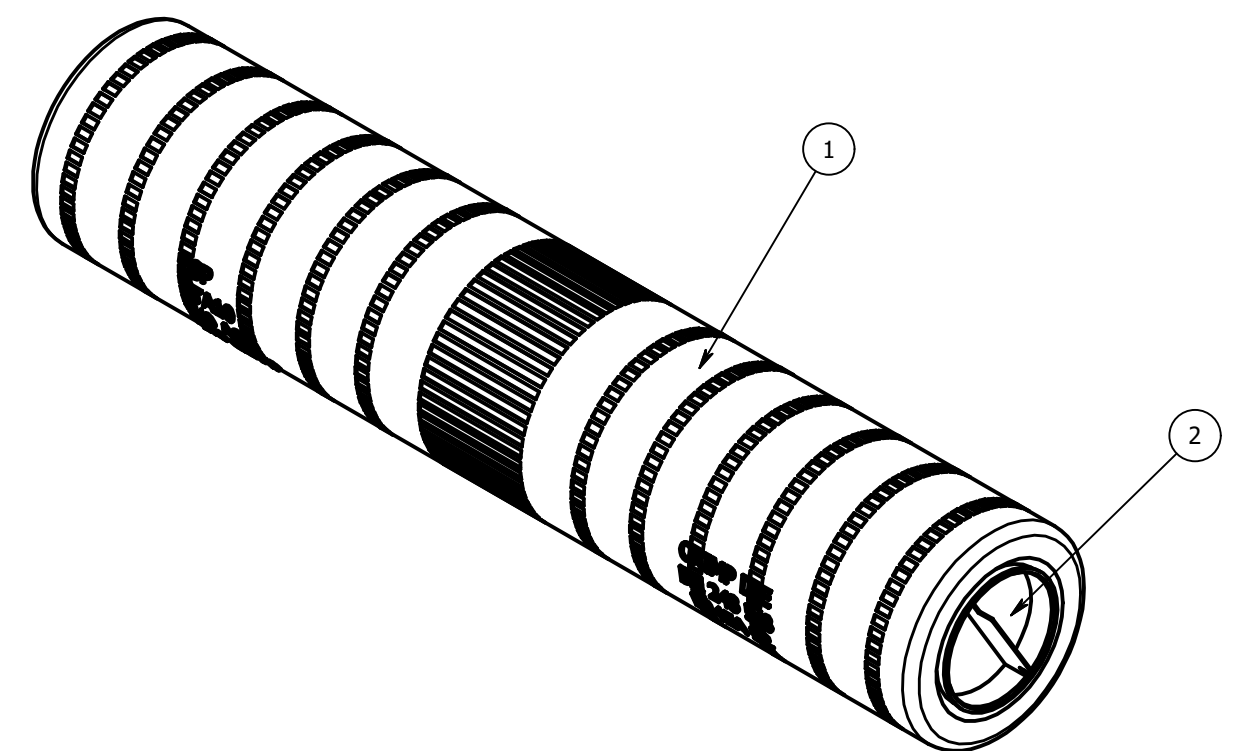
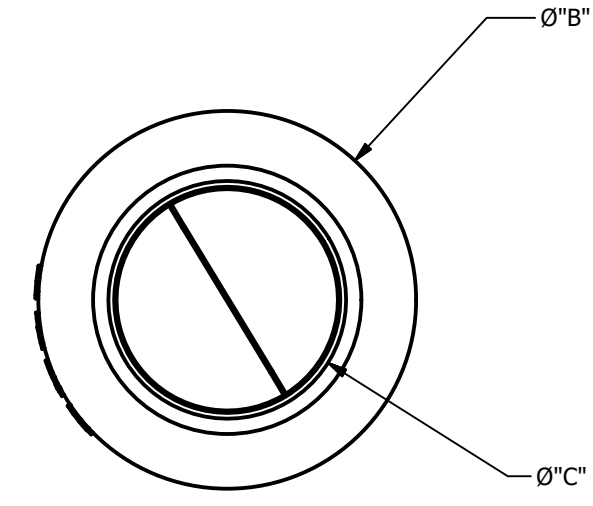
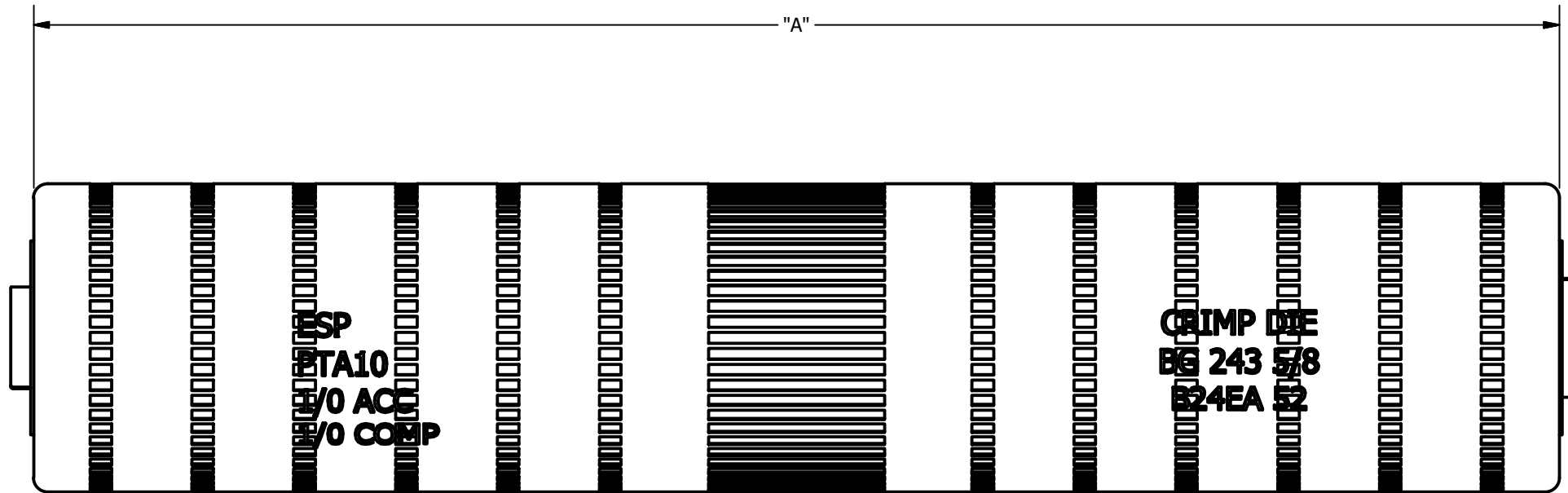

- NOTES:
- ALL DIMENSIONS FOR REFERENCE ONLY IN. [MM].
 - THESE LOOP TENSION COMPRESSION SLEEVES ARE RECOMMENDED FOR SLACK SPAN SPLICING OF STANDARD ALUMINUM (SAC), COMPRESSED AND COMPACT ALUMINUM CONDUCTORS. SPLICES MEET DESIGN CRITERIA FOR CLASS 2 "PARTIAL TENSION" CONNECTORS PER ANSI SPECIFICATION C119.4. THEY WILL HOLD A MINIMUM OF 40% OF THE CONDUCTOR RATED ULTIMATE STRENGTH WITHOUT FAILURE.
 - SLEEVES HAVE CENTER BARRIER WALLS AND ARE FACTORY INHIBITED WITH ANDERSON VERSA SEAL 155 ELECTRICAL JOINT COMPOUND AND PLUGGED.
 - SLEEVES ARE METAL EMBOSSED WITH CATALOG NUMBER, CONDUCTOR SIZE RATING, RECOMMENDED CRIMPING DIES AND BITE LOCATIONS.

74716	6/22/2018	NLA	SD	HPS.	HUBBELL® POWER SYSTEMS <small>POWER SYSTEMS, INC.</small>			
EC #	DATE	CHG BY	RESP ENG					
DESC OF DWG: NEW CUSTOMER DRAWING IN INVENTOR				CONFIDENTIAL: THIS DRAWING AND ITS CONTACTS ARE CONFIDENTIAL AND THE EXCLUSIVE PROPERTY OF HUBBELL POWER SYSTEMS. NO PUBLICATION, DISTRIBUTION OR COPIES MAY BE MADE WITHOUT THE WRITTEN CONSENT OF HUBBELL POWER SYSTEMS. HUBBELL POWER SYSTEMS UNPUBLISHED ALL RIGHTS RESERVED UNDER THE COPYRIGHT LAWS	TITLE PARTIAL TENSION COMPRESSION SPLICE SAC, COMPRESSED & COMPACT ALUMINUM			
REASON (S) FOR CHANGE: DISPOSITION OF MAT'L:					<table border="1"> <tr> <td>SIZE C</td> <td>DWG NO. CC-215-E</td> <td>CAT / PART / ASSY NO. SEE TABLE</td> <td>REV 02</td> </tr> </table>	SIZE C	DWG NO. CC-215-E	CAT / PART / ASSY NO. SEE TABLE
SIZE C	DWG NO. CC-215-E	CAT / PART / ASSY NO. SEE TABLE	REV 02					
DO NOT SCALE THIS DRAWING		DRN BY NLA	DATE 6/22/2018	SHEET 1 OF 1				