

200 - Amp Bushing Well



Technical Data

Indoor Applications

Cycloaliphatic Epoxy

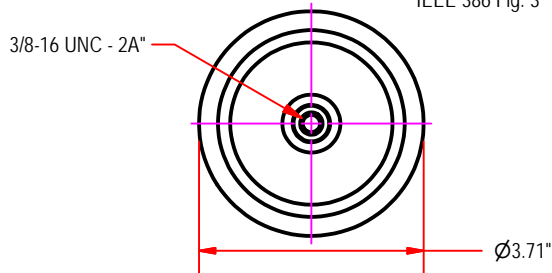
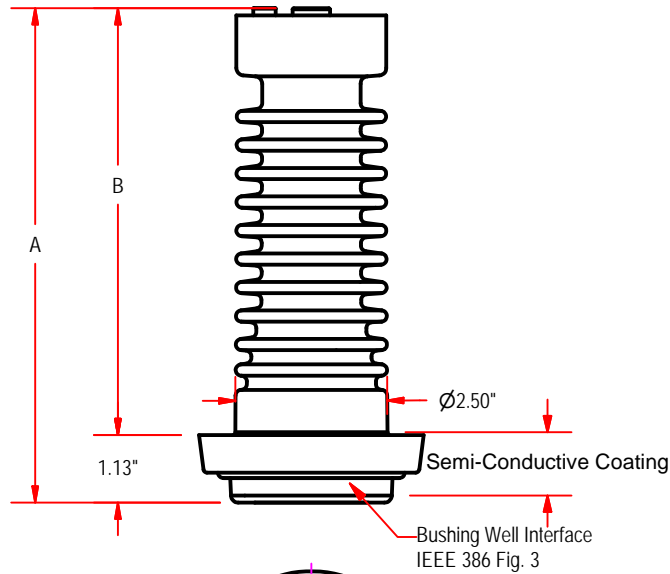
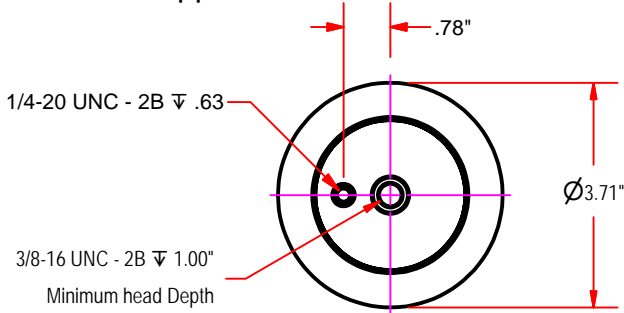

Part #	Dimensions (in.)		Electrical Ratings (kV)					Leakage Distance (In.)	Current Capacity (RMS)		Momentary Withstand (RMS, ASYM)	
	A	B	Voltage Class(kV)	BIL (kV)	Withstand 1 Min. 60 Hz. (kV)	Withstand 15 Min. D.C. (kV)	Corona Extinction		Continuous (Amps)	8-Hr. Overload (Amps)	10 Cycles (Amps)	3 Seconds (Amps)
U-UBWF95	8.25	7.00	15	95	34	53	11	13.47	200	300	10,000	3,500
U-UBWF125	10.88	9.63	25	125	40	78	19	19.83	200	300	10,000	3,500

Part #	Mechanical			Weight (Lbs.)
	Cantilever on Stud	Axial on Stud	Torque on Stud	
U-UBWF95	270 lbs.	1,500 lbs.	18 ft./lbs.	2.25
U-UBWF125	270 lbs.	1,500 lbs.	18 ft./lbs.	3.75

1. Reuel 200-amp 15 kV and 25 kV Bushing Wells meet all requirements of ANSI/IEEE Standard 386. The Bushing Wells accept all bushing inserts which meet ANSI/IEEE Standard 386 requirements. The Bushing Wells are made for cover of sidewall mounting in transformers, switchgear and other air-insulated apparatus.



PCORE Electric Co., Inc.
200 West Dewey St.
Goldsboro, NC 27530

Phone: +1.919.734.0460
Fax: +1.919.734.0902
www.hubbellpowersystems.com

Data Sheet DSUBWF-01
20 October 2015