

ITEM	DESCRIPTION	MATERIAL
1	BODY	ALUMINIUM
2	SPRING RETAINER	HDPE
3	JAW SPRING	STAINLESS STEEL
4	NOSE JAW	ALUMINIUM
5	COTTER PIN	STAINLESS STEEL
6	ROLL PIN	STAINLESS STEEL
7	CLEVIS PIN	1018-STEEL-HDG
8	THREADED SPRING PLUNGER	STAINLESS STEEL

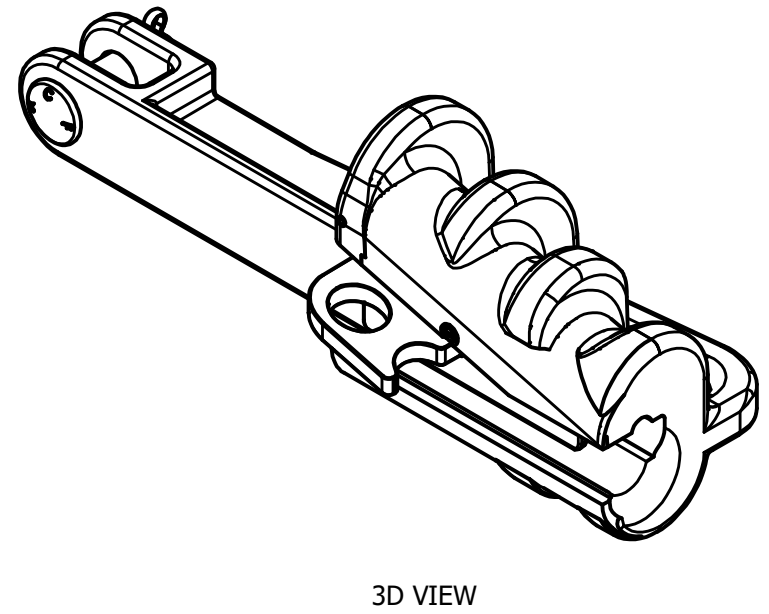

- NOTES:**
- ALL DIMENSIONS FOR REFERENCE ONLY.
DISTANCE IN. [MM], FORCE LBS. [kN], TORQUE IN. LBS. [N.m], & WEIGHT LBS. [KG].
 - MATERIAL: SEE TABLE
 - CABLE RANGE: 2/0 AAC, AAAC, ACSR, 2/0 Cu (DIA. 0.4 [10.16]) Min-397.5 AAC, AAAC, ACSR, 397.5 Cu (DIA. 0.806 [20.47]) Max

-		PREM	SP	SP	
EC #	DATE	CHANGED BY	CHECKED BY	APPROVED BY	
EC DESCRIPTION:				WEIGHT (lbmass)	 THIRD ANGLE PROJECTION
				3.785	
ADDITIONAL COMMENTS:				CONFIDENTIAL: THIS DRAWING AND ITS CONTENTS ARE CONFIDENTIAL AND THE EXCLUSIVE PROPERTY OF HUBBELL POWER SYSTEMS. NO PUBLICATION, DISTRIBUTION OR COPIES MAY BE MADE WITHOUT THE WRITTEN CONSENT OF HUBBELL POWER SYSTEMS. HUBBELL POWER SYSTEMS UNPUBLISHED ALL RIGHTS RESERVED UNDER THE COPYRIGHT LAWS	

 HUBBELL POWER SYSTEMS, Inc.			
TITLE			
AUTOMATIC SIDE OPEN DEAD END			
CATALOG NUMBER: EM-SODE203970S-SRP			
SIZE	DWG NO.	PART / ASSY NO.	REV
B	EM-SODE203970S-SRP-CC	EM-SODE203970S-SRP	A
SCALE: NTS	DRN BY: PREM	DATE: 9/22/2023	SHEET 1 OF 1