

ITEM NO.	DESCRIPTION	QTY.	CATALOG NUMBER	LENGTH	COLOR	DESCRIPTION
1	CAT 6 PATCH CABLE	1	6110PCL3	3 FEET	YELLOW	ASSEMBLY, PATCH CORD, CAT 6 SERIES, 6110 TO 6110
2	6110 4-PAIR PLUG	2	6110PCL5	5 FEET	YELLOW	ASSEMBLY, PATCH CORD, CAT 6 SERIES, 6110 TO 6110
3	TRACEABILITY LABEL	1	6110PCL7	7 FEET	YELLOW	ASSEMBLY, PATCH CORD, CAT 6 SERIES, 6110 TO 6110
			6110PCL9	9 FEET	YELLOW	ASSEMBLY, PATCH CORD, CAT 6 SERIES, 6110 TO 6110
			6110PCL12	12 FEET	YELLOW	ASSEMBLY, PATCH CORD, CAT 6 SERIES, 6110 TO 6110

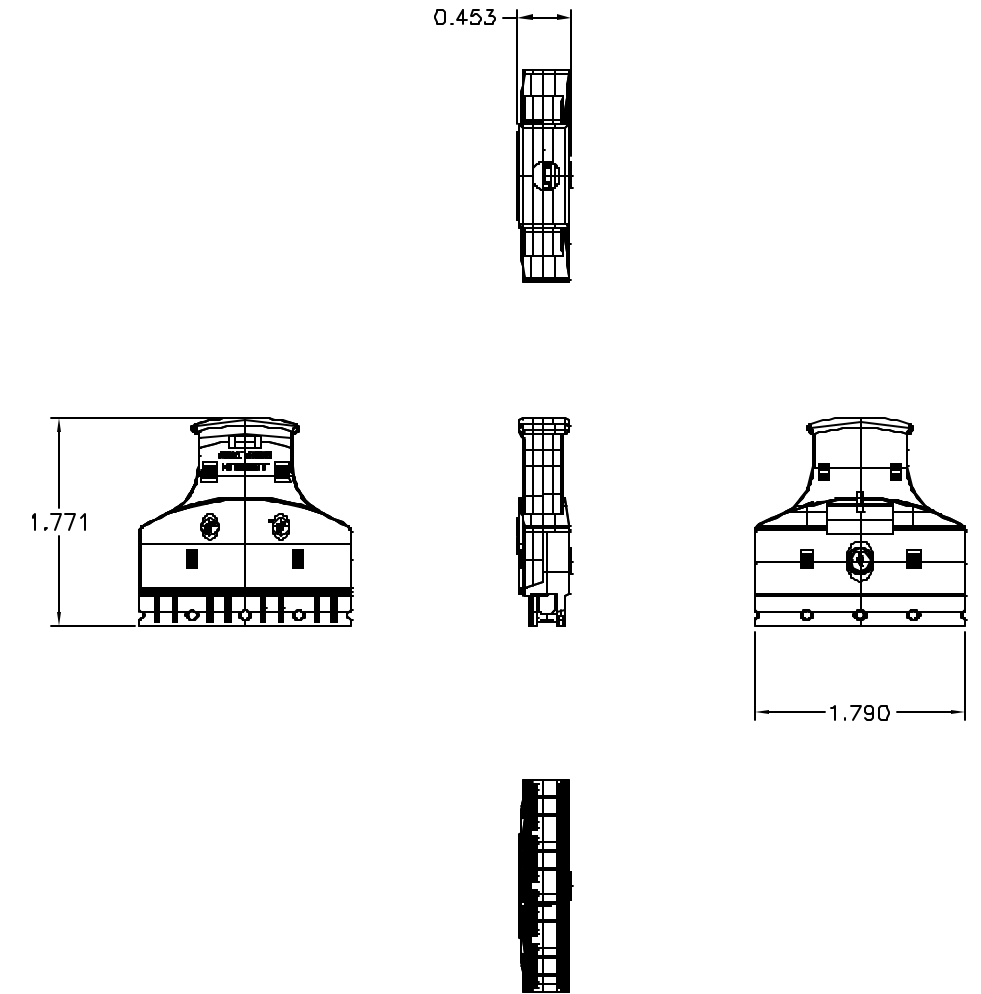
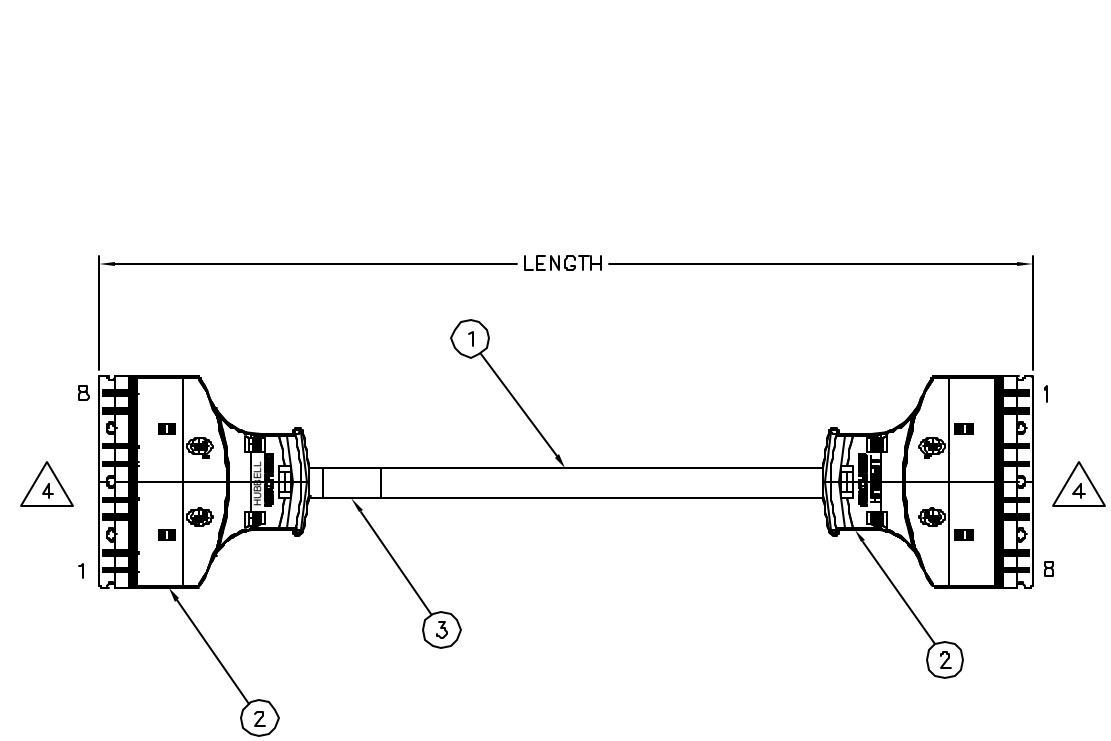

**PLUG DETAIL**

**NOTES:**

1. MEETS PROPOSED TIA/EIA AND ISO/IEC CATEGORY 6 CHANNEL PERFORMANCE WHEN USED IN CONJUNCTION WITH THE "NEXT SPEED" CAT 6 SYSTEM (NS6-110) AND APPROVED CABLES.
2. PATCH CORD: CATEGORY 6, 24 AWG TINNED COPPER, 0.024 NOMINAL DIAMETER.
3. 6110 4-PAIR PLUG: FLAME RETARDENT ENGINEERING THERMOPLASTIC BODY TRANSLUCENT GREY. CONTACTS: COPPER ALLOY WITH 100 MICRINCHES MIN. NICKEL PLATING.

- 4. WIRING DETAIL:**  
 STANDARD 110 T568B (TIA/EIA) WIRING
- |                  |                 |
|------------------|-----------------|
| 1 - WHITE/BLUE   | 5 - WHITE/GREEN |
| 2 - BLUE         | 6 - GREEN       |
| 3 - WHITE/ORANGE | 7 - WHITE/BROWN |
| 4 - ORANGE       | 8 - BROWN       |

REV.	ECN	DATE	DESCRIPTION	CHG BY	APPD BY
A	4293	12/18/01	INITIAL RELEASE	PSM	R.R.

Created on AUTOCAD

DIMENSIONING AND TOLERANCE PER ANSI Y14.5M-1982 UNLESS OTHERWISE SPECIFIED, DIMENSIONS ARE IN INCHES (MM).  
 TOLERANCES  
 .XX = ±.01 (.25)  
 .XXX = ±.005 (.127)  
 .XXXX = ±.0025 (.0635)  
 ANGLE TOL ±1°

IN ACCEPTING OUR DRAWINGS, BLUEPRINTS, OR SUPPORTING DOCUMENTATION FOR QUOTATION OR OTHER PURPOSES, YOU AGREE NOT TO DISCLOSE TO OTHERS THE IDEAS, INFORMATION, OR DESIGNS SHOWN HEREIN, AND THAT YOU WILL MAKE NO USE OF SAME WITHOUT PERMISSION

PROJECT REFERENCE:

MATERIAL:

DRAWN BY:  
PAUL S. MAGUIRE 12/18/01

CHECKED BY:

APPROVED BY:  
RAY RODDEN 01/23/02

**HUBBELL** Hubbell Premise Wiring  
 HUBBELL INCORPORATED (Delaware)  
 14 Lord's Hill Road, Sturington, Connecticut 06378

TITLE:  
ASSEMBLY, PATCH CORD,  
CAT 6 SERIES, 6110 TO 6110

SIZE: C DRAWING NO.: C1165501

SCALE: 1/1 SHEET 1 OF 1

REV. A