

6

5

4

3

2

1

ITEM NO.	DESCRIPTION	QTY.
1	ADAPTER, LC DUPLEX SC-STYLE	1
2	DUST CAP	4

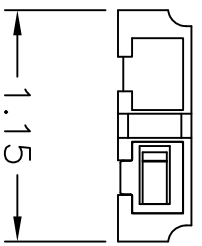
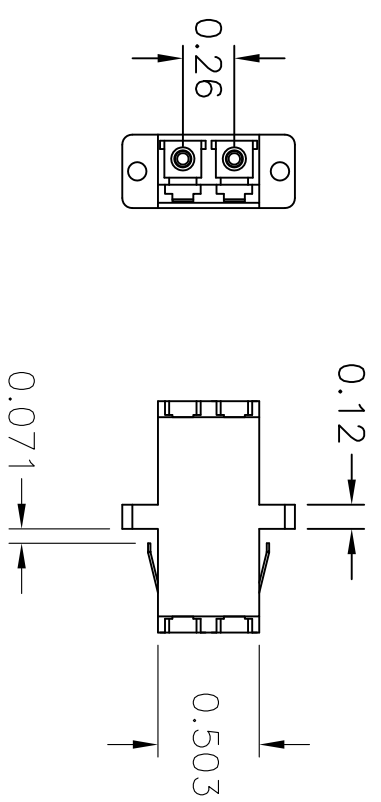
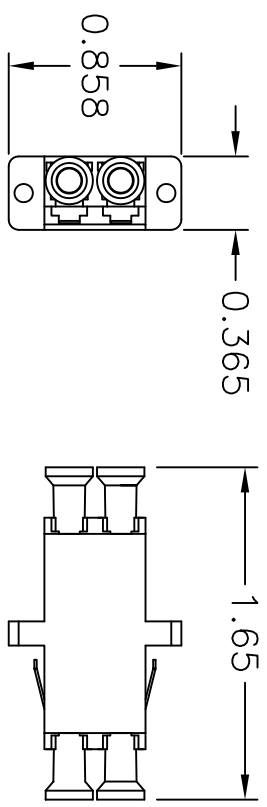

CATALOG NUMBER	HOUSING COLOR	DESCRIPTION	SPLIT SLEEVE MATERIAL
FALCDMS6BK	BLACK	LC DUPLEX ADAPTER	PHOS BRONZE
FALCDMS6AQ	AQUA	LC DUPLEX ADAPTER	PHOS BRONZE
FALCDMS6BE	BEIGE	LC DUPLEX ADAPTER	PHOS BRONZE
FALCDMS6R	RED	LC DUPLEX ADAPTER	PHOS BRONZE
FALCDMS6Y	YELLOW	LC DUPLEX ADAPTER	PHOS BRONZE
FALCDMS6GN	GREEN	LC DUPLEX ADAPTER	PHOS BRONZE
FALCDMS6B	BLUE	LC DUPLEX ADAPTER	PHOS BRONZE
FALCDMS6OR	ORANGE	LC DUPLEX ADAPTER	PHOS BRONZE
FALCDSS6B	BLUE	LC DUPLEX ADAPTER, PC	ZIRCONIA
FALCDSS6R	RED	LC DUPLEX ADAPTER, PC	ZIRCONIA
FALCDSS6Y	YELLOW	LC DUPLEX ADAPTER, PC	ZIRCONIA
FALCDSS6OR	ORANGE	LC DUPLEX ADAPTER, PC	ZIRCONIA
FALCDSS6GN	GREEN	LC DUPLEX ADAPTER, PC	ZIRCONIA
FALCDSS6BK	BLACK	LC DUPLEX ADAPTER, PC	ZIRCONIA
FALCDSS6BE	BEIGE	LC DUPLEX ADAPTER, PC	ZIRCONIA
FALCDSS6AQ	AQUA	LC DUPLEX ADAPTER, PC	ZIRCONIA

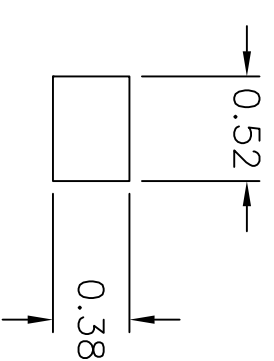

RECOMMENDED  
PANEL CUTOUT

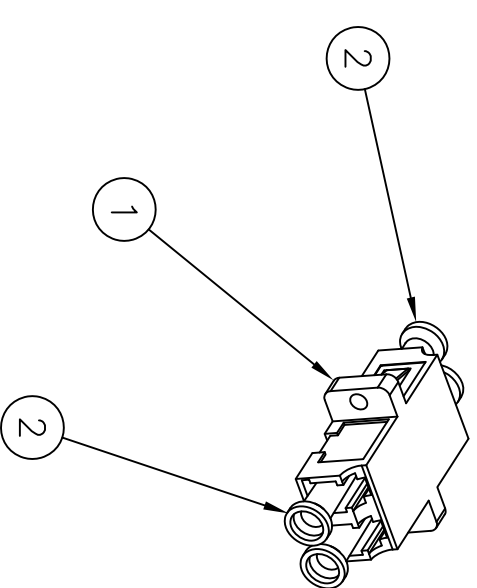

B

NOTES:

- ADAPTERS SUPPLIED WITH DUST CAPS INSTALLED.
- ADAPTER MATERIAL IS UL-V0 ENGINEERING THERMOPLASTIC.
- CLIP MATERIAL IS STAINLESS STEEL.
- SPLIT SLEEVE MATERIAL – SEE TABLE.  
ZIRCONIA SPLIT SLEEVE IS COMPATIBLE WITH BOTH SINGLEMODE AND MULTIMODE FIBER.  
PHOSPHOR BRONZE SPLIT SLEEVE IS ONLY COMPATIBLE WITH MULTIMODE FIBER.
- SPECIFICATIONS SUBJECT TO CHANGE WITHOUT NOTICE.

REV.	ECN	DATE	DESCRIPTION	CHG BY	APPD BY
1	17149	11/18/11	INITIAL RELEASE	CG	

B

A

A

Created on AUTOCAD		DIMENSIONING AND TOLERANCE PER ANSI Y14.5M-1982 UNLESS OTHERWISE SPECIFIED, DIMENSIONS ARE IN INCHES (MM). TOLERANCES .XX = ±.01 (.25) .XXX = ±.005 (.127) .XXXX = ±.0025 (.0635) ANGLE TOL. ±1°		PROJECT REFERENCE: <b>2011-016</b>			
IN ACCEPTING OUR DRAWINGS, BLUEPRINTS, OR SUPPORTING DOCUMENTATION FOR QUOTATION OR OTHER PURPOSES, YOU AGREE NOT TO DISCLOSE TO OTHERS THE IDEAS, INFORMATION, OR DESIGNS SHOWN HEREIN, AND THAT YOU WILL MAKE NO USE OF SAME WITHOUT PERMISSION		MATERIAL: SEE NOTES		DRAWN BY: C. GRIBBLE 11/18/11		<b>Hubbell Premise Wiring</b> <b>HUBBELL INCORPORATED (Delaware)</b> 14 Lord's Hill Road, Stonington, Connecticut 06378	
CHECKED BY: APPROVED BY:		TITLE: <b>FIBER OPTIC ADAPTER</b> <b>LC DUPLEX, SCREW MOUNT, SM/MM</b>		SIZE DRAWING NO. <b>C</b> <b>HW512998C</b>		REV. <b>1</b>	
SCALE: 1/1		SHEET 1 OF 1					