

6

5

4

3

2

1

ITEM NO.	DESCRIPTION	QTY.
1	ADAPTER, SC OR SC/APC SIMPLEX	1
2	SC DUST CAP	2

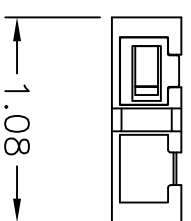
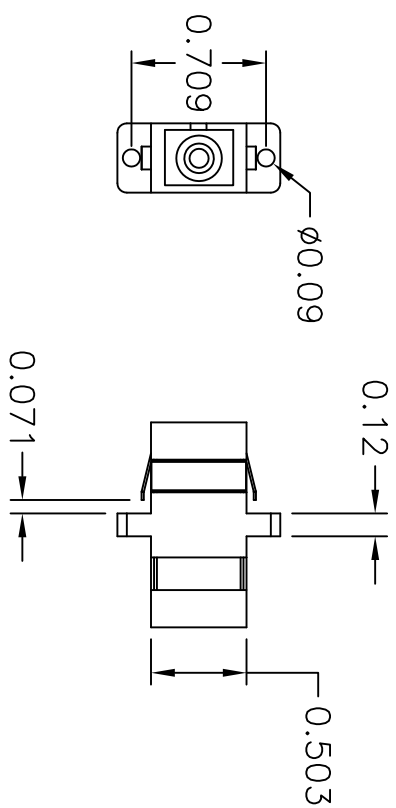
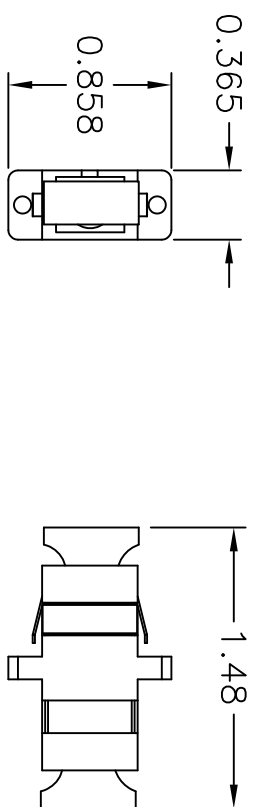

CATALOG NUMBER	HOUSING COLOR	DESCRIPTION	SPLIT SLEEVE MATERIAL
FASCSS12R	RED	ADAPTER, SC/PC SIMPLEX	ZIRCONIA
FASCSS12Y	YELLOW	ADAPTER, SC/PC SIMPLEX	ZIRCONIA
FASCSS12GN	GREEN	ADAPTER, SC/PC SIMPLEX	ZIRCONIA
FASCSS12B	BLUE	ADAPTER, SC/PC SIMPLEX	ZIRCONIA
FASCSS12OR	ORANGE	ADAPTER, SC/PC SIMPLEX	ZIRCONIA
FASCSS12BK	BLACK	ADAPTER, SC/PC SIMPLEX	ZIRCONIA
FASCSS12BE	BEIGE	ADAPTER, SC/PC SIMPLEX	ZIRCONIA
FASCSS12AQ	AQUA	ADAPTER, SC/PC SIMPLEX	ZIRCONIA
FASCSS12R	RED	ADAPTER, SC SIMPLEX	PHOS BRONZE
FASCSS12Y	YELLOW	ADAPTER, SC SIMPLEX	PHOS BRONZE
FASCSS12GN	GREEN	ADAPTER, SC SIMPLEX	PHOS BRONZE
FASCSS12B	BLUE	ADAPTER, SC SIMPLEX	PHOS BRONZE
FASCSS12OR	ORANGE	ADAPTER, SC SIMPLEX	PHOS BRONZE
FASCSS12BK	BLACK	ADAPTER, SC SIMPLEX	PHOS BRONZE
FASCSS12BE	BEIGE	ADAPTER, SC SIMPLEX	PHOS BRONZE
FASCSS12AQ	AQUA	ADAPTER, SC SIMPLEX	PHOS BRONZE

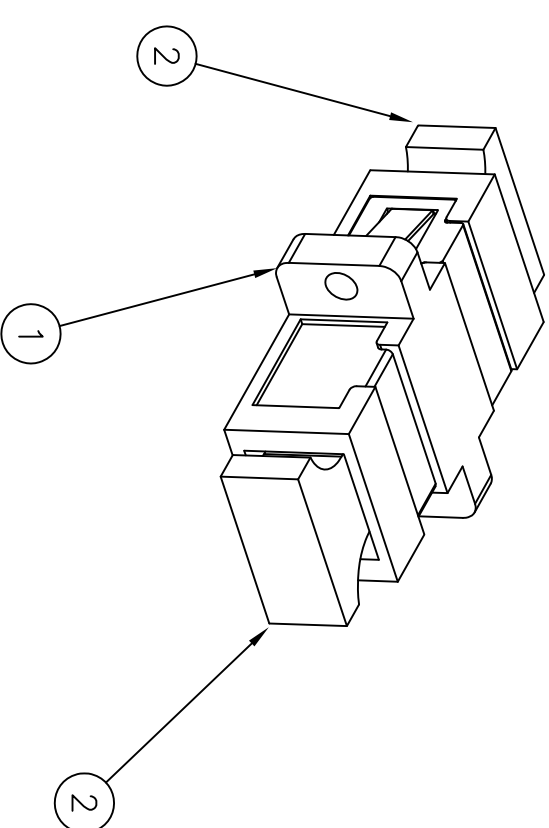
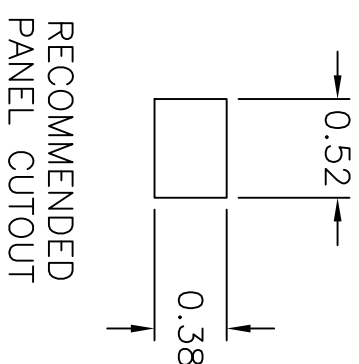

NOTES:

- ADAPTERS SUPPLIED WITH DUST CAPS INSTALLED.
- ADAPTER MATERIAL IS UL-V0 ENGINEERING THERMOPLASTIC.
- CLIP MATERIAL IS STAINLESS STEEL.
- SPLIT SLEEVE MATERIAL – SEE TABLE ZIRCONIA COMPATIBLE WITH BOTH MULTIMODE AND SINGLEMODE FIBER. PHOSPHOR BRONZE COMPATIBLE WITH MULTIMODE FIBER ONLY.
- SPECIFICATIONS SUBJECT TO CHANGE WITHOUT NOTICE.

REV.	ECN	DATE	DESCRIPTION	CHG BY	APPD BY
1	17150	11/18/11	ADDED/UPDATED CATALOGS	CG	

Created on AUTOCAD

DIMENSIONING AND TOLERANCE PER ANSI Y14.5M-1982 UNLESS OTHERWISE SPECIFIED, DIMENSIONS ARE IN INCHES (MM). TOLERANCES: .XX = ±.01 (.25) .XXX = ±.005 (.127) .XXXX = ±.0025 (.0635) ANGLE TOL #1°

IN ACCEPTING OUR DRAWINGS, BLUEPRINTS, OR SUPPORTING DOCUMENTATION FOR QUOTATION OR OTHER PURPOSES, YOU AGREE NOT TO DISCLOSE TO OTHERS THE IDEAS, INFORMATION, OR DESIGNS SHOWN HEREIN, AND THAT YOU WILL MAKE NO USE OF SAME WITHOUT PERMISSION

PROJECT REFERENCE: 2011-016

DRAWN BY: C. GRIBBLE 11/18/11

CHECKED BY:

APPROVED BY:

TITLE: FIBER OPTIC ADAPTER

SC SIMPLEX, SM/MM, SCREW MOUNT

Hubbell Premise Wiring
HUBBELL INCORPORATED (Delaware)
14 Lord's Hill Road, Stonington, Connecticut 06378

SCALE: 1/1 SHEET 1 OF 1

REV. 1