

HLJ6CP4

FRAME, 2 GANG, 4 PORT LJ6C, WHITE

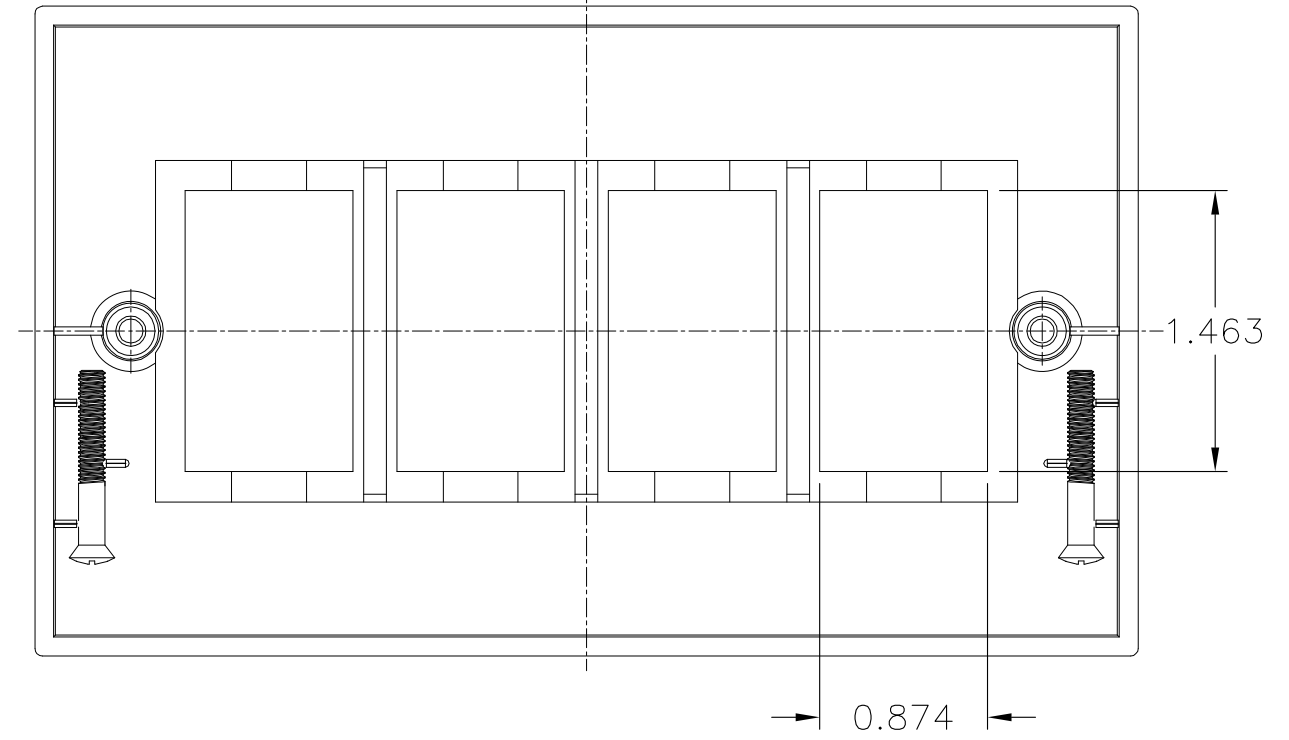
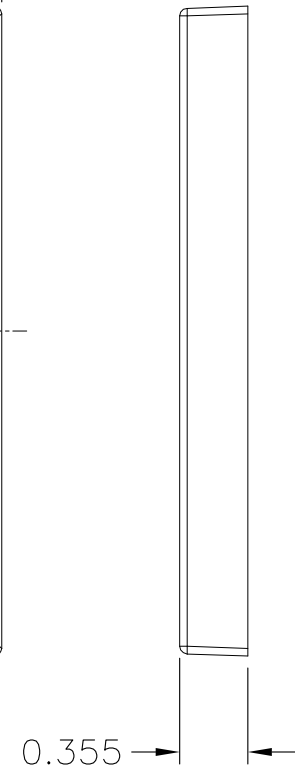
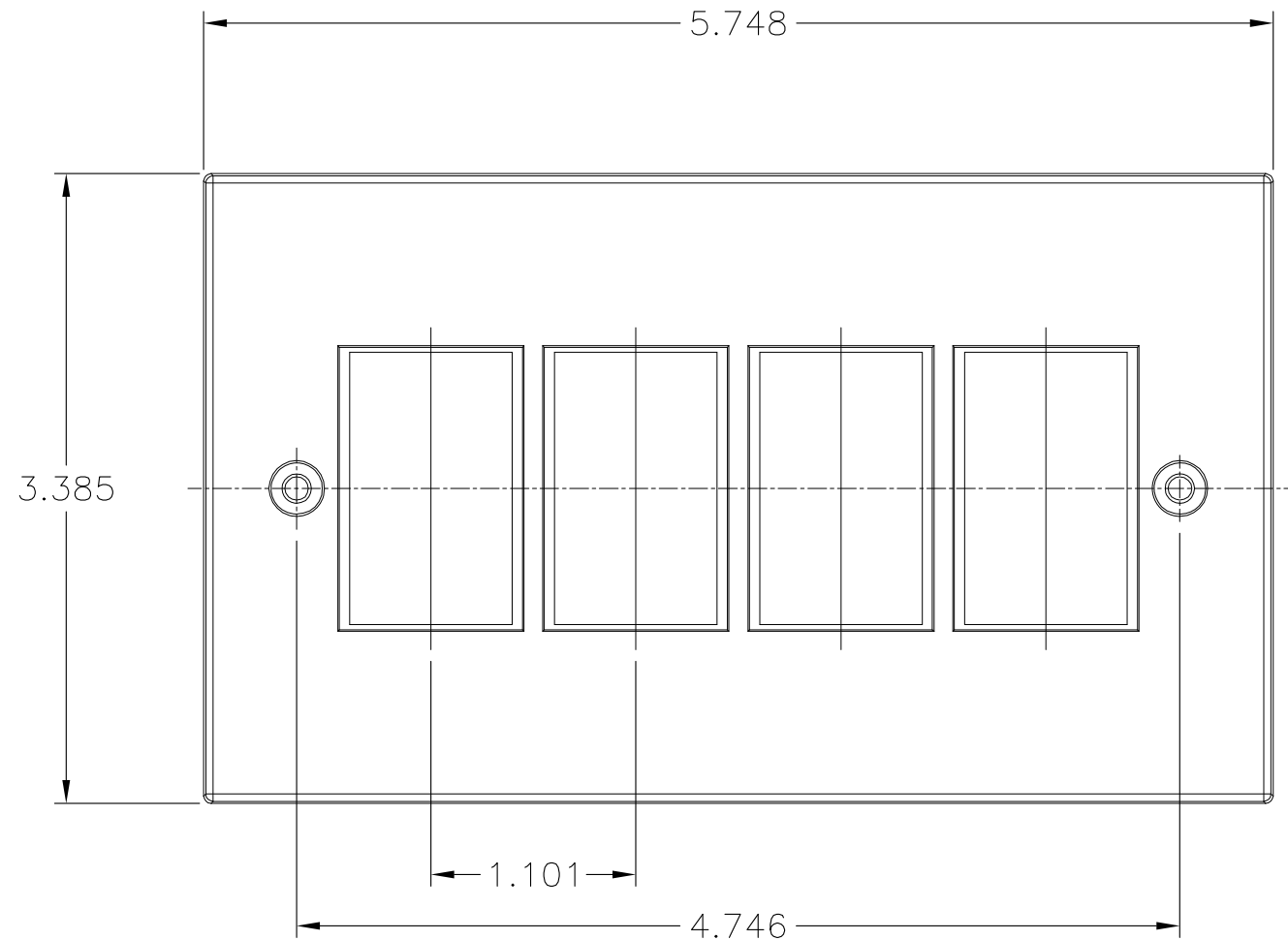

NOTES:

1. MATERIAL: ABS THERMOPLASTIC, WHITE
2. ACCEPTS LJ6C MODULES.
3. SPECIFICATIONS SUBJECT TO CHANGE WITHOUT NOTICE.

Created on AUTOCAD	DIMENSIONING AND TOLERANCE PER ANSI Y14.5M-1982 UNLESS OTHERWISE SPECIFIED, DIMENSIONS ARE IN INCHES (MM). TOLERANCES .XX = ±.01 (.25) .XXX = ±.005 (.127) .XXXX = ±.0025 (.0635) ANGLE TOL ±1°	PROJECT REFERENCE: NPD-00208	<b>Hubbell Premise Wiring</b> HUBBELL INCORPORATED (Delaware) 23 CLARA DRIVE, SUITE 103 MYSTIC, CT 06355	
	MATERIAL:  SEE NOTE 1	DRAWN BY: D.O'CONNOR 7/14/16		TITLE: FRAME, 2 GANG, 4 PORT LJ6C
	IN ACCEPTING OUR DRAWINGS, BLUEPRINTS, OR SUPPORTING DOCUMENTATION FOR QUOTATION OR OTHER PURPOSES, YOU AGREE NOT TO DISCLOSE TO OTHERS THE IDEAS, INFORMATION, OR DESIGNS SHOWN HEREIN, AND THAT YOU WILL MAKE NO USE OF SAME WITHOUT PERMISSION	CHECKED BY:	APPROVED BY:	SIZE: <b>B</b> DRAWING NO.: <b>HWS14596C</b> REV.: <b>1</b>
		SCALE: NTS	SHEET 1 OF 1	

1	21475	7/14/15	INITIAL RELEASE	DPO	MMA
REV.	ECN	DATE	DESCRIPTION	CHG BY	APPD BY