

CATALOG NO.	FIG NO	CONDUCTOR SIZE CODE (FLEX CABLE)				W ±.06	T ±.04	L ±.06
		MAIN	TAP 1	TAP 2	TAP 3			
HHH3939	1	750-500 (550-444)	750-350 (550-313)	--	--	2.97 [75]	1.50 [38]	1.25 [32]
HHH3931	2	750-350 (550-500)	4/0-1/0 (250-1/0)	1-6 SOL (1-8)	2-14 (2-14)	2.97 [75]	1.50 [38]	.95 [24]
HHH3434	1	500-250 (373-4/0)	500-4/0 (373-4/0)	--	--	2.43 [62]	1.15 [29]	1.00 [25]
HHH3429	2	500-4/0 (373-4/0)	250-1/0 (4/0-1/0)	1-6 SOL (1-8)	8-14 (8-14)	2.23 [57]	1.31 [33]	1.00 [25]
HHH2929	1	250-2 (4/0-2)	250-2 (4/0-2)	--	--	1.85 [47]	.90 [23]	.90 [23]
HHH292C	3	250-2 (4/0-2)	2-6 SOL (2-8)	8-14 (8-14)	--	1.52 [39]	.90 [23]	.90 [23]
HHH2C2C	4	2-6 SOL (2-8)	2-6 SOL (2-8)	8-14 (8-14)	8-14 (8-14)	1.25 [32]	.60 [15]	.75 [19]
HHH6C6C	1	6-10 (6-10)	6-14 (6-14)	--	--	.81 [21]	.39 [10]	.60 [15]

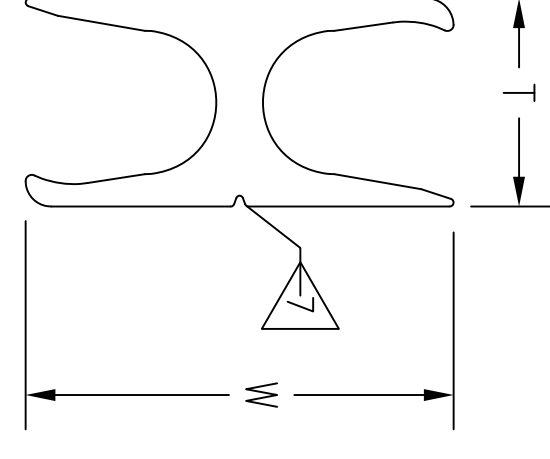

FIGURE 1

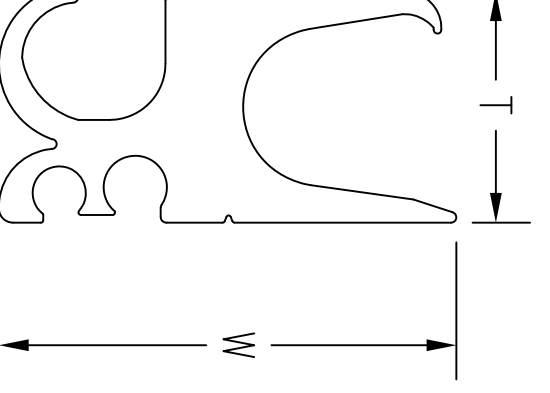

FIGURE 2

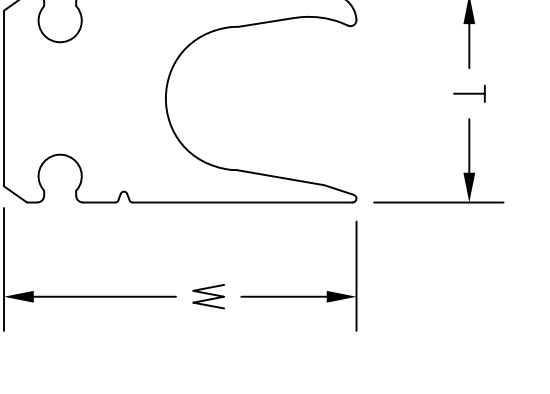

FIGURE 3

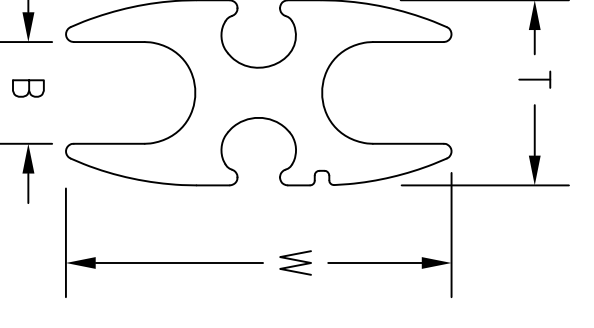

FIGURE 4

- TECHNICAL NOTES:
1. MATERIAL: COPPER.
 2. FINISH: TIN PLATE.
 3. FOR USE WITH COPPER OR TIN PLATED COPPER CONDUCTORS ONLY.
 4. ACCOMMODATES CODE CABLE, FLEX LOCOMOTIVE, AND FLEX CLASS 1 WITH SPECIFIED RANGES.
 5. RECOMMENDED CONDUCTOR STRIP LENGTH (CONNECTOR LENGTH +1/8" MAX), CONNECTOR LENGTH SHOWN BY DIMENSION "L".
 6. SPECIFICATIONS SUBJECT TO CHANGE WITHOUT NOTICE.

REV.	EGN	DATE	DESCRIPTION	CHG BY	APPD BY
2	18114	03/13/13	ADDITIONAL CATALOG NUMBERS	MMA	

Created on AUTOCAD		DIMENSIONING AND TOLERANCE PER ANSI Y14.5M-1992 UNLESS OTHERWISE SPECIFIED, DIMENSIONS ARE IN INCHES (MM). .xxx = ±.01 (25) .xxx = ±.005 (127) .xxxx = ±.0025 (.0635) ANGLE TOL. ±1°	
PROJECT REFERENCE: 2011-041		DRAWN BY: C. GRIBBLE 8/20/12	
MATERIAL: SEE NOTES		CHECKED BY:	
APPROVED BY:		TITLE: HTAP IRREVERSIBLE CRIMP CONNECTOR	
SIZE: D	DRAWING NO.: HWS14142C	SCALE: N/A	SHEET 1 OF 1
HUBBELL Hubbell Premise Wiring HUBBELL INCORPORATED (Delaware) 23 CLARA DRIVE, SUITE 103 MYSTIC, CT 06355		REV.: 2	