

ITEM NO.	DESCRIPTION	QTY.
1	PLATE, FLUSH, 2P, W/LABELS	1
2	SCREW, 6-32 PAN HD-SPECIAL	2
3	CARD, PAPER, 40X1.92, BLANK	2
4	COVER LABEL, CLEAR	2
5	COVER LABEL, MATCHING COLOR	2

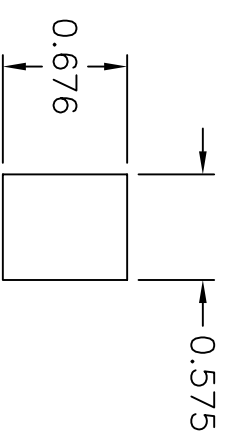

KEYSTONE OPENING

CATALOG NUMBER	COLOR	DESCRIPTION
IFP120W	OFFICE WHITE	PLATE FLUSH 2 PORT
IFP12EI	ELECTRIC IVORY	PLATE FLUSH 2 PORT
IFP12W	WHITE	PLATE FLUSH 2 PORT
IFP12GY	GRAY	PLATE FLUSH 2 PORT
IFP12TI	TELCO IVORY	PLATE FLUSH 2 PORT
IFP12BK	BLACK	PLATE FLUSH 2 PORT
IFP12AL	ALMOND	PLATE FLUSH 2 PORT
IFP12LA	LIGHT ALMOND	PLATE FLUSH 2 PORT
IFP12BN	BROWN	PLATE FLUSH 2 PORT

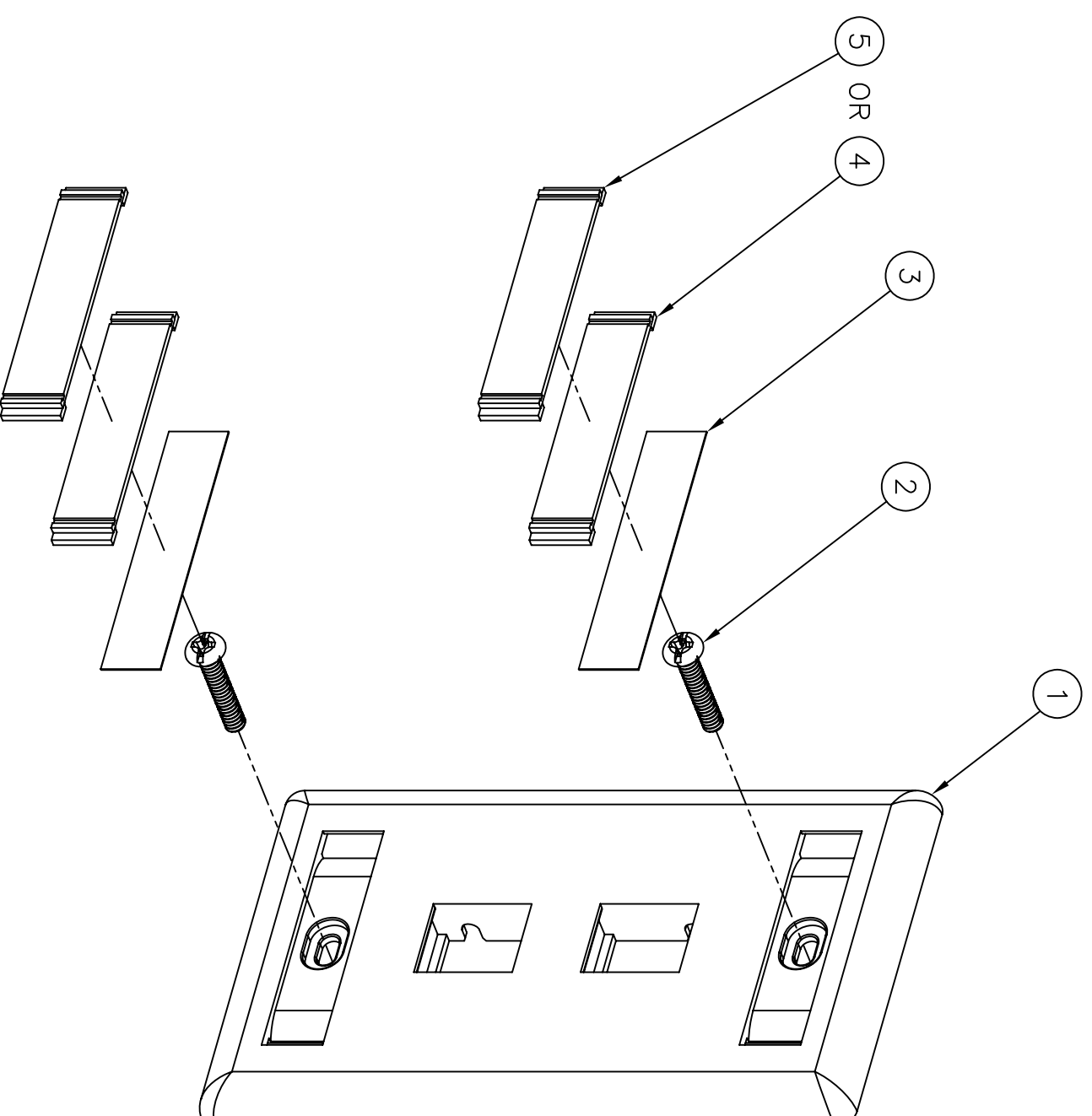
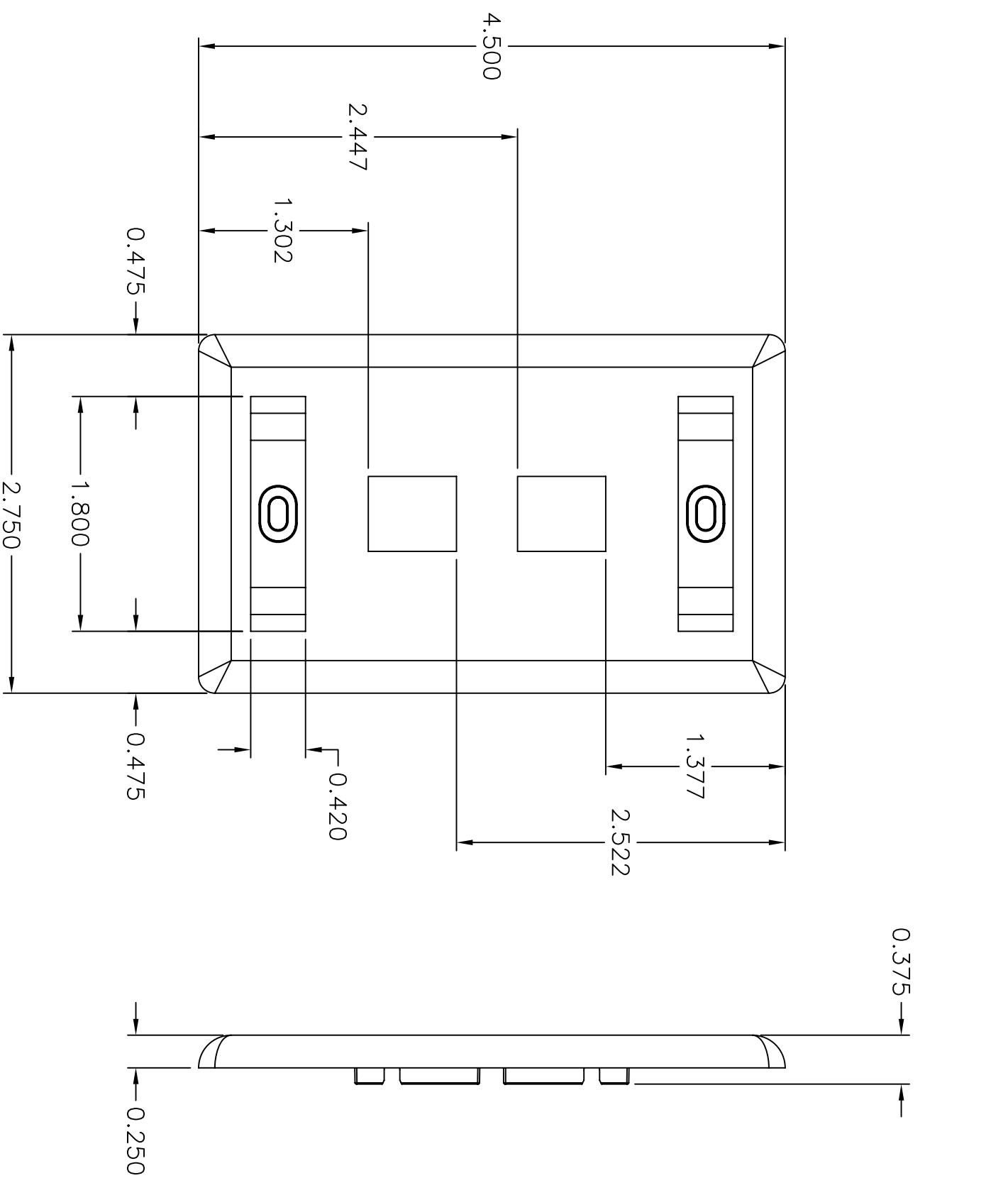

**NOTES**  
UNLESS OTHERWISE SPECIFIED:

1. UL LISTED: E129878
2. CSA CERTIFIED: LR 80837
3. SPECIFICATIONS SUBJECT TO CHANGE WITHOUT NOTICE

REV.	EON	DATE	DESCRIPTION	CHG BY	APPD BY
D	16450	7/7/10	ADDED BROWN COLOR	CG	

Created on AUTOCAD	
DIMENSIONING AND TOLERANCE PER ANSI Y14.5M-1982 UNLESS OTHERWISE SPECIFIED, DIMENSIONS ARE IN INCHES (MM). TOLERANCES .XX = ±.01 (.25) .XXX = ±.005 (.127) .XXXX = ±.0025 (.0635) ANGLE TOL ±1°	IN ACCEPTING OUR DRAWINGS, BLUEPRINTS, OR SUPPORTING DOCUMENTATION FOR QUOTATION OR OTHER PURPOSES, YOU AGREE NOT TO DISCLOSE TO OTHERS THE IDEAS, INFORMATION, OR DESIGNS SHOWN HEREIN, AND THAT YOU WILL MAKE NO USE OF SAME WITHOUT PERMISSION
PROJECT REFERENCE:	DRAWN BY: P.S.MAGUIRE 02/22/2001
MATERIAL:	CHECKED BY: H. MCGREGOR 02/28/2001
	APPROVED BY: H. MCGREGOR 02/28/2001
TITLE: INFINE STATION FACE PLATE FLUSH 2-PORT W/LABEL HOLDERS	HUBBELL Hubbell Premise Wiring HUBBELL INCORPORATED (Delaware) 14 Lord's Hill Road, Stonington, Connecticut 06378
SIZE DRAWING NO. C C773014	SCALE: FULL
REV. D	SHEET 1 OF 1