

ITEM NO.	DESCRIPTION	QTY.
1	DUPLEX RECEPTACLE SEE NOTE 1	1
2	WALL PLATE WHITE	1
3	SWITCH BOX RACO P/N 565	1
4	#6-20X1/2 SELF TAPPING SCREW	4

CATALOG NUMBER	DESCRIPTION	RECEPTACLE
NSOKPTR	STANDARD POWER KIT	TAMPER RESISTANT 5-15R CR15WH1TR
NSOKPS	SURGE SUPPRESSION KIT	SURGE PROTECTION NEMA 5-15R DUPLEX SP520WABULK

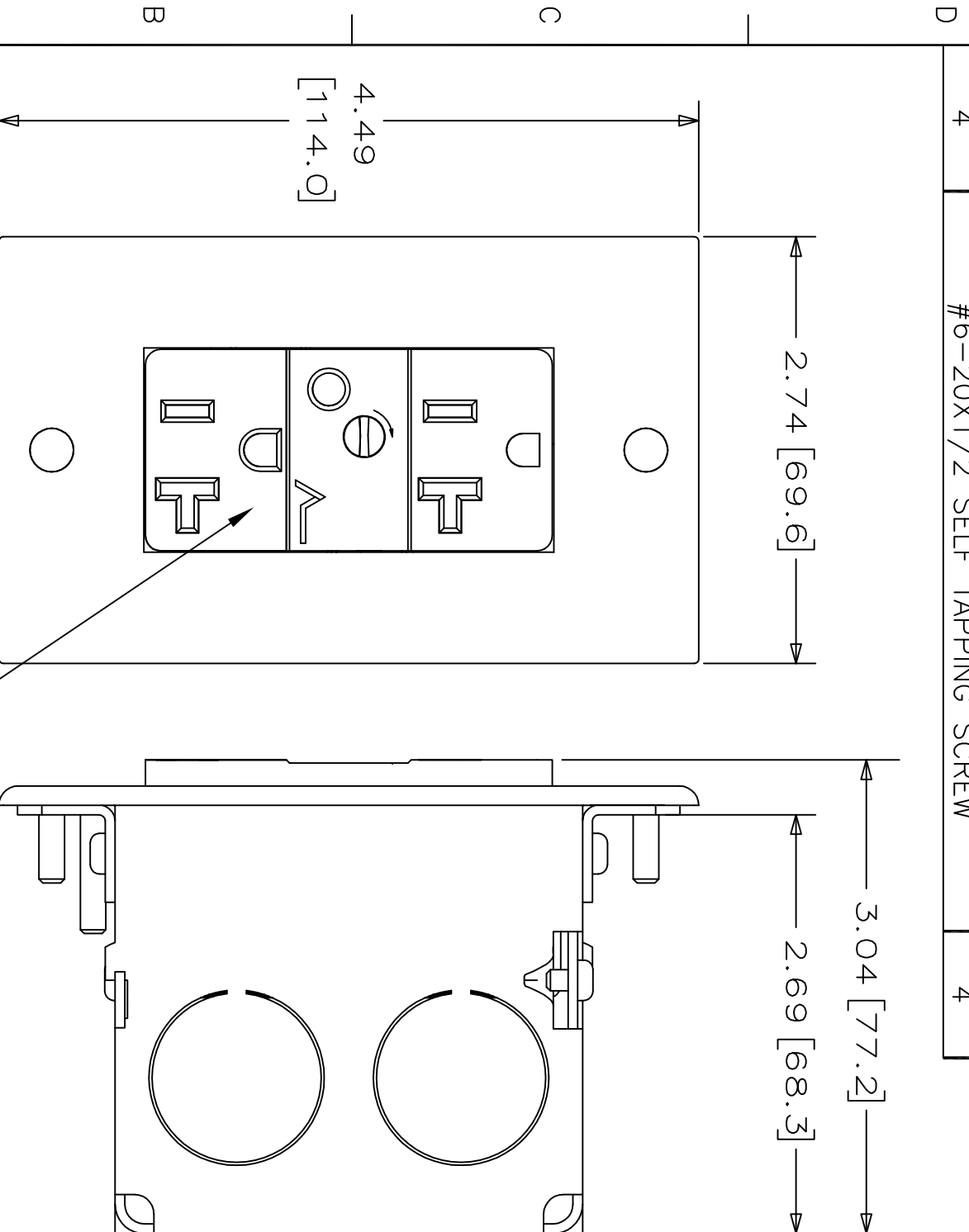

SURGE RECEPTACLE SHOWN SEE TABULATION

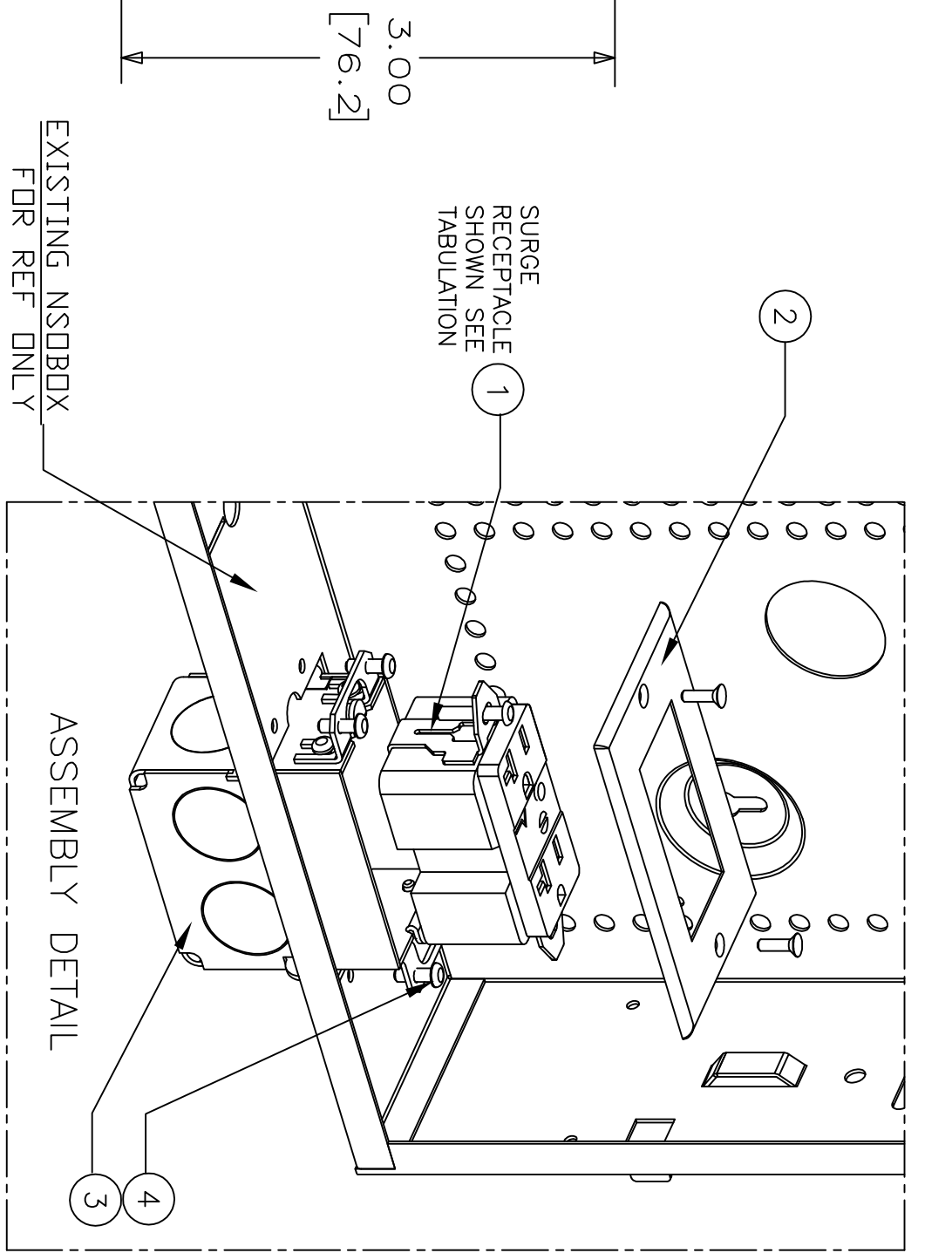

EXISTING NSOBOX FOR REF ONLY

ASSEMBLY DETAIL

- NOTES:
- SPECIFICATIONS SUBJECT TO CHANGE WITHOUT NOTICE.

REV.	ECN	DATE	DESCRIPTION	CHG BY	APPD BY
B	17019	02/07/11	REPLACED NSOKP W/NSOKPTR; REVISED RECEPTACLES	MMA	

Created on AUTOCAD

DIMENSIONING AND TOLERANCE PER ANSI Y14.5M-1982 UNLESS OTHERWISE SPECIFIED, DIMENSIONS ARE IN INCHES (MM).
 TOLERANCES
 .XX = ±.01 (.25)
 .XXX = ±.005 (.127)
 .XXXX = ±.0025 (.0635)
 ANGLE TOL. ±1°

IN ACCEPTING OUR DRAWINGS, BLUEPRINTS, OR SUPPORTING DOCUMENTATION FOR QUOTATION OR OTHER PURPOSES, YOU AGREE NOT TO DISCLOSE TO OTHERS THE IDEAS, INFORMATION, OR DESIGNS SHOWN HEREIN, AND THAT YOU WILL MAKE NO USE OF SAME WITHOUT PERMISSION

PROJECT REFERENCE: PMS-520

MATERIAL: N/A

DRAWN BY: B MARTINO 03/28/08

CHECKED BY:

APPROVED BY:

HUBBELL
 Hubbell Premise Wiring
 HUBBELL INCORPORATED (Delaware)
 14 Lord's Hill Road, Stonington, Connecticut 06378

TITLE: netSELECT POWER KITS

SIZE: B DRAWING NO. 11977C REV. B

SCALE: NONE SHEET 1 OF 1