

ITEM NO.	DESCRIPTION	QTY.
1	STAINLESS STEEL FACEPLATE	1
2	LABEL COVERS PAPER LABELS	4
3	PAPER LABELS	4
4	FACEPLATE MOUNTING SCREWS #6-32 x 3/4 L	4

CATALOG NUMBER	DESCRIPTION
SSFL24	STAINLESS STEEL FACEPLATE, 4-PORT, LABELS
SSFL26	STAINLESS STEEL FACEPLATE, 6-PORT, LABELS
SSFL29	STAINLESS STEEL FACEPLATE, 9-PORT, LABELS
SSFL212	STAINLESS STEEL FACEPLATE, 12-PORT, LABELS

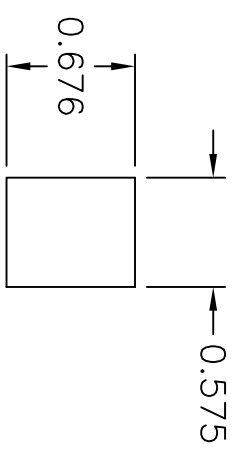

KEYSTONE OPENING

NOTES

1. SPECIFICATIONS SUBJECT TO CHANGE WITHOUT NOTICE

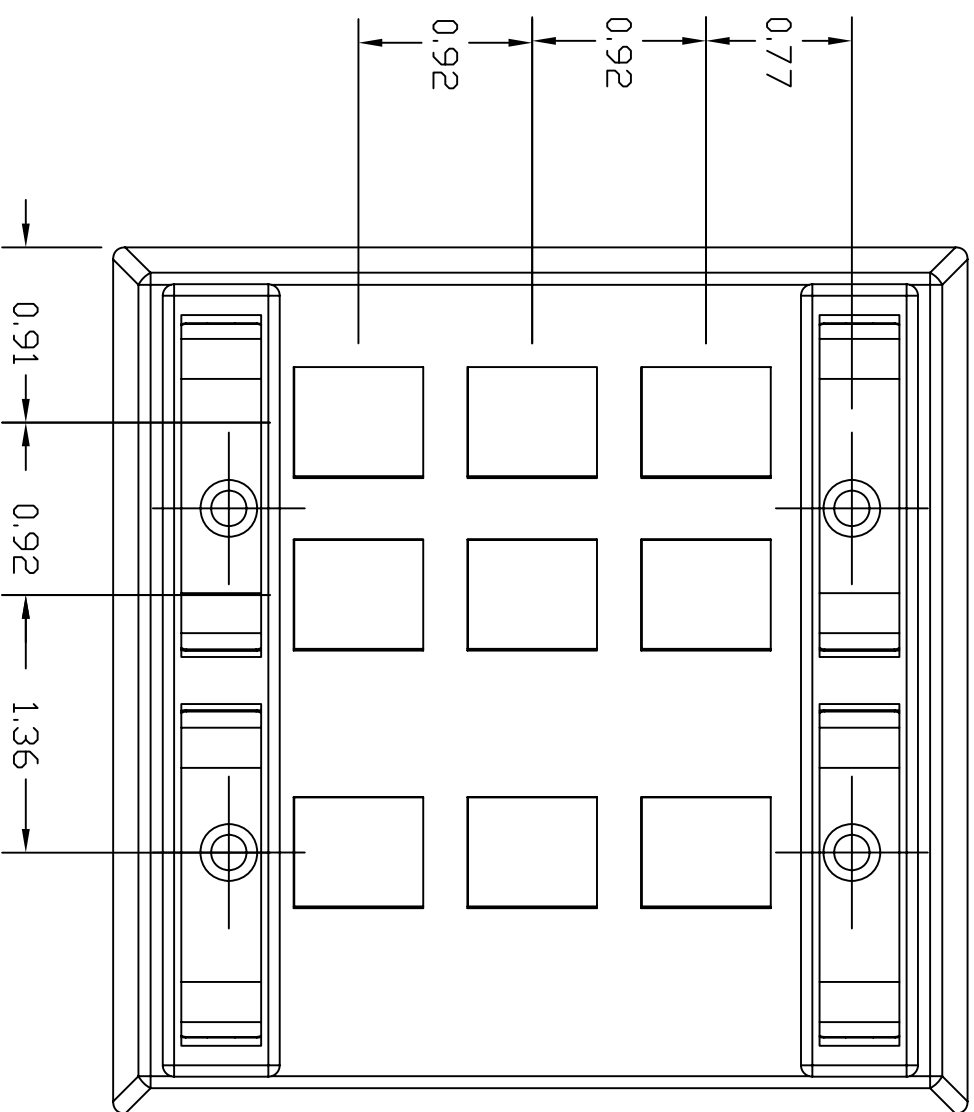
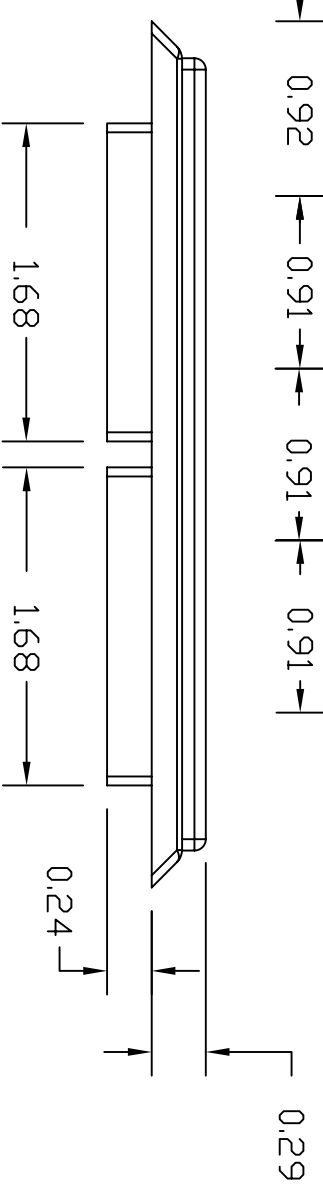
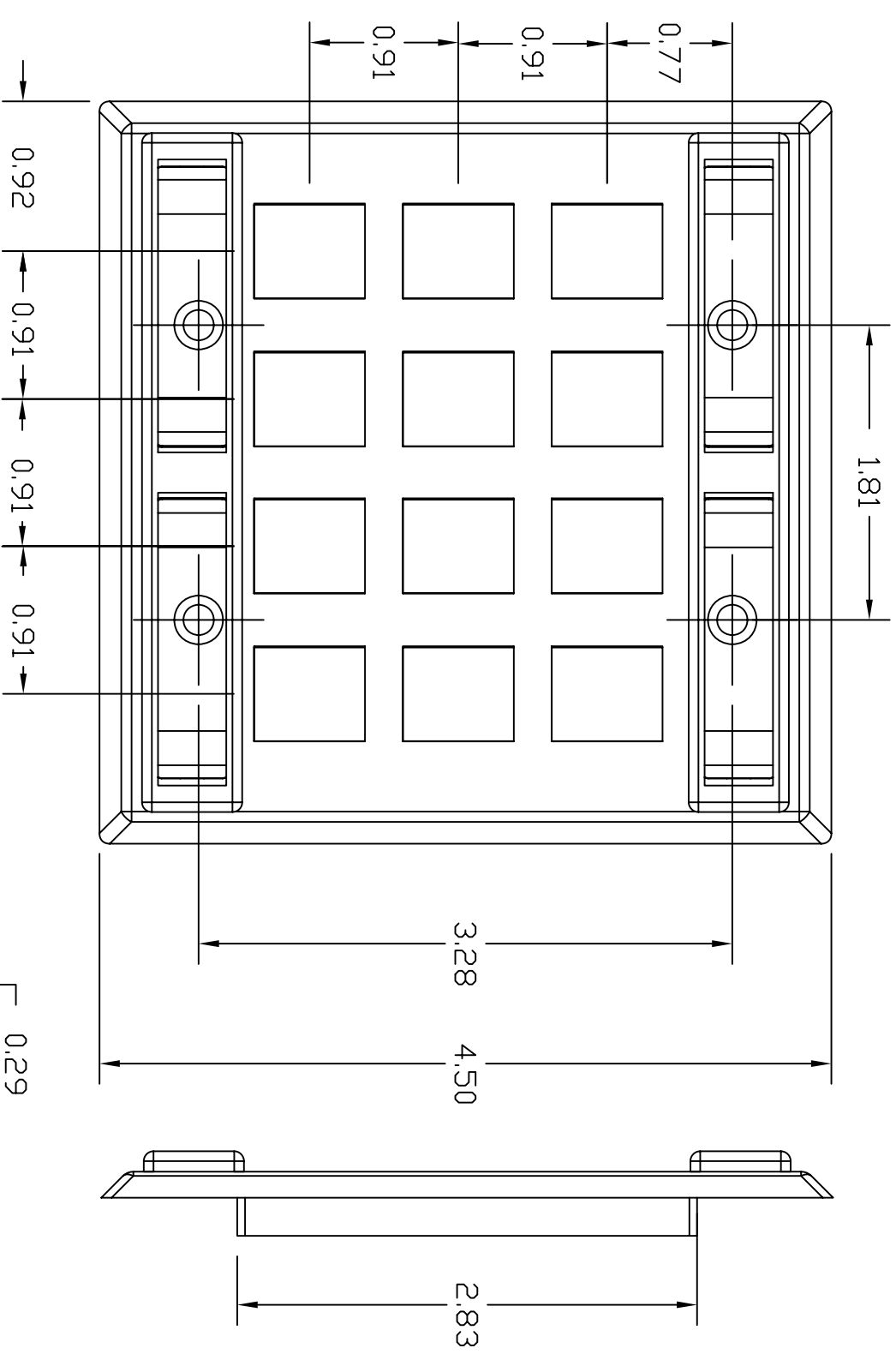
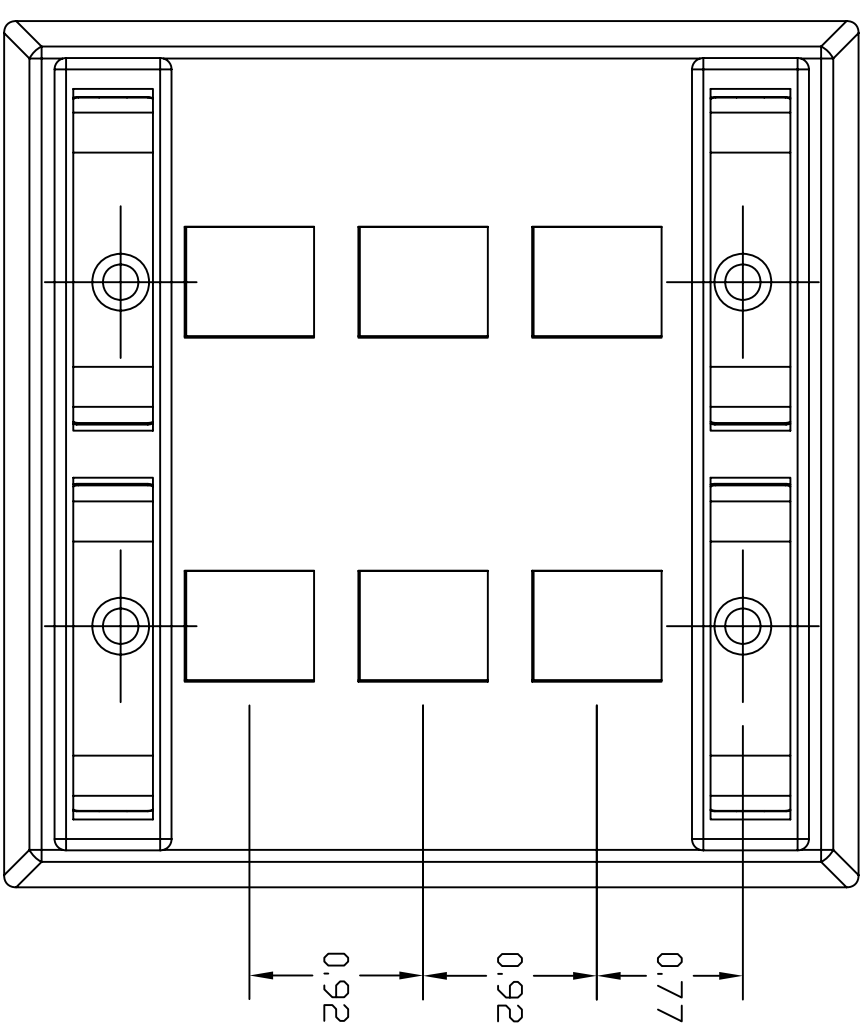
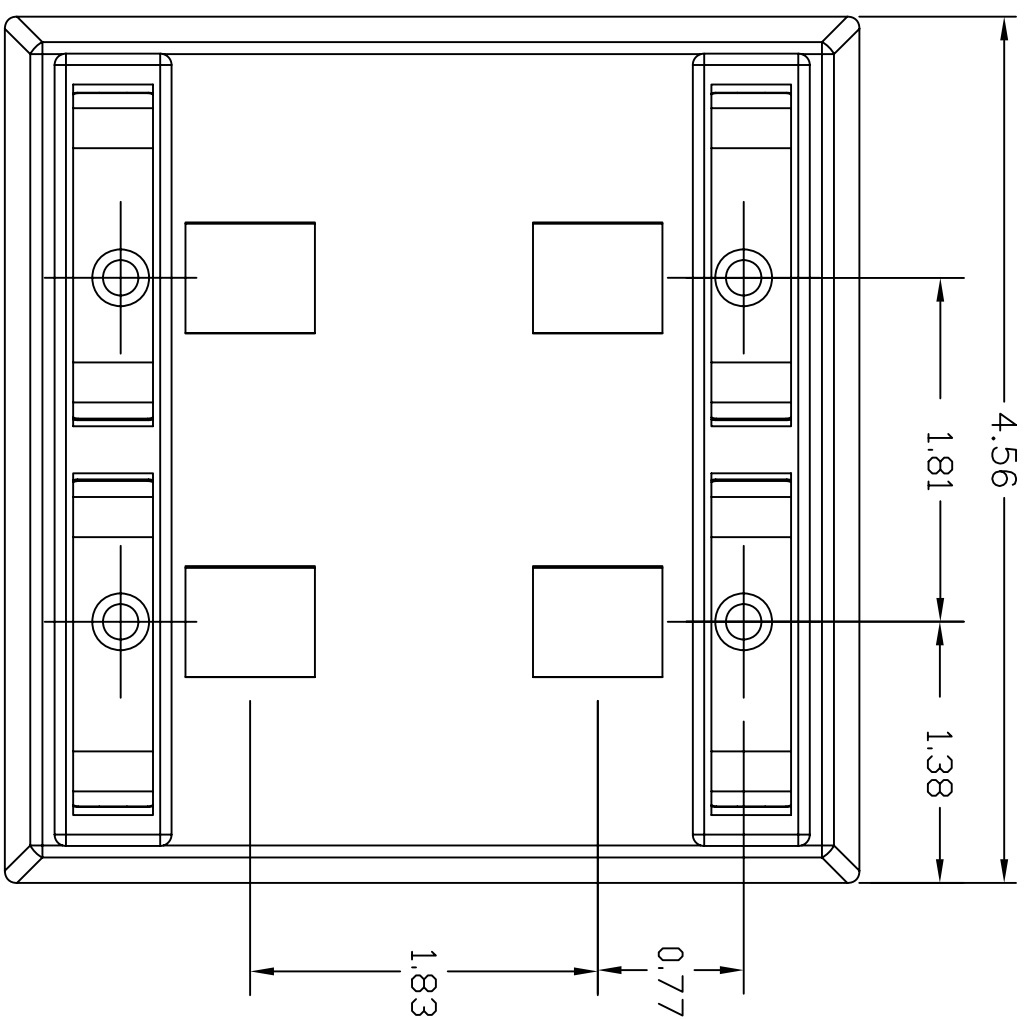

REV.	ECN	DATE	DESCRIPTION	CHG BY	APPD BY
C	6508	01/21/09	CHANGED LABEL HOLDER MATERIAL	NJR	
B	6372	06/06/08	ADDED 4,6 & 9 PORT FACEPLATES	NJR	

Created on AUTOCAD

DIMENSIONING AND TOLERANCE PER  
ANSI Y14.5M-1982  
UNLESS OTHERWISE SPECIFIED,  
DIMENSIONS ARE IN INCHES (MM).  
TOLERANCES:  
.XX = ±.01 (.25)  
.XXX = ±.005 (.127)  
.XXXX = ±.0025 (.0635)  
ANGLE TOL #1°

IN ACCEPTING OUR DRAWINGS,  
BLUEPRINTS, OR SUPPORTING  
DOCUMENTATION FOR QUOTATION  
OR OTHER PURPOSES, YOU AGREE  
NOT TO DISCLOSE TO OTHERS  
THE IDEAS, INFORMATION, OR  
DESIGNS SHOWN HEREIN, AND  
THAT YOU WILL MAKE NO USE  
OF SAME WITHOUT PERMISSION

PROJECT REFERENCE:

MATERIAL:  
Plate: 430 SS COIL  
Bracket: THERMOPLASTIC  
Label holder: LEXAN

DRAWN BY:  
C. GRIBBLE

CHECKED BY:

APPROVED BY:



**Hubbell Premise Wiring**  
HUBBELL INCORPORATED (Delaware)  
14 Lord's Hill Road, Storington, Connecticut 06378

TITLE:  
STAINLESS STEEL FACEPLATE  
DOUBLE GANG WITH LABEL FIELDS  
4,6,9 & 12-PORT

SIZE: C  
DRAWING NO.: HWS12482C  
SCALE: 1/1  
SHEET 1 OF 1

REV.: C