

**TOP VIEW**

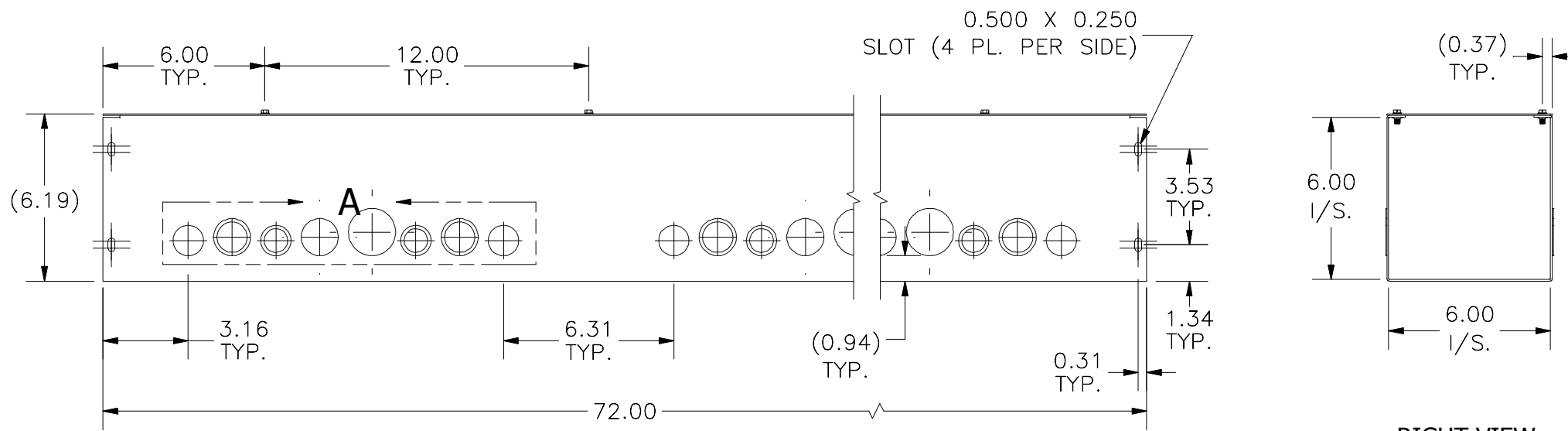

**FRONT VIEW**

**RIGHT VIEW**

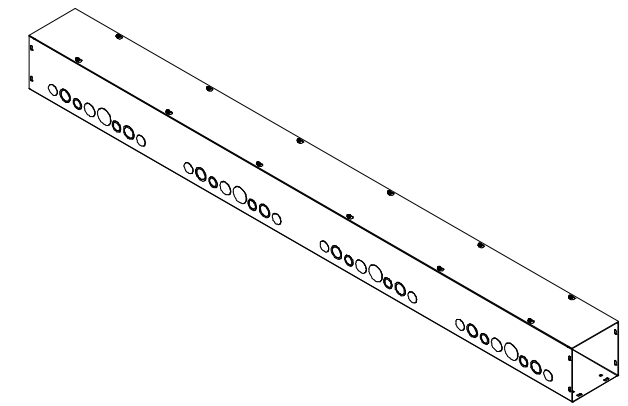
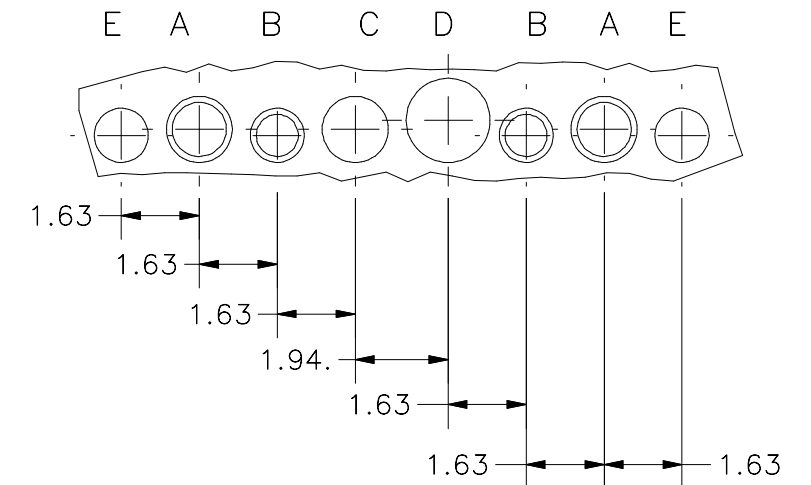

**DETAIL A  
PATTERN DESCRIPTION (8 PL.)**

- A) 3/4"-1" CONCENTRIC KO (2 PL.)
- B) 1/2"-3/4" CONCENTRIC KO (2 PL.)
- C) 1" SOLID KO (1 PL.)
- D) 1 1/4" SOLID KO (1 PL.)
- E) 3/4" SOLID KO (2 PL.)

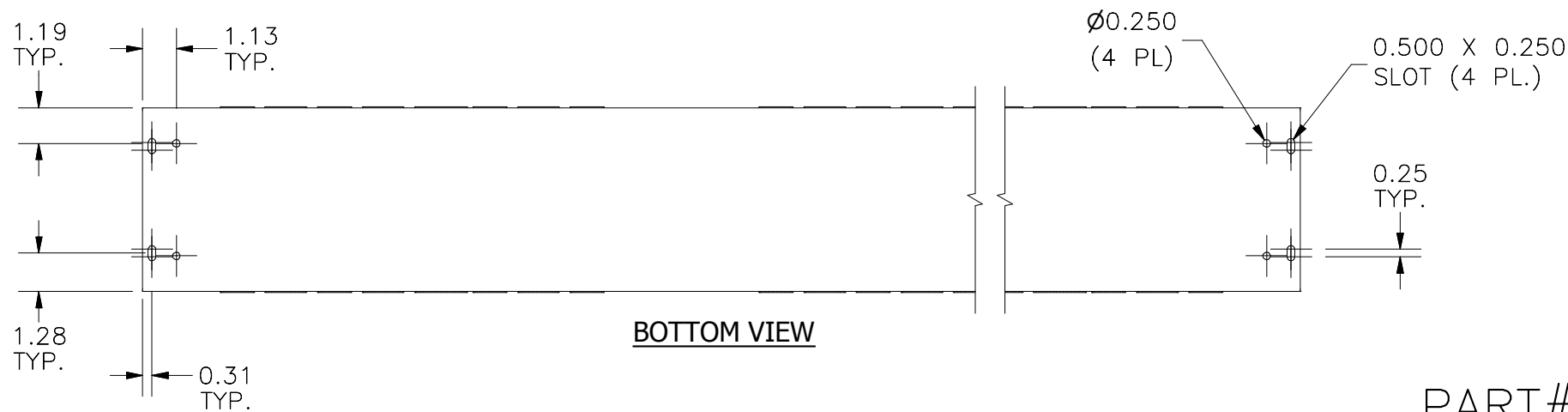

**BOTTOM VIEW**

PART#: S6672G  
(DATA SUBJECT TO CHANGE WITHOUT NOTICE)