

PART NO.	DESCRIPTION	MAX HOLE DIAMETER TO BE COVERED
WASPBG	MINATURE OIL-TIGHT PUSHBUTTON HOLES	0.88 (22)
WASPB	STANDARD OIL-TIGHT PUSHBUTTON HOLES	1.25 (32)
WAS050	1/2" CONDUIT HOLES	0.88 (22)
WAS075	3/4" CONDUIT HOLES	1.06 (27)
WAS100	1" CONDUIT HOLES	1.30 (33)
WAS125	1 1/4" CONDUIT HOLES	1.69 (43)
WAS150	1 1/2" CONDUIT HOLES	2.00 (51)
WAS200	2" CONDUIT HOLES	2.50 (64)
WAS250	2 1/2" CONDUIT HOLES	3.00 (76)
WAS300	3" CONDUIT HOLES	3.63 (92)
WAS350	3 1/2" CONDUIT HOLES	4.12 (105)
WAS400	4" CONDUIT HOLES	4.63 (118)

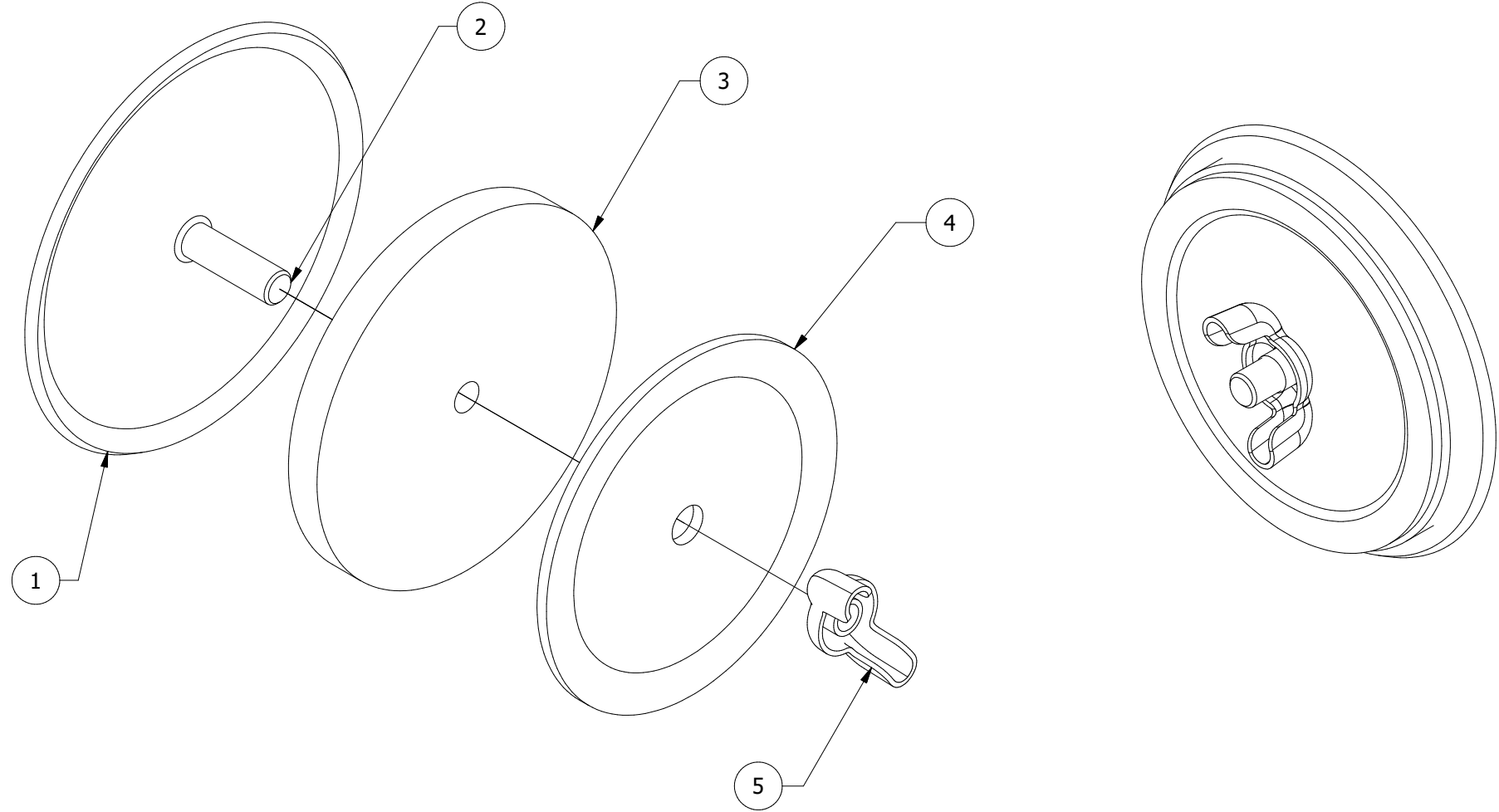

**PART #: WAS050 - WAS400**  
**(DATA SUBJECT TO CHANGE WITHOUT NOTICE)**  
**THIS DRAWING IS THE PROPERTY OF HUBBELL INC. WIEGMANN**  
**ALL INFORMATION IS PROPRIETARY AND NOT TO BE DUPLICATED**

5	1	WING NUT #10-32	S.S OR C.R.S.	GRAINED FINISH (S.S.), ZINC PLATED (C.R.S.)
4	1	BACK PLATE	C.R.S	ZINC PLATED
3	1	GASKET	NEOPRENE RUBBER	NONE
2	1	WELD STUD #10-32 X 5/8"	S.S. OR C.R.S.	PASSIVATED FINISH (S.S.), COPPER PLATED (C.R.S.)
1	1	CAP	C.R.S.	ANSI 61 TEXTURED GRAY POLYESTR POWDER PAINT
ITEM NO.	QTY.	DESCRIPTION	MATERIAL	FINISH

B.O.M. TABLE