

CATALOG NO.	DESCRIPTION	HEIGHT "H"	OVERALL DEPTH "D"	FRAME DEPTH "B"	MOUNTING APERTURE "A"	FRONT TO REAR MOUNTING RAIL "M"
H3N4242	H3,CABINET,NETWORK,42RU,30"W,42"D,CVRS,B	76.59	44.22	39.37	74.12	32.51
H3N4248	H3,CABINET,NETWORK,42RU,30"W,48"D,CVRS,B	76.59	50.22	45.37	74.12	38.51
H3N4742	H3,CABINET,NETWORK,47RU,30"W,42"D,CVRS,B	85.35	44.22	39.37	82.88	32.51
H3N4748	H3,CABINET,NETWORK,47RU,30"W,48"D,CVRS,B	85.35	50.22	45.37	82.88	38.51

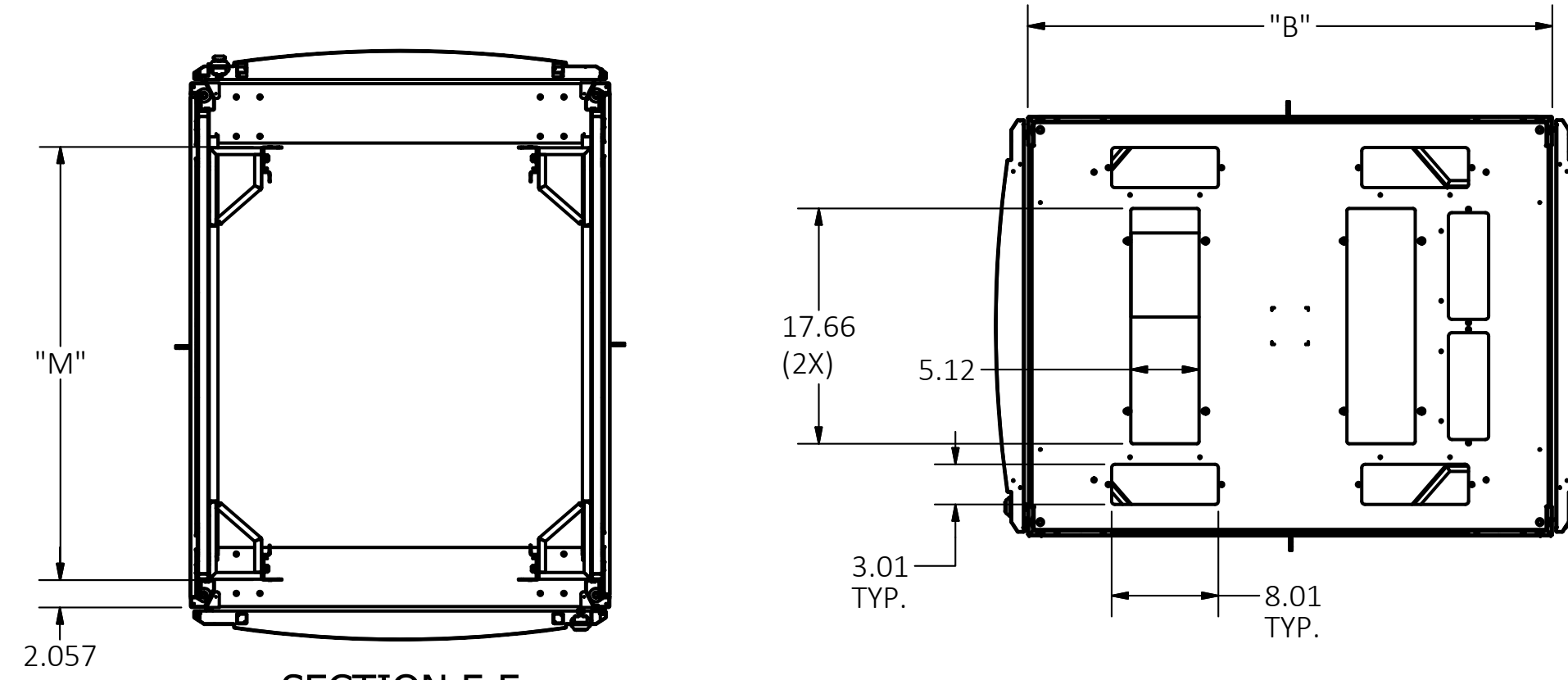

- NOTES:
1. SURFACE FINISH: BLACK POWDER COAT
 2. HARDWARE PACKA CONTAINS:
(50) #12-24 X 5/8" PAN HEAD SCREWS
(50) WASHERS
 3. SPECIFICATIONS SUBJECT TO CHANGE WITHOUT NOTICE.

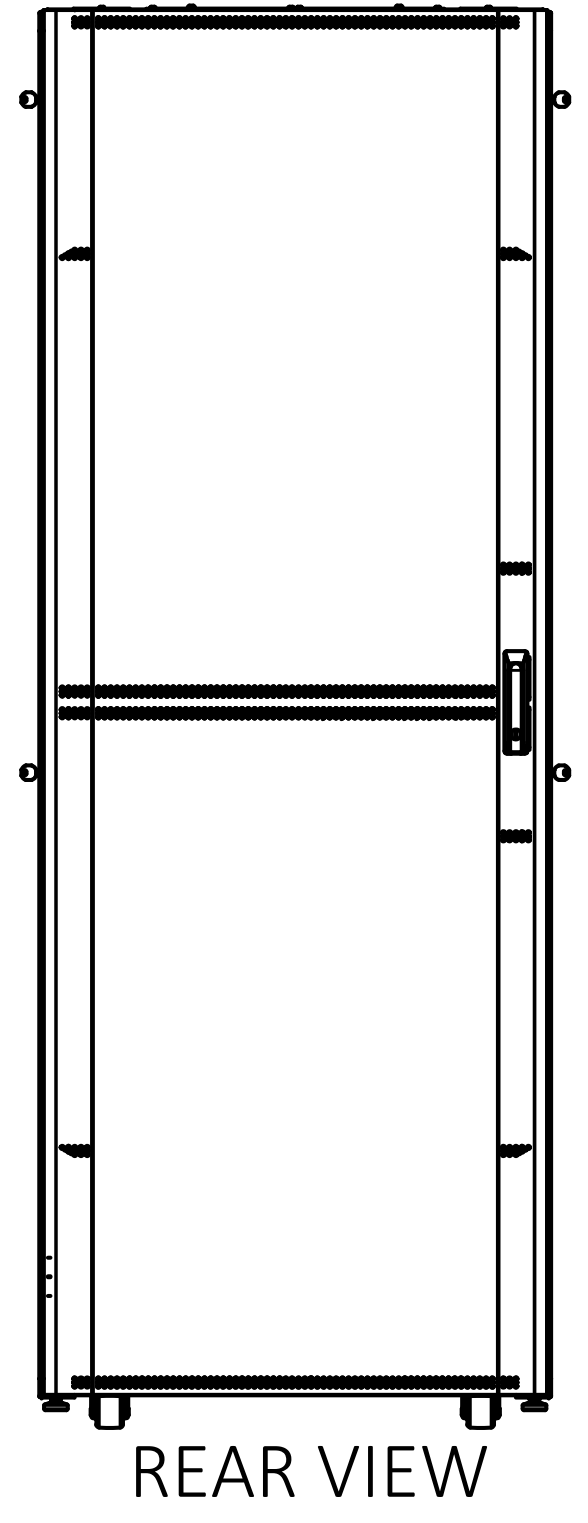
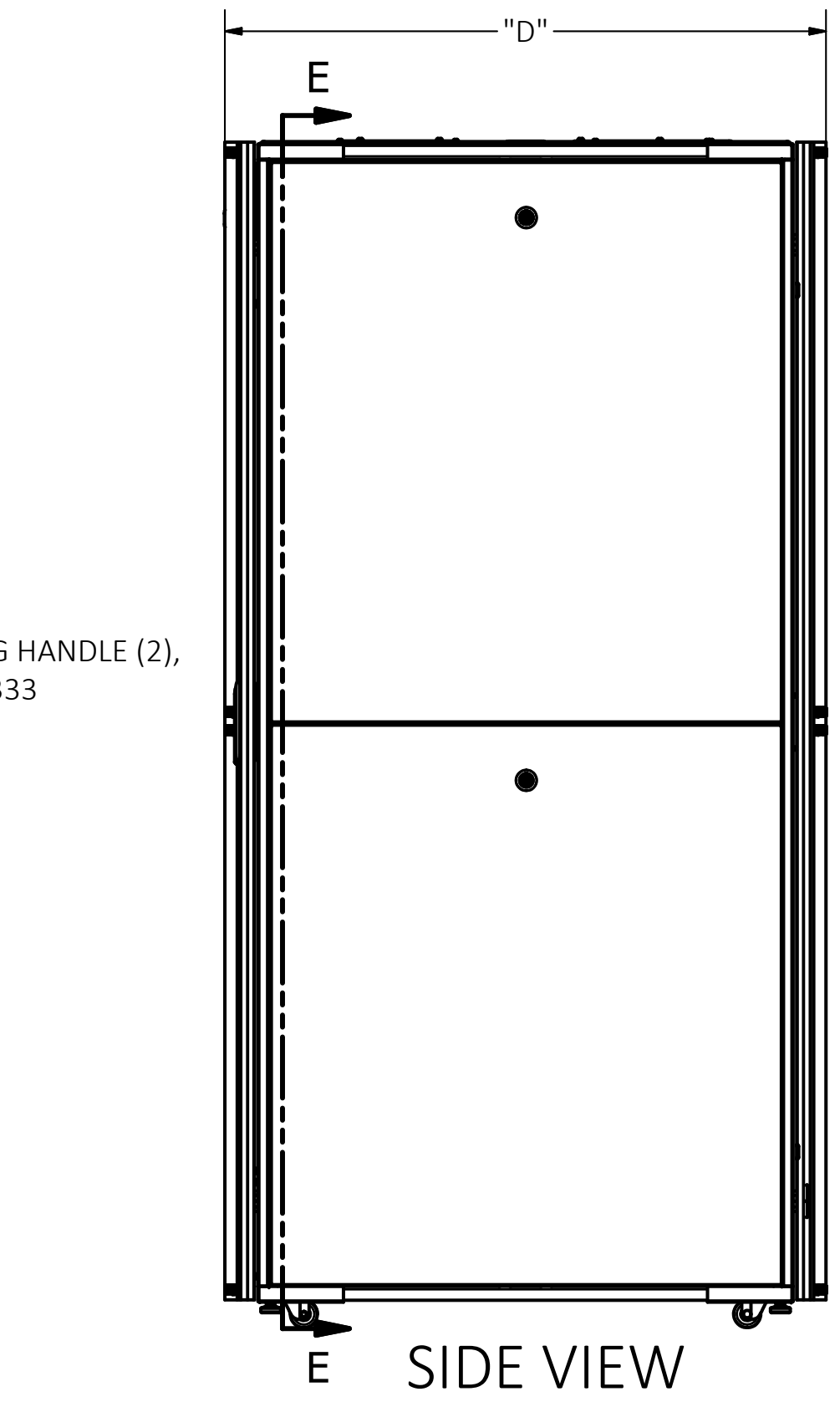
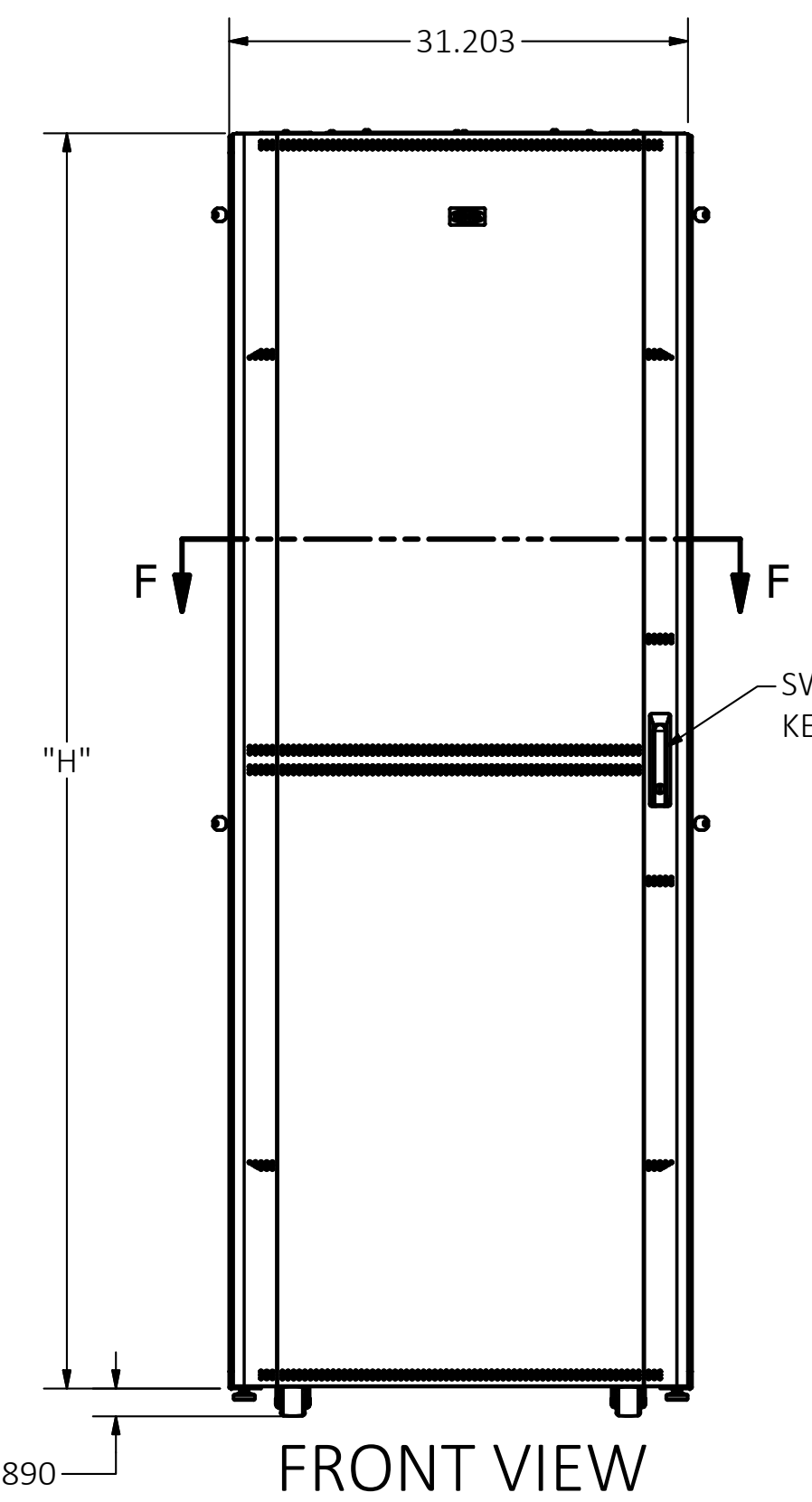
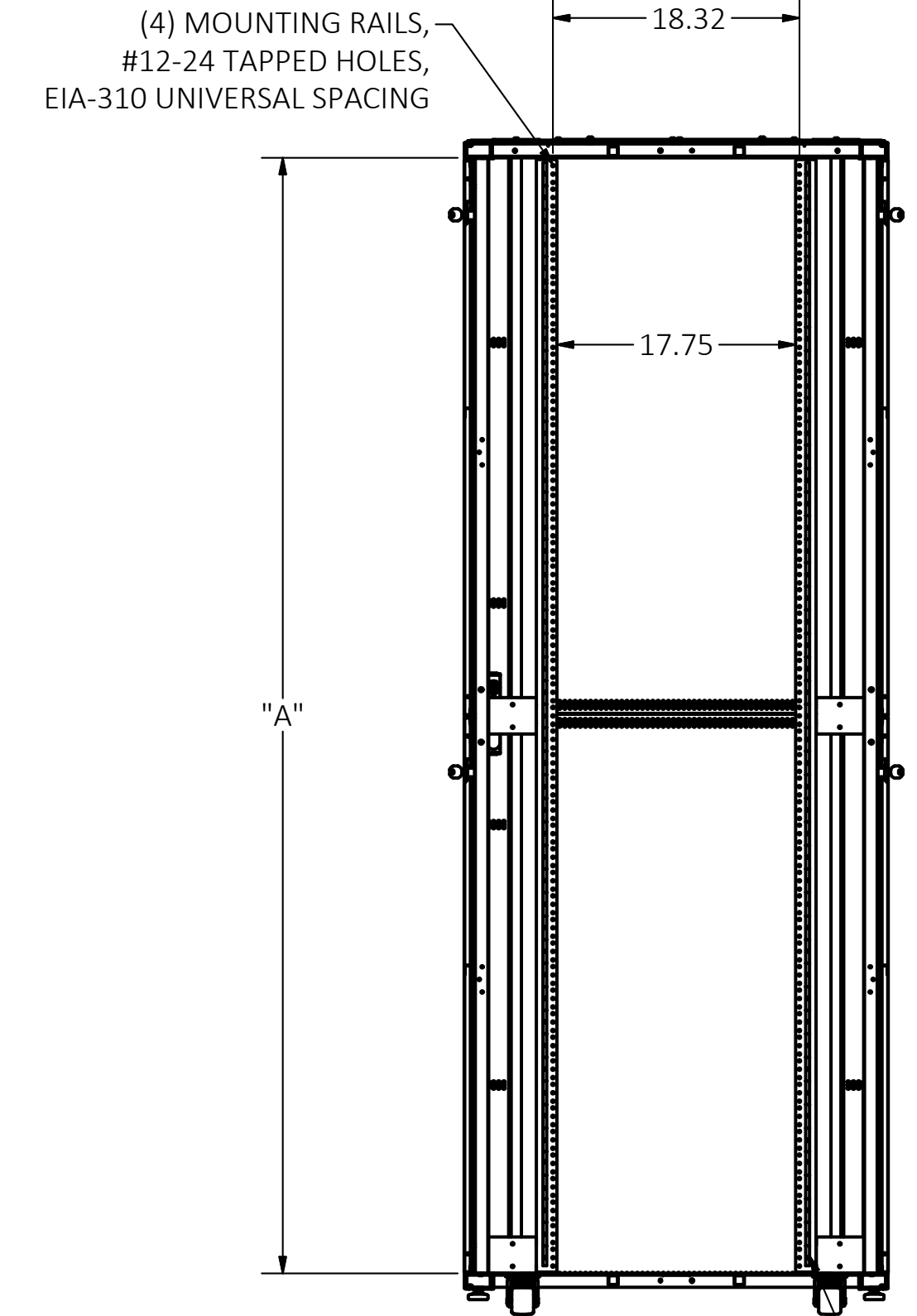
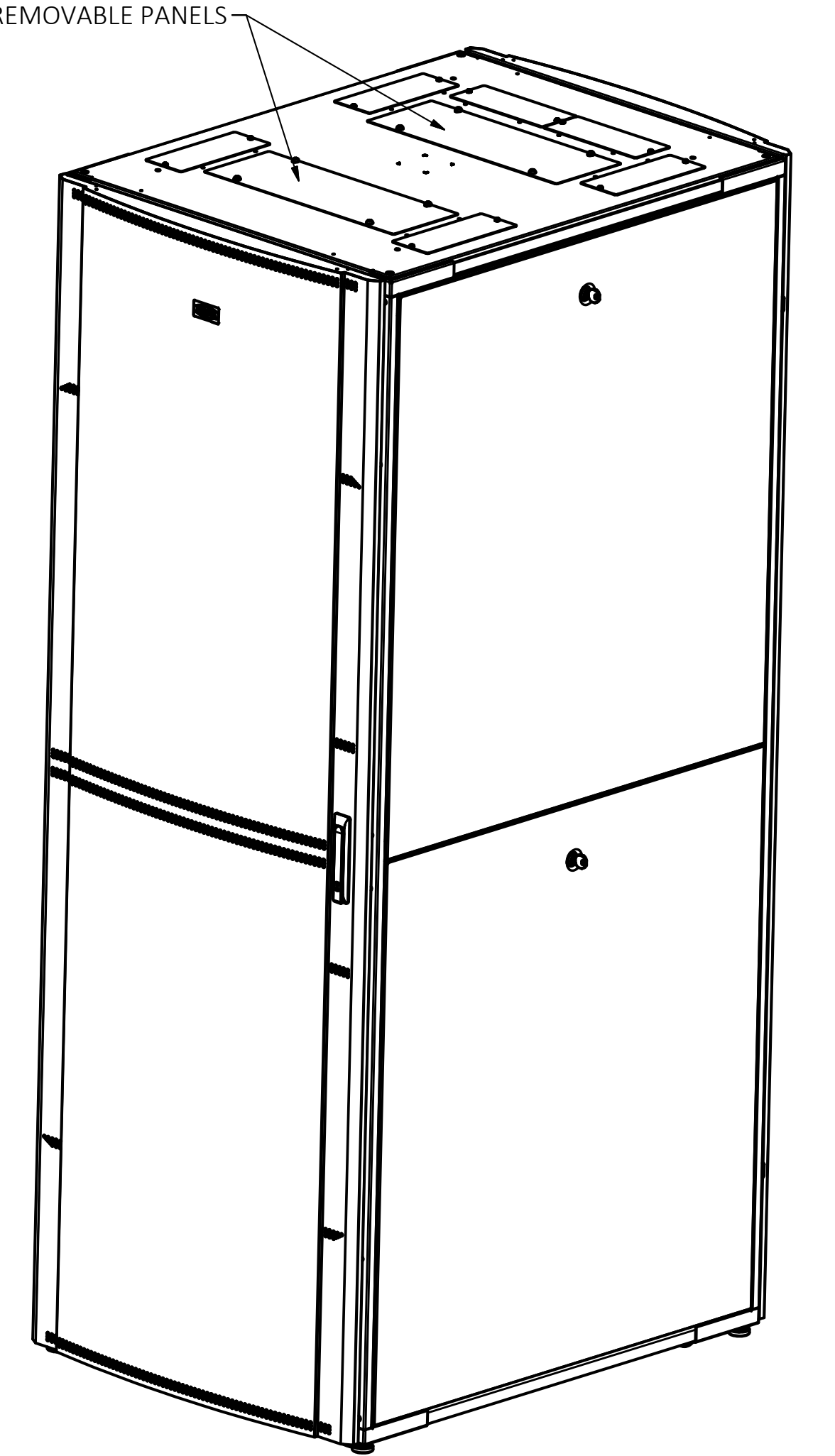

RACK UNIT LABEL (4),
INSTALL TWO ON FRONT
AND TWO ON REAR SET
OF RAILS

SWING HANDLE (2),
KEY #333

SALES/SERVICE LABEL,
FAR SIDE

REV.	ECN	DATE	DESCRIPTION	CHG BY	APPD BY
2	23977	08/31/20	ADDED LOCK KEY NUMBER	MMA	DO
1	23699	11/02/18	INITIAL RELEASE	MMA	DO

Created on INVENTOR	DIMENSIONING AND TOLERANCE PER ANSI Y14.5M-1982 UNLESS OTHERWISE SPECIFIED, DIMENSIONS ARE IN INCHES (MM). TOLERANCES: .XX = ±.01 (.25) .XXX = ±.005 (.127) .XXXX = ±.0025 (.0635) ANGLE TOL ±1°		PROJECT REFERENCE: NPD 2617	Hubbell Premise Wiring HUBBELL INCORPORATED (Delaware) 23 CLARA DRIVE, SUITE 103 MYSTIC, CT 06355	
	IN ACCEPTING OUR DRAWINGS, BLUEPRINTS, OR SUPPORTING DOCUMENTATION FOR QUOTATION OR OTHER PURPOSES, YOU AGREE NOT TO DISCLOSE TO OTHERS THE IDEAS, INFORMATION, OR DESIGNS SHOWN HEREIN, AND THAT YOU WILL MAKE NO USE OF SAME WITHOUT PERMISSION		MATERIAL: CRS		TITLE: ASSY, NETWORK CABINET
			DRAWN BY: MABBY 10/3/18	CHECKED BY:	SIZE: DRAWING NO. D HWS14836C
			APPROVED BY:		REV. 2
			SCALE: N/A	SHEET 1 OF 1	