

4

3

2

1

| ENCLOSURE INFORMATION | |
|------------------------|---------------------------------|
| P/N: | DESCRIPTION: |
| 23831KBAM | BOX SST 1F 1b, M20 BOTTOM |
| 23804ACAB | COVER SST 1F 1b, TWO DEVICE |
| 23203BAAB | ASSY, DIN RAIL HKH 2 TIER |
| MOUNT METHOD: | |
| DEVICE 1 ASSEMBLY (1F) | |
| P/N: | DESCRIPTION: |
| HKHPLR | PILOT LIGHT RED LENS ASSEMBLY |
| 23225AAAB | LAM, BLANK |
| LOCKOUT DEV.: | |
| N/A | N/A |
| CONTACT 1: | |
| HKHPLD | PILOT LIGHT MOD, DM |
| DEVICE 2 ASSEMBLY (2F) | |
| P/N: | DESCRIPTION: |
| HKHPLG | PILOT LIGHT GREEN LENS ASSEMBLY |
| 23225AAAB | LAM, BLANK |
| LOCKOUT DEV.: | |
| N/A | N/A |
| CONTACT 1: | |
| HKHPLD | PILOT LIGHT MOD, DM |

PILOT LIGHT RATINGS:
 LIGHT EMITTING DIODE
 12-254 VAC/DC LED
 0.6WTERMINALS RATED FOR 1-2 CONDUCTORS
 #22-10 AWG. (0.5-4mm²)

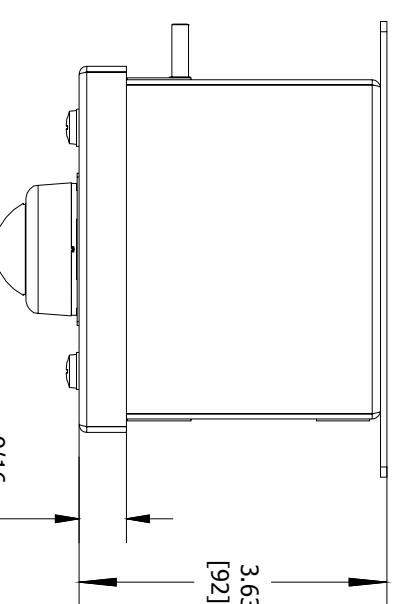

TOP VIEW

HUBBELL
 Harsh & Hazardous
 CAT. NO. **HKHMOD Series**
 WWW.HARSHANDHAZARDOUS.COM
 DATE CODE S/N

ST. LOUIS, MO 63113

INDUSTRIAL CONTROL EQUIPMENT FOR USE IN ZONE CLASSIFIED HAZ. LOCS.
 CLASS I, ZONE 1, AEx de IIC T6...T4 Gb; Ex de IIC T6...T4 Gb
 CLASS II, AEx tb IIC T85°C...T135°C Db IP66; Ex tb IIIC T85°C...T135°C Db IP66
 CLASS I, DIV.2, GRPS. A,B,C,D; CLASS II, DIV.1, GRPS. E,F,G (CANADA ONLY)
 CLASS II, DIV.2, GROUPS E,F,G; CLASS III
 CLASS III; TYPE 3/4/4X/12/13; -50°C ≤Ta≤+60°C

SEE IOM FORM K1466 FOR ELECTRICAL RATINGS.

ST. LOUIS, MO 63113
 LST100
 A243

TR RU C-US;MIO62.B.04167 IEX 16.0079 INMETRO

FOR T-CODES AND FOR ELECTRICAL RATINGS.
 SEE IOM FORM K1466 & K1470

Seguranca
 IEX
 INMETRO

CERTIFICATION NAME PLATES

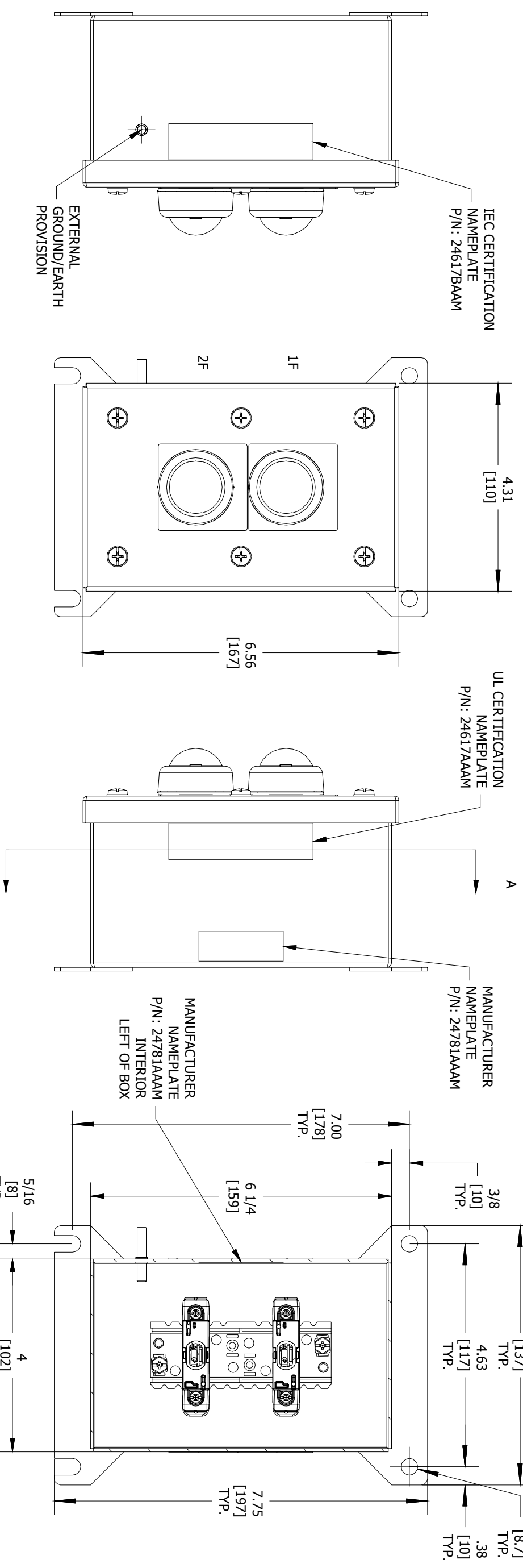

LEFT SIDE VIEW

FRONT VIEW

RIGHT SIDE VIEW

SECTION A-A VIEW

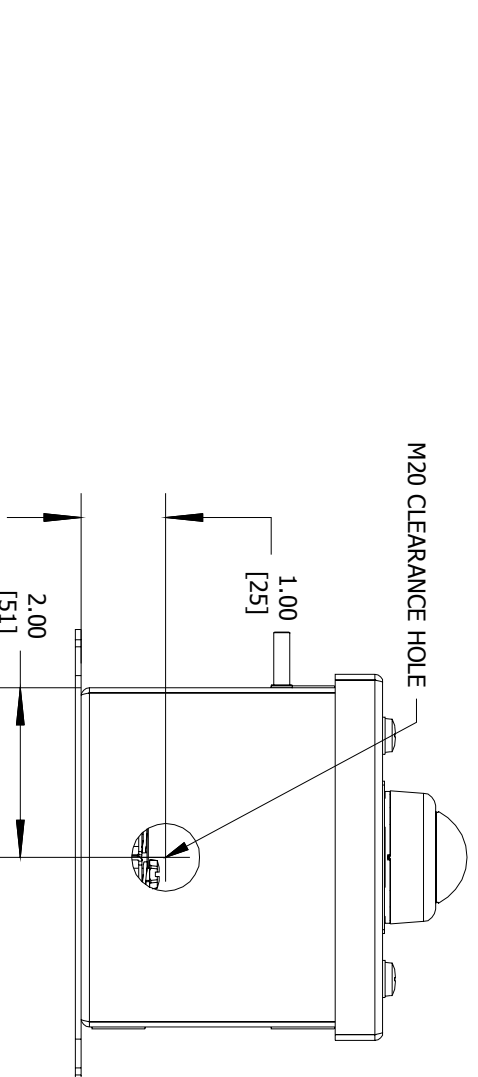

BOTTOM VIEW

HUBBELL
 HKH SERIES
 CONTROL STATION
 CAT. NO. **HKH1BSDALRLOGL0**
 COUNTRY/DATE CODE
 WWW.HARSHANDHAZARDOUS.COM

COMMENT:

SGN:

DATE:

ACCEPTANCE:

DRAWN BY:

DATE:

DWG NUMBER:

ENTRY NO. HUB/GLAND:

ITEM:

CODE 1: APPROVED (NO COMMENTS)

PR

10/24/2016

SALES/QUOTE NO.:

ENTRY 1 NONE

CODE 2: APPROVED FOR MANUFACTURING WITH COMMENTS TO BE INCORPORATED

CODE 3: NOT APPROVED RE-SUBMIT

TITLE:

HKH MODIFIED ENCLOSURE (HKH1BSDALRLOGL0)

ENTRY 1 NONE

CODE 4: FOR INFORMATION ONLY

HKH MODIFIED ENCLOSURE (HKH1BSDALRLOGL0)

SALES/QUOTE NO.:

ENTRY 1 NONE

REVISION



3

THIS DOCUMENT IS THE PROPERTY OF HUBBELL - KILLARK. IT IS LOANED TO YOU AND MUST NOT BE USED IN ANY WAY DETRIMENTAL TO THE INTEREST HUBBELL - KILLARK.

REVISION

2

DATE:

SALES/QUOTE NO.:

ENTRY 1 NONE

4

3

2

1