

ENCLOSURE INFORMATION	
P/N:	DESCRIPTION:
23831KBAM	BOX SST 1F 1b, M20 BOTTOM
23804BAB	COVER SST 1F 1b, ONE DEVICE
HKHPMBRKT	HKH PANEL MOUNT BRACKET, C. B. & P. L. (1 PL.)
MOUNT METHOD: HKHPMBRKT	
DEVICE 1 ASSEMBLY (1F)	
P/N:	DESCRIPTION:
HKHB1TMR	MAINTAINED P. B. TWIST REL, MUSH HD, RED
23225TAAB	LAM, EMERGENCY STOP
LOCKOUT DEV.: NONE	
CONTACT 1: HKHNO20P CONTACT BLCK, FACT SEALED N.O. PM, 20A	
CONTACT 2: HKHNC20P CONTACT BLCK, FACT SEALED N.O. PM, 20A	

CONTACT BLOCK RATINGS:
 690 VAC, 20A, 50-60
 60 VDC, 5A, 110VDC, 1.5A
 1/2 HP @ 120 VAC, 1 HP @ 208/240/277VAC
 NEMA A600/PE600 - PILOT DUTY
 350VAC, 20A - TUNGSTEN
 AC690V, 16A AC-12
 AC230V, 16A AC-15
 50-60HZ
 DCGOV 5A DC-13
 TERMINALS RATED FOR 1-2 CONDUCTORS
 #22-10 AWG (0.5-4mm²)

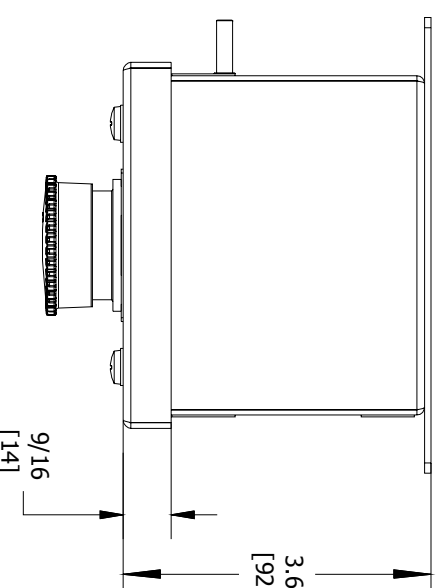

	CAT. NO. HKHMOD Series	DATE CODE: S/N
Harsh & Hazardous	WWW.HARSHANDHAZARDOUS.COM	ST. LOUIS, MO 63113
	0539 Ex de IIC T6...T4 Gb	SEE IOM FORM K1466 & K1470
	0539 Ex tb IIC T85°C...T135°C Db IP66	FOR T-CODES AND FOR ELECTRICAL RATINGS.
	DEMKO 15 ATEX 1405X	See IOM FORM K1466 FOR ELECTRICAL RATINGS.
	Ex de IIC T6...T4 Gb	
	Ex de IIC T85°C...T135°C Db IP66	
	ATEX UL 15:0054X	
	-40°C ≤Tas≤+55°C WITH AMMETER)	
	TR RU C-US, M1062.B.04167	IEX 16.0079 INMETRO
	HKHMOD Series	
	INDUSTRIAL CONTROL EQUIPMENT FOR USE IN ZONE CLASSIFIED HAZ. LOCS.	
	CLASS I, ZONE 1, AEx de IIC T6...T4 Gb; Ex de IIC T6...T4 Gb	
	CLASS II, DIV. 2, GRPS. A,B,C,D; CLASS II, DIV. 1, GRPS. E,F,G (CANADA ONLY)	
	CLASS III, TYPE 3/4/4X/12/13, -50°C ≤Tas≤+60°C	
	CERTIFICATION NAME PLATES	

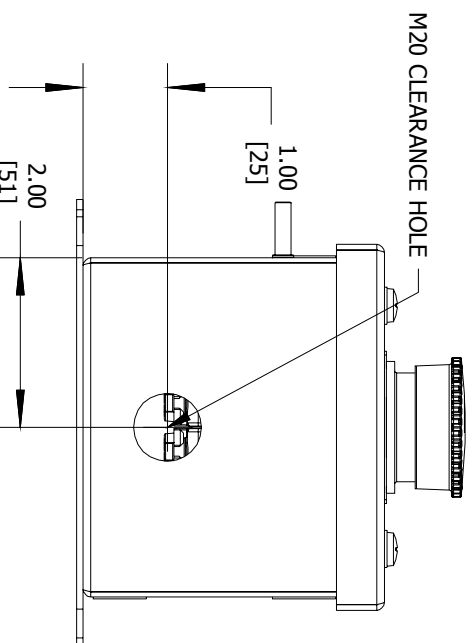
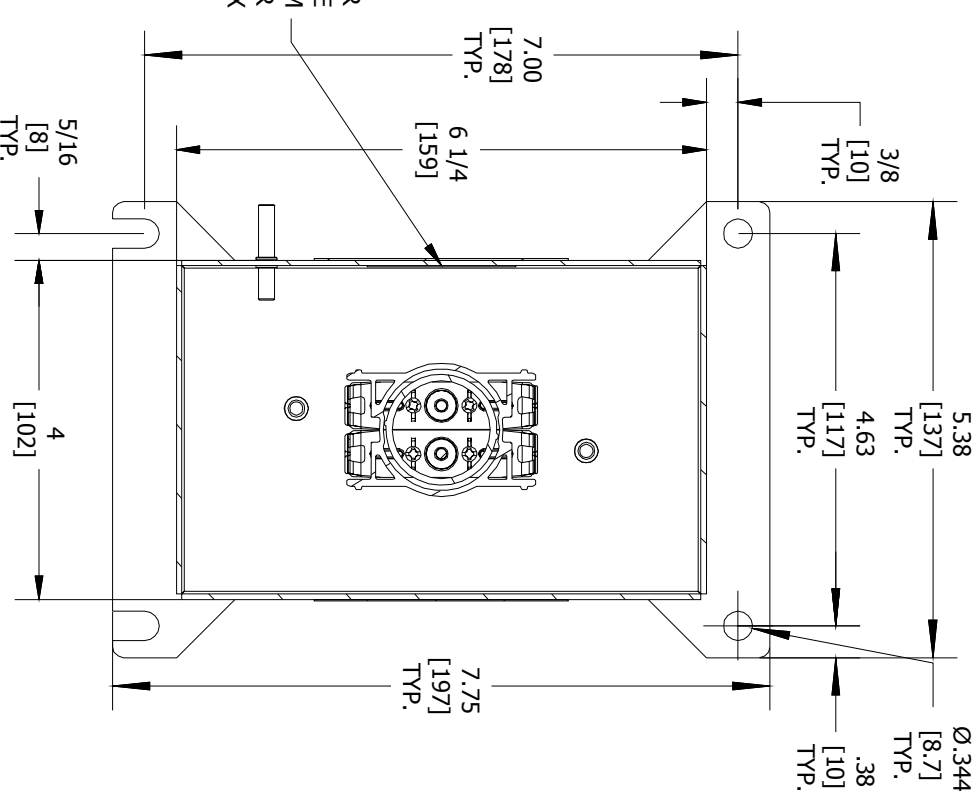
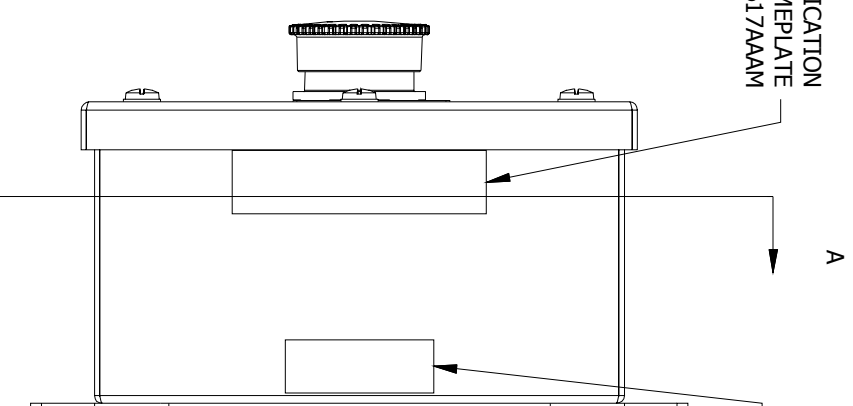
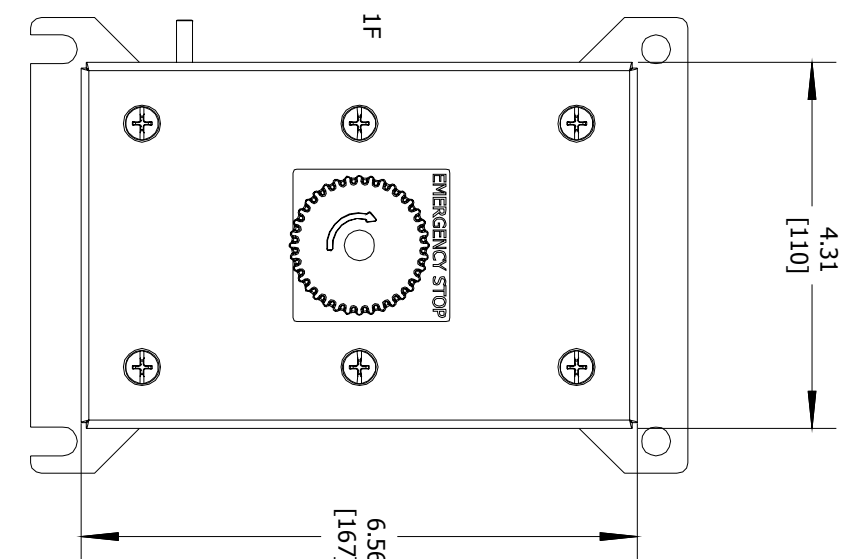
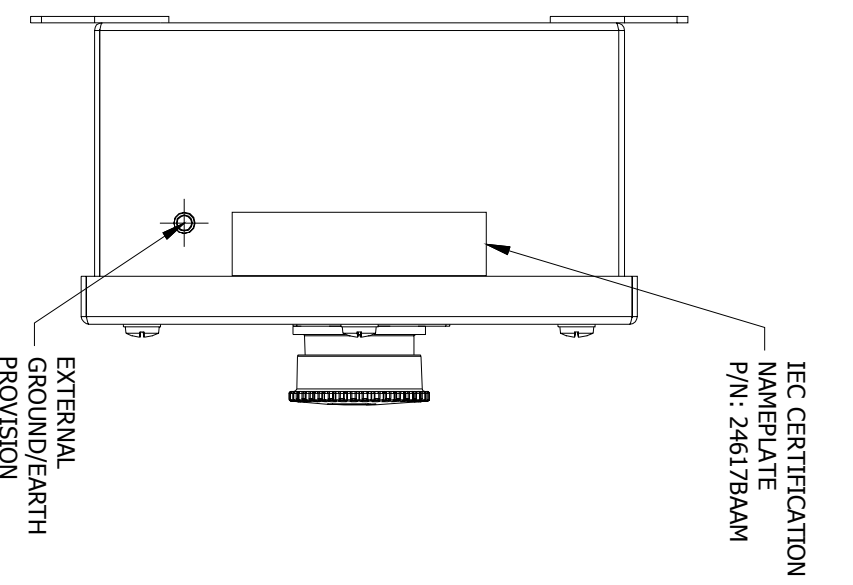

M20 CLEARANCE HOLE

COMMENT:

SGN:

DATE:

ACCEPTANCE:

DRAWN BY:

DATE:

DWG NUMBER:

ENTRY HUB/GLAND SELECTION CHART*	
ENTRY NO.	HUB/GLAND:
ENTRY 1	NONE

REVISION

SGN:

DATE:

ACCEPTANCE:

DRAWN BY:

DATE:

DWG NUMBER:

ITEM:

REVISION

SGN:

DATE:

ACCEPTANCE:

DRAWN BY:

DATE:

DWG NUMBER:

ITEM:



REVISION	SGN:	DATE:	ACCEPTANCE:	DRAWN BY:	DATE:	DWG NUMBER:	ITEM:
1							
2		10/21/2016		PR	10/21/2016	HKHIBSPAM71E	N/A
3						SALES/QUOTE NO.:	N/A
4							

REVISION



THIS DOCUMENT IS THE PROPERTY OF HUBBELL - KILLARK. IT IS LOANED TO YOU AND MUST NOT BE USED IN ANY WAY DETRIMENTAL TO THE INTEREST HUBBELL - KILLARK.

REVISION

DATE:

SALES/QUOTE NO.:

SHEET 1 OF 1