

ENCLOSURE INFORMATION		
P/N:	DESCRIPTION:	
23198KBAM	BOX PLASTIC 1C, M20 BOTTOM	
23195CAAB	COVER PLASTIC HKH 1C, THREE DEVICE	
23203CAAB	ASSY, DIN RAIL HKH 3 TIER	
DEVICE 1 ASSEMBLY (1F)		
P/N:	DESCRIPTION:	
HKHPLR	PILOT LIGHT RED LENS ASSEMBLY	
23225AAAB	LAM., BLANK	
N/A	N/A	
HKHPLD	PILOT LGHT MOD, DM	
DEVICE 2 ASSEMBLY (2F)		
P/N:	DESCRIPTION:	
HKHPBMSS	PUSH BUTTON, MOM.,STOP	
NONE	N/A	
NONE	N/A	
HKH1NO20D	CONTACT BLCK, FACT SEALED N.O. DRM, 20A	
HKH1NC20D	CONTACT BLCK, FACT SEALED N.C. DRM, 20A	
DEVICE 3 ASSEMBLY (3F)		
P/N:	DESCRIPTION:	
HKHPBMSS	PUSH BUTTON, MOM.,START	
NONE	N/A	
NONE	N/A	
HKH1NO20D	CONTACT BLCK, FACT SEALED N.O. DRM, 20A	
HKH1NC20D	CONTACT BLCK, FACT SEALED N.C. DRM, 20A	

CONTACT BLOCK RATINGS:
690 VAC, 20A, 50-60
60 VDC, 5A, 110VDC, 1.5A

1/2 HP @ 120 VAC, 1 HP @ 208/240/277VAC
NEMA A600/P600 - PILOT DUTY
350VAC, 20A - TUNGSTEN
AC690V 16A AC-12
AC230V 16A AC-15

50-60HZ
DC60V 5A DC-13
TERMINALS RATED FOR 1-2 CONDUCTORS
#22-10 AWG. (0.5-4mm²)

PILOT LIGHT RATINGS:
LIGHT EMITTING DIODE
12-254 VAC/VDC LED
0.6W/TERMINALS RATED FOR 1-2 CONDUCTORS
#22-10 AWG. (0.5-4mm²)

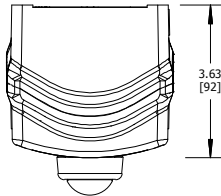

TOP VIEW

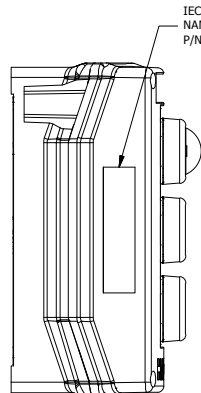

LEFT SIDE VIEW

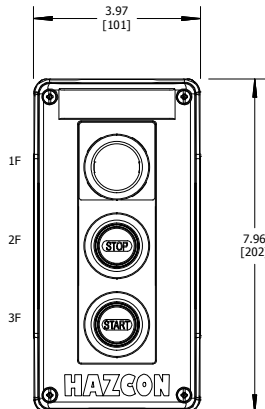

FRONT VIEW

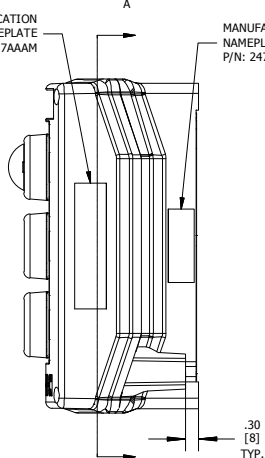

RIGHT SIDE VIEW

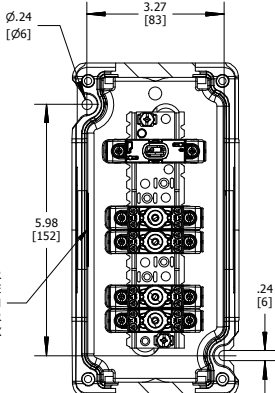

SECTION A-A VIEW

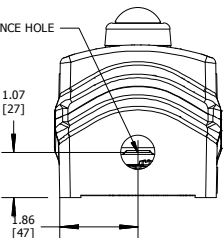

BOTTOM VIEW

HKHMOD Series CAT. NO. DATE CODE-S/N

Harsh & Hazardous INDUSTRIAL CONTROL EQUIPMENT FOR USE IN ZONE CLASSIFIED HAZ. LOCS.
CLASS I, ZONE 1, AEx de IIC T6...T4 Gb; Ex de IIC T6...T4 Gb
ZONE 21, AEx tb IIIC T85°C...T135°C Db IP66; Ex tb IIIC T85°C...T135°C Db IP66
CLASS I, DIV.2, GRPS. A,B,C,D; CLASS II, DIV.1, GRPS. E,F,G (CANADA ONLY)
CLASS II, DIV.2, GROUPS E,F,G; CLASS III
CLASS III; TYPE 3/4/4X/12/13; -50°C ≤Tas+60°C

ST. LOUIS, MO 63113
SEE IOM FORM K1466 & K1470 FOR T-CODES AND FOR ELECTRICAL RATINGS.

TR RU C-US.M1062.B.04167 IEx 16.0079 INMETRO

HKHMOD Series CAT. NO. DATE CODE-S/N

Harsh & Hazardous INDUSTRIAL CONTROL EQUIPMENT FOR USE IN ZONE CLASSIFIED HAZ. LOCS.
CLASS I, ZONE 1, AEx de IIC T6...T4 Gb; Ex de IIC T6...T4 Gb
ZONE 21, AEx tb IIIC T85°C...T135°C Db IP66; Ex tb IIIC T85°C...T135°C Db IP66
CLASS I, DIV.2, GRPS. A,B,C,D; CLASS II, DIV.1, GRPS. E,F,G (CANADA ONLY)
CLASS II, DIV.2, GROUPS E,F,G; CLASS III
CLASS III; TYPE 3/4/4X/12/13; -50°C ≤Tas+60°C

ST. LOUIS, MO 63113
SEE IOM FORM K1466 FOR ELECTRICAL RATINGS.

HKH SERIES CONTROL STATION

CAT. NO. **HKHMOD000003**

COUNTRY/DATE CODE

WWW.HARSHANDHAZARDOUS.COM

COMMENT:	SGN:	DATE:	ACCEPTANCE:	DRAWN BY:	DATE:	DWG NUMBER:	SALES/QUOTE NO.:	ITEM:
			CODE 1: APPROVED (NO COMMENTS)	PR	03/21/2017	HKHMOD000003	N/A	N/A
			CODE 2: APPROVED FOR MANUFACTURING WITH COMMENTS TO BE INCORPORATED					
			CODE 3: NOT APPROVED RE-SUBMIT					
			CODE 4: FOR INFORMATION ONLY					
TITLE: HKH MODIFIED ENCLOSURE (HKH1CNDALRL0P11P11)				SHEET 1 OF 1				

ENTRY HUB/GLAND SELECTION CHART*

ENTRY NO.	HUB/GLAND:
ENTRY 1	NONE

*HUBS & CABLE GLANDS ARE SHIPPED WITH ENCLOSURE



4 3 2 1

D

C

B

A

4 3 2 1