

9B7@CG F9 -B: CFA 5H-CB		
DIB.	89G7F -DH-CB.	
6CL.	& % . 765A	6CL D15GH-7 %7A &S 6CHCA
7CJ 9F.	& %) 7556	7CJ 9F D65GH-7 <? < %Z H- F 99 B 9J -79
ACI BHA 9K-CB.	& &S 7556	5GGM B-B F5 @ <? < " H-9F

7CBH57H 6@C?? F5H-B: G
 + S J 572 &S2) S* S
 * S J 872) 52 %8J 872 %) 5
 %8< < D 4 %8S J 572 %< D 4 &S. 88(\$8++J 57
 B9A 5 S *S8D' S\$1 D @CH81 HM
 ') S J 572 &S1 H B: GH9B
 57' - S J %' 5 571%
 57& S J %' 5 571%
) S' S< N
 87' S J) 5 871%
 H9F A 1B 58F F5H9B: CF %8 & 7CB81 7HCFG
 . && %S 5K : " 1B) (a a &

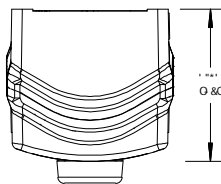

HCD J -9K

89J -79 % 5GG9A 6@M1% L		
DIB.	89G7F -DH-CB.	
89J -79.	<? < D6A A GG	DI G< 6I HHC BZ A CA "GH5FH
@9 9B8 D@5H9.	& &S 5556	@5A "Z 6@5B?
@C77CI H 89J".	BCB9	B#5
7CBH57H %	<? < %BC &S8	7CBH57H 6@77Z: 57H G95@9B "B"C" 8FA Z &S5
7CBH57H &	<? < %B7 &S8	7CBH57H 6@77Z: 57H G95@9B "B" " 8FA Z &S5

89J -79 % 5GG9A 6@M1% L		
DIB.	89G7F -DH-CB.	
89J -79.	<? < D6A A GG	DI G< 6I HHC BZ A CA "GH5FH
@9 9B8 D@5H9.	& &S 5556	@5A "Z 6@5B?
@C77CI H 89J".	BCB9	B#5
7CBH57H %	<? < %BC &S8	7CBH57H 6@77Z: 57H G95@9B "B"C" 8FA Z &S5
7CBH57H &	<? < %B7 &S8	7CBH57H 6@77Z: 57H G95@9B "B" " 8FA Z &S5

89J -79 % 5GG9A 6@M1% L		
DIB.	89G7F -DH-CB.	
89J -79.	<? < D6A A GG	DI G< 6I HHC BZ A CA "Z 6@ 6@5B?
@9 9B8 D@5H9.	& &S 5556	@5A "Z 6@5B?
@C77CI H 89J".	BCB9	B#5
7CBH57H %	<? < %BC &S8	7CBH57H 6@77Z: 57H G95@9B "B"C" 8FA Z &S5
7CBH57H &	<? < %B7 &S8	7CBH57H 6@77Z: 57H G95@9B "B" " 8FA Z &S5

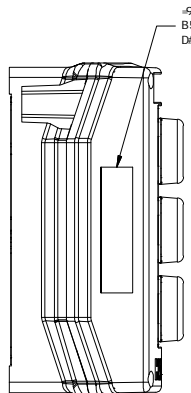

@9: H'G-89'J -9K

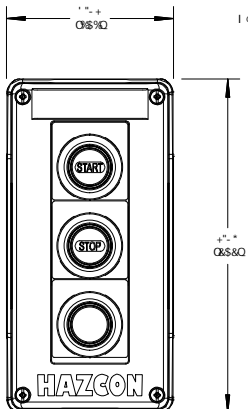

: FCBH J -9K

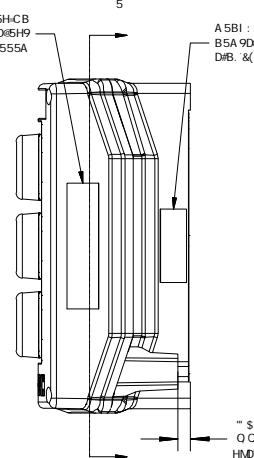

F = <H'G-89'J -9K

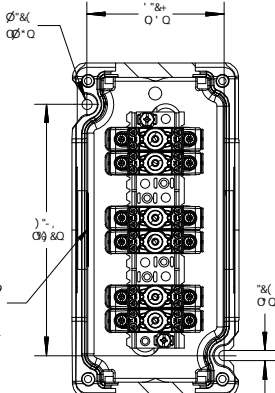

G97H-CB '5!5'J -9K

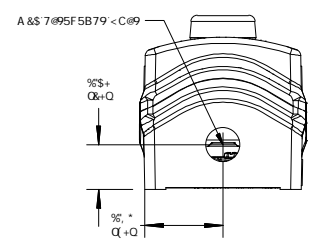

6CHCA 'J -9K

75H' <? < A C 8 'G Y f Y g 85H9 7CB9@CB

Harsh & Hazardous K K K * : SFG : 5B8 : 5N5F 8C1 G7CA

99-CA : CFA 7% " : / 7% : 4S : CF H7CB9G 5B8 : CF 9@97HF 758F 5H8: G'

9A 7C 9@ 5H9L % (S) L
 9I XY = 7 H " " " " V
 9I IV = 7 H) S7 " " " " H) S7 8V -D* *
 979I 1 @ 9@ S8) (L
) (S' C sTas2 * S' C
) (S' C sTas2 * S' C WITH AMMETER)

Segurança

EX EMC

HF FI 711 GA -C' &G'S (% + -9I % " S\$+ -BA 9F C

75H' <? < A C 8 'G Y f Y g 85H9 7CB9@CB

Harsh & Hazardous K K K * : SFG : 5B8 : 5N5F 8C1 G7CA

99-CA : CFA 7% " : / 9@97HF 758F 5H8: G'

9A 7C 9@ 5H9L % (S) L
 9I XY = 7 H " " " " V
 9I IV = 7 H) S7 " " " " H) S7 8V -D* *
 979I 1 @ 9@ S8) (L
) (S' C sTas2 * S' C
) (S' C sTas2 * S' C WITH AMMETER)

Segurança

EX EMC

HF FI 711 GA -C' &G'S (% + -9I % " S\$+ -BA 9F C

75H' <? < A C 8 \$\$\$\$+
 TCI BHFMB5H9 7CB9
 K K K * : SFG : 5B8 : 5N5F 8C1 G7CA

7CAA 9BH.	G. B.	85H9.	5779DH5B79.	8F5K B 6M	85H9.	8K : 'BI A 69F. <? < A C 8 \$\$\$\$+
			7CB9 % 5DDFCJ 98 fBC 7CAA 9BHGL	DF	\$' #R&#&S%@	G5@9G#E I CH9 BC". B#5
			7CB9 & 5DDFCJ 98 : CF A 5B1 : 57H F-B: K H- 7CAA 9BHGH C: 69 -B7CF DCF 5H9B	HH@9.		+H9A. B#5
			7CB9' . BCH 5DDFCJ 98 F 9I GI 6A -H	<? < 'A C 8 = -98 9B7@CGI F 9		G< 99H ' % ' ' C: %
			7CB9 (: CF -B: CFA 5H-CB CB@M	f k ? < % / B 85D % \$ D % \$ D % \$		
5	F 9J -G-CB					

9BHF M<1 6# @5B8 G9@97H-CB 7< 5FH
9BHF MCB" <1 6# @5B8.
9BHF M% BCB9
1 <1 6G/ 756@9: @5B8G 5F 9 G: -DD9B K H- 9B7@CGI F 9