

2

1. DIMENSIONS ARE IN INCHES[mm].
2. REFER TO PD2934 INSTRUCTIONS FOR INSTALLATION.
3. CORD RANGE #6AWG TO #2AWG.
4. NEMA 3R RATING.

CAT NO. HBL100MAGF

LIST OF PARTS		
DESCRIPTION	MATERIAL	FINISH
RUBBER HOUSING	TPV	
HOUSING	PBT	
CONTACTS	BRASS	
PLUNGER	PBT	
BUTTONS	PBT	
SPRINGS	STEEL	
MOUNTING SCREWS	STAINLESS STEEL	
CORD CLAMPS	PBT	
THREADED INSERTS	BRASS	
CORD CLAMP SCREWS	STAINLESS STEEL	
EXTERNAL BRACKETS	STAINLESS STEEL	
EXTERNAL BRACKET SCREWS	STAINLESS STEEL	

2	NEW RELEASE PER DCN 231009033956 RGP	DL	11-16-2023
REV	DESCRIPTION	APP	DATE

THE DESIGN AND DIMENSIONS OF THE
PRODUCT SHOWN ON THIS DRAWING ARE
SUBJECT TO CHANGE WITHOUT NOTICE.
DIMENSIONS ARE IN INCHES [mm].

TITLE

ARC GUARD™® PIN AND SLEEVE
CONNECTOR 100A/250VDC



WIRING DEVICE-KELLEMS
HUBBELL INCORPORATED
SHELTON, CT

TOLERANCES UNLESS
OTHERWISE SPECIFIED
.XX = $\pm .01$
.XXX = $\pm .005$
ANGLE TOL. $\pm 2'$

DR. BY	CAC
CHK. BY	

SCALE	1 / 2
DATE	09/24/20

DIMENSION SHEET END CAT NO

३

M-14309

2

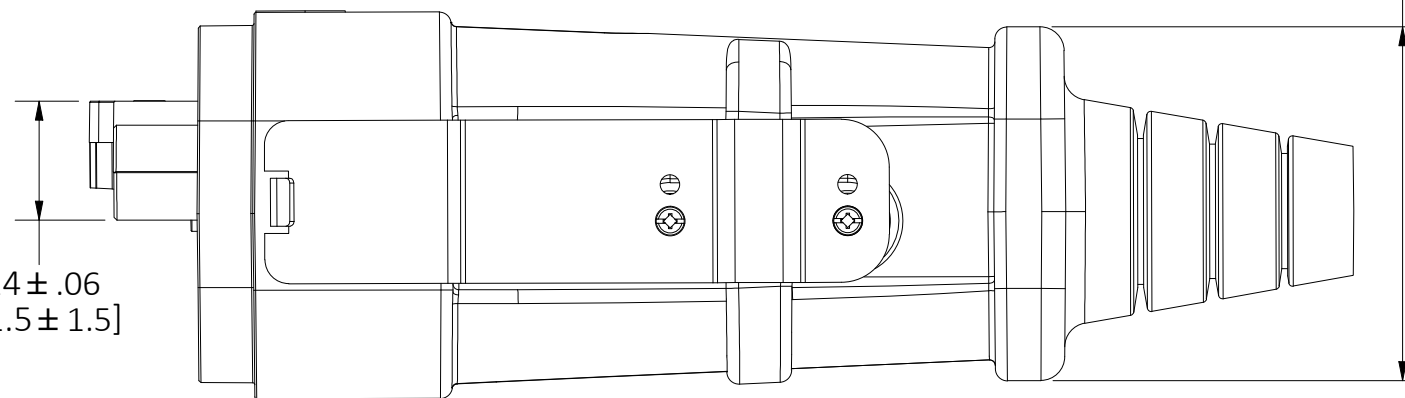
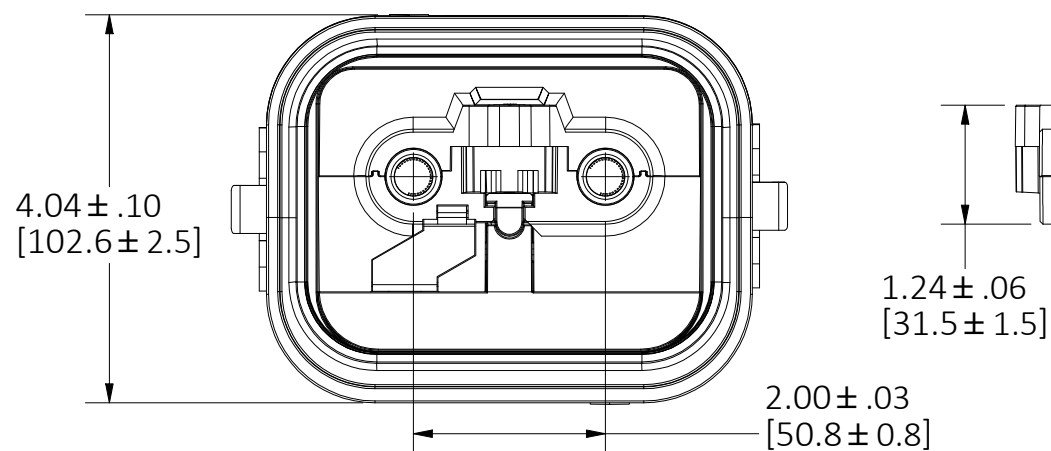
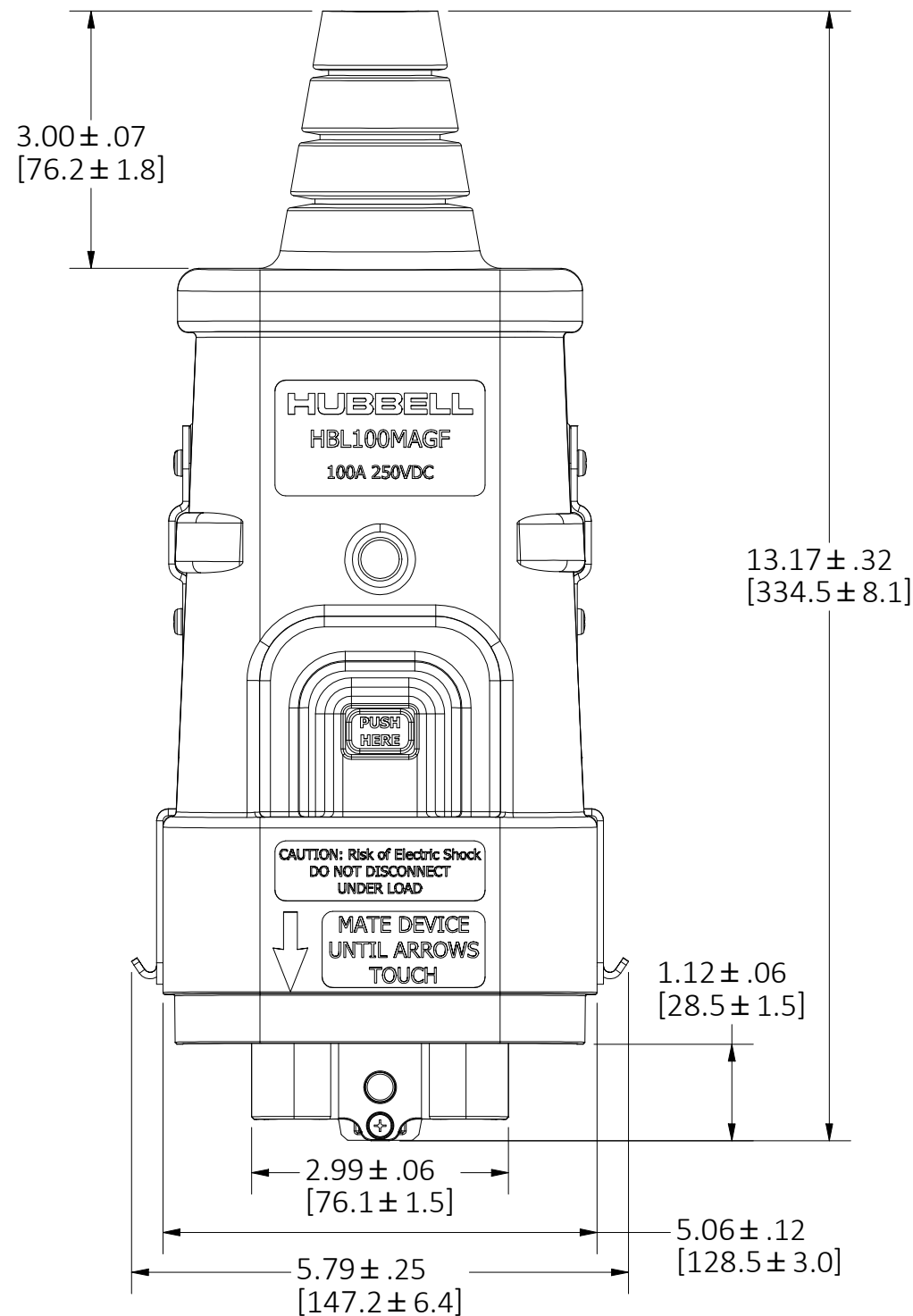

CAGE CODE 74545