

M-14310

NOTES:

CAT NO. HBL100MAGM

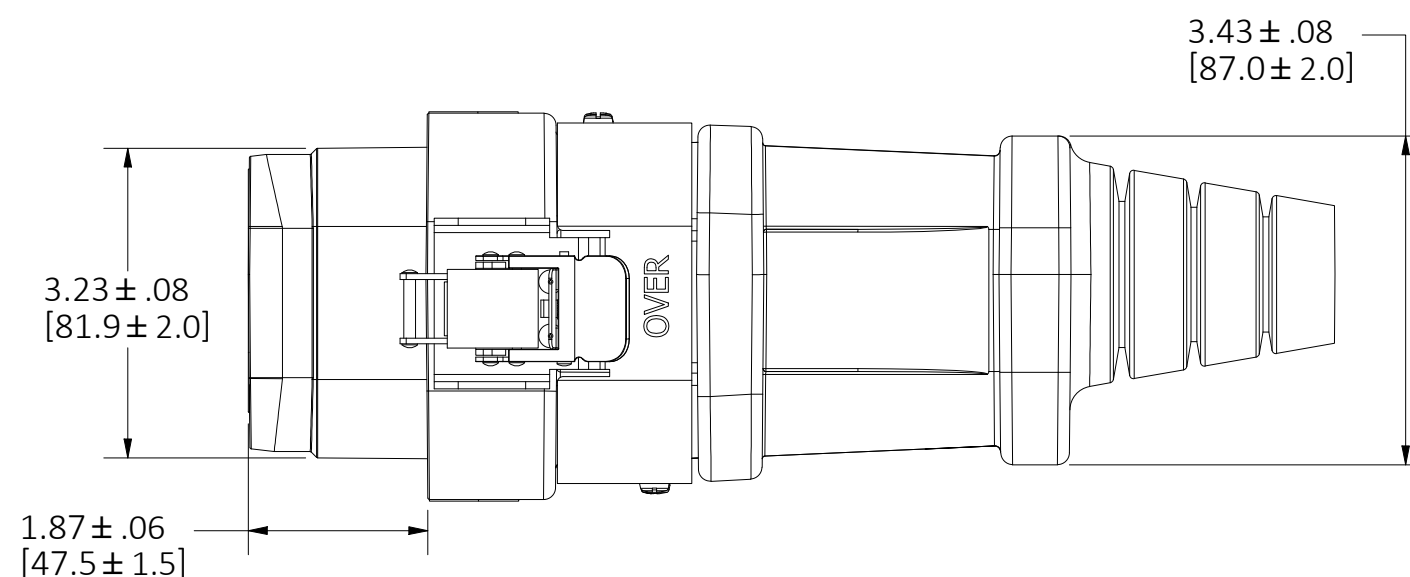
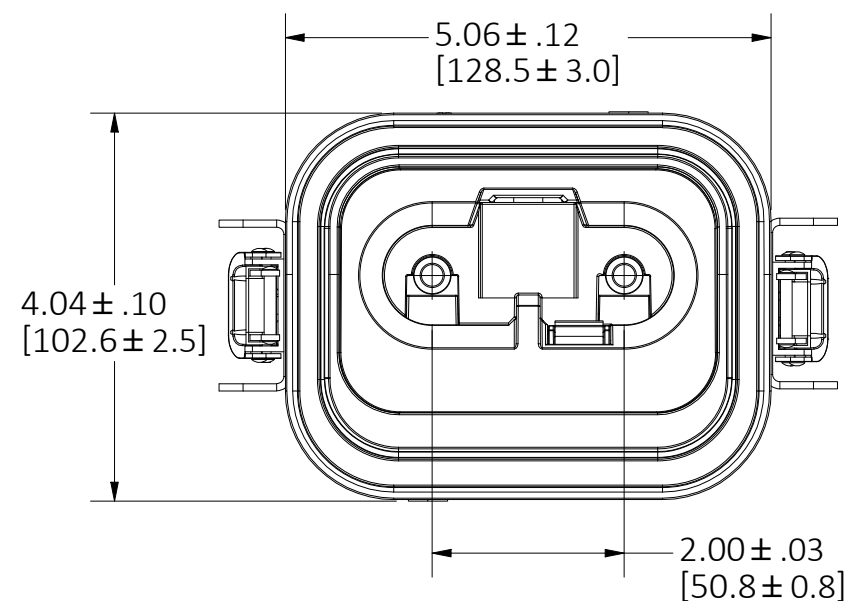

LIST OF PARTS		
DESCRIPTION	MATERIAL	FINISH
RUBBER HOUSING	TPV	
HOUSING	PBT	
CONTACTS	BRASS	
MOUNTING SCREWS	STAINLESS STEEL	
CORD CLAMPS	PBT	
THREADED INSERTS	BRASS	
CORD CLAMP SCREWS	STAINLESS STEEL	
EXTERNAL BRACKETS	STAINLESS STEEL	
EXTERNAL BRACKET LATCHES	STAINLESS STEEL	
EXTERNAL BRACKET SCREWS	STAINLESS STEEL	

2	NEW RELEASE PER DCN 231009033956 RGP	DL	11-16-2023
REV	DESCRIPTION	APP	DATE

THE DESIGN AND DIMENSIONS OF THE  
PRODUCT SHOWN ON THIS DRAWING ARE  
SUBJECT TO CHANGE WITHOUT NOTICE.  
DIMENSIONS ARE IN INCHES [mm].

	TITLE
--	-------

ARC GUARD™<sup>®</sup> PIN AND SLEEVE PLUG  
100A/250VDC

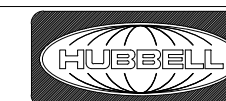

WIRING DEVICE-KELLEMS  
HUBBELL INCORPORATED  
SHELTON, CT

TOLERANCES UNLESS OTHERWISE SPECIFIED .XX = ± .01 .XXX = ± .005 ANGLE TOL. ±2'	DR. BY	CAC	SCALE	1 / 2
	CHK. BY		DATE	09/24/20

CAGE CODE 74545

DIMENSION SHEET FOR CAT. NO.

३

M-14310

2